



Route Log and Progress Chart

DRAFT

Please Note: Errors and Omissions May Exist.
Contact the VTrans Mapping Section with questions or concerns.

DISTRICT	TOWN	ROUTE
5	ESSEX JUNCTION	Urb-5314

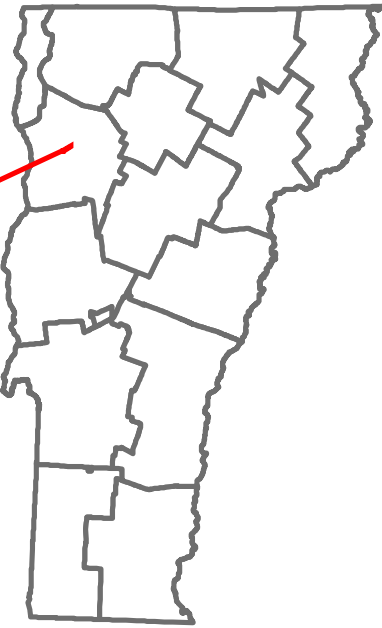

Urb-5314

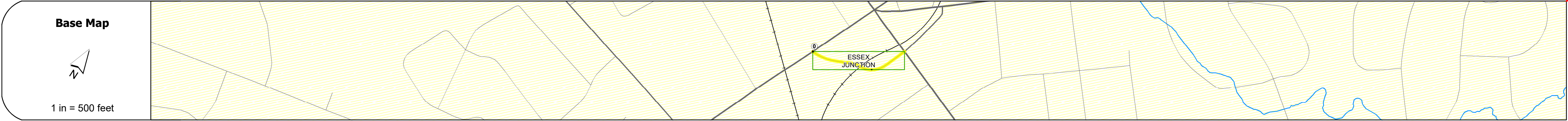

Road Widths	Travellane Roadway Lane Count Base Subbase
-------------	--

Curves	
--------	--

Grades	
--------	--

Guardrails	
------------	--

Rumblestrips	
--------------	--

Historic Projects	
-------------------	--

Maintenance Garage	
--------------------	--

Speed Zone	
------------	--

Functional Class	4
------------------	---

National Highway System	
-------------------------	--

Limited Access Highway	
------------------------	--

Customer Service Level	
------------------------	--

Traffic Counters	
------------------	--

AADT	2024 8249 2023 2022 2021 2020
------	---

Crash Locations	(Incomplete) 2025 2024 2023 2022 2021
-----------------	---

STRUCTURE DESCRIPTIONS

Unknown

Retreatment

Resurface

Bituminous Mix

Skinny Mix

Bituminous Seal

Bituminous Concrete

Cold Plane and Bituminous Concrete

Concrete

Surface Treated Gravel

Plant Mix

Reclaimed Base and Bituminous Concrete

1 - Interstate System

2 - Other Freeways and Expressways

3 - Principal Arterial

4 - Minor Arterial

5 - Major Collector

6 - Minor Collector

Curves

Left (degrees)

Right (degrees)

Grades

Left (percent)

Right (percent)

Road Widths

(ft)

Traffic Counters

Continuous (CTC)

Weight-In-Motion (WIM)

Short-Term, Scheduled

Short-Term, Unscheduled

Crash Locations

Fatal

Injury

Property Damage Only

Unknown Crash Type

High Crash Locations (HCL's)

Sections (& Intersections)

HCL No.

1 - 100 (1 - 10)

101 - 200 (11 - 20)

201 - 300 (21 - 30)

301 - 400 (31 - 40)

401 - 800 (41 - 113)

Mileage by Functional Class By Sheet

5314 4 - Minor Arterial

0.161

Page Total Mileage: 0.161 mi

Mileage by Town By Sheet

ESSEX JUNCTION - s53140419

0.161 of 0.161

Page Total Mileage: 0.161 mi

DISTRICT

5

TOWN

ESSEX JUNCTION

Date: 11/24/25

1 of 1

TWN mileage: 0.0 to 0.161

ROUTE

Urb-5314

ETE mileage: 0.0 to 0.161

For More Information Contact - Vermont Agency of Transportation, Policy, Planning and Intermodal Development Division - Mapping Section, 219 North Main Street, Barre, VT 05641 Telephone: 802-828-2600.