



Route Log and Progress Chart

DRAFT

Please Note: Errors and Omissions May Exist.
Contact the VTrans Mapping Section with questions or concerns.

DISTRICT	TOWN	ROUTE
8	FAIRFAX	Min-0742

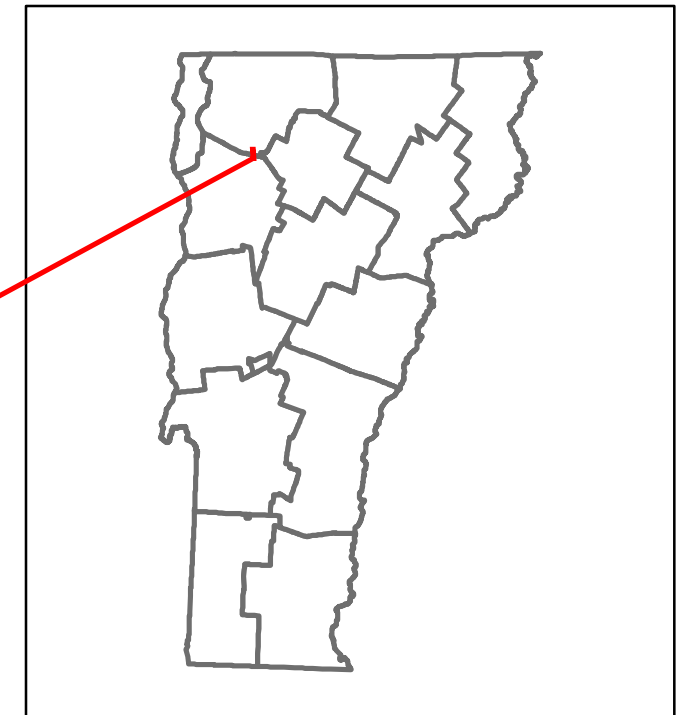

Min-0742

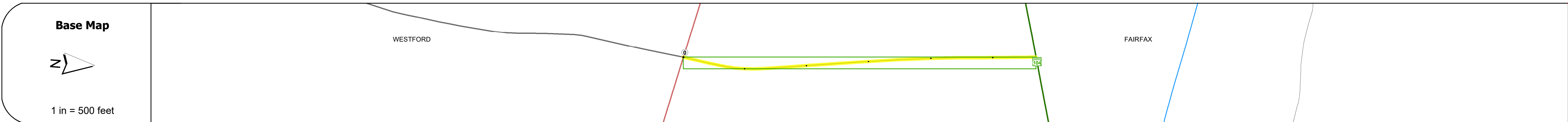

Road Widths	Travellane: 20
Roadway	20
Lane Count	2
Base	
Subbase	

Curves	
---------------	--

Grades	
---------------	--

Guardrails	
-------------------	--

Rumblestrips	
---------------------	--

Historic Projects	
--------------------------	--

Maintenance Garage	
---------------------------	--

Speed Zone	
-------------------	--

Functional Class	6
-------------------------	---

National Highway System	
--------------------------------	--

Limited Access Highway	
-------------------------------	--

Customer Service Level	
-------------------------------	--

Traffic Counters	
-------------------------	--

AADT	2020
	2019
	2018
	2017
	2016

Crash Locations	(Incomplete) 2021
	2020
	2019
	2018
	2017

STRUCTURE DESCRIPTIONS	

Historic Projects Unknown, Retreatment, Resurface, Bituminous Mix, Skiny Mix, Bituminous Seal, Surface Treated Gravel, Plant Mix, Reclaimed Base and Bituminous Concrete, Concrete, Gravel	Functional Class 1- Interstate System, 2- Other Freeways and Expressways, 3- Principal Arterial, 4- Minor Arterial, 5- Major Collector, 6- Minor Collector	Curves Left (degrees), Right (degrees), Grades (percent) grade up, Grades (percent) grade down	Traffic Counters Continuous (CTC), Weigh-In-Motion (WIM), Short-Term, Scheduled, Short-Term, Unscheduled (counter ID)	Crash Locations High Crash Locations (HCL's) Sections (& Intersections) HCL No. 1-100 (1-10), 101-200 (11-20), 201-300 (21-30), 301-400 (31-40), 401-800 (41-113)	Mileage by Functional Class By Sheet 0742 6 - minor collector 0.570	Mileage by Town By Sheet FAIRFAX - S07420604 0.57 of 0.57	DISTRICT 8	TOWN FAIRFAX	Date: 11/19/21	ROUTE Min-0742 ETE mileage: 3.13 to 3.7
					Legend Road Widths (ft) 125, 30, 35, 40, 45, 50, 55, 60, 65	AADT (AADT)	Page Total Mileage: 0.570 mi	Page Total Mileage: 0.57 mi	1 of 1 TWN mileage: 0.0 to 0.57	