



Route Log and Progress Chart

DRAFT

Please Note: Errors and Omissions May Exist.
Contact the VTrans Mapping Section with questions or concerns.

DISTRICT	TOWN	ROUTE
5	MILTON	Urb-5814

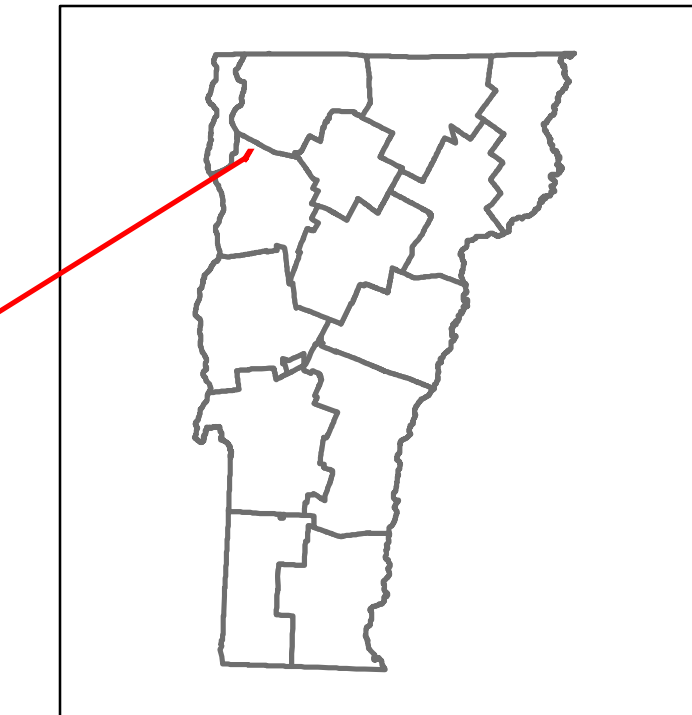

Urb-5814

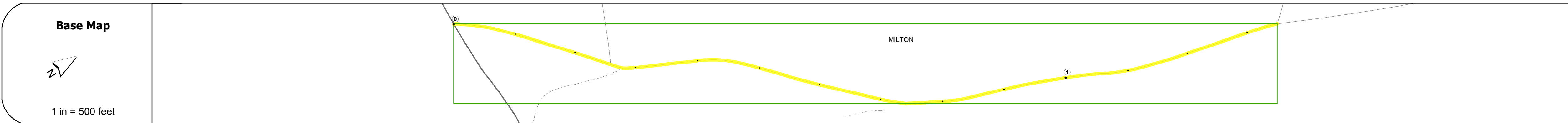

STRUCTURE DESCRIPTIONS

Road Widths	Travellane: 23 Roadway: 23 Lane Count: 2 Base: Subbase:
Curves	
Grades	
Guardrails	
Rumblestrips	
Historic Projects	0: Unknown
Maintenance Garage	
Speed Zone	
Functional Class	5
National Highway System	
Limited Access Highway	
Customer Service Level	
Traffic Counters	DOTS
AADT	2021: 1062 2020: 937 2019: 1106 2018: 1100 2017: 1100
Crash Locations	(Incomplete) 2022 2021 2020 2019 2018

Historic Projects Unknown, Bituminous Concrete, Retreatment, Bituminous Macadam, Resurface, Cold Plane and Bituminous Concrete, Bituminous Mix, Concrete, Skippy Mix, Bituminous Seal, Gravel, Surface Treated Gravel, Plant Mix, Reclaimed Base and Bituminous Concrete	Functional Class 1 - Interstate System, 2 - Other Freeways and Expressways, 3 - Principal Arterial, 4 - Minor Arterial, 5 - Major Collector, 6 - Minor Collector	Curves Left (degrees), Right (degrees), Grades (percent) grade up, (percent) grade down	Traffic Counters Continuous (CTC), Weigh-In-Motion (WIM), Short-Term, Scheduled, Short-Term, Unscheduled (counter ID)	Crash Locations Fatal, Injury, Property Damage Only, Unknown Crash Type, High Crash Locations (HCL's) Sections (& Intersections)	Mileage by Functional Class By Sheet 5814 5 - Major Collector 1.350	Mileage by Town By Sheet MILTON - S58140410 1.35 of 1.35	DISTRICT 5	TOWN MILTON	Date: 10/03/22	ROUTE Urb-5814 ETE mileage: 0.0 to 1.35
Page Total Mileage: 1.350 mi						Page Total Mileage: 1.35 mi				

For More Information Contact - Vermont Agency of Transportation, Policy, Planning and Intermodal Development Division - Mapping Section, 219 North Main Street, Barre, VT 05641 Telephone: 802-828-2600.