



# Route Log and Progress Chart

**DRAFT**

Please Note: Errors and Omissions May Exist.  
Contact the VTrans Mapping Section with questions or concerns.

DISTRICT	TOWN	ROUTE
1	PAWLET	Min-0564

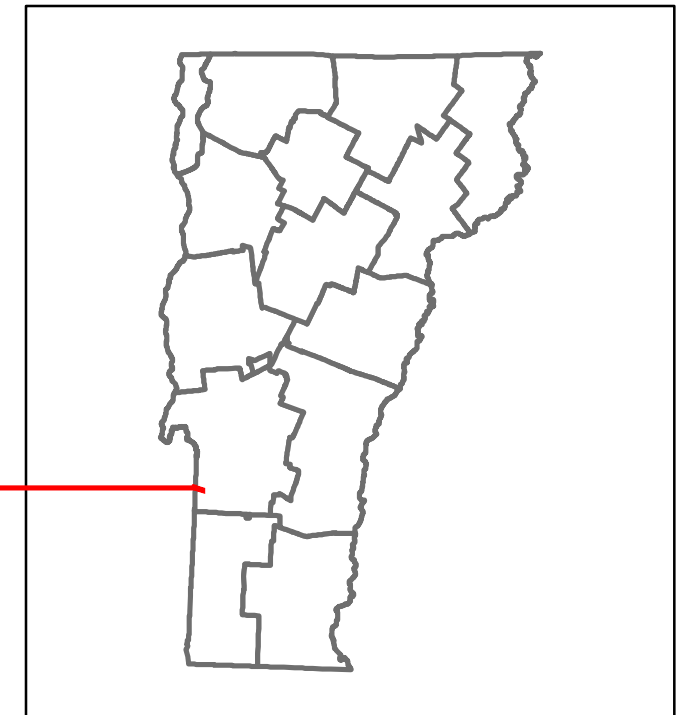

**Min-0564**

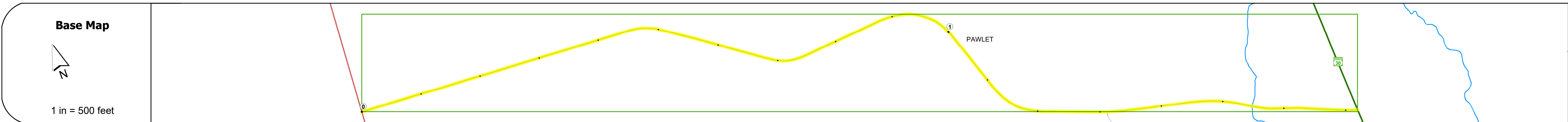

### STRUCTURE DESCRIPTIONS

**Bridge 25:**  
Stringer/multi-beam or girder - 1933  
Structure No: 101114002511141  
Length: 64'  
Height: 5.33'  
Width: 2.7'  
Facility Carried: C2002  
Structure Type: ROLLED BEAM  
Features Intersected: METTAWEE RIVER  
Surface: Bituminous  
Maintenance/Ownership: Town

<b>Road Widths</b>	Travellane	22
Roadway		22
Lane Count		2
Base		
Subbase		

<b>Curves</b>	
---------------	--

<b>Grades</b>	
---------------	--

<b>Guardrails</b>	
-------------------	--

<b>Rumblestrips</b>	
---------------------	--

<b>Historic Projects</b>	
--------------------------	--

<b>Maintenance Garage</b>	
---------------------------	--

<b>Speed Zone</b>	
-------------------	--

<b>Functional Class</b>	6
-------------------------	---

<b>National Highway System</b>	
--------------------------------	--

<b>Limited Access Highway</b>	
-------------------------------	--

<b>Customer Service Level</b>	
-------------------------------	--

<b>Traffic Counters</b>	
-------------------------	--

<b>AADT</b>	2021	
	2020	
	2019	
	2018	
	2017	

<b>Crash Locations</b>	(Incomplete) 2022	
	2021	
	2020	
	2019	
	2018	

<b>Historic Projects</b> Unknown, Retreatment, Resurface, Bituminous Mix, Skinny Mix, Bituminous Seal Bituminous Concrete, Bituminous Macadam, Cold Plane and Bituminous Concrete, Concrete, Gravel, Plant Mix, Reclaimed Base and Bituminous Concrete, Surface Treated Gravel	<b>Functional Class</b> 1 - Interstate System, 2 - Other Freeways and Expressways, 3 - Principal Arterial, 4 - Minor Arterial, 5 - Major Collector, 6 - Minor Collector	<b>Curves</b> Left (degrees), Right (degrees) <b>Grades</b> (percent) grade up, (percent) grade down <b>Road Widths</b> (ft)	<b>Traffic Counters</b> Continuous (CTC), Weigh-In-Motion (WIM), Short-Term, Scheduled, Short-Term, Unscheduled (counter ID) <b>Crash Locations</b> Fatal, Injury, Property Damage Only, Unknown Crash Type <b>High Crash Locations (HCL's)</b> Sections (& Intersections) HCL No. 1-100 (1-10), 101-200 (11-20), 201-300 (21-30), 301-400 (31-40), 401-800 (41-113)	<b>Mileage by Functional Class By Sheet</b> 0564 6 - minor collector 1.720	<b>Mileage by Town By Sheet</b> PAWLET - S05641114 1.72 of 1.72	<b>DISTRICT</b> 1	<b>TOWN</b> PAWLET	<b>Date:</b> 10/03/22	<b>ROUTE</b> Min-0564 ETE mileage: 0.0 to 1.72
				<b>Page Total Mileage: 1.720 mi</b>		<b>Page Total Mileage: 1.72 mi</b>		<b>1 of 1</b> TWN mileage: 0.0 to 1.72	

For More Information Contact - Vermont Agency of Transportation, Policy, Planning and Intermodal Development Division - Mapping Section, 219 North Main Street, Barre, VT 05641 Telephone: 802-828-2600.