



Route Log and Progress Chart

DRAFT

Please Note: Errors and Omissions May Exist.
Contact the VTrans Mapping Section with questions or concerns.

DISTRICT	TOWN	ROUTE
5	WILLISTON	Maj-0332

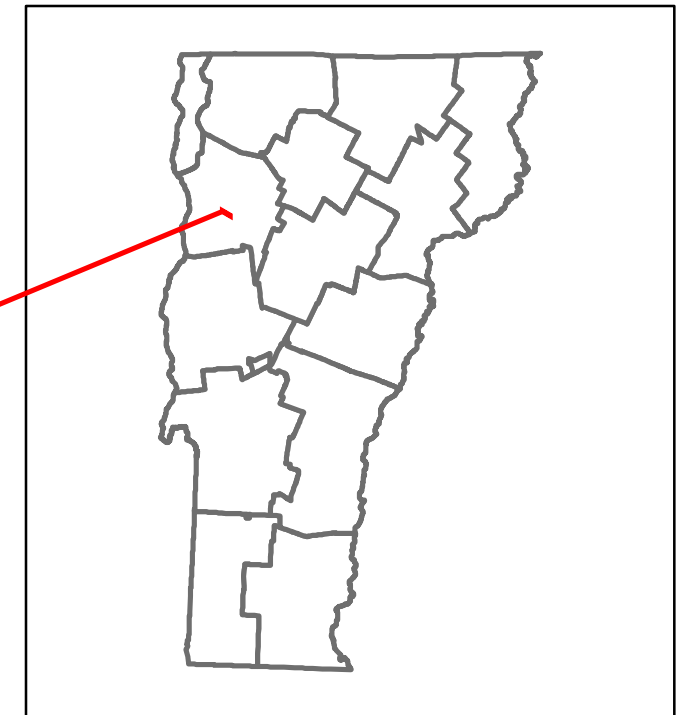

Maj-0332

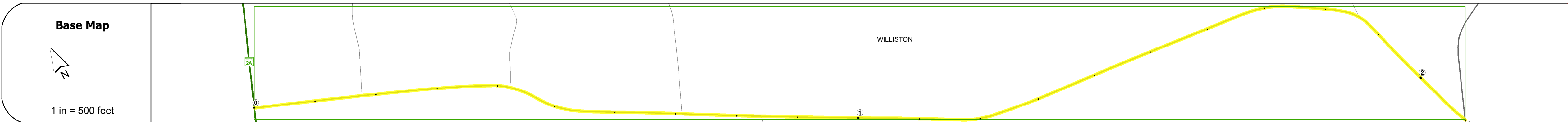

STRUCTURE DESCRIPTIONS

Road Widths	Travellane	Roadway	Lane Count	Base	Subbase
			24		
			24		
			2		

Curves	
---------------	--

Grades	
---------------	--

Guardrails	
-------------------	--

Rumblestrips	
---------------------	--

Historic Projects	
--------------------------	--

Maintenance Garage	
---------------------------	--

Speed Zone	
-------------------	--

Functional Class	5
-------------------------	---

National Highway System	
--------------------------------	--

Limited Access Highway	
-------------------------------	--

Customer Service Level	
-------------------------------	--

Traffic Counters	
-------------------------	--

AAADT	2021	3390
	2020	2991
	2019	3531
	2018	3600
	2017	3600

Crash Locations	(Incomplete) 2022	
	2021	
	2020	
	2019	
	2018	

Historic Projects Unknown, Retreatment, Resurface, Bituminous Mix, Skiny Mix, Bituminous Seal, Bituminous Concrete, Cold Plane and Bituminous Concrete, Reclaimed Base and Bituminous Concrete, Surface Treated Gravel, Plant Mix, Bituminous Concrete	Functional Class 1- Interstate System, 2- Other Freeways and Expressways, 3- Principal Arterial, 4- Minor Arterial, 5- Major Collector, 6- Minor Collector	Curves Left (degrees), Right (degrees), Grades (degrees) grade up, (degrees) grade down	Traffic Counters Continuous (CTC), Weigh-In-Motion (WIM), Short-Term, Scheduled, Short-Term, Unscheduled (counter ID)	Crash Locations Fatal, Injury, Property Damage Only, Unknown Crash Type, High Crash Locations (HCL's) Sections (& Intersections)	Mileage by Functional Class By Sheet 0332 5 - Major Collector 2.100	Mileage by Town By Sheet WILLISTON - S03320417 2.1 of 2.1	DISTRICT 5	TOWN WILLISTON	Date: 10/03/22	ROUTE Maj-0332
					Page Total Mileage: 2.100 mi	Page Total Mileage: 2.1 mi	1 of 1 TWN mileage: 0.0 to 2.1	ETE mileage: 0.0 to 2.1		

For More Information Contact - Vermont Agency of Transportation, Policy, Planning and Intermodal Development Division - Mapping Section, 219 North Main Street, Barre, VT 05641 Telephone: 802-828-2600.