



# Route Log and Progress Chart

**DRAFT**

Please Note: Errors and Omissions May Exist.  
Contact the VTrans Mapping Section with questions or concerns.

DISTRICT	TOWN	ROUTE
4	WINDSOR	Maj-0152

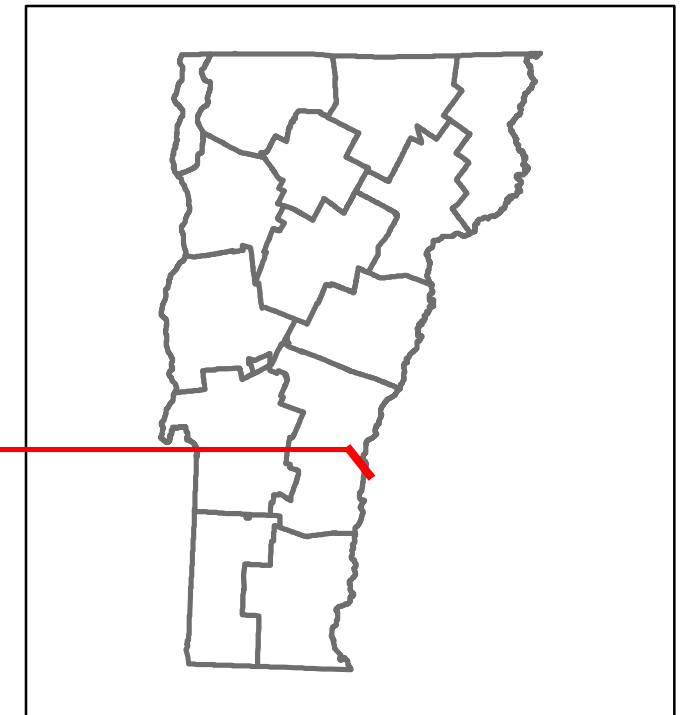

**Maj-0152**

**Base Map**

1 in = 2,000 feet

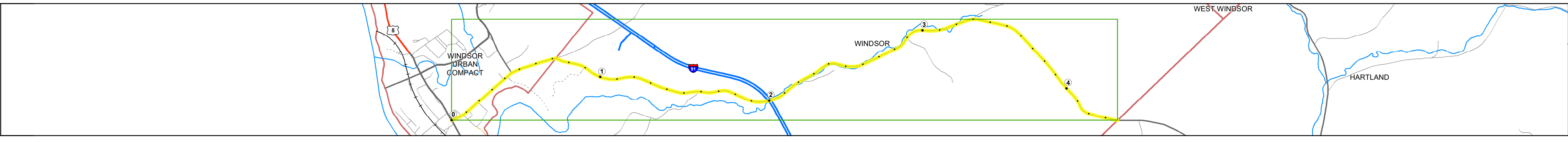

**Stick Diagram**

- Town Center
- Intersecting State Routes (excl. ramps/approaches)
- Other Intersecting Highways, Ramps, Approaches
- Railroad Crossings
- Primary Structures
- Secondary Structures
- Divided State Highway
- State Highway
- Divided Town Highway
- Town Highway
- Streams (Hydraulic Structure)
- Town Boundary
- Village/IC Boundaries
- District Boundaries
- State/Town Highway Change
- Divided Highway Limits
- Ghost Section Boundary
- Federal Urban Area Limits

Scale: **1 INCH = 2,000 FEET**

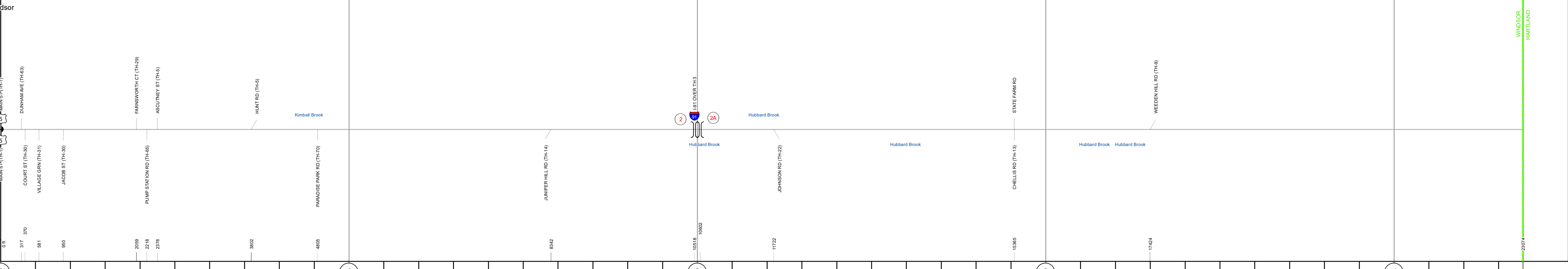

## STRUCTURE DESCRIPTIONS

**Unknown 2:**  
Unknown  
Structure No: 200091035N14232  
Structure Type: Unknown  
Features Intersected: 1 91 OVER TH 3  
Maintenance/Ownership: State

**Unknown 2A:**  
Unknown  
Structure No: 200091035S14232  
Structure Type: Unknown  
Features Intersected: 1 91 OVER TH 3  
Maintenance/Ownership: State

<b>Road Widths</b>	Travellane: 22, 22, 24, 24, 22, 24, 24, 22, 24, 23
Roadway	22, 22, 24, 24, 22, 24, 24, 22, 24, 23
Lane Count	2, 2, 2, 2, 2, 2, 2, 2, 2, 2
Base	18" Gravel
Subbase	

<b>Curves</b>	8, 5
---------------	------

<b>Grades</b>	
---------------	--

<b>Guardrails</b>	
-------------------	--

<b>Rumblestrips</b>	
---------------------	--

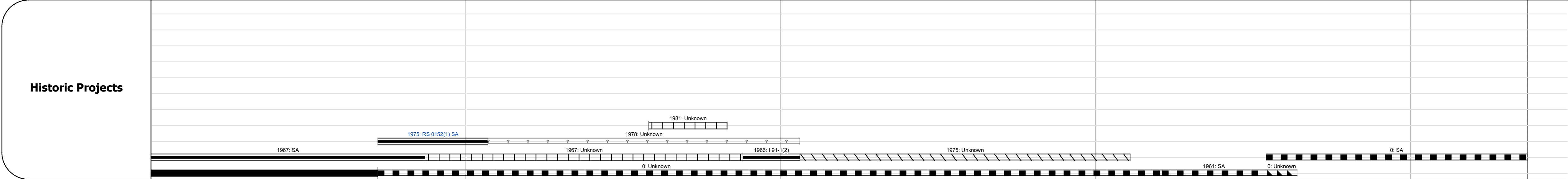

<b>Maintenance Garage</b>	
---------------------------	--

<b>Speed Zone</b>	
-------------------	--

<b>Functional Class</b>	5
-------------------------	---

<b>National Highway System</b>	
--------------------------------	--

<b>Limited Access Highway</b>	
-------------------------------	--

<b>Customer Service Level</b>	
-------------------------------	--

<b>Traffic Counters</b>	Y234, Y245
-------------------------	------------

<b>AADT</b>	2021: 2808, 1986, 668
	2020: 2478, 1753, 589
	2019: 3142, 2458, 695
	2018: 3200, 2500, 690
	2017: 3200, 2500, 700

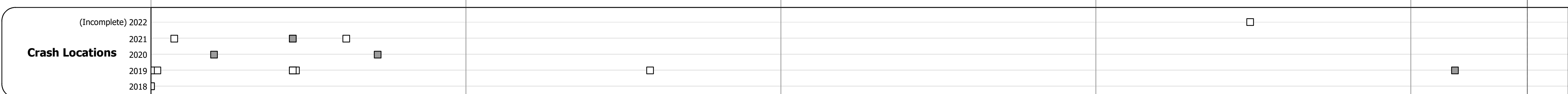

<p><b>Historic Projects</b></p> <ul style="list-style-type: none"> <li>Unknown</li> <li>Retreatment</li> <li>Resurface</li> <li>Bituminous Mix</li> <li>Skinny Mix</li> <li>Bituminous Seal</li> </ul>	<p><b>Functional Class</b></p> <ul style="list-style-type: none"> <li>1 - Interstate System</li> <li>2 - Other Freeways and Expressways</li> <li>3 - Principal Arterial</li> <li>4 - Minor Arterial</li> <li>5 - Major Collector</li> <li>6 - Minor Collector</li> </ul>	<p><b>Curves</b></p> <ul style="list-style-type: none"> <li>Left (dogleg)</li> <li>Right</li> </ul>	<p><b>Grades</b></p> <ul style="list-style-type: none"> <li>Left (dogleg)</li> <li>Right</li> </ul>	<p><b>Traffic Counters</b></p> <ul style="list-style-type: none"> <li>Continuous (CTC)</li> <li>Weight-In-Motion (WIM)</li> <li>Short-Term, Scheduled</li> <li>Short-Term, Unscheduled</li> </ul>	<p><b>Crash Locations</b></p> <ul style="list-style-type: none"> <li>Fatal</li> <li>Injury</li> <li>Property Damage Only</li> <li>Unknown Crash Type</li> </ul>	<p><b>Mileage by Functional Class By Sheet</b></p> <p>0152 5 - Major collector 4.370</p>	<p><b>Mileage by Town By Sheet</b></p> <p>WINDSOR - S01521423 4.37 of 4.37</p>	<p><b>DISTRICT</b></p> <p>4</p>	<p><b>TOWN</b></p> <p>WINDSOR</p>	<p><b>Date:</b> 10/03/22</p>	<p><b>ROUTE</b></p> <p>Maj-0152</p>	<p><b>ETE mileage:</b></p> <p>0.0 to 4.37</p>
--	--	---	---	---	---	--	--	---------------------------------	-----------------------------------	------------------------------	-------------------------------------	---