



Route Log and Progress Chart

DRAFT

Please Note: Errors and Omissions May Exist.
Contact the VTrans Mapping Section with questions or concerns.

DISTRICT	TOWN	ROUTE
3	POULTNEY	Maj-0138

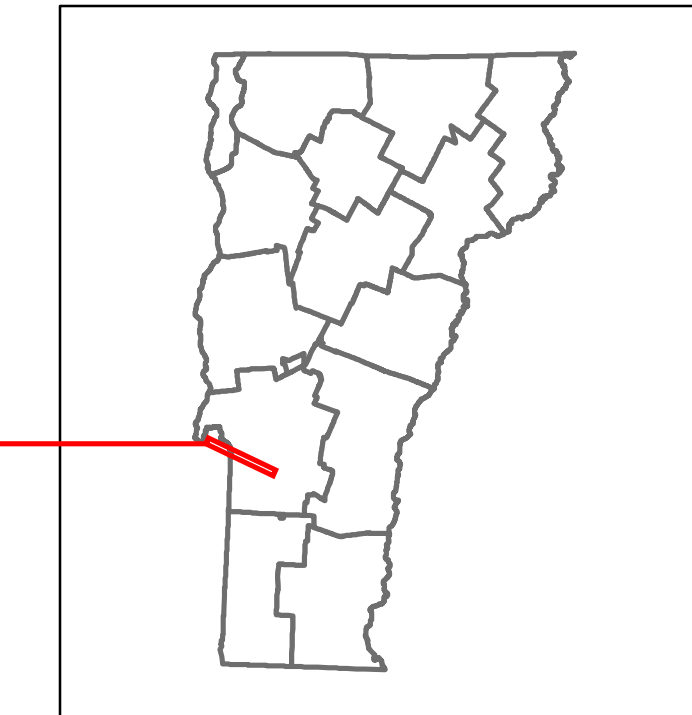

Base Map

1 in = 0.8 miles

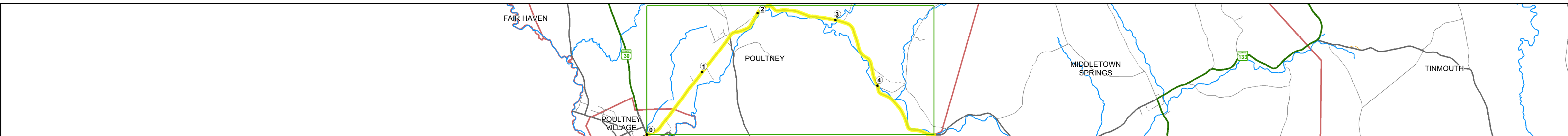

Stick Diagram

- Town Center
- Intersecting State Routes (excl. ramps/approaches)
- Other Intersecting Highways, Ramps, Approaches
- Railroad Crossings
- Primary Structures
- Secondary Structures
- Divided State Highway
- State Highway
- Divided Town Highway
- Town Highway
- Streams (Hydraulic Structure)
- Town Boundary
- Village/IC Boundaries
- District Boundaries
- State/Town Highway Change
- Divided Highway Limits
- Ghost Section Boundary
- Federal Urban Area Limits

Scale: 1 INCH = 2,000 FEET

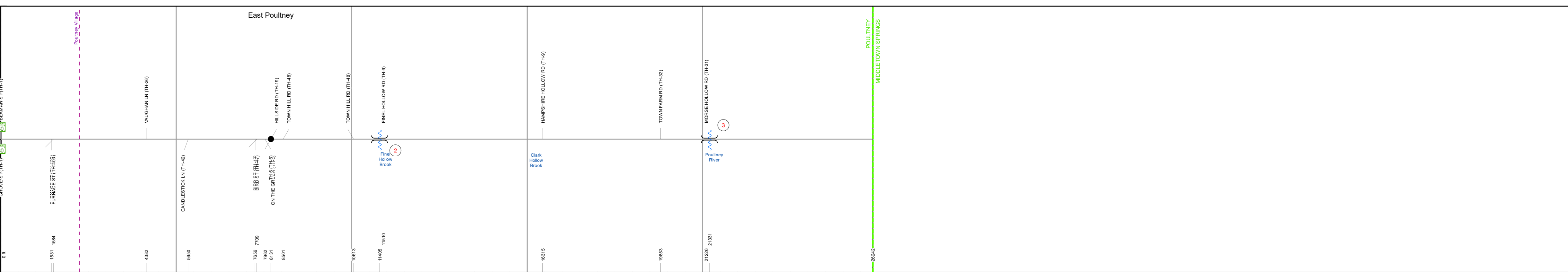

STRUCTURE DESCRIPTIONS

Bridge 2:
Culvert - 2019
Structure No. 200138000211172
Length: 37'
Height: 5.33'
Facility Carried: TR 02 FAS 138
Structure Type: PRECAST RIGID FRAME
Features Intersected: FINEL HOLLOW BROOK
Maintenance/Ownership: Town

Bridge 3:
I-beam - 1934
Structure No. 200138000311172
Length: 54'
Height: 5.33'
Width: 2.0'
Facility Carried: TR 02 FAS 138
Structure Type: CONCRETE T-BEAM
Features Intersected: POULTNEY RIVER
Surface: Bituminous
Maintenance/Ownership: Town

Road Widths	Travellane: 30, 30, 28, 28, 28, 22
Roadway	30, 30, 28, 28, 28, 22
Lane Count	2, 2
Base	
Subbase	

Curves	
---------------	--

Grades	
---------------	--

Guardrails	
-------------------	--

Rumblestrips	
---------------------	--

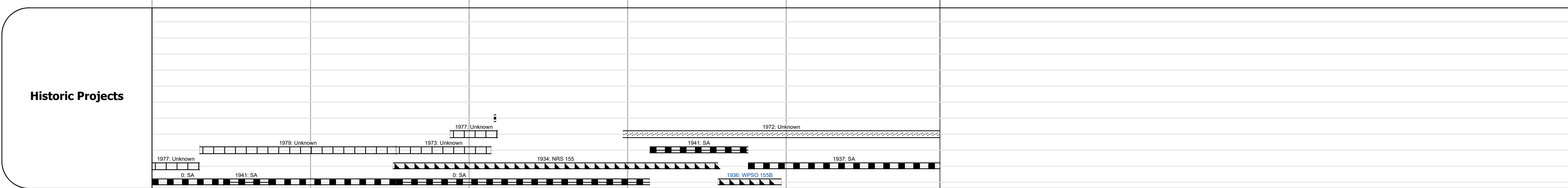

Maintenance Garage	
---------------------------	--

Speed Zone	
-------------------	--

Functional Class	5
-------------------------	---

National Highway System	
--------------------------------	--

Limited Access Highway	
-------------------------------	--

Customer Service Level	
-------------------------------	--

Traffic Counters	
-------------------------	--

AADT	2021: 2221, 2149, 2537, 2600, 2600	2020: 2221, 2149, 2537, 2600, 2600	2019: 2221, 2149, 2537, 2600, 2600	2018: 2221, 2149, 2537, 2600, 2600	2017: 2221, 2149, 2537, 2600, 2600
-------------	------------------------------------	------------------------------------	------------------------------------	------------------------------------	------------------------------------

Crash Locations	(Incomplete) 2022, 2021, 2020, 2019, 2018
------------------------	---

<p>Historic Projects</p> <ul style="list-style-type: none"> Unknown Retreatment Resurface Bituminous Mix Skinny Mix Bituminous Seal <p>Indicated plans available - http://vtransmap01.aot.state.vt.us/p/dcr/D/webstore/</p>	<p>Functional Class</p> <ul style="list-style-type: none"> 1 - Interstate System 2 - Other Freeways and Expressways 3 - Principal Arterial 4 - Minor Arterial 5 - Major Collector 6 - Minor Collector <p>Speed Zones</p> <p>25 30 35 40 45 50 55 60 65</p>	<p>Curves</p> <ul style="list-style-type: none"> Left (clockwise) Right (counter-clockwise) <p>Grades</p> <ul style="list-style-type: none"> down grade up down grade down <p>Road Widths</p> <p>(ft)</p>	<p>Traffic Counters</p> <ul style="list-style-type: none"> Continuous (CTC) Weight-In-Motion (WIM) Short-Term, Scheduled Short-Term, Unscheduled <p>Crash Locations</p> <ul style="list-style-type: none"> Fatal Injury Property Damage Only Unknown Crash Type <p>High Crash Locations (HCL's)</p> <p>Sections (& Intersections)</p> <p>HCL No. 1 - 100 (1 - 10), 201 - 300 (21 - 30), 401 - 500 (41 - 50), 601 - 700 (51 - 60), 801 - 900 (61 - 70)</p>	<p>Mileage by Functional Class By Sheet</p> <p>0138 5 - Major collector 4.970</p>	<p>Mileage by Town By Sheet</p> <p>POULTNEY - S01381117 4.97 of 4.97</p>	<p>DISTRICT</p> <p>3</p>	<p>TOWN</p> <p>POULTNEY</p>	<p>Date: 10/02/22</p>	<p>ROUTE</p> <p>Maj-0138</p> <p>ETE mileage: 0.0 to 4.97</p>
				<p>Page Total Mileage: 4.970 mi</p>		<p>Page Total Mileage: 4.97 mi</p>		<p>1 of 1</p> <p>TWN mileage: 0.0 to 4.97</p>	

For More Information Contact - Vermont Agency of Transportation, Policy, Planning and Intermodal Development Division - Mapping Section, 219 North Main Street, Barre, VT 05641 Telephone: 802-828-2600.