



# Route Log and Progress Chart

**DRAFT**

Please Note: Errors and Omissions May Exist. Contact the VTrans Mapping Section with questions or concerns.

DISTRICT	TOWN	ROUTE
8	SAINT ALBANS TOWN	Min-0787

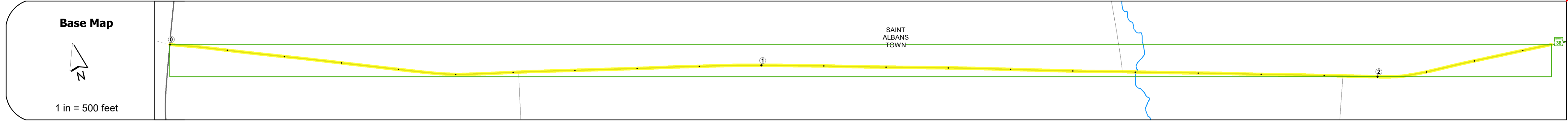
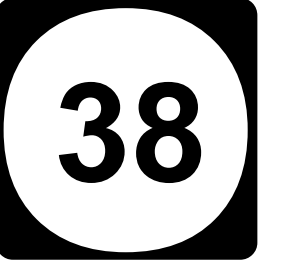
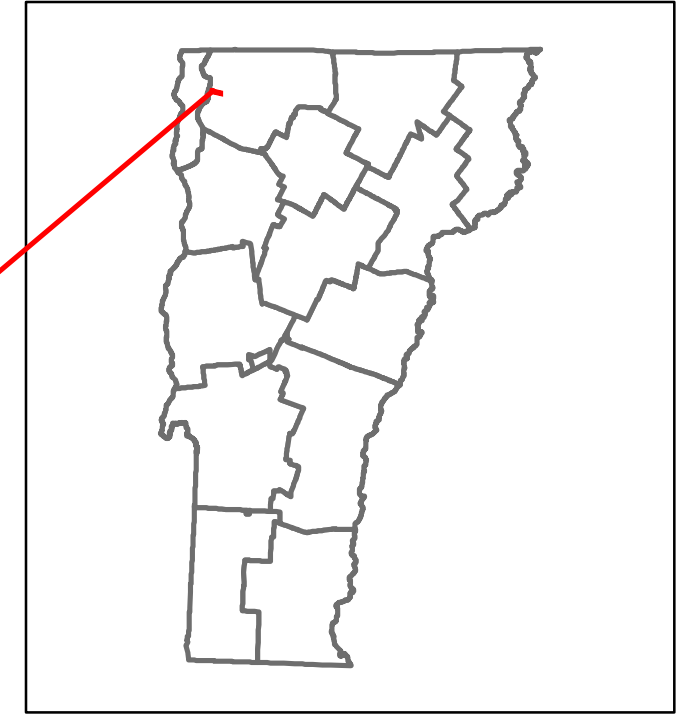

## STRUCTURE DESCRIPTIONS

<b>Road Widths</b>	Travellane Roadway Lane Count Base Subbase	0-22 22-24 24-26	22 22 2
<b>Curves</b>			
<b>Grades</b>			
<b>Guardrails</b>			
<b>Rumblestrips</b>			
<b>Historic Projects</b>			
<b>Maintenance Garage</b>			
<b>Speed Zone</b>			
<b>Functional Class</b>		6	
<b>National Highway System</b>			
<b>Limited Access Highway</b>			
<b>Customer Service Level</b>			
<b>Traffic Counters</b>			
<b>AADT</b>	2020 2019 2018 2017 2016		
<b>Crash Locations</b>	(Incomplete) 2021 2020 2019 2018 2017		

<b>STRUCTURE DESCRIPTIONS</b>
-------------------------------

<b>Historic Projects</b> Bituminous Concrete Retreatment Resurface Bituminous Mix Skippy Mix Bituminous Seal Surface Treated Gravel Cold Plane and Bituminous Concrete Reclaimed Base and Bituminous Concrete Concrete Gravel	<b>Functional Class</b> 1 - Interstate System 2 - Other Freeways and Expressways 3 - Principal Arterial 4 - Minor Arterial 5 - Major Collector 6 - Minor Collector	<b>Curves</b> Left (degrees) Right <b>Grades</b> Left (percent) Right grade up grade down	<b>Traffic Counters</b> Continuous (CTC) Weigh-In-Motion (WIM) Short-Term, Scheduled (counter ID) Short-Term, Unscheduled	<b>Crash Locations</b> High Crash Locations (HCL's) Sections (& Intersections) 1-100 (1-10) 101-200 (11-20) 201-300 (21-30) 301-400 (31-40) 401-800 (41-113)	<b>Mileage by Functional Class By Sheet</b> 0787 6 - minor collector 2.360	<b>Mileage by Town By Sheet</b> SAINT ALBANS TOWN - S07870613 2.36 of 2.36	<b>DISTRICT</b> 8	<b>TOWN</b> SAINT ALBANS TOWN	Date: 11/19/21 <b>ROUTE</b> Min-0787 ETE mileage: 0.0 to 2.36
--	--	--	---	---	---	---	----------------------	----------------------------------	--

For More Information Contact - Vermont Agency of Transportation, Policy, Planning and Intermodal Development Division - Mapping Section, 1 National Life Drive, Montpelier, VT 05633-5001 Telephone: 802-828-2600.