



Route Log and Progress Chart

DRAFT

Please Note: Errors and Omissions May Exist.
Contact the VTrans Mapping Section with questions or concerns.

DISTRICT	TOWN	ROUTE
7	BARNET	Maj-0215

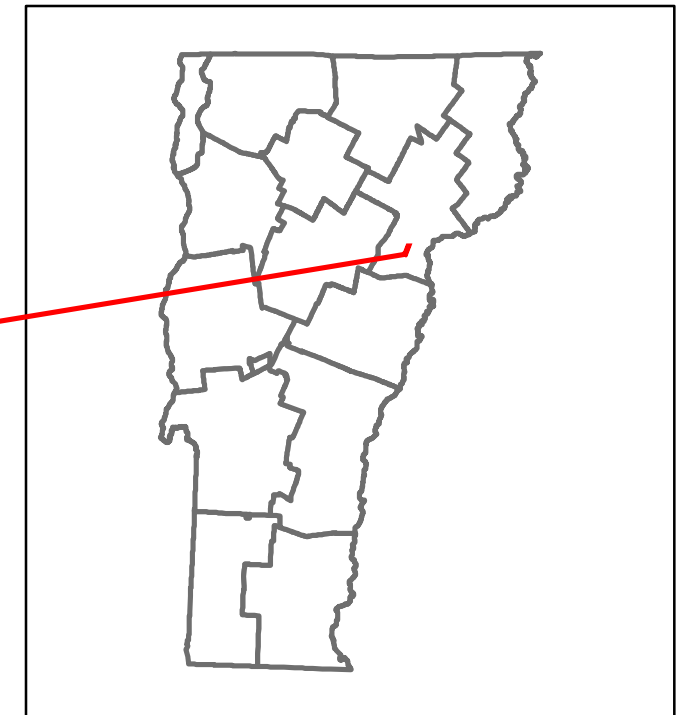

Maj-0215

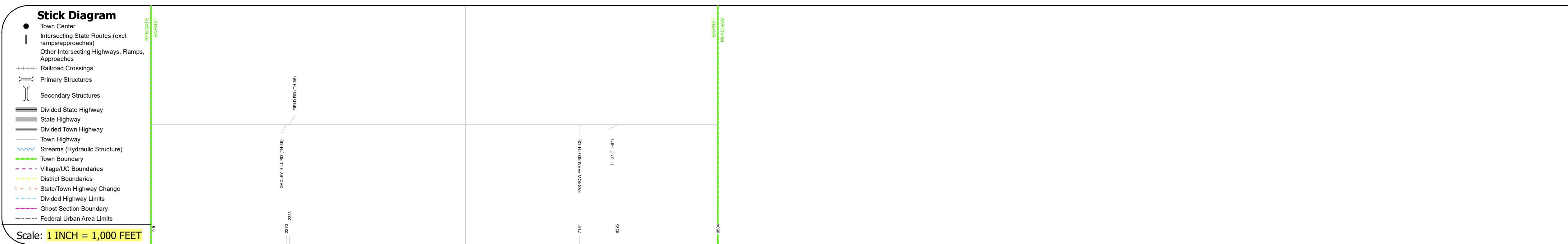
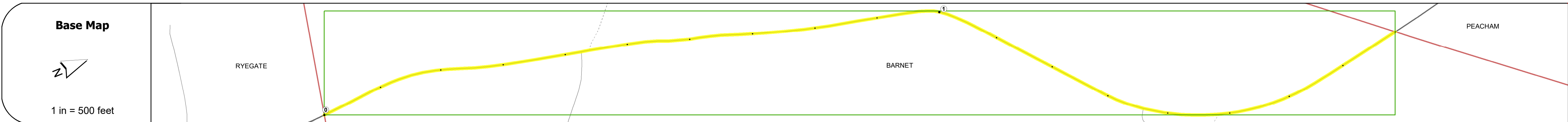

STRUCTURE DESCRIPTIONS

Road Widths	Travellane: 22'	Roadway: 22'	Lane Count: 2	Base: 18' Gravel	Subbase: 18' Gravel
--------------------	-----------------	--------------	---------------	------------------	---------------------

Curves	
---------------	--

Grades	
---------------	--

Guardrails	
-------------------	--

Rumblestrips	
---------------------	--

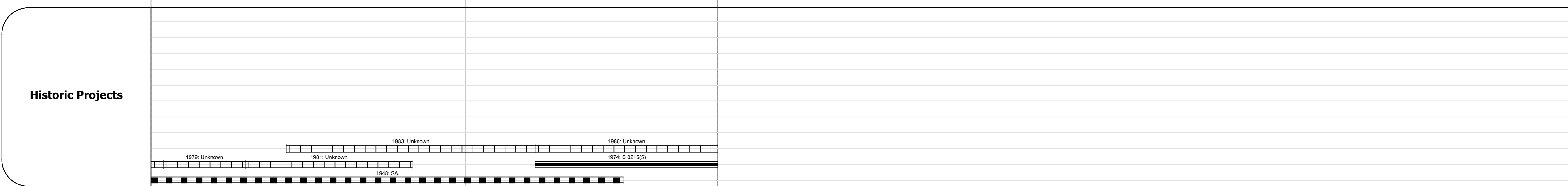

Maintenance Garage	
---------------------------	--

Speed Zone	
-------------------	--

Functional Class	5 - Major Collector
-------------------------	---------------------

National Highway System	
--------------------------------	--

Limited Access Highway	
-------------------------------	--

Customer Service Level	
-------------------------------	--

Traffic Counters	CT188
-------------------------	-------

AADT	2018: 290	2017: 290	2016: 277	2015: 263	2014: 250	310	310	310	310	310
-------------	-----------	-----------	-----------	-----------	-----------	-----	-----	-----	-----	-----

Crash Locations	2018	2017	2016	2015	2014
------------------------	------	------	------	------	------

Historic Projects Unknown, Bituminous Concrete, Retreatment, Resurface, Bituminous Mix, Skiny Mix, Bituminous Seal, Surface Treated Gravel, Plant Mix, Reclaimed Base and Bituminous Concrete	Functional Class 1- Interstate System, 2- Other Freeways and Expressways, 3- Principal Arterial, 4- Minor Arterial, 5- Major Collector, 6- Minor Collector	Curves Left (degrees), Right (degrees), Grades (percent) grade up, (percent) grade down	Traffic Counters Continuous (CTC), Weigh-In-Motion (WIM), Short-Term, Scheduled, Short-Term, Unscheduled	Crash Locations Fatal, Injury, Property Damage Only, Unknown Crash Type, High Crash Locations (HCL's)	Mileage by Functional Class By Sheet 0215 5 - Major Collector 1.800	Mileage by Town By Sheet BARNET - S02150301 1.8 of 1.8	DISTRICT 7	TOWN BARNET	Date: 12/05/19	ROUTE Maj-0215 ETE mileage: 4.86 to 6.66
Page Total Mileage: 1.800 mi						Page Total Mileage: 1.8 mi				

For More Information Contact - Vermont Agency of Transportation, Policy, Planning and Intermodal Development Division - Mapping Section, 1 National Life Drive, Montpelier, VT 05633-5001 Telephone: 802-828-2600.