



Route Log and Progress Chart

DRAFT

Please Note: Errors and Omissions May Exist.
Contact the VTrans Mapping Section with questions or concerns.

DISTRICT	TOWN	ROUTE
9	DERBY	Maj-0319

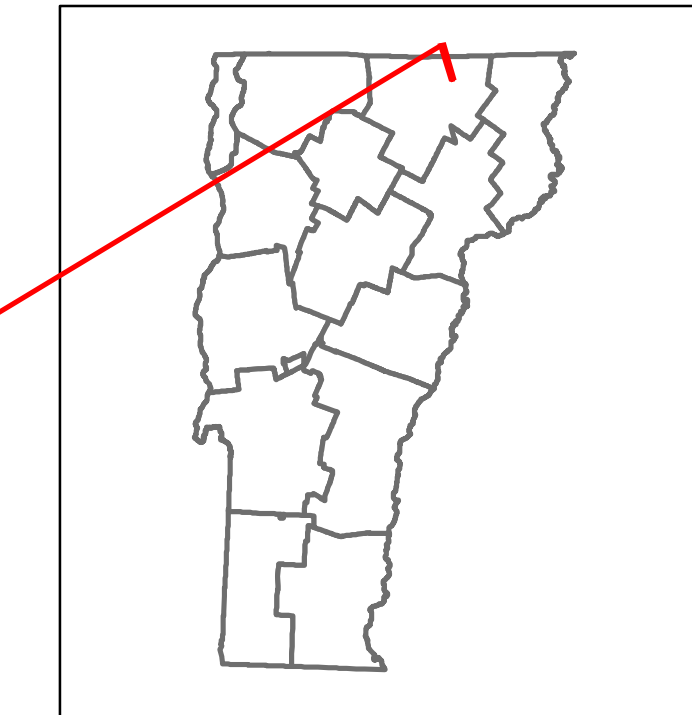

Maj-0319

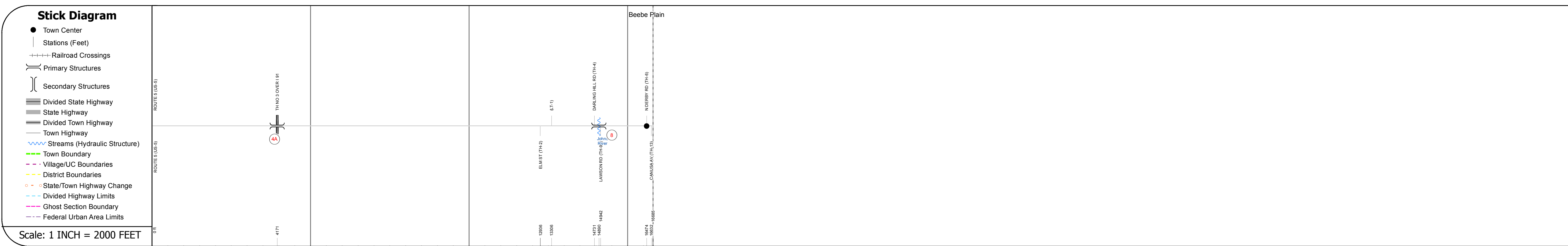
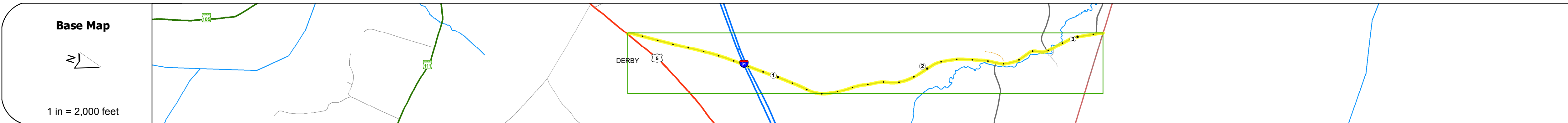

STRUCTURE DESCRIPTIONS

Bridge 4A:
Stringer/multi-beam or girder - 1963
Structure No: 200319004A10072
Length: 344'
Width: 30.0'
Under Clearance: 17.58'
Facility Carried: TR 03 FAS 319
Bridge Type: 5 SP ROLLED BM
Features Intersected: TH NO 3 OVER I 91
Surface: Bituminous
Maintenance/Ownership: State

Bridge 8:
Slab - 1989
Structure No: 101007000810071
Length: 26'
Width: 34.0'
Facility Carried: C2003 BYPASS
Bridge Type: CONCRETE SLAB
Features Intersected: JOHNS RIVER
Surface: Bituminous
Maintenance/Ownership: Town

Road Widths	Travellane	22	20
Roadway	24	22	
Lane Count		2	
Base			
Subbase			

Curves	
---------------	--

Grades	
---------------	--



Maintenance Garage	
---------------------------	--

Speed Zone	
-------------------	--

Functional Class	5
-------------------------	---

National Highway System	
--------------------------------	--

Limited Access Highway	
-------------------------------	--

Traffic Counters	P228	P220
-------------------------	------	------

AADT Counts	2014	720	1000	810
	2013	720	1000	790
	2012	720	1100	770
	2011	720	1100	750
	2010	730	1200	800

Crash Locations	2014			
	2013			
	2012			
	2011			
	2010			

Historic Projects Unknown, Retreatment, Resurface, Bituminous Mix, Skinny Mix, Bituminous Seal Bituminous Concrete, Surface Treated, Gravel, Cold Plane and, Bituminous Concrete, Concrete, Reclaimed Base and Bituminous Concrete	Functional Class 1- Interstate System, 2- Other Freeways and Expressways, 3- Principal Arterial, 4- Minor Arterial, 5- Major Collector, 6- Minor Collector	Curves Left (degrees), Right Grades grade up, grade down	Road Widths (ft) Traffic Counters (counter ID)	AADT (count) Crash Locations Fatal, Injury, Property Damage Only, Unknown Crash Type	Mileage by Functional Class By Sheet 0319 5 - Major collector 3.160 Page Total Mileage: 3.160 mi	Mileage by Town By Sheet DERBY - S03191007 3.16 of 3.16 Page Total Mileage: 3.16 mi	DISTRICT 9	TOWN DERBY	Date: 11/11/16 1 of 1 TWN mileage: 0.0 to 3.16 ETE mileage: 0.0 to 3.16	ROUTE Maj-0319 ETE mileage: 0.0 to 3.16
---	--	---	---	---	--	---	----------------------	----------------------	--	--

For More Information Contact - Vermont Agency of Transportation, Policy, Planning and Intermodal Development Division - Mapping Section, 1 National Life Drive, Montpelier, VT 05633-5001 Telephone: 802-828-2600.