



# Route Log and Progress Chart

DRAFT

Please Note: Errors and Omissions May Exist.  
Contact the VTrans Mapping Section with questions or concerns.

DISTRICT	TOWN	ROUTE
2, 4	WEATHERSFIELD, WINDSOR, SPRINGFIELD	I-91

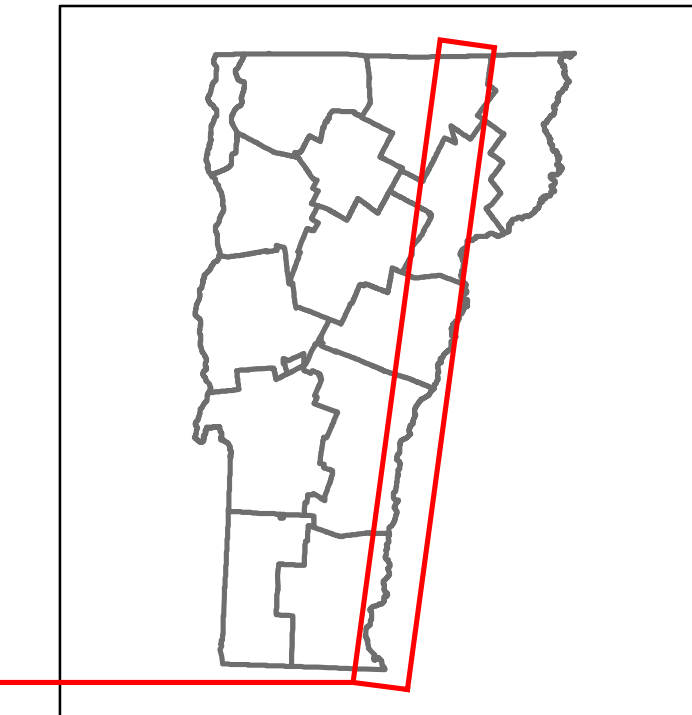

**Base Map**

1 in = 7 miles

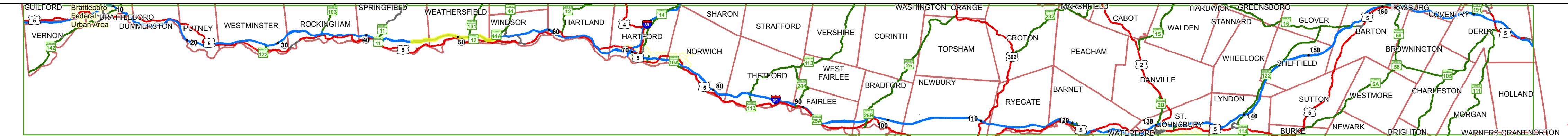

**Stick Diagram**

- Town Center
- Stations (Feet)
- Railroad Crossings
- Primary Structures
- Secondary Structures
- Divided State Highway
- State Highway
- Divided Town Highway
- Town Highway
- Streams (Hydraulic Structure)
- Town Boundary
- Village/UC Boundaries
- District Boundaries
- State/Town Highway Change
- Divided Highway Limits
- Ghost Section Boundary
- Federal Urban Area Limits

Scale: 1 INCH = 2000 FEET

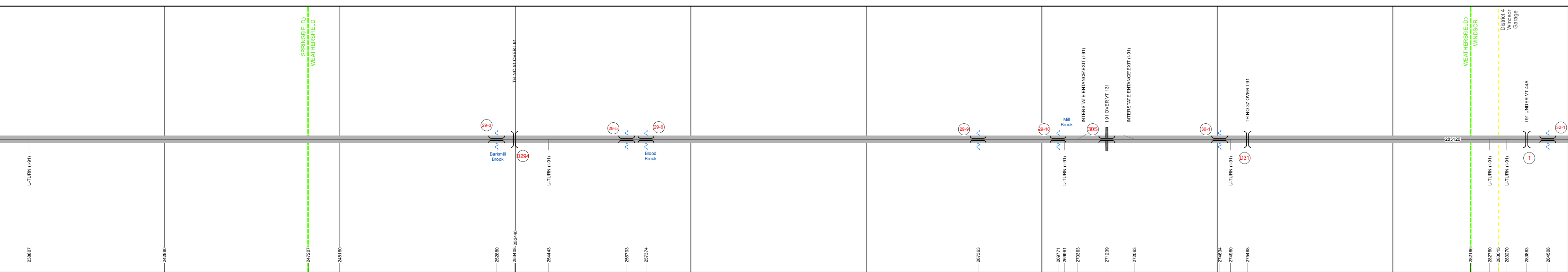

**Road Widths**

Travellane  
Roadway  
Lane Count  
Base  
Subbase

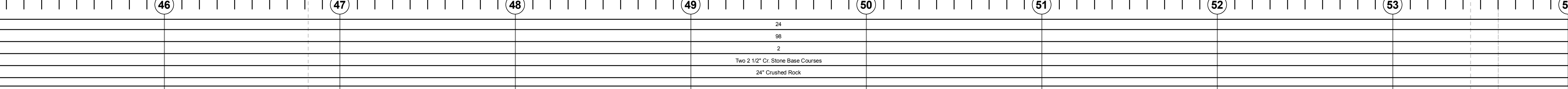

**Curves**

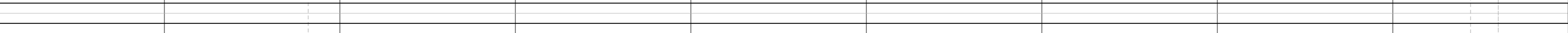

**Grades**

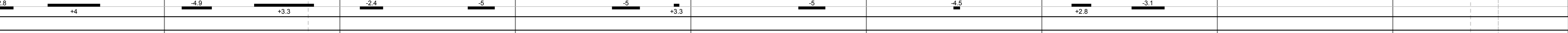

**Historic Projects**

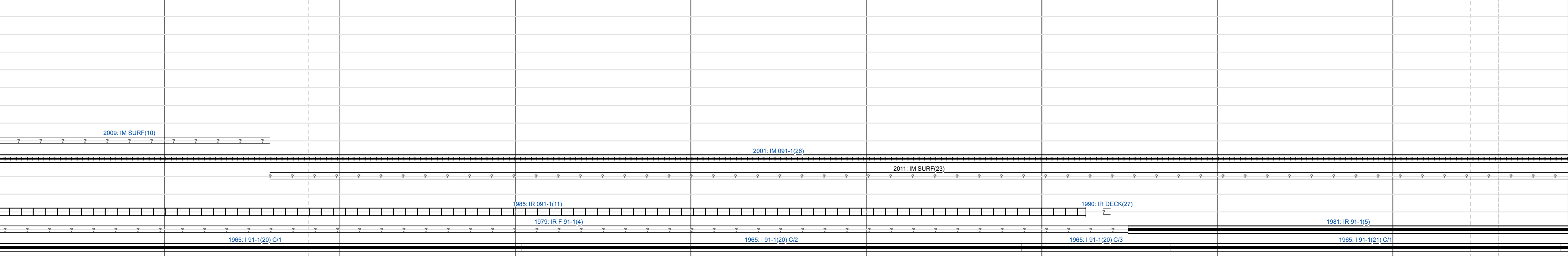

**Maintenance Garage**

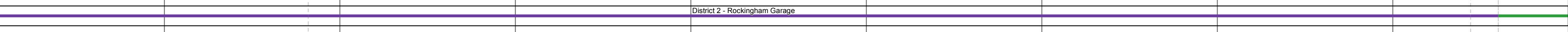

**Speed Zone**

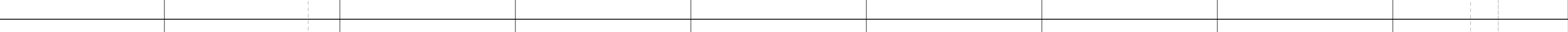

**Functional Class**

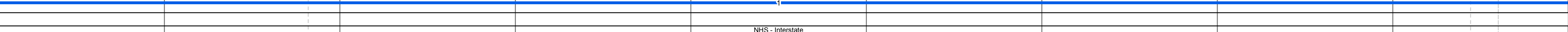

**National Highway System**

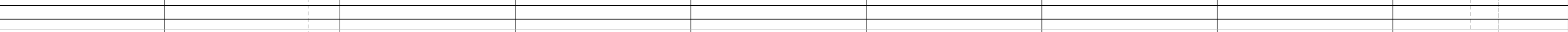

**Traffic Counters**



**AADT Counts**

2014  
2013  
2012  
2011  
2010



**Crash Locations**

2014  
2013  
2012  
2011  
2010

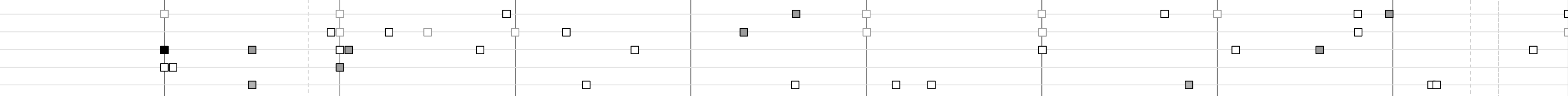

## STRUCTURE DESCRIPTIONS

<p><b>Culvert 29-3:</b> Culvert - 1965 Structure No. 30009129-314201 Length: 9' Under Clearance: 10.0' Facility Carried: I91 Bridge Type: MULTI PLATE/SLEEVE Features Intersected: BROOK Maintenance: State</p>	<p><b>Bridge 32-1:</b> Culvert - 1966 Structure No. 30009132-114231 Length: 6' Under Clearance: 6.5' Facility Carried: I91 Bridge Type: CGMPP Features Intersected: BROOK Maintenance: State</p>
<p><b>Bridge D29-4:</b> Stringer/multi-beam or girder - 1965 Structure No. 201420D29414201 Length: 279' Width: 24.0' Under Clearance: 17.25' Facility Carried: TR 0TH51 Bridge Type: 5 SPN CONT ROLLED BM Features Intersected: TH NO 51 OVER I 91 Maintenance/Ownership: State</p>	
<p><b>Culvert 29-5:</b> Culvert - 1965 Structure No. 30009129-514201 Length: 6' Under Clearance: 6.5' Facility Carried: I91 Bridge Type: CGMPP Features Intersected: BROOK Maintenance: State</p>	
<p><b>Culvert 29-6:</b> Culvert - 1965 Structure No. 30009129-614201 Length: 9' Under Clearance: 10.0' Facility Carried: I91 Bridge Type: CGMPP Features Intersected: BLOOD BROOK Maintenance: State</p>	
<p><b>Culvert 29-9:</b> Culvert - 1965 Structure No. 30009129-914201 Length: 6' Under Clearance: 6.0' Facility Carried: I91 Bridge Type: ACCGMP Features Intersected: CATTLEPASS Maintenance: State</p>	
<p><b>Culvert 29-10:</b> Culvert - 1965 Structure No. 200091291014202 Length: 21' Facility Carried: I 00091 ML Bridge Type: TWIN CELL RC BOX Features Intersected: MILL L BROOK Maintenance/Ownership: State</p>	
<p><b>Bridge 30S:</b> Stringer/multi-beam or girder - 1965 Structure No. 200091030S14202 Length: 219' Width: 30.0' Under Clearance: 15.08' Facility Carried: I 00091 ML Bridge Type: 3 SP CONT ROLLED BM Features Intersected: I 91 OVER VT 131 Surface: Bituminous Maintenance/Ownership: State</p>	
<p><b>Culvert 30-1:</b> Culvert - 1966 Structure No. 30009130-114201 Length: 8' Under Clearance: 8.5' Facility Carried: I91 Bridge Type: CGMPP Features Intersected: BROOK Maintenance: State</p>	
<p><b>Bridge D31:</b> Stringer/multi-beam or girder - 1965 Structure No. 201420D3114201 Length: 251' Width: 24.0' Under Clearance: 17.0' Facility Carried: TR 0TH37 Bridge Type: 4 SPAN ROLLED BEAM Features Intersected: TH NO 37 OVER I 91 Surface: Bituminous Maintenance/Ownership: State</p>	
<p><b>Bridge 1:</b> Stringer/multi-beam or girder - 1965 Structure No. 2014230D3214231 Length: 321' Width: 30.0' Under Clearance: 16.08' Facility Carried: VT 0044A Bridge Type: 4 SP ROLLED BEAM Features Intersected: I 91 UNDER VT 44A Surface: Bituminous Maintenance/Ownership: State</p>	

<p><b>Historic Projects</b></p> <ul style="list-style-type: none"> <li>Unknown</li> <li>Bituminous Seal</li> <li>Retreatment</li> <li>Resurface</li> <li>Bituminous Mix</li> <li>Bituminous Concrete</li> <li>Skimny Mix</li> <li>Gravel</li> <li>Surface Treated Gravel</li> <li>Plant Mix</li> <li>Reclaimed Base and Expressways</li> <li>Bituminous Concrete</li> </ul>	<p><b>Functional Class</b></p> <ul style="list-style-type: none"> <li>1 - Interstate System</li> <li>2 - Other</li> <li>3 - Principal Arterial</li> <li>4 - Minor Arterial</li> <li>5 - Major Collector</li> <li>6 - Minor Collector</li> </ul>	<p><b>Curves</b></p> <ul style="list-style-type: none"> <li>Left</li> <li>Right</li> </ul>	<p><b>Road Widths</b></p> <p>(ft)</p>	<p><b>AADT</b></p> <p>(count)</p>	<p><b>Crash Locations</b></p> <ul style="list-style-type: none"> <li>Fatal</li> <li>Injury</li> <li>Property Damage Only</li> <li>Unknown Crash Type</li> </ul>	<p><b>Mileage by Functional Class By Sheet</b></p> <p>91-1 1 - Interstate 9.000</p>	<p><b>Mileage by Town By Sheet</b></p> <p>ETE - I091-0000S 9.0 of 177.432</p>	<p><b>DISTRICT</b></p> <p>2, 4</p>	<p><b>TOWN</b></p> <p>WEATHERSFIELD, WINDSOR, SPRINGFIELD</p>	<p><b>Date: 10/26/16</b></p>	<p><b>ROUTE</b></p> <p>I-91</p> <p>ETE mileage: 45.0 to 54.0</p>
<p>Indicated plans available - <a href="http://vtransmap01.ad.state.vt.us/rp/cpr/D/webstore/">http://vtransmap01.ad.state.vt.us/rp/cpr/D/webstore/</a></p>						<p>Page Total Mileage: 9.000 mi</p>		<p>Page Total Mileage: 9.0 mi</p>		<p><b>6 of 20</b> TWN mileage: 45.0 to 54.0</p>	