



Route Log Progress Chart

DRAFT

Please Note: Errors and Omissions May Exist.
Contact the VTrans Mapping Unit with questions or concerns.

DISTRICT	TOWN	ROUTE
6	WOLCOTT	Maj-0324

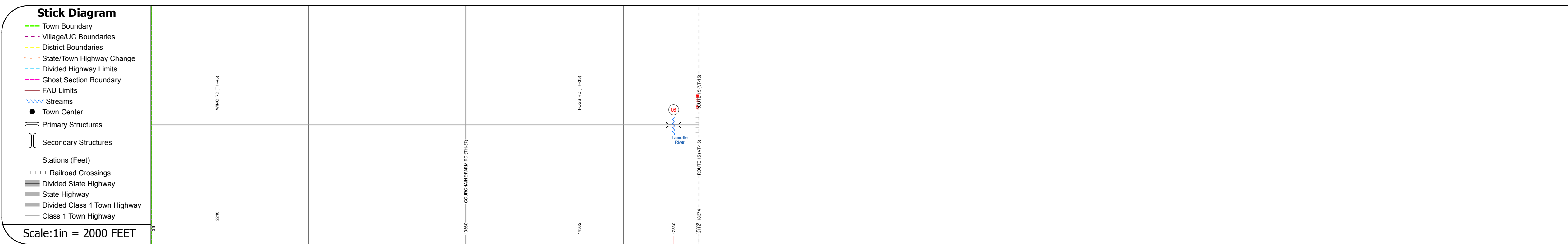
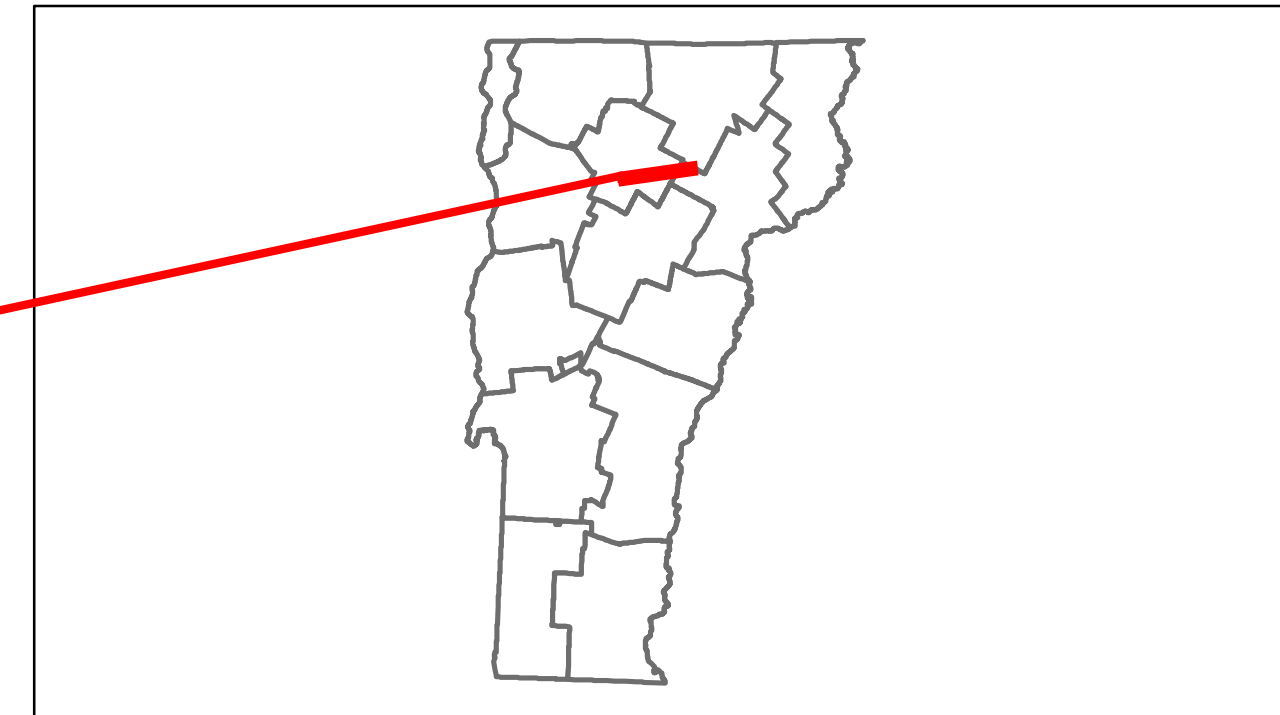

DESCRIPTION BLOCK
<p>Bridge 8: Stringer/multi-beam or girder - 1984 Structure No. 10081000808101 Length: 102' Width: 26.7' Weight Limit: 0 Facility Carried: C2004 Bridge Type: WELDED GIRDER Features Intersected: LAMOILLE RIVER Maintenance/Ownership: Town</p>

0	1	2	3
Road Widths			
Travellane		20	
Roadway		20	
Lane Count			
Base			
Subbase			
Curves			
Grades			
Historic Projects			
Maintenance Garage			
(Not State Maintained)			
Traffic Counters			
SRL 187			
Functional Class			
7			
Speed Zone			
AADT Counts			
2012		490	
2011		490	
2010		480	
2009		470	
2008		450	
Crash Locations			
2012			
2011			
2010			
2009			
2008			

Historic Projects Retirement, Resurface, Unknown, Bituminous Mix, Skippy Mix, Bituminous Seal, Bituminous Concrete, Surface Treated Gravel, Plant Mix, Reclaimed Base and Bituminous Concrete, Concrete	Functional Class 1, 2, 3, 4, 5, 6, 7, 8, 9, 10, 11, 12, 13, 14, 15, 16, 17, 18, 19	Curves curve left, curve right	Road Widths (ft)	AADT (count)	Mileage by Functional Class By Sheet 0324 7 - Rural - Major collector 3.480	Mileage by Town By Sheet WOLCOTT - S03240810 3.48 of 3.48	DISTRICT 6	TOWN WOLCOTT	Date: 04/01/14	ROUTE Maj-0324 ETE mileage: 0.4 to 3.88
					Total Mileage: 3.480 mi	Total Mileage: 3.48 mi	1 of 1 TWN mileage: 0.0 to 3.48			