



Route Log Progress Chart

DRAFT

Please Note: Errors and Omissions May Exist.
Contact the VTrans Mapping Unit with questions or concerns.

DISTRICT	TOWN	ROUTE
7	WATERFORD	Min-0738

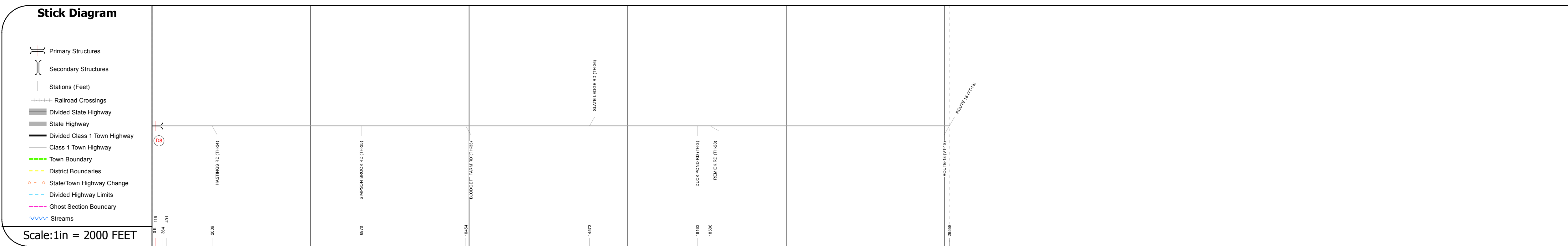
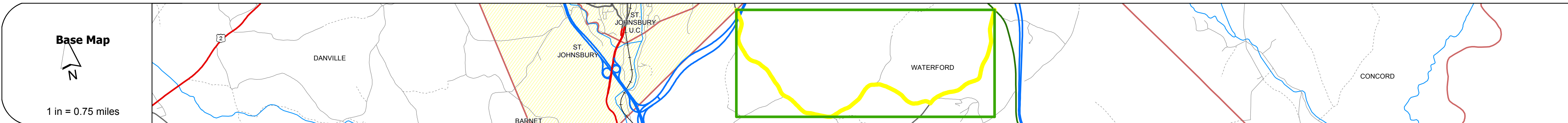
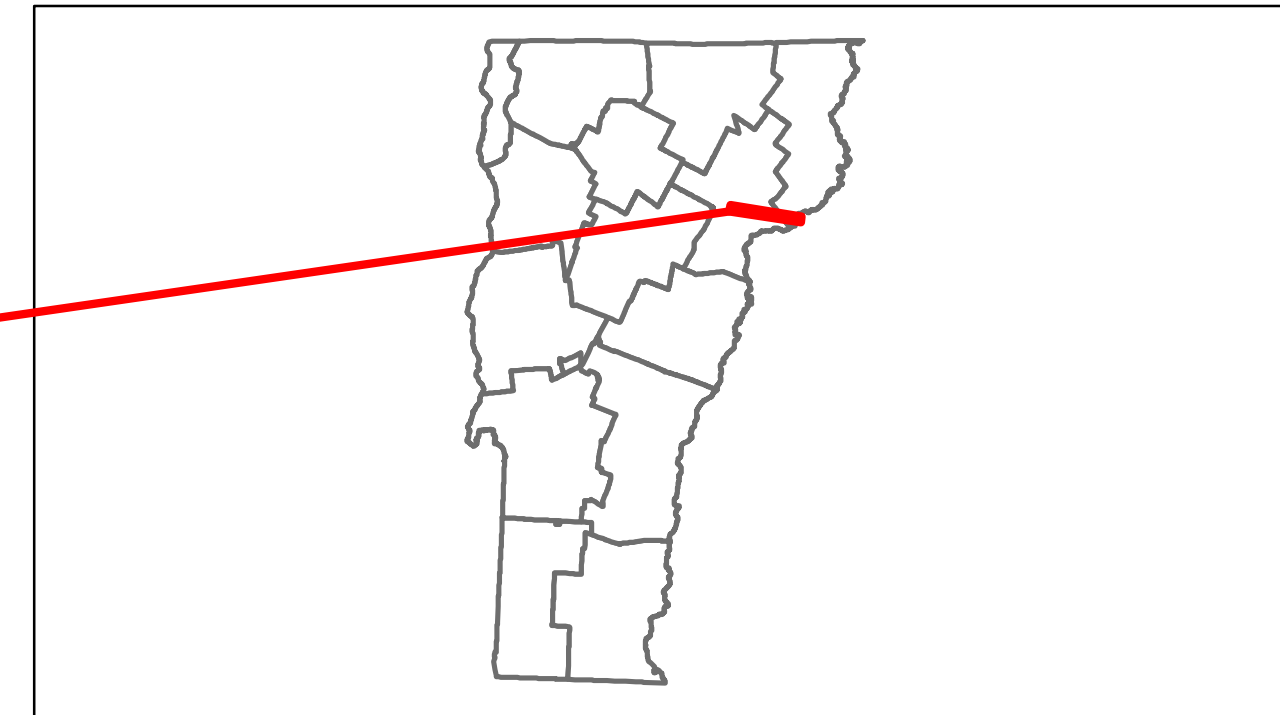

DESCRIPTION BLOCK

Bridge D8:
 Stringer/multi-beam or girder - 1982
 Structure No: 20031600D803161
 Length: 306'
 Width: 30.0'
 Under Clearance: 16.58'
 Facility Carried: TR 00TH4
 Bridge Type: 2 SP CONT WLD PL GIR
 Features Intersected: TH NO 4 OVER I 93
 Surface: Epoxy overlay
 Maintenance/Ownership: State

Road Widths	Travellane								
	Roadway								
	Lane Count								
	Base								
	Subbase								
Curves									
Grades									
Historic Projects									
Maintenance Garage									
Traffic Counters									
Functional Class									
Speed Zone									
AADT Counts	2012								
	2011								
	2010								
	2009								
	2008								
Crash Locations	2012								
	2011								
	2010								
	2009								
	2008								

Historic Projects Retreatment, Resurface, Unknown, Bituminous Mix, Skirny Mix, Bituminous Seal, Bituminous Concrete, Surface Treated Gravel, Plant Mix, Reclaimed Base and Bituminous Concrete, Concrete	Functional Class 1, 2, 3, 4, 5, 6, 7, 8, 9, 10, 11, 12, 13, 14, 15, 16, 17, 18, 19	Curves curve left, curve right	Road Widths (ft)	AADT (count)	Mileage by Functional Class By Sheet 0738 8 - Rural - Minor collector 5.030	Mileage by Town By Sheet WATERFORD - S07380316 5.03 of 5.03	DISTRICT 7	TOWN WATERFORD	Date: 11/15/13	ROUTE Min-0738
Crash Locations Fatal, Injury, Property Damage Only, Unknown Crash Type						Total Mileage: 5.030 mi		1 of 1 TWN mileage: 0.0 to 5.03		ETE mileage: 0.0 to 5.03