



# Route Log and Progress Chart

**DRAFT**

Please Note: Errors and Omissions May Exist.  
Contact the VTrans Mapping Section with questions or concerns.

DISTRICT	TOWN	ROUTE
6	MONTPELIER	US-2

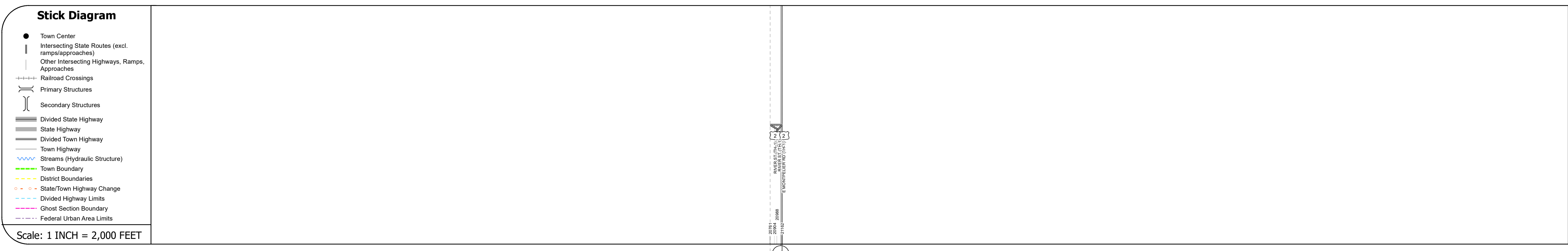
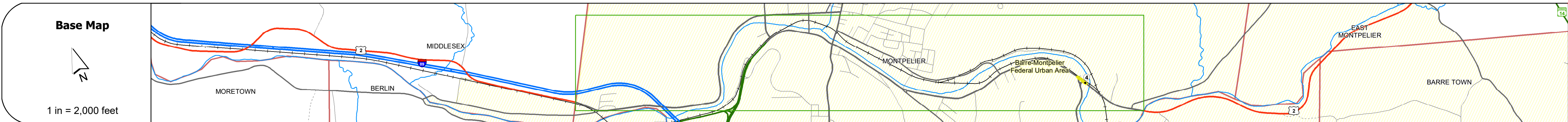
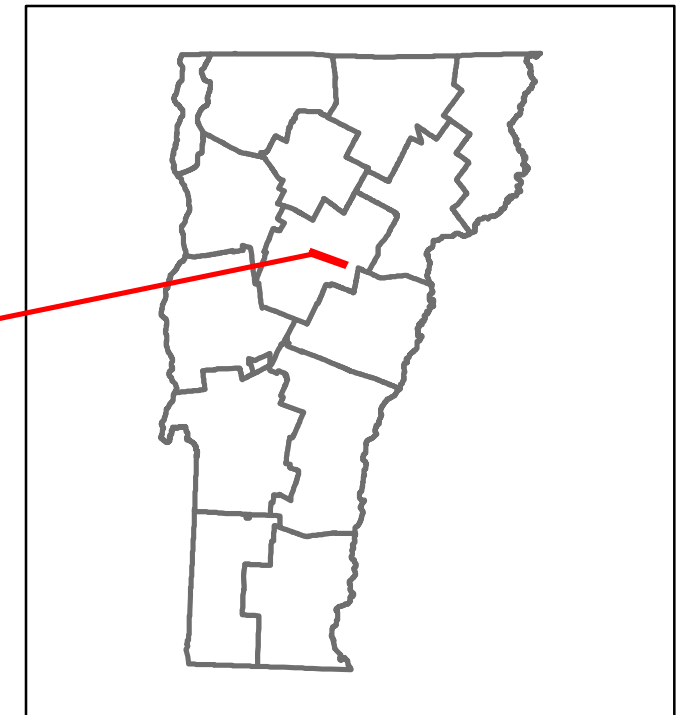

## STRUCTURE DESCRIPTIONS

<b>Road Widths</b>	Travellane Roadway Lane Count Base Subbase
<b>Curves</b>	
<b>Grades</b>	
<b>Guardrails</b>	
<b>Rumblestrips</b>	
<b>Speed Zone</b>	
<b>Curves: Head-on, FTC6</b>	
<b>Curves: Overturn, FTC7</b>	
<b>Curves: Run-off Road, FTC8</b>	
<b>Curves: Fixed Object, FTC9</b>	
<b>Curves: Night Run-off Road, FTC10</b>	
<b>Interstate: Overturn, FTC11</b>	
<b>Tangents: Head-on, FTC12</b>	
<b>Tangents: Overturn, FTC13</b>	
<b>Tangents: Run-off Road, FTC14</b>	

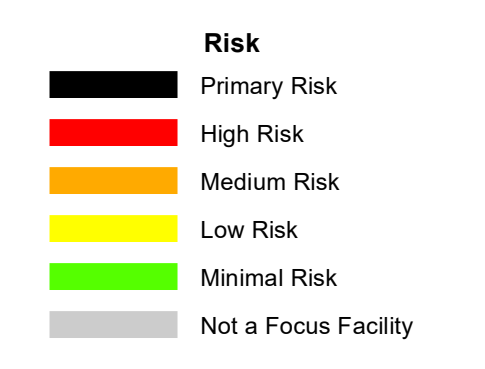

<b>AAADT</b>	2022 2021 2020 2019 2018
--------------	--------------------------------------

<b>Historic Projects</b> Unknown, Retreatment, Resurface, Bituminous Mix, Skiny Mix, Bituminous Seal Bituminous Concrete, Cold Plane and Bituminous Concrete, Concrete, Gravel, Plant Mix, Reclaimed Base and Bituminous Concrete, Surface Treated Gravel	<b>Functional Class</b> 1 - Interstate System, 2 - Other, 3 - Principal Arterial, 4 - Minor Arterial, 5 - Major Collector, 6 - Minor Collector	<b>Crash Locations</b> Fatal, Injury, Property Damage Only, Unknown Crash Type High Crash Locations (HCL's) HCL No. 201 - 300 (21 - 30), 301 - 400 (31 - 40), 401 - 800 (41 - 113)	<b>Mileage by Functional Class By Sheet</b> 028-3 3 - Other Principal Arterial 0.076 <b>Page Total Mileage: 0.076 mi</b>	<b>Mileage by Town By Sheet</b> MONTPELIER - U002-1211w 0.076 of 0.076 <b>Page Total Mileage: 0.076 mi</b>	<b>DISTRICT</b>	<b>TOWN</b>	<b>Date: 02/14/24</b>	<b>ROUTE</b>
					6	MONTPELIER	1 of 1 TWN mileage: 3.932 to 4.008	US-2 ETE mileage: 78.472 to 78.548