

MILEAGE SUMMARY		
CLASS 2		
TH-1	4.700	
TH-2	1.231	
	TOTAL CLASS 2	5.931
CLASS 3		
	TOTAL CLASS 3	41.95
	TOTAL TOWN	47.881
STATE HIGHWAY		
VT-44	5.044	
	TOTAL STATE HIGHWAY	5.044
	TOTAL STATE	5.044
TOTAL, TRAVELED HIGHWAYS, FEB. 10, 2025:		52.925
<i>(Excludes Class 4 and Legal Trail Mileage)</i>		

* The sections of the town highways listed above are legally Class 3, but have been deemed "Not Up To Standard" and are functionally Class 4 Town Highways

LEGAL TRAIL No.	LENGTH IN MILES LEGAL TRAIL
2	(0.38)
TOTAL	0.38

B34 / C34 STATE BRIDGE OR CULVERT IDENTIFIER
B34 / C34 TOWN BRIDGE OR CULVERT IDENTIFIER

DISCLAIMER:
The untraveled highways (laid-out town highways), discontinued highways, and legal trails hereon are those of which the Agency of Transportation has record; others may exist.

Highway and bridge data by the Agency of Transportation.
Town short structures drawn from the VTCULVERTS
(formerly VOBCIT) online database. All other data from the
Vermont Open Geodata Portal. Only named streams shown.

Vermont State Plane Coordinate System
North American Datum of 1983
SPCS_Zone_Identifier: 4400
Geodetic Reference System 80
4,000-meter grid, Easting - Northing

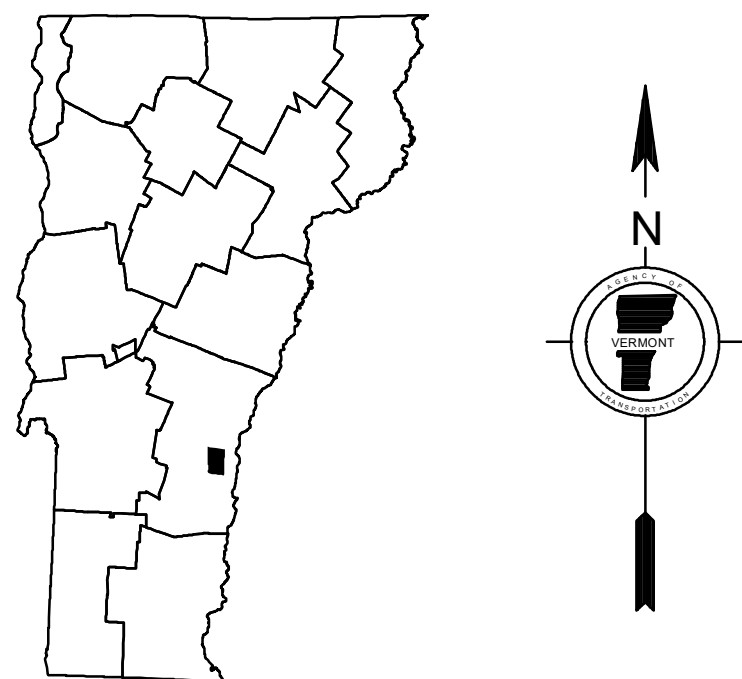
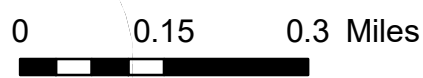
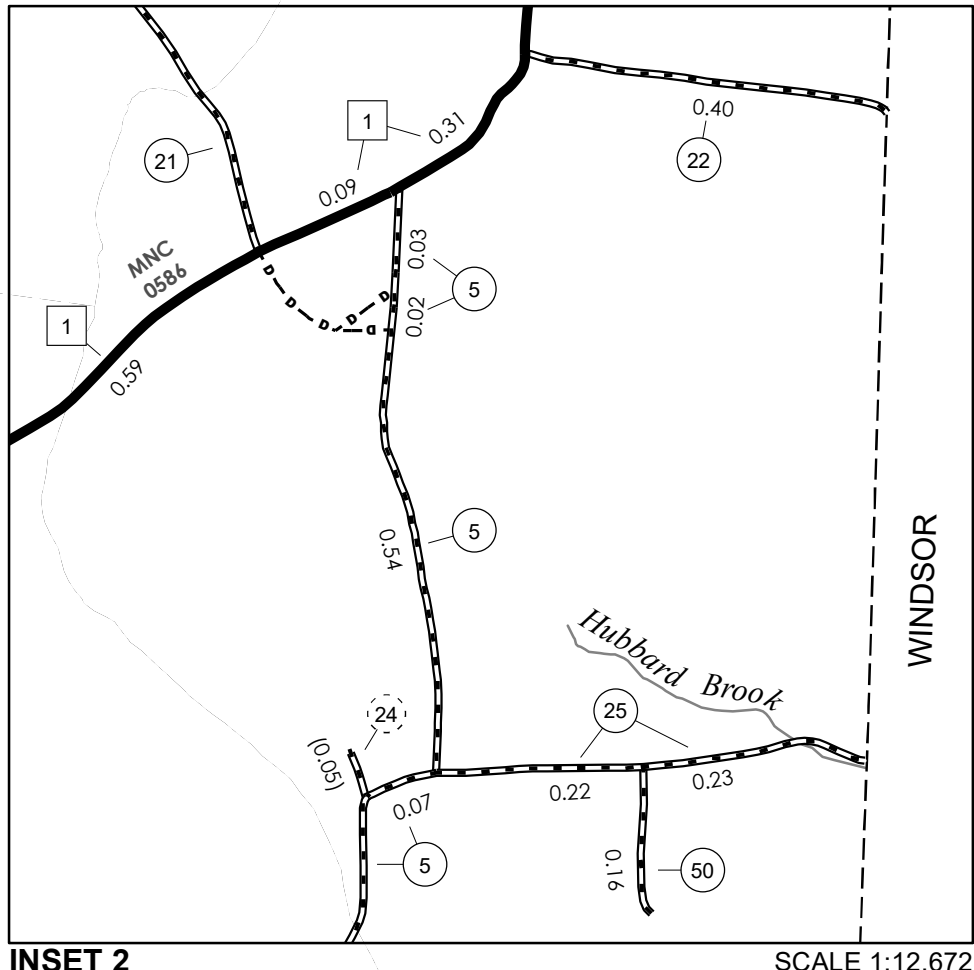
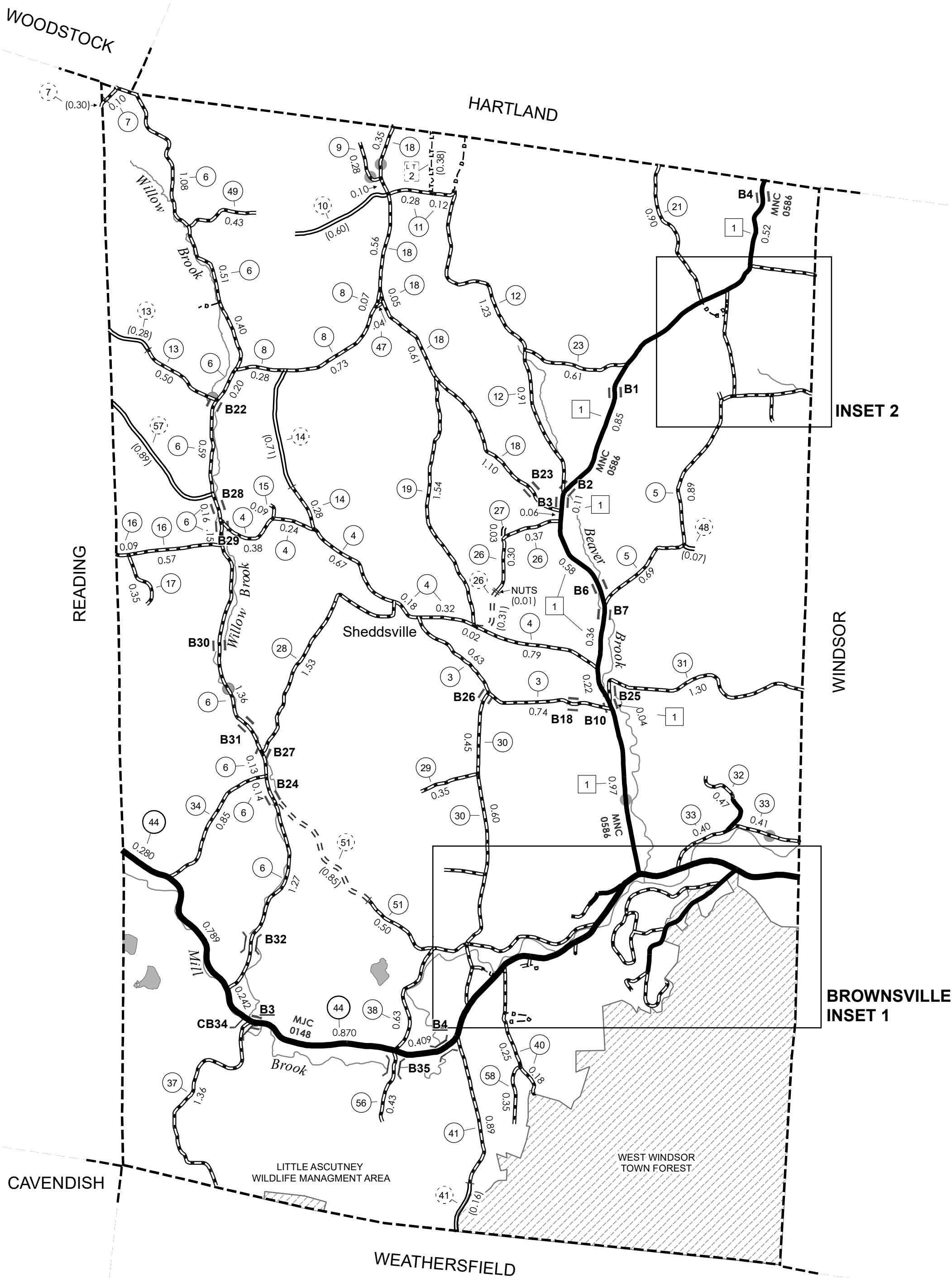

VERMONT
GENERAL HIGHWAY MAP
Town of West Windsor
WINDSOR COUNTY

Transportation District #4

Prepared by the
Vermont Agency of Transportation
 Division of Policy, Planning and Intermodal Development
 in cooperation with
U.S. Department of Transportation
Federal Highway Administration

Mileage as of February 10, 2025
Map prepared September 04, 2025

SCALE 1:31,680

