

TOWN HWY. No.	LENGTH IN MILES		TOWN ROAD NAME
	CLASS 3	CLASS 4	
14	0.15		CROSS ST
16	0.07		CEMETERY HILL RD
55	0.09		CHURCH ST
56	0.11		JAIL ST
TOTAL	0.42	0.00	

MILEAGE SUMMARY			
CLASS 2			
TH-1	0.440		0.440
	TOTAL CLASS 2		0.440
CLASS 3			
	TOTAL CLASS 3		0.42
	TOTAL TOWN		0.860
STATE HIGHWAY			
VT-30	0.523		0.523
	TOTAL STATE HIGHWAY		0.523
	TOTAL STATE		0.523
TOTAL, TRAVELED HIGHWAYS, FEB. 10, 2025:			1.383
(Excludes Class 4 and Legal Trail Mileage)			

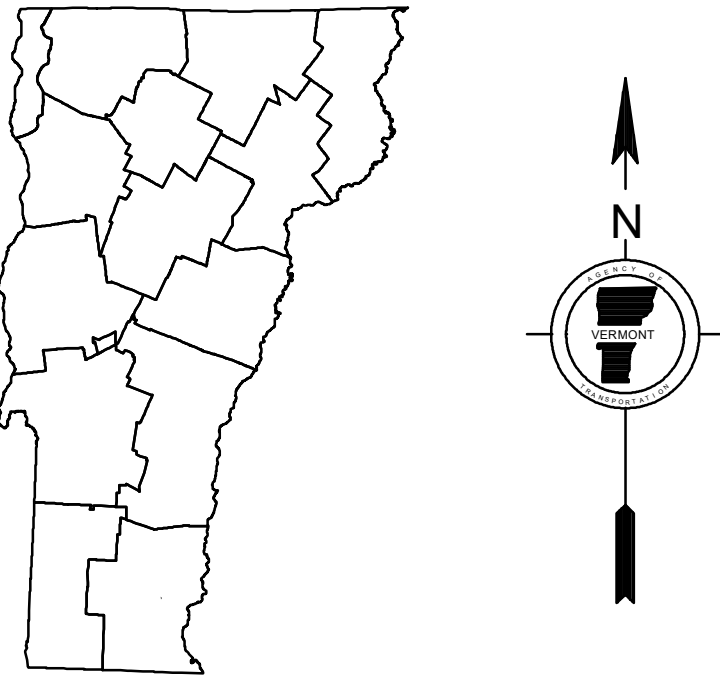
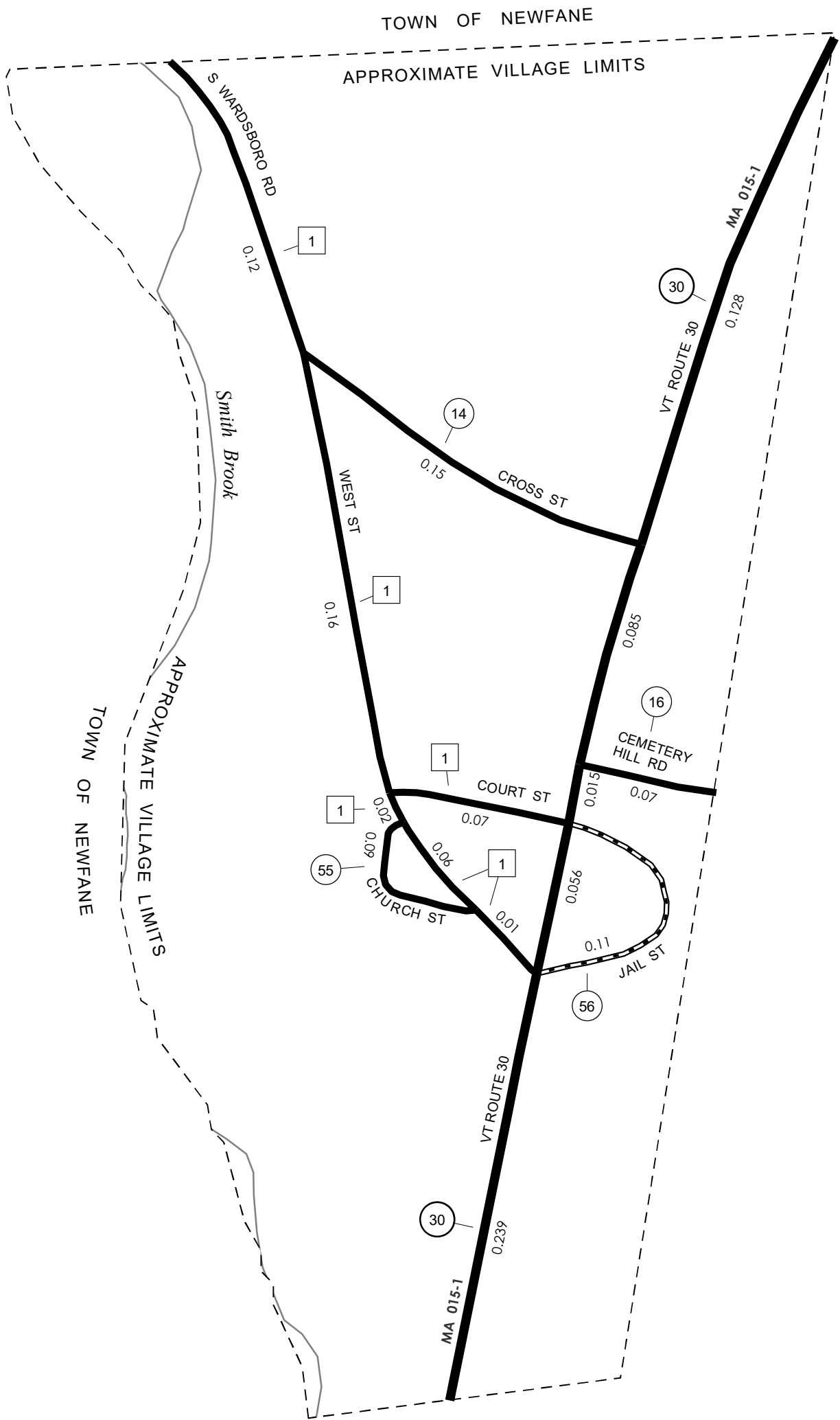

VERMONT
GENERAL HIGHWAY MAP

Village of Newfane

WINDHAM COUNTY

Transportation District #2

Prepared by the
Vermont Agency of Transportation
Division of Policy, Planning and Intermodal Development
in cooperation with

U.S. Department of Transportation
Federal Highway Administration

Mileage as of February 10, 2025
Map prepared August 26, 2025

SCALE 1:3,168

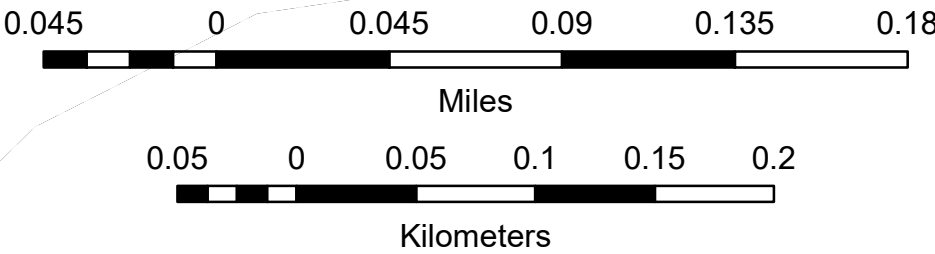

HIGHWAYS		POLITICAL SUBDIVISIONS	
INTERSTATE	INTERSTATE OR DIVIDED HIGHWAY	STATE BOUNDARY	
U.S. ROUTE	STATE - HARD SURFACE OR PAVED	COUNTY BOUNDARY	
STATE ROUTE	TOWN - HARD SURFACE OR PAVED	TOWN BOUNDARY	
CLASS 1	GRAVEL	VILLAGE BOUNDARY	
CLASS 2	SOIL OR GRADED AND DRAINED EARTH	URBAN COMPACT BOUNDARY	
CLASS 3	UNIMPROVED OR PRIMITIVE	WATER BODY	
CLASS 4	IMPASSABLE OR UNTRAVELED	STREAM OR BROOK	
LEGAL TRAIL	LEGAL TRAIL	BRIDGE OR CULVERT	
PARK AND RIDE	DISCONTINUED	BRIDGE OR CULVERT > 20'	FEDERAL CLASSIFICATION IDENTIFIER
	HIGHWAY CLASS CHANGE	BRIDGE OR CULVERT 6' - 20'	MA MINOR ARTERIAL
	RAILROAD	BIKE PATH STRUCTURE	MJC MAJOR COLLECTOR
	INACTIVE RAILROAD	VTCULVERTS BRIDGE	MNC MINOR COLLECTOR
	PUBLIC LAND - NATIONAL FOREST	VTCULVERTS CULVERT > 6'	PA PRINCIPAL ARTERIAL
	PUBLIC LAND - STATE/MUNICIPAL		
	NATIONAL FOREST ROAD	STATE BRIDGE OR CULVERT IDENTIFIER	
	ARMY CORPS OF ENGINEERS	TOWN BRIDGE OR CULVERT IDENTIFIER	
	UNITED STATES GOV. HWY.		

DISCLAIMER:
The untraveled highways (laid-out town highways), discontinued highways, and legal trails hereon are those of which the Agency of Transportation has record; others may exist.

Highway and bridge data by the Agency of Transportation.
Town short structures drawn from the VTCULVERTS (formerly VOBCIT) online database. All other data from the Vermont Open Geodata Portal. Only named streams shown.

Vermont State Plane Coordinate System
North American Datum of 1983
SPCS_Zone_Identifier: 4400
Geodetic Reference System 80
2,000-meter grid, Easting - Northing