

TOWN HWY. No.	LENGTH IN MILES CLASS 3	LENGTH IN MILES CLASS 4	TOWN HWY. No.	LENGTH IN MILES CLASS 3	LENGTH IN MILES CLASS 4
6	0.10		40	2.72	(0.09)
8	1.73		41	0.40	
9	2.06		42	0.40	
11	0.32	(0.30)	43	1.56	
12			44	0.28	
13	1.17		45	0.54	(0.35)
14	0.18		46	1.44	
15	0.34		47	0.24	
16	0.21		48	0.90	
17	2.78		49	0.36	
18	1.48		50	0.19	
19	1.27	(0.35)	51	1.12	
20	0.39		52	0.35	(0.62)
21	0.04		55	0.11	
22	0.15		56	0.19	
23	0.08		57	0.10	
24	0.42		58	0.16	
25	0.25		59	0.74	
26	0.85	(1.15)	60	0.20	
27	1.00		63	0.15	
28	0.91	(0.09)	64	0.28	
29	0.56		65	0.40	
30	0.24		66	1.19	
31	0.14	(0.24)	67	0.30	
32	0.31		68	0.22	
33	0.96	(0.64)	69	0.30	
35	0.47		70	0.11	
36	3.51		71	0.41	
37	0.82		72	0.43	
38	0.35		73	0.12	
39	1.41		74	0.07	(0.05)
TOTAL			TOTAL	40.08	3.88

TOWN HWY. No.	LENGTH IN MILES "NOT UP TO STANDARD"
22	(0.16)
48	(1.18)
TOTAL	1.34

*The sections of the town highways listed above are legally Class 3, but have been deemed "Not Up To Standard" and are functionally Class 4 Town Highways

LEGAL TRAIL No.	LENGTH IN MILES LEGAL TRAIL
1	(0.50)
2	(1.11)
3	(1.37)
4	(0.25)
TOTAL	3.23

MILEAGE SUMMARY	
CLASS 2	
TH-1	2.550
TH-2	3.200
TH-3	0.340
TH-4	0.490
TH-5	2.590
TH-6	3.020
TOTAL CLASS 2	12.190
TOTAL CLASS 3	40.08
TOTAL TOWN	52.270
STATE HIGHWAY	
VT-11	7.556
VT-100	7.646
TOTAL STATE HIGHWAY	15.202
TOTAL STATE	15.202

TOTAL, TRAVELED HIGHWAYS, FEB. 10, 2016: 67.472
(Excludes Class 4 and Legal Trail Mileage)

- HIGHWAYS**
- INTERSTATE OR DIVIDED HIGHWAY
 - INTERSTATE
 - U.S. ROUTE
 - STATE ROUTE
 - CLASS 1
 - CLASS 2
 - CLASS 3
 - CLASS 4
 - LEGAL TRAIL
 - INTERSTATE OR DIVIDED HIGHWAY
 - STATE - HARD SURFACE OR PAVED
 - TOWN - HARD SURFACE OR PAVED
 - GRAVEL
 - SOIL OR GRADED AND DRAINED EARTH
 - UNIMPROVED OR PRIMITIVE
 - IMPASSABLE OR UNTRAVELED
 - LEGAL TRAIL
 - DISCONTINUED
 - HIGHWAY CLASS CHANGE
 - RAILROAD
 - INACTIVE RAILROAD
 - NATIONAL FOREST ROAD
 - STATE FOREST HIGHWAY
 - PARK AND RIDE

- PUBLIC LAND - GREEN MOUNTAIN NATIONAL FOREST
- PUBLIC LAND - STATE/MUNICIPAL
- POLITICAL SUBDIVISIONS**
- STATE BOUNDARY
- COUNTY BOUNDARY
- TOWN BOUNDARY
- VILLAGE BOUNDARY
- URBAN COMPACT BOUNDARY
- WATER BODY
- STREAM OR BROOK
- BRIDGE OR CULVERT**
- BRIDGE OR CULVERT > 20'
- BRIDGE OR CULVERT 6' - 20'
- VOBICIT BRIDGE
- VOBICIT CULVERT > 6'
- STATE BRIDGE OR CULVERT IDENTIFIER
- TOWN BRIDGE OR CULVERT IDENTIFIER

- FEDERAL CLASSIFICATION IDENTIFIER**
- FAU URBAN ARTERIAL OR COLLECTOR
 - MA MINOR ARTERIAL
 - MJC MAJOR COLLECTOR
 - MNC MINOR COLLECTOR
 - PA PRINCIPAL ARTERIAL

DISCLAIMER:
The untraveled highways (laid-out town highways), discontinued highways, and legal trails herein are those of which the Agency of Transportation has record; others may exist.

Highway and bridge data by the Agency of Transportation. Town short structures are drawn from the Vermont Online Bridge & Culvert Inventory Tool (VOBCIT) database. All other data from the Vermont Center for Geographic Information. Only named streams are shown.

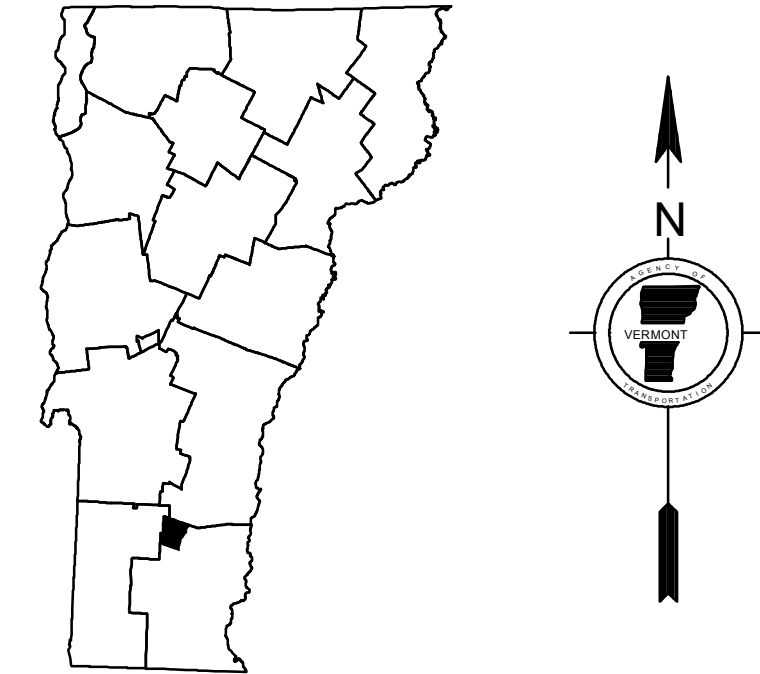
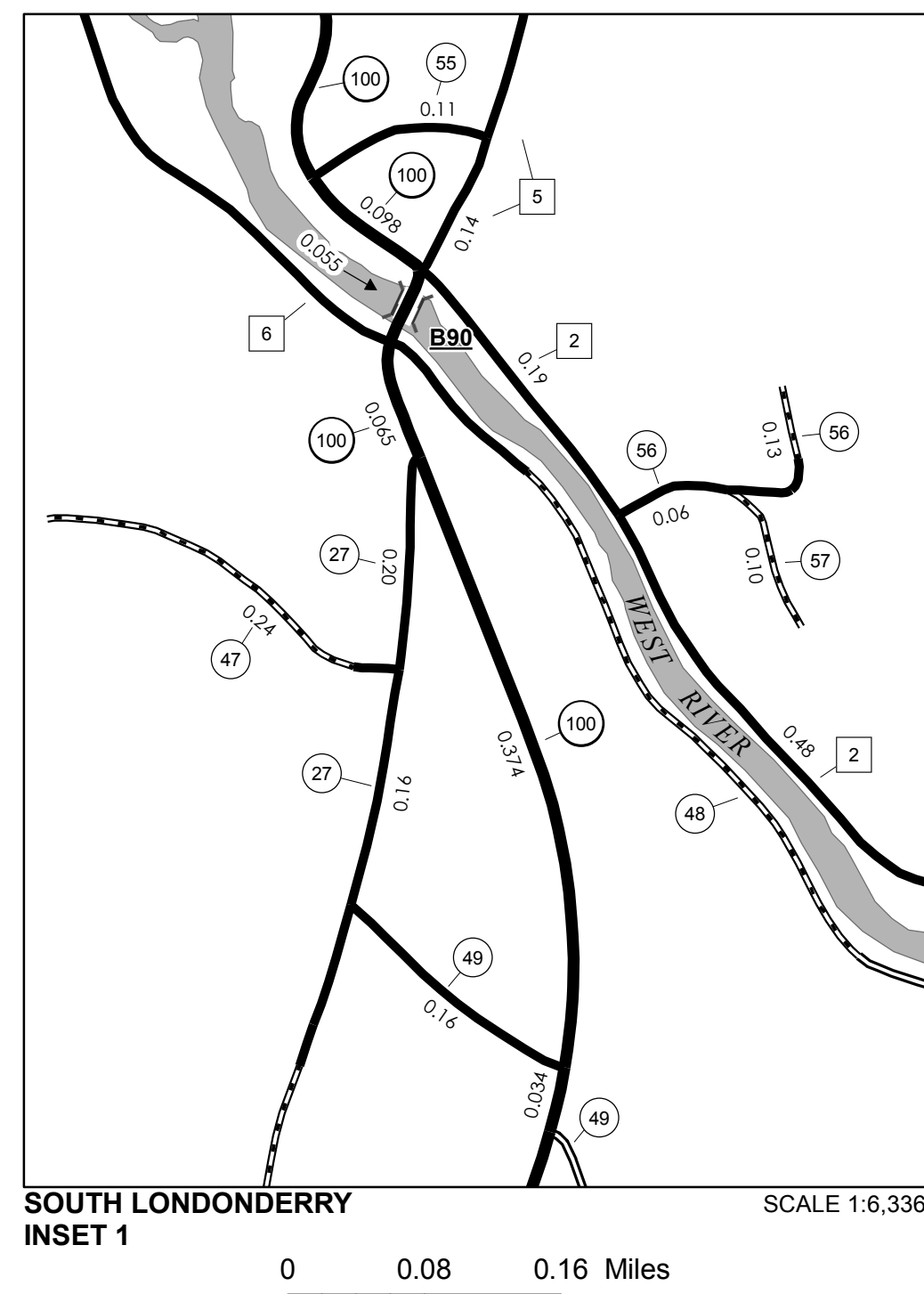
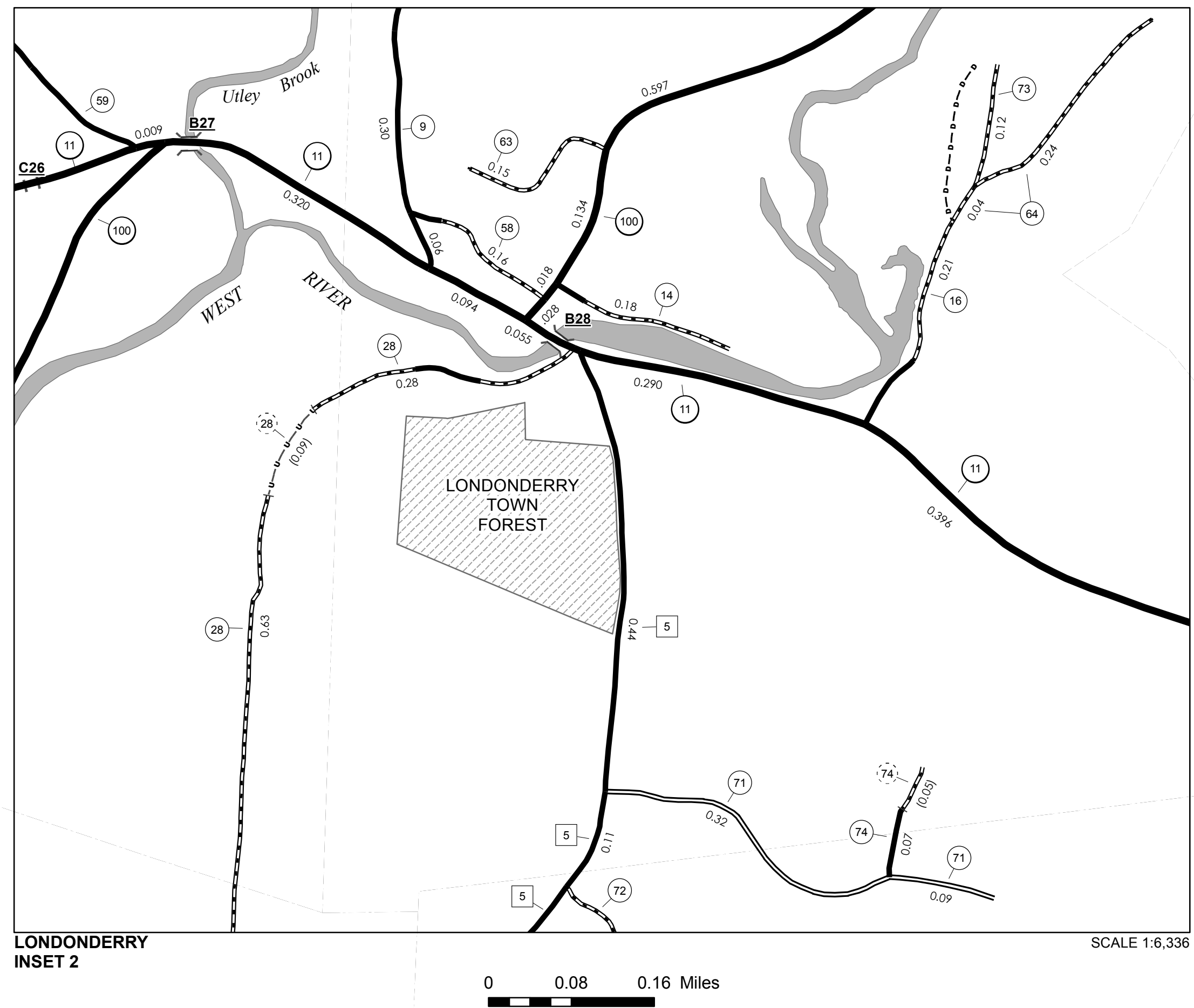
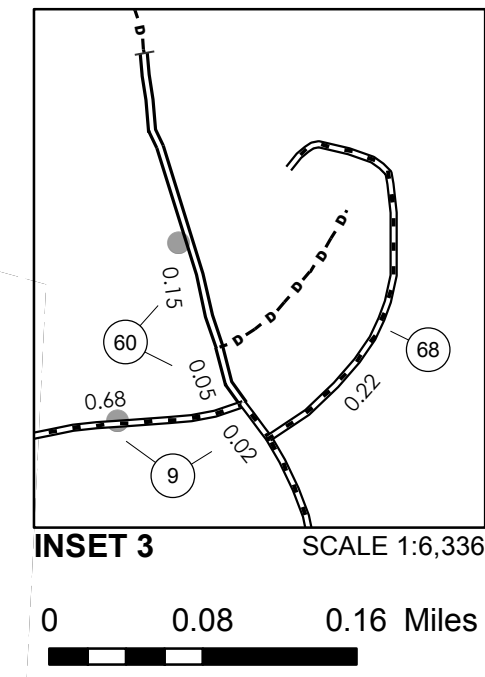
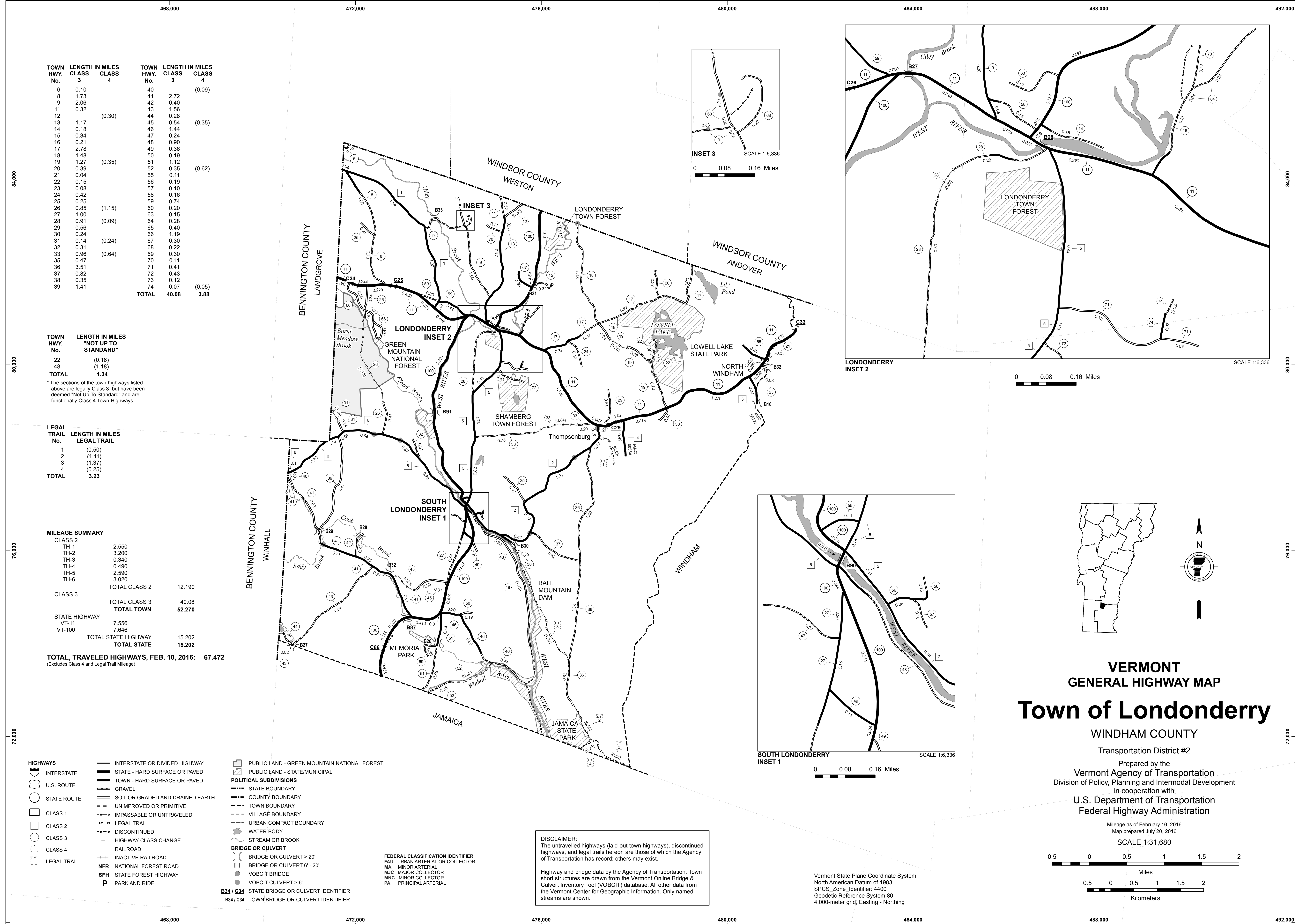

VERMONT GENERAL HIGHWAY MAP Town of Londonderry

WINDHAM COUNTY
Transportation District #2
Prepared by the
Vermont Agency of Transportation
Division of Policy, Planning and Intermodal Development
in cooperation with
U.S. Department of Transportation
Federal Highway Administration

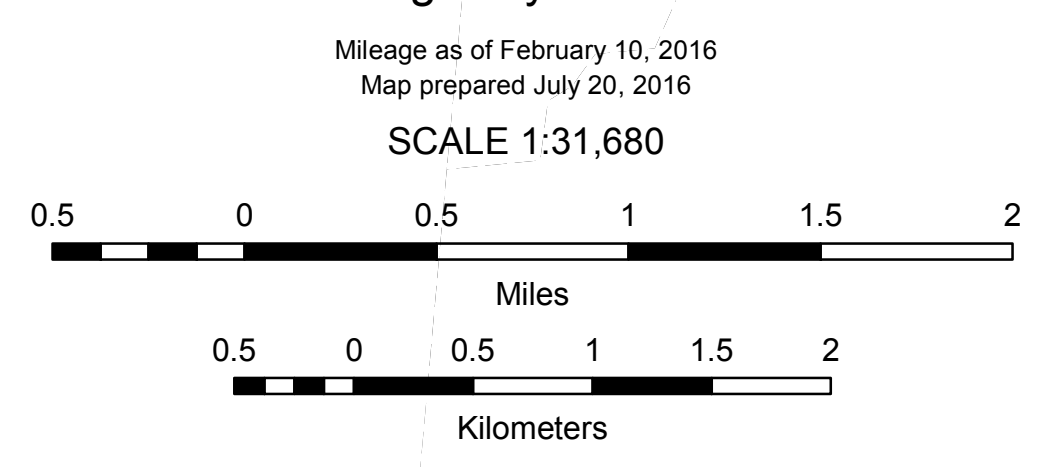

Vermont State Plane Coordinate System
North American Datum of 1983
SPCS_Zone_Identifier: 4400
Geodetic Reference System 80
4,000-meter grid, Easting - Northing