

TOWN HWY. No.	LENGTH IN MILES CLASS 3	LENGTH IN MILES CLASS 4	TOWN HWY. No.	LENGTH IN MILES CLASS 3	LENGTH IN MILES CLASS 4
5	2.02		46	0.21	
6	4.70		47	0.45	
7	3.42		48	0.40	
10	1.25		49	3.58	(0.52)
11	0.20		50	0.73	
12	0.70		51	1.47	
13	2.66		52	0.10	
14	0.15		53	0.11	
15	1.08		54	0.09	
16	0.58	(0.97)	55	0.22	(1.05)
17	0.60	(0.21)	56		(0.50)
18	1.78		57	0.45	
19	0.54		58	0.17	
20	1.82		59	0.10	(0.80)
21	0.80		60	0.06	
22	0.35	(0.20)	61	0.06	
23	1.34		63	0.15	
24	0.20		64	0.07	
25	0.38		65	0.06	
26	0.45	(0.14)	66	0.05	
27	0.89		67	0.15	
28	0.92		69	0.06	
29	0.27		70	0.14	
30	0.96	(1.03)	71	0.22	
31	0.43	(0.90)	72	0.15	
32	0.35		73	0.29	
33	0.36	(0.24)	74	0.09	
34	0.98	(0.39)	75	0.33	
35	0.20		76		(0.10)
36	0.30		77	0.13	
37	1.26	(0.19)	78	0.78	
38	0.72		79	0.60	
39	0.25		80	0.78	
40	0.20		81	0.08	
41	0.22		82	0.04	
42	0.70	(0.75)	83		(0.03)
43	0.08	(0.14)	84		(0.49)
44	2.46	(0.27)	85	0.03	
45	0.16				
TOTAL			49.73	8.92	

LEGAL TRAIL No.	LENGTH IN MILES LEGAL TRAIL
1	(1.19)
2	(0.31)
3	(1.49)
4	(1.06)
TOTAL	4.05

MILEAGE SUMMARY		
CLASS 2		
TH-1	8.250	
TH-2	3.700	
TH-3	0.210	
TH-4	5.090	
	TOTAL CLASS 2	17.250
CLASS 3		
	TOTAL CLASS 3	49.73
TOTAL TOWN		66.980
US HIGHWAY US-5	6.758	
TOTAL US HIGHWAY	6.758	
TOTAL STATE	6.758	
INTERSTATE I-91	3.925	
TOTAL INTERSTATE	3.925	
TOTAL INTERSTATE	3.925	

TOTAL, TRAVELED HIGHWAYS, FEB. 10, 2017: 77.663
 (Excludes Class 4 and Legal Trail Mileage)

- HIGHWAYS**
- INTERSTATE OR DIVIDED HIGHWAY
 - STATE - HARD SURFACE OR PAVED
 - TOWN - HARD SURFACE OR PAVED
 - GRAVEL
 - SOIL OR GRADED AND DRAINED EARTH
 - UNIMPROVED OR PRIMITIVE
 - IMPASSABLE OR UNTRAVELED
 - LEGAL TRAIL
 - DISCONTINUED
 - HIGHWAY CLASS CHANGE
 - RAILROAD
 - INACTIVE RAILROAD
 - PUBLIC LAND - NATIONAL FOREST
 - PUBLIC LAND - STATE/MUNICIPAL
 - NFR NATIONAL FOREST ROAD
 - SFH STATE FOREST HIGHWAY

- POLITICAL SUBDIVISIONS**
- STATE BOUNDARY
 - COUNTY BOUNDARY
 - TOWN BOUNDARY
 - VILLAGE BOUNDARY
 - URBAN COMPACT BOUNDARY
 - WATER BODY
 - STREAM OR BROOK
- BRIDGE OR CULVERT**
- BRIDGE OR CULVERT > 20'
 - BRIDGE OR CULVERT 6' - 20'
 - BIKE PATH STRUCTURE
 - VOBCIT BRIDGE
 - VOBCIT CULVERT > 6'
- FEDERAL CLASSIFICATION IDENTIFIER**
- MA MINOR ARTERIAL
 - MJC MAJOR COLLECTOR
 - MNC MINOR COLLECTOR
 - PA PRINCIPAL ARTERIAL
- B34 / C34 STATE BRIDGE OR CULVERT IDENTIFIER**
- B34 / C34 TOWN BRIDGE OR CULVERT IDENTIFIER**

DISCLAIMER:
 The untraveled highways (laid-out town highways), discontinued highways, and legal trails hereon are those of which the Agency of Transportation has record; others may exist.

Highway and bridge data by the Agency of Transportation. Town short structures drawn from the Vermont Online Bridge & Culvert Inventory Tool (VOBCIT) database. All other data from the Vermont Center for Geographic Information. Only named streams shown.

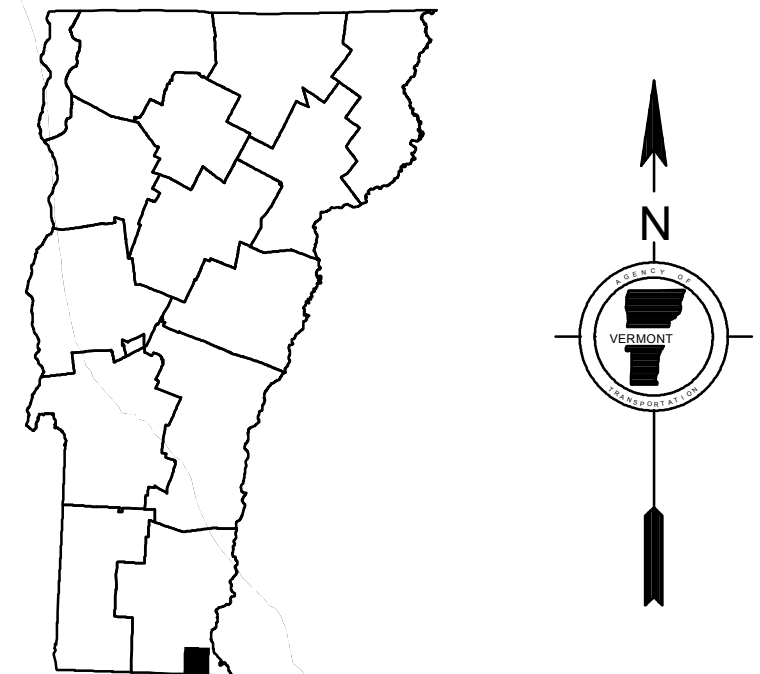
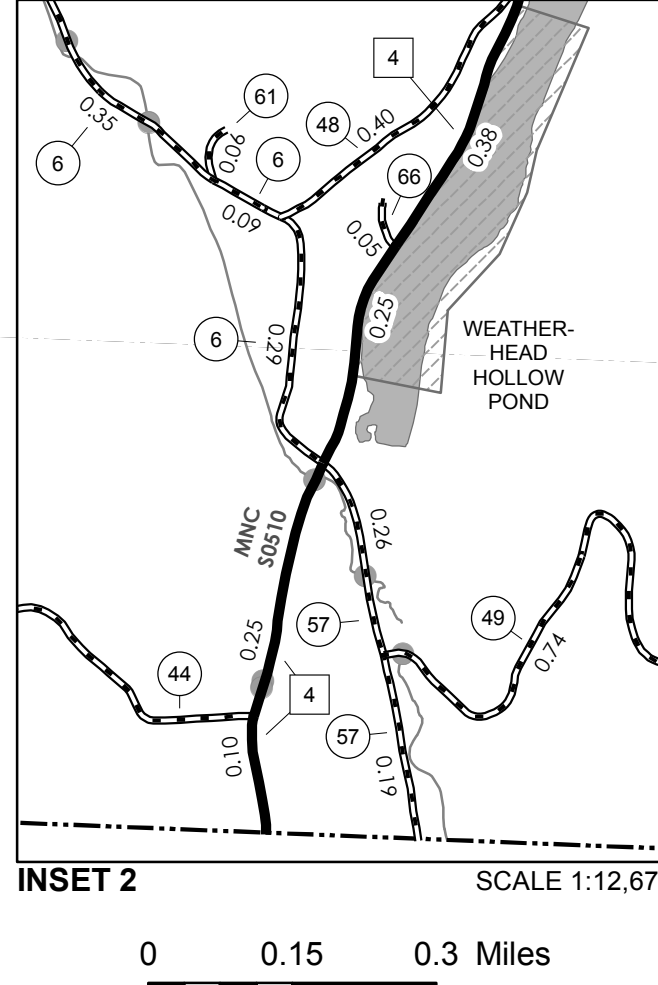
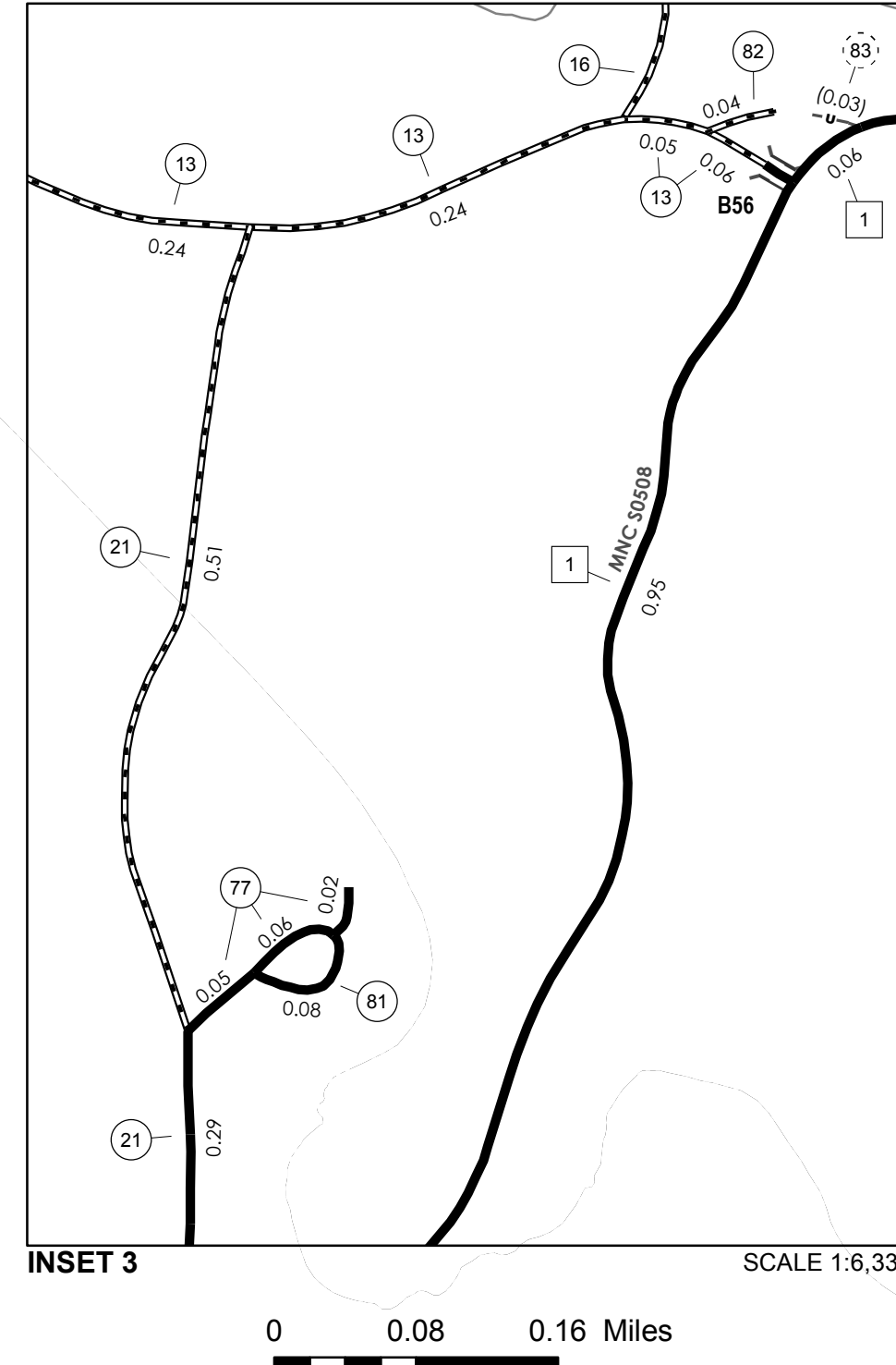
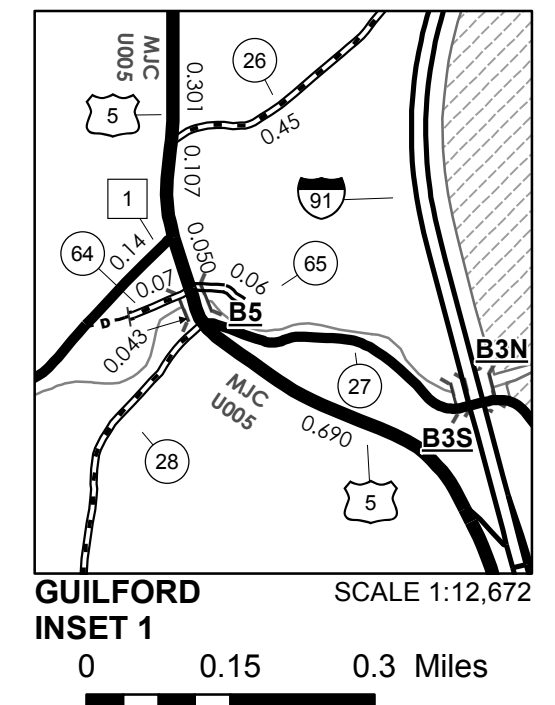

VERMONT
GENERAL HIGHWAY MAP
Town of Guilford
 WINDHAM COUNTY
 Transportation District #2

Prepared by the
 Vermont Agency of Transportation
 Division of Policy, Planning and Intermodal Development
 in cooperation with
 U.S. Department of Transportation
 Federal Highway Administration

Mileage as of February 10, 2017
 Map prepared June 23, 2017
 SCALE 1:31,680

0.5 0 0.5 1 1.5 2
 Miles
 0.5 0 0.5 1 1.5 2
 Kilometers