

TOWN HWY. No.	LENGTH IN MILES CLASS 3	LENGTH IN MILES CLASS 4	TOWN HWY. No.	LENGTH IN MILES CLASS 3	LENGTH IN MILES CLASS 4
2		(0.51)	388	0.12	
4		(1.87)	390		(0.15)
6		(0.10)	392	0.25	
8	0.94		393	0.06	
10	0.49		395	0.22	
12	3.30		396	0.18	
14	0.20		397	0.16	
18	0.10		398	0.36	
20	0.73	(0.89)	400	0.41	
23	0.11		402	0.09	
24	2.03		404	0.17	
25	0.81		406	0.41	
26	1.87		408	0.05	(0.09)
27	0.18		410	0.13	
28	0.68		412	0.09	
29	0.52		414	0.14	
30	1.09		416	0.23	
32	1.43		418	0.37	
34	0.31		419	0.08	
35	0.31		420	0.19	(0.15)
36	1.98		422	0.07	
38	0.32		423	0.04	
40	0.81		424	0.05	
41	0.09		426	0.04	
42	0.75		428	0.44	
43	0.23		430	0.18	
44	0.04		432	0.04	
46	0.34		434	0.34	
47	0.06		438	0.04	
48	0.50	(1.14)	442	0.20	
50	0.28	(1.11)	444	0.34	
52	1.25		445	0.06	
54	0.94	(0.28)	446	0.37	
56	0.96	(0.69)	448	0.18	
58	0.38		450	0.10	
60	1.21		452	0.10	
62	1.10		454	0.03	
64	0.10		455	0.13	
66	0.38		456	0.09	
68	2.32		458	0.11	
70	0.19	(0.37)	460	0.07	
72	1.77		462	0.40	
73	0.23		464	0.07	
74	0.47		466	0.08	
76	1.54		468	0.22	
78	0.16		470	0.06	
80	0.01		472	0.06	
82	0.21		474	0.05	
83	0.66		476	0.06	
84	0.13		478	0.09	
85	0.42		480	0.38	
86	0.14		481	0.04	
87	0.51		482	0.11	
88	0.20		484	0.09	
89	0.11		486	0.31	
90		(0.12)	488	0.29	
91	0.54		490	0.23	
92	1.27		492	0.07	
300	0.32		494	0.32	
302	0.10		496	0.27	
304	0.31		498	0.25	
306	0.32		500	0.12	
308	0.16		502	0.04	
310	0.18		504	0.38	
314	0.31		506	0.06	
316	0.10		508	0.05	
317	0.04		510	0.07	
318	0.15		512	0.40	
319	0.06		514	0.31	
320	0.11		516	0.12	
322	0.09		518	0.17	
324	0.75		520	0.08	
326	0.10		522	0.26	
327	0.03		524	0.21	
328	0.25		526	0.03	
329		(0.09)	528	0.07	
330	0.15		530	0.56	
332	0.30		532	0.03	
334	0.12		534	0.09	
336	0.16		536	0.21	
338	0.05		538	0.31	
340	0.27		540	0.06	
342	0.13		542	0.04	
344	0.04		544	0.07	
346	0.20		546	0.04	
350	0.13		548	0.42	
352	0.04		549	0.20	
354	0.09		700	0.21	
355	0.48		701	0.03	
356	0.30		702	0.08	
358	0.07		703	0.32	
360	0.18		704	0.16	
362	0.10		705	0.18	
364	0.13		706	0.33	
366	0.19		707	0.66	
368	0.10		708	0.45	
370	0.05		709	0.09	
372	0.17		710	0.35	
375	0.04		711	0.11	
376	0.12		712	0.12	
378	1.09		714	0.28	
380	0.19		715	0.17	
382	0.20		716	0.31	
384	0.11		717	0.15	
386	0.15				
TOTAL	65.01	7.56			

MILEAGE SUMMARY

CLASS 1		
TH-1	2.168	
TH-2	2.792	
TH-3	0.326	
TH-4	1.069	
TOTAL CLASS 1	6.355	
CLASS 1 - Ramps	0.065	
TH-1	1.25	
TOTAL CLASS 1 - Ramps	0.065	
CLASS 2		
TH-5	2.850	
TH-6	3.800	
TH-7	0.080	
TH-8	3.030	
TH-9	2.060	
TH-10	1.670	
TH-11	0.400	
TOTAL CLASS 2	13.890	
CLASS 3		
TOTAL CLASS 3	65.01	
TOTAL TOWN	85.320	
STATE HIGHWAY		
VT-9	4.412	
VT-30	3.254	
VT-142	1.098	
NSH-BSH	0.135	
TOTAL STATE HIGHWAY	8.899	
US HIGHWAY		
US-5	3.599	
TOTAL US HIGHWAY	3.599	
TOTAL STATE	12.498	
INTERSTATE		
I-91	6.085	
TOTAL INTERSTATE	6.085	
INTERSTATE - Ramps		
I-91	3.612	
TOTAL INTERSTATE - Ramps	3.612	
TOTAL INTERSTATE	9.697	

TOTAL, TRAVELED HIGHWAYS, FEB. 10, 2013: 107.515
(Excludes Class 4, Legal Trail, and Unidentified Corridor Mileage)

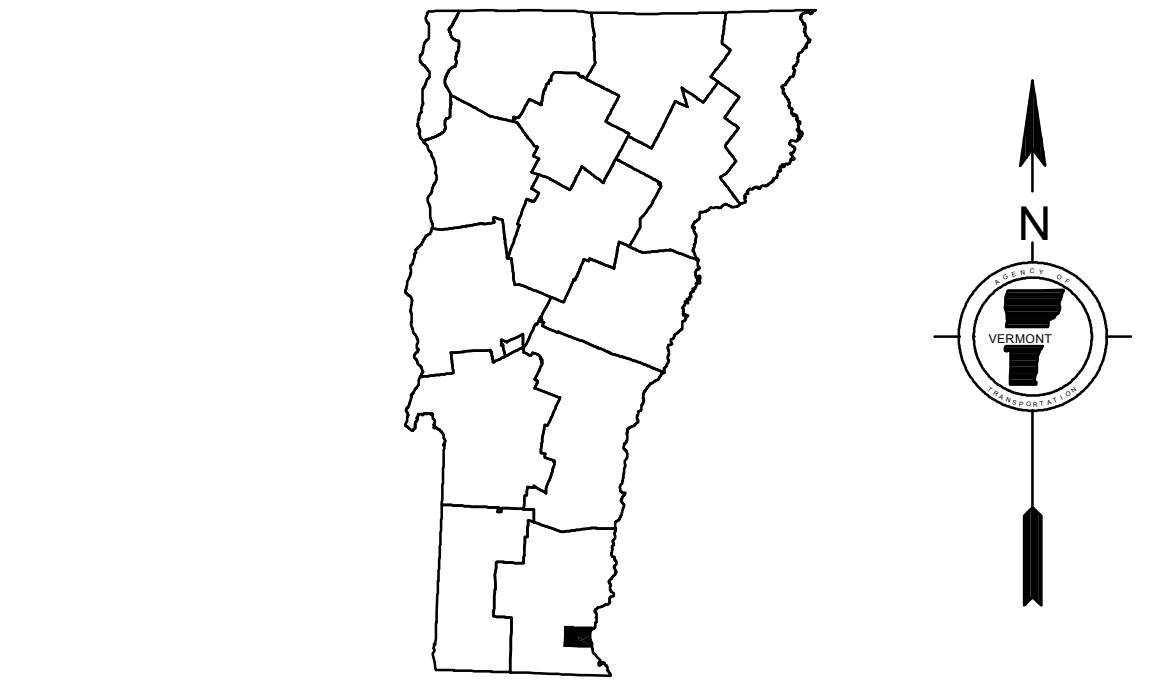
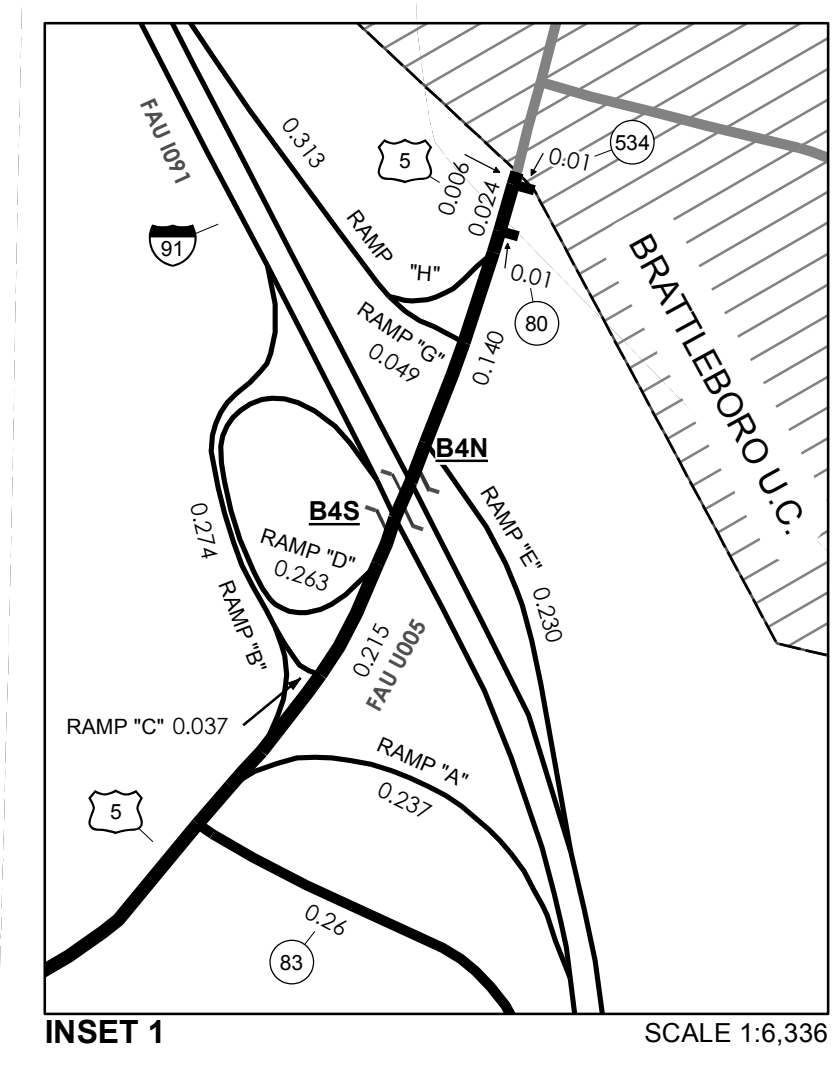
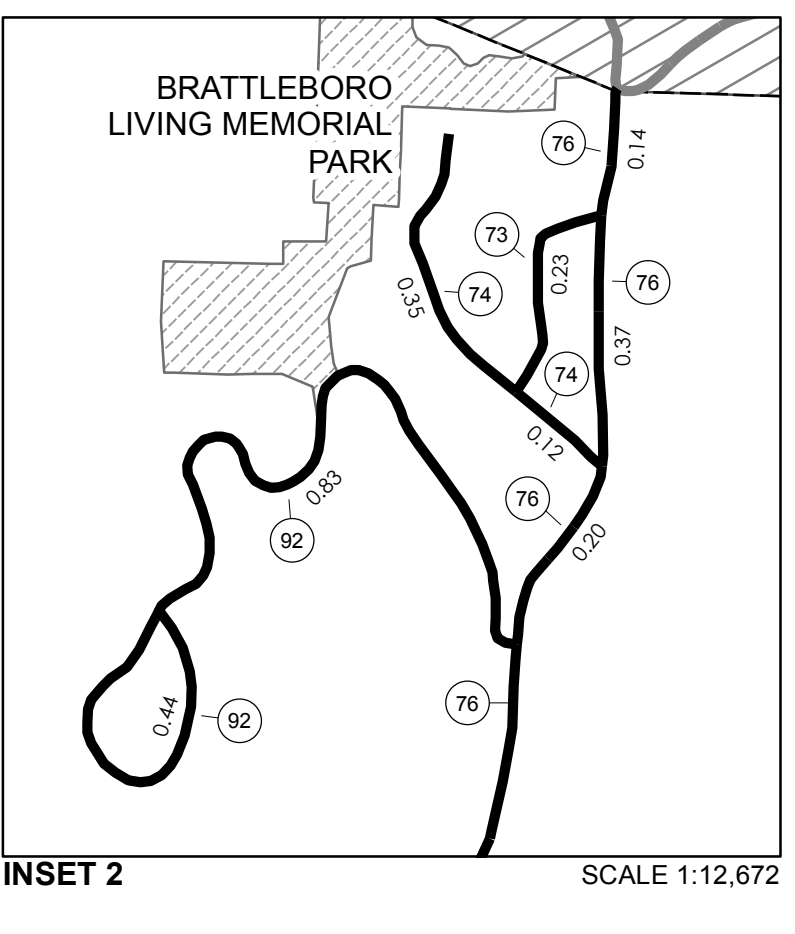
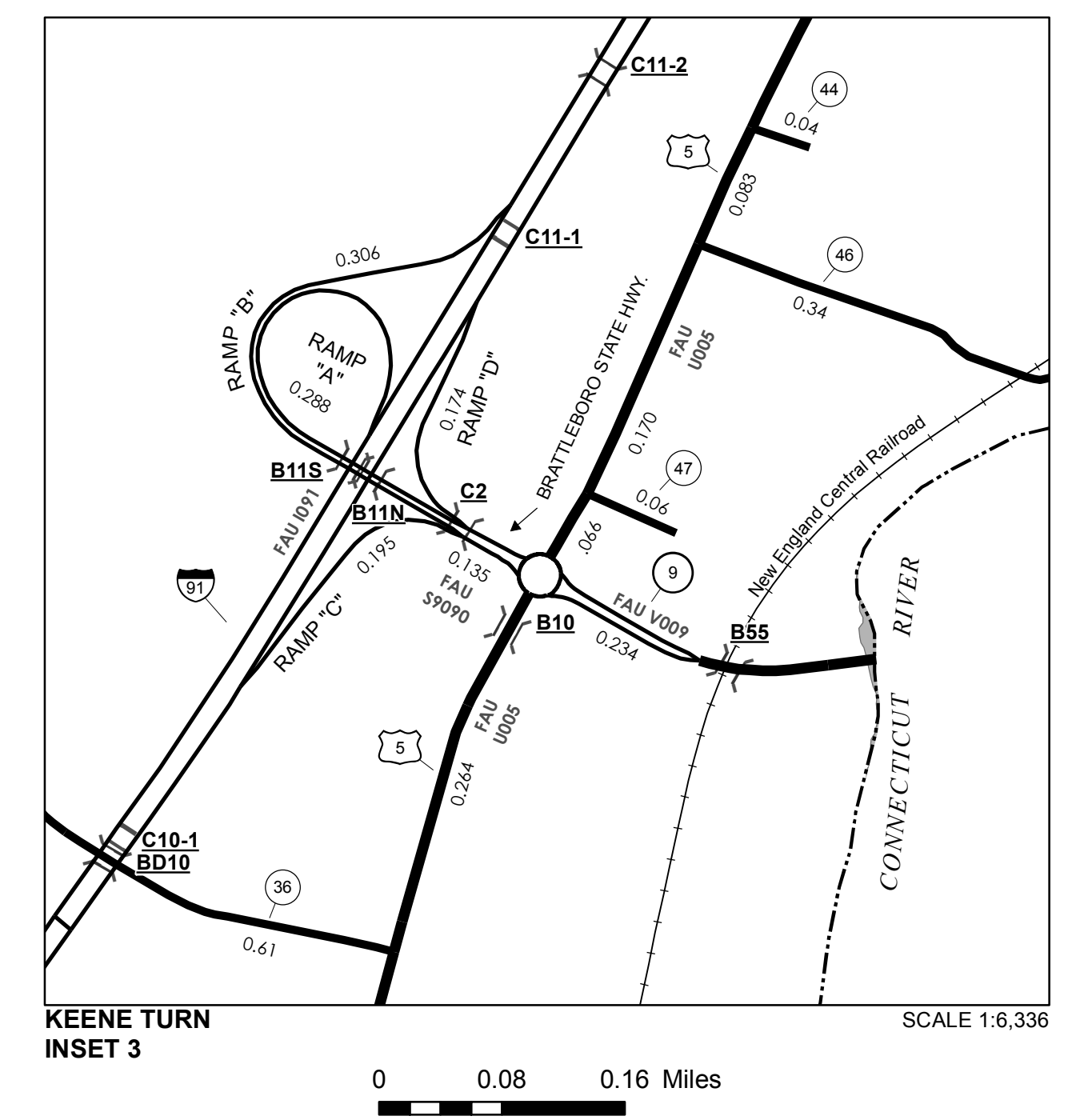

VERMONT
GENERAL HIGHWAY MAP
Town of Brattleboro
WINDHAM COUNTY
Transportation District #2
Prepared by the
Vermont Agency of Transportation
Division of Policy, Planning and Intermodal Development
in cooperation with
U.S. Department of Transportation
Federal Highway Administration
Mileage as of February 10, 2013
Map prepared October 15, 2013
SCALE 1:31,680

0 0.5 1 1.5 2 Miles
0.5 0 0.5 1 1.5 2 Kilometers

DISCLAIMER:
The untraveled highways (laid-out town highways), discontinued highways, and legal trails hereon are those of which the Agency of Transportation has record; others may exist.
Highway and bridge data by the Agency of Transportation. All other data from the Vermont Center for Geographic Information. Only named streams are shown.

Vermont State Plane Coordinate System
North American Datum of 1983
SPCS_Zone_Identifier: 4000
Geodetic Reference System 80
4,000-meter grid, Easting - Northing