

TOWN HWY. No.	LENGTH IN MILES CLASS 3	LENGTH IN MILES CLASS 4	TOWN HWY. No.	LENGTH IN MILES CLASS 3	LENGTH IN MILES CLASS 4
2		(0.51)	388	0.12	
4		(1.87)	390		(0.15)
6		(0.10)	392	0.25	
8	0.94		393	0.06	
10	0.49		395	0.22	
12	3.30		396	0.18	
14	0.20		397	0.16	
18	0.10		398	0.36	
20	0.73	(0.89)	400	0.41	
23	0.11		402	0.09	
24	2.03		404	0.17	
25	0.81		406	0.41	
26	1.87		408	0.05	(0.09)
27	0.18		410	0.13	
28	0.68		412	0.09	
29	0.52		414	0.14	
30	1.09		416	0.23	
32	1.43		418	0.37	
34	0.31		419	0.08	
35	0.31		420	0.19	(0.15)
36	1.98		422	0.07	
38	0.32		423	0.04	
40	0.81		424	0.05	
41	0.09		426	0.04	
42	0.75		428	0.44	
43	0.23		430	0.18	
44	0.04		432	0.04	
46	0.34		434	0.34	
47	0.06		438	0.04	
48	0.50	(1.14)	442	0.20	
50	0.28	(1.11)	444	0.34	
52	1.25		445	0.06	
54	0.94	(0.28)	446	0.37	
56	0.96	(0.69)	448	0.18	
58	0.38		450	0.10	
60	1.21		452	0.10	
62	1.10		454	0.03	
64	0.10		455	0.13	
66	0.38		456	0.09	
68	2.32		458	0.11	
70	0.19	(0.37)	460	0.07	
72	1.77		462	0.40	
73	0.23		464	0.07	
74	0.47		466	0.08	
76	1.54		468	0.22	
78	0.16		470	0.06	
80	0.01		472	0.06	
82	0.21		474	0.05	
83	0.66		476	0.06	
84	0.13		478	0.09	
85	0.42		480	0.38	
86	0.14		481	0.04	
87	0.51		482	0.11	
88	0.20		484	0.09	
89	0.11		486	0.31	
90		(0.12)	488	0.29	
91	0.54		490	0.23	
92	1.27		492	0.07	
300	0.32		494	0.32	
302	0.10		496	0.27	
304	0.31		498	0.25	
306	0.32		500	0.12	
308	0.16		502	0.04	
310	0.18		504	0.38	
314	0.31		506	0.06	
316	0.10		508	0.05	
317	0.04		510	0.07	
318	0.15		512	0.40	
319	0.06		514	0.31	
320	0.11		516	0.12	
322	0.09		518	0.17	
324	0.75		520	0.08	
326	0.10		522	0.26	
327	0.03		524	0.21	
328	0.25		526	0.03	
329		(0.09)	528	0.07	
330	0.15		530	0.56	
332	0.30		532	0.03	
334	0.12		534	0.09	
336	0.16		536	0.21	
338	0.05		538	0.31	
340	0.27		540	0.06	
342	0.13		542	0.04	
344	0.04		544	0.07	
346	0.20		546	0.04	
350	0.13		548	0.42	
352	0.04		549	0.20	
354	0.09		700	0.21	
355	0.48		701	0.03	
356	0.30		702	0.08	
358	0.07		703	0.32	
360	0.18		704	0.16	
362	0.10		705	0.18	
364	0.13		706	0.33	
366	0.19		707	0.66	
368	0.10		708	0.45	
370	0.05		709	0.09	
372	0.17		710	0.35	
375	0.04		711	0.11	
376	0.12		712	0.12	
378	1.09		714	0.28	
380	0.19		715	0.17	
382	0.20		716	0.31	
384	0.11		717	0.15	
386	0.15				
<b>TOTAL</b>			<b>65.01</b>	<b>7.56</b>	

**MILEAGE SUMMARY**

<b>CLASS 1</b>		
TH-1	2.168	
TH-2	2.792	
TH-3	0.326	
TH-4	1.069	
<b>TOTAL CLASS 1</b>	<b>6.355</b>	
<b>CLASS 1 - Ramps</b>		
TH-1	0.065	
<b>TOTAL CLASS 1 - Ramps</b>	<b>0.065</b>	
<b>CLASS 2</b>		
TH-5	2.850	
TH-6	3.800	
TH-7	0.080	
TH-8	3.030	
TH-9	2.060	
TH-10	1.670	
TH-11	0.400	
<b>TOTAL CLASS 2</b>	<b>13.890</b>	
<b>CLASS 3</b>		
<b>TOTAL CLASS 3</b>	<b>65.01</b>	
<b>TOTAL TOWN</b>	<b>85.320</b>	
<b>STATE HIGHWAY</b>		
VT-9	4.412	
VT-30	3.254	
VT-142	1.098	
NSH-BSH	0.135	
<b>TOTAL STATE HIGHWAY</b>	<b>8.899</b>	
<b>US HIGHWAY</b>		
US-5	3.599	
<b>TOTAL US HIGHWAY</b>	<b>3.599</b>	
<b>TOTAL STATE</b>	<b>12.498</b>	
<b>INTERSTATE</b>		
I-91	6.085	
<b>TOTAL INTERSTATE</b>	<b>6.085</b>	
<b>INTERSTATE - Ramps</b>		
I-91	3.612	
<b>TOTAL INTERSTATE - Ramps</b>	<b>3.612</b>	
<b>TOTAL INTERSTATE</b>	<b>9.697</b>	

**TOTAL, TRAVELED HIGHWAYS, FEB. 10, 2012: 107.515**  
(Excludes Class 4, Legal Trail, and Unidentified Corridor Mileage)

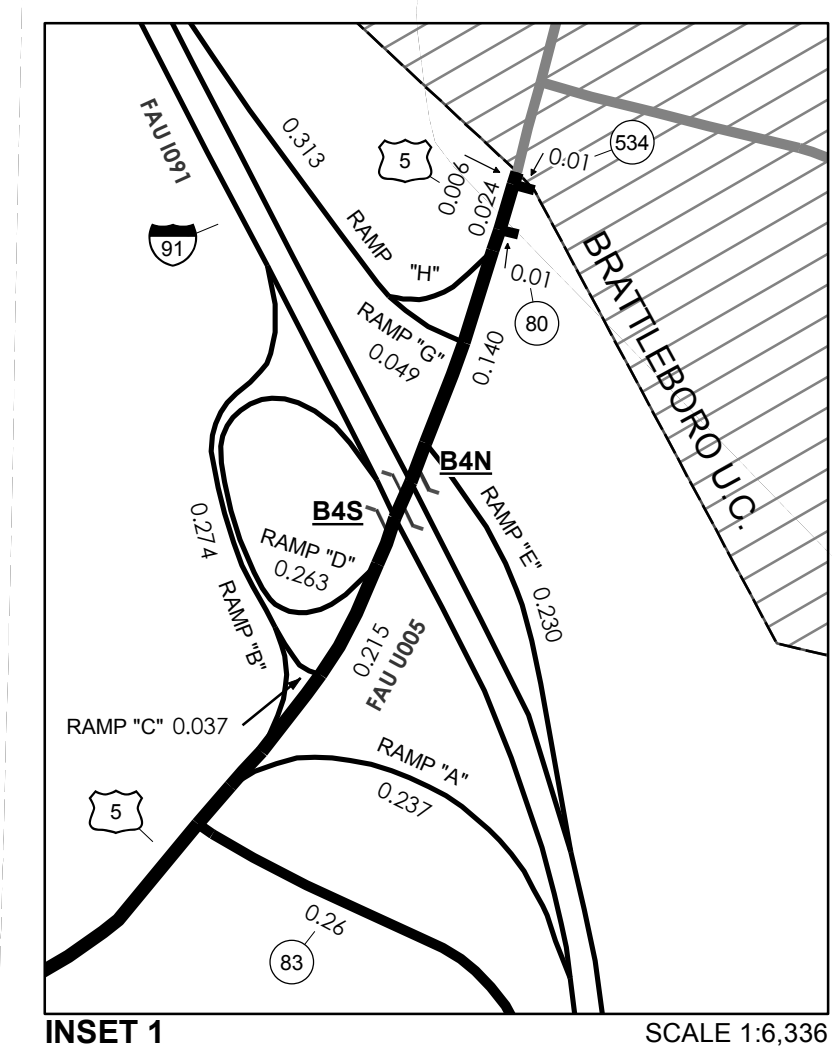
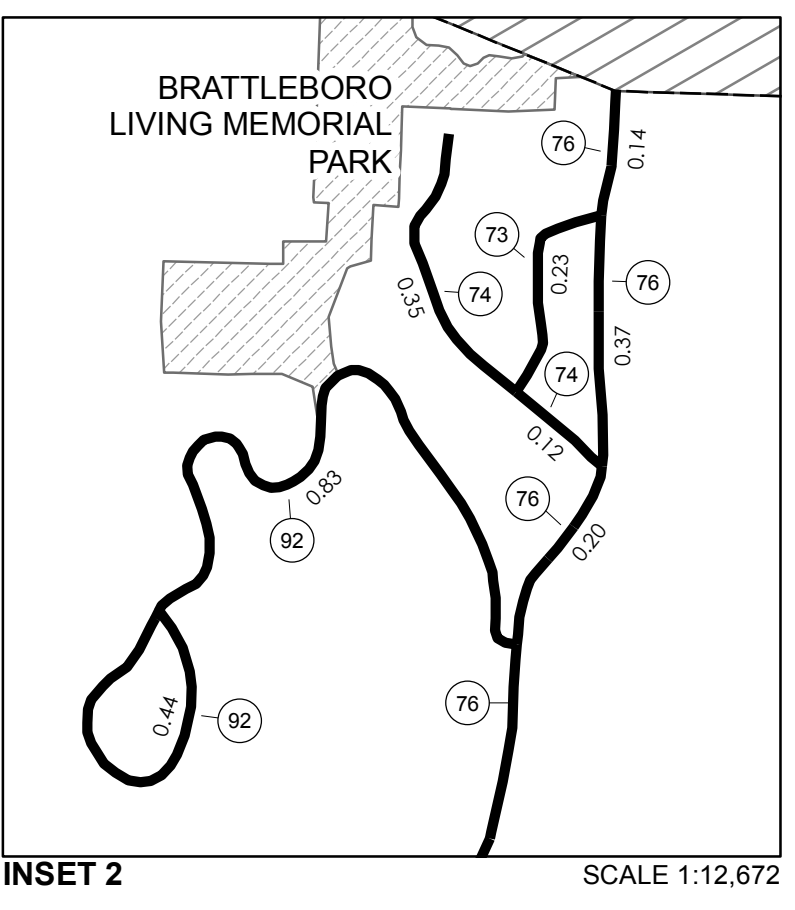
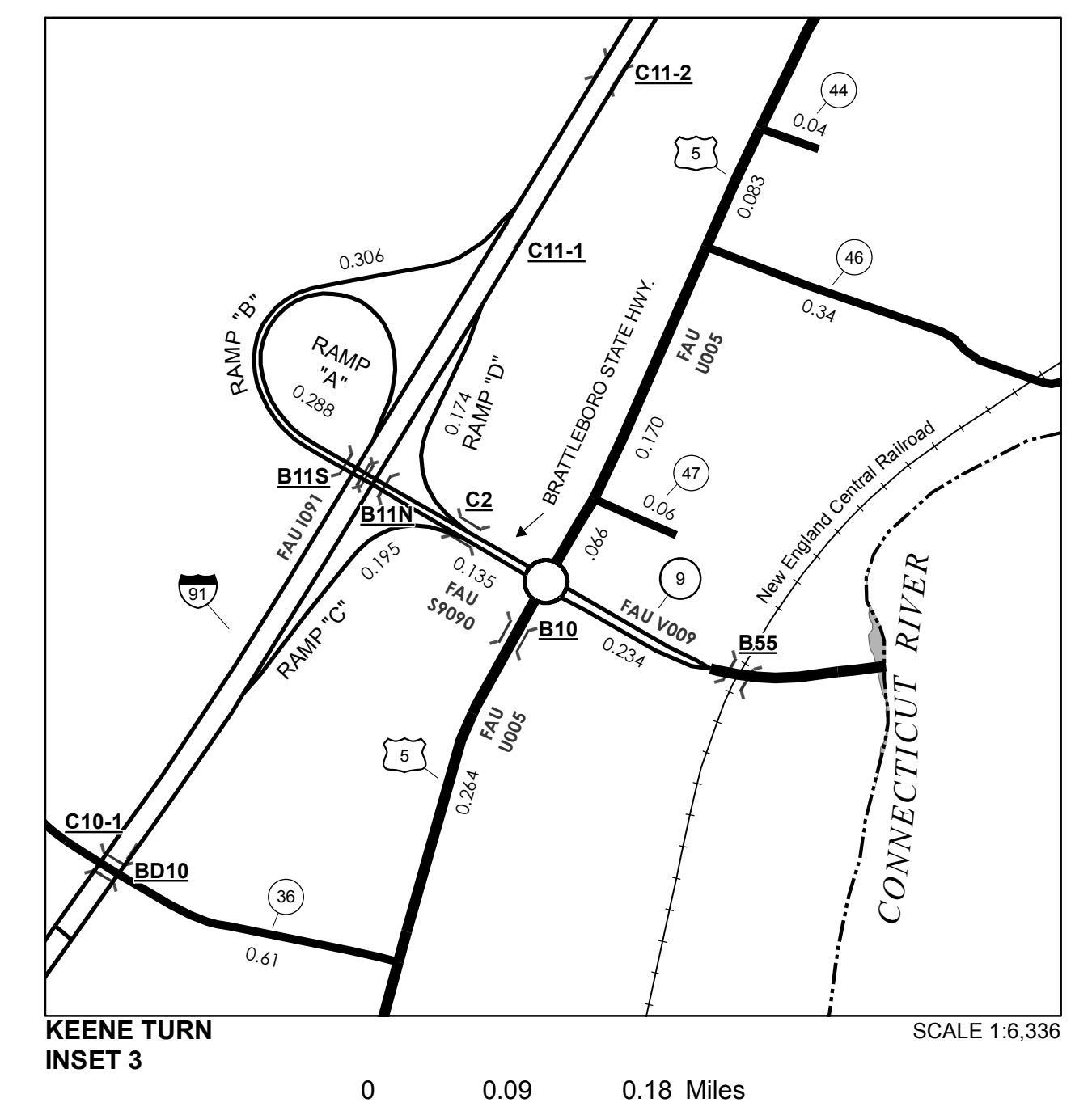

**VERMONT**  
**GENERAL HIGHWAY MAP**  
**Town of Brattleboro**  
WINDHAM COUNTY  
Transportation District #2

Prepared by the  
Vermont Agency of Transportation  
Division of Policy, Planning and Intermodal Development  
in cooperation with  
U.S. Department of Transportation  
Federal Highway Administration

Mileage as of February 10, 2012  
Map prepared September 26, 2012  
SCALE 1:31,680

0 0.5 1 1.5 2  
Miles  
0.5 0 0.5 1 1.5 2  
Kilometers

**DISCLAIMER:**  
The untraveled highways (laid-out town highways), discontinued highways, and legal trails hereon are those of which the Agency of Transportation has record; others may exist.

Highway and bridge data by the Agency of Transportation. All other data from the Vermont Center for Geographic Information. Only named streams are shown.

Vermont State Plane Coordinate System  
North American Datum of 1983  
SPCS\_Zone\_Identifier: 4400  
Geodetic Reference System 80  
4,000-meter grid, Easting - Northing