

TOWN HWY. No.	LENGTH IN MILES CLASS 3	CLASS 4
3	2.28	
4	0.55	
5		(0.31)
6	0.80	(0.30)
7	0.66	
8	0.25	
9	0.17	
10		(0.06)
11	0.30	
12	0.52	
13	0.20	
14	1.53	
15	0.19	(0.96)
16	0.44	(0.26)
17	0.10	
18	0.18	
19	2.97	
20		(0.51)
TOTAL	11.14	2.40

TOWN HWY. No.	LENGTH IN MILES "NOT UP TO STANDARD"
9	(0.31)
11	(0.25)
TOTAL	0.56

* The sections of the town highways listed above are legally Class 3, but have been deemed "Not Up To Standard" and are functionally Class 4 Town Highways

MILEAGE SUMMARY

CLASS 2		
TH-1	4.990	
TH-2	1.760	
TOTAL CLASS 2	6.750	
CLASS 3		
TOTAL CLASS 3	11.14	
TOTAL TOWN	17.890	
TOTAL STATE	0.000	

TOTAL, TRAVELED HIGHWAYS, FEB. 10, 2017: 17.890
(Excludes Class 4 and Legal Trail Mileage)

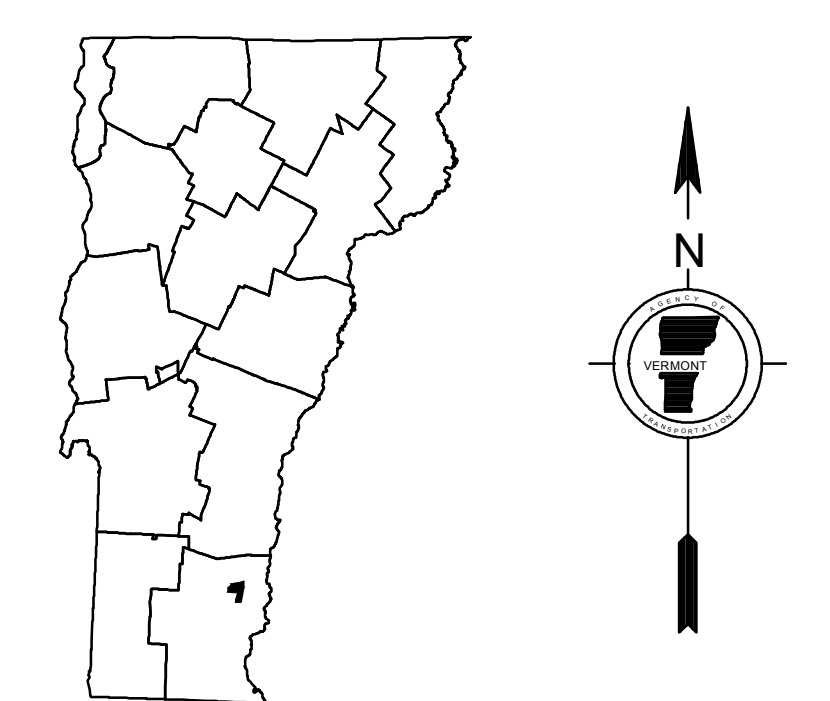
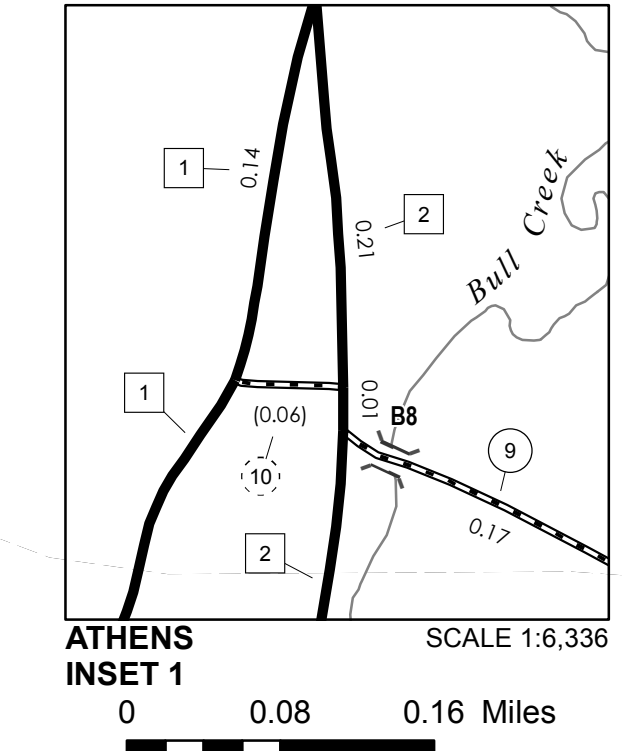

VERMONT GENERAL HIGHWAY MAP
Town of Athens

WINDHAM COUNTY
Transportation District #2
Prepared by the
Vermont Agency of Transportation
Division of Policy, Planning and Intermodal Development
in cooperation with
U.S. Department of Transportation
Federal Highway Administration

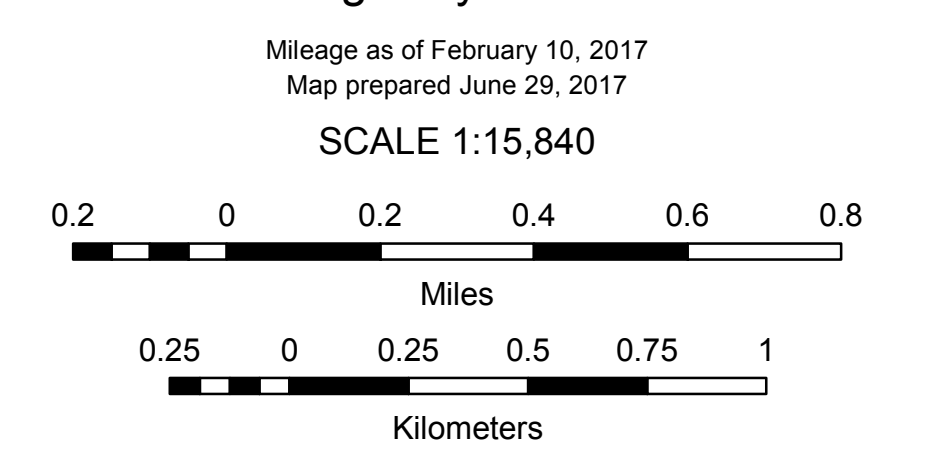

- HIGHWAYS**
- INTERSTATE
 - U.S. ROUTE
 - STATE ROUTE
 - CLASS 1
 - CLASS 2
 - CLASS 3
 - CLASS 4
 - LEGAL TRAIL
 - PARK AND RIDE
 - INTERSTATE OR DIVIDED HIGHWAY
 - STATE - HARD SURFACE OR PAVED
 - TOWN - HARD SURFACE OR PAVED
 - GRAVEL
 - SOIL OR GRADED AND DRAINED EARTH
 - UNIMPROVED OR PRIMITIVE
 - IMPASSABLE OR UNTRAVELED
 - LEGAL TRAIL
 - DISCONTINUED
 - HIGHWAY CLASS CHANGE
 - RAILROAD
 - INACTIVE RAILROAD
 - PUBLIC LAND - NATIONAL FOREST
 - PUBLIC LAND - STATE/MUNICIPAL
 - NATIONAL FOREST ROAD
 - STATE FOREST HIGHWAY

- POLITICAL SUBDIVISIONS**
- STATE BOUNDARY
 - COUNTY BOUNDARY
 - TOWN BOUNDARY
 - VILLAGE BOUNDARY
 - URBAN COMPACT BOUNDARY
 - WATER BODY
 - STREAM OR BROOK
 - BRIDGE OR CULVERT
 - BRIDGE OR CULVERT > 20'
 - BRIDGE OR CULVERT 6' - 20'
 - BIKE PATH STRUCTURE
 - VOBCIT BRIDGE
 - VOBCIT CULVERT > 6'
 - STATE BRIDGE OR CULVERT IDENTIFIER
 - TOWN BRIDGE OR CULVERT IDENTIFIER

- FEDERAL CLASSIFICATION IDENTIFIER**
- MA - MINOR ARTERIAL
 - MJC - MAJOR COLLECTOR
 - MNC - MINOR COLLECTOR
 - PA - PRINCIPAL ARTERIAL

DISCLAIMER:
The untraveled highways (laid-out town highways), discontinued highways, and legal trails hereon are those of which the Agency of Transportation has record; others may exist.

Highway and bridge data by the Agency of Transportation. Town short structures drawn from the Vermont Online Bridge & Culvert Inventory Tool (VOBCIT) database. All other data from the Vermont Center for Geographic Information. Only named streams shown.

Vermont State Plane Coordinate System
North American Datum of 1983
SPCS_Zone_Identifier: 4400
Geodetic Reference System 80
4,000-meter grid, Easting - Northing