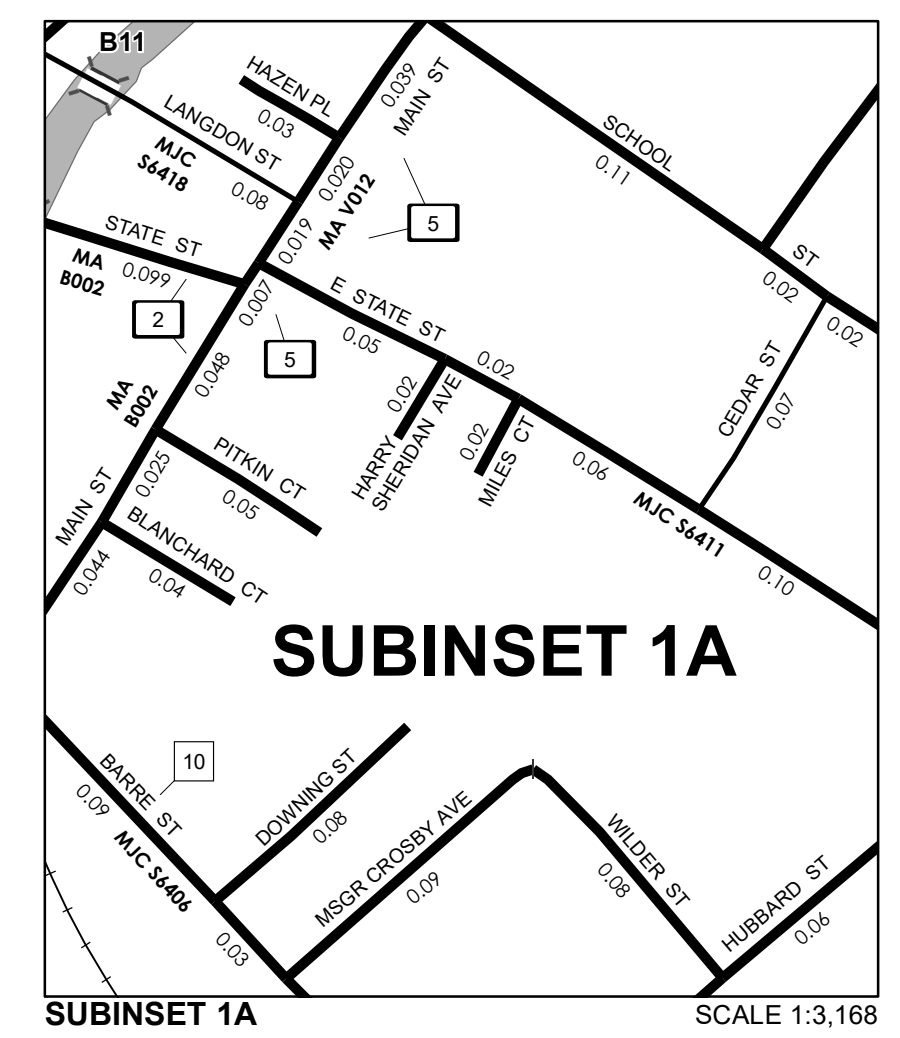
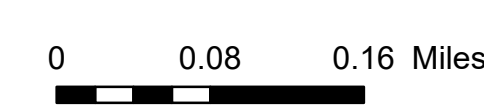
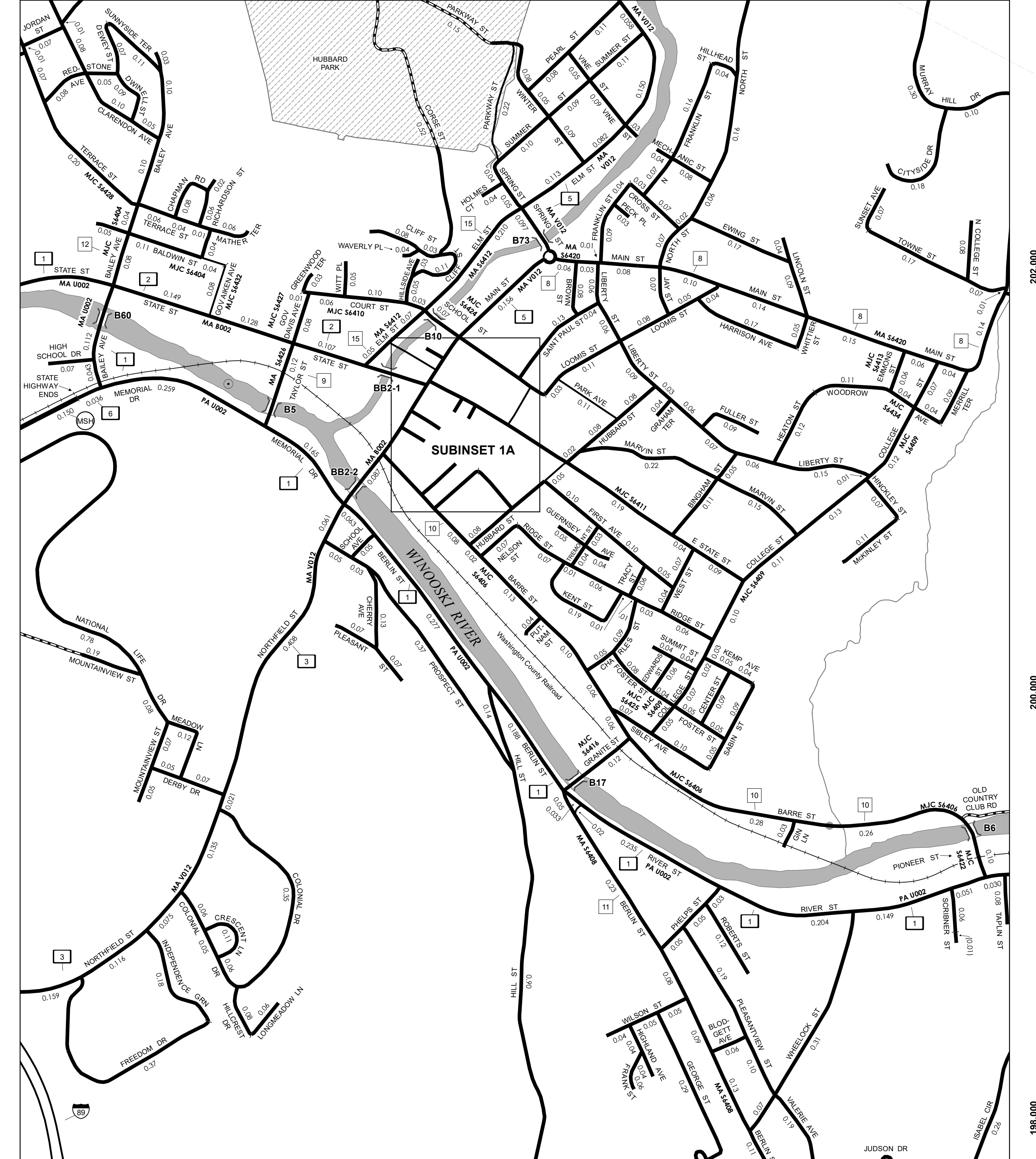
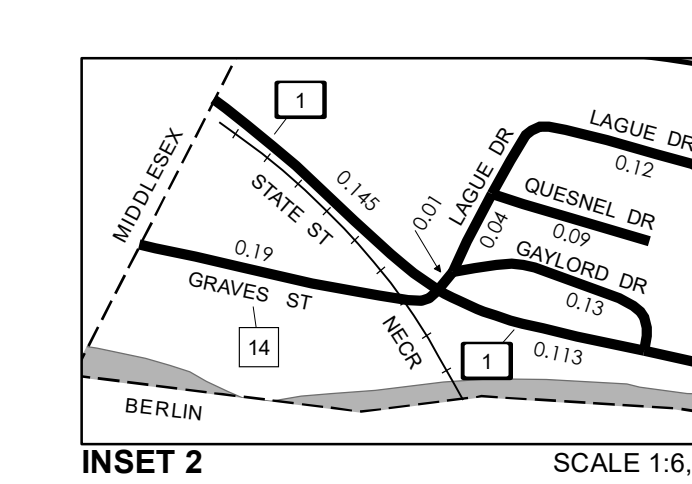

Table with 3 columns: TOWN HWY. No., LENGTH IN MILES CLASS, and TOWN ROAD NAME. It lists 157 roads with their respective lengths and classifications.

MILEAGE SUMMARY table showing totals for various road classes (TH-1 to TH-16, Ramps, STATE HIGHWAY, INTERSTATE) and a total of 56.044 miles for traveled highways as of Feb. 10, 2020.

- Legend for HIGHWAYS, LEGAL TRAIL, BRIDGE OR CULVERT, and FEDERAL CLASSIFICATION IDENTIFIER. Includes symbols for different road types and boundary lines.



VERMONT GENERAL HIGHWAY MAP City of Montpelier WASHINGTON COUNTY Transportation District #5. Includes contact information for the Vermont Agency of Transportation and a disclaimer.

DISCLAIMER: The untraveled highways (laid-out town highways), discontinued highways, and legal trails hereon are those of which the Agency of Transportation has record; others may exist.