

TOWN HWY. No.	LENGTH IN MILES CLASS 3	TOWN ROAD NAME	TOWN HWY. No.	LENGTH IN MILES CLASS 3	TOWN ROAD NAME	TOWN HWY. No.	LENGTH IN MILES CLASS 3	TOWN ROAD NAME
101	0.23	BAILEY AVE	158	0.30	GRANDVIEW TER	216	1.32	NORTH ST
102	0.20	BALDWIN ST	159	0.12	GRANITE ST	217	0.53	OLD COUNTRY CLUB RD
103	0.18	BALLFIELD DR	160	0.40	GREEN MOUNTAIN DR	218	0.11	PARK AVE
104	0.15	BINGHAM ST	161	0.20	GREENFIELD TER	219	0.11	PARKSIDE DR
105	0.08	BLACKWELL ST	162	0.19	GREENOCK AVE	220	0.37	PARKWAY ST
106	0.04	BLANCHARD CT	163	0.03	GREENWOOD TER	221	0.19	PEARL ST
107	0.44	BLISS RD	164	0.04	GROUT RD	222	0.03	PECK PL
108	0.06	BLODGETT AVE	165	0.09	GUERNSEY AVE	223	0.16	PERKINS RD
109	0.28	BROWN ST	166	0.17	HACKAMORE RD	224	0.13	PHILIPS ST
110	0.07	CEDAR ST	167	0.03	HAGGETT RD	225	0.13	PHILLIPS RD
111	0.09	CENTER ST	168	0.17	HARRISON AVE	226	0.18	PINEWOOD RD
112	0.08	CHAPMAN RD	169	0.02	HARRY SHERIDAN AVE	227	0.05	PITKIN CT
113	0.14	CHARLES ST	170	0.03	HAZEN ST	228	0.14	PLEASANT ST
114	0.13	CHERRY AVE	171	0.12	HEATON ST	229	0.29	PLEASANTVIEW ST
115	0.25	CHESTNUT HILL RD	172	0.44	HEBERT RD	230		POOLSIDE DR
116	0.17	FINCH RD	173	0.07	HIGH SCHOOL DR	231	0.45	PROSPECT ST
117	0.18	CITYSIDE DR	174	0.08	HIGHLAND AVE	232	0.04	PUTNAM ST
118	0.49	CLARENDON AVE	175	1.04	HILL ST	233	0.09	QUESNEL DR
119	0.22	CLIFF ST	176	0.08	HILLCREST DR	234	0.13	REDSTONE AVE
120	0.71	COLLEGE ST	177	0.04	HILLHEAD ST	235	0.08	RICHARDSON ST
121	0.52	COLONIAL DR	178	0.08	HILLSIDE AVE	236	0.25	ROBERTS ST
122	0.06	COOLIDGE ST	179	0.07	HINCKLEY ST	237	0.12	ROBINHOOD CIR
123	0.07	CORRY RD	180	0.04	HOLMES CT	238	0.16	SABIN ST
124	0.52	CORSE ST	181	0.04	HOPKINS ST	239	0.14	SCHOOL AVE
125	0.19	COUNTRY CLUB RD	182	0.27	HORN OF THE MOON RD	240	0.05	SCHOOL ST
126	0.20	COURT ST	183	0.37	HUBBARD PARK DR	241	0.22	SCRIBNER ST
127	0.11	CRESCENT LN	184	0.37	HUBBARD ST	242		SCRIBNER ST
128	0.07	CRESTVIEW DR	185	0.18	INDEPENDENCE GRN	242	0.06	SCRIBNER ST
129	0.10	CROSS ST	186	0.26	ISABEL CIR	243	0.54	SHERWOOD DR
130		CUMMINGS ST	187	0.07	JAY ST	244	0.17	SIBLEY AVE
131	0.12	DAIRY LN	188	0.07	JORDAN ST	245	0.30	SPRING HOLLOW LN
132	0.52	DEERFIELD DR	189	0.15	JUDSON DR	246	0.09	SPRING ST
133	0.12	DERBY DR	190	0.09	KEMP AVE	247	0.17	SAINT PAUL ST
134	0.06	DEWEY ST	191	0.19	KENT ST	248	0.30	SUMMER ST
135	0.20	DOVER RD	192	0.17	LAGUE DR	249	0.08	SUMMIT ST
136	0.08	DOWNING ST	193	0.08	LANGDON ST	250	0.11	SUNNYSIDE TER
137	0.16	DUNPATRICK CIR	194	0.58	LIBERTY ST	251	0.07	SUNSET AVE
138	0.09	DWYNE ST	195	0.13	LINCOLN AVE	252	0.08	TAPLIN ST
139	0.08	DYER AVE	196	0.06	LONGMEADOW DR	253	0.11	TERRACE ST
140	0.55	E STATE ST	197	0.31	LOOMIS ST	254	0.24	TOWNE ST
141	0.06	EDWARDS ST	198	0.37	MARVIN ST	255	0.06	TRACY ST
142	0.06	EMMONS ST	199	0.06	MATHER TER	256	0.07	TREMONT ST
143	0.08	EMMONS ST	200	0.11	MCKINLEY ST	257	0.19	VALERIE AVE
144	0.25	FIRST AVE	201	0.12	MEADOW LN	258	0.11	VELO RD
145	0.20	FOREST DR	202	0.12	MECHANIC ST	259	0.17	VINE ST
146	0.22	FOSTER ST	203	0.09	MERRILL TER	260	0.07	WALKER TER
147	0.06	FRANK ST	204	0.02	MILL RD	261	0.04	WAVERLY PL
148	0.13	FRANKLIN ST	205	0.42	MILL RD	262	0.11	WEST ST
149	0.37	FREEDOM DR	206	0.15	MOONLIGHT TER	263	0.36	WESTWOOD DR
150	0.09	FULLER ST	207	0.39	MOUNTAINVIEW ST	264	0.38	WHELOCK ST
151	0.13	GAYLORD DR	208	0.09	MONSIGNOR CROSBY AVE	265	0.05	WHITTIER ST
152	0.29	GEORGE ST	209	0.40	MURRAY HILL DR	266	0.08	WILDER ST
153	0.22	GIDNEY PL	210	0.45	MURRAY RD	267	0.14	WILSON ST
154	1.07	GOULD HILL RD	211	0.08	N COLLEGE ST	268	0.22	WINTER ST
155	0.08	GOV DAVIS AVE	212	0.23	N FRANKLIN ST	269	0.05	WITT PL
156	0.08	GOVERNOR ARKEN AVE	213	0.27	N PARK DR	270	0.19	WOODCREST RD
157	0.04	GRAHAM TER	214	0.78	NATIONAL LIFE DR	271	0.19	WOODROW AVE
			215	0.07	NELSON ST			
					<b>TOTAL</b>	<b>33.04</b>	<b>0.53</b>	

**MILEAGE SUMMARY**

CLASS	TH-1	TH-2	TH-3	TH-4	TH-5	TH-6	TOTAL CLASS 1
	4.490	0.687	0.975	0.862	3.455	0.036	10.505
<b>CLASS 1 - Ramps</b>							
TH-1	0.026						0.026
<b>CLASS 2</b>							
TH-7	0.050						0.050
TH-8	1.641						1.641
TH-9	0.120						0.120
TH-10	1.210						1.210
TH-11	1.100						1.100
TH-12	1.680						1.680
TH-13	1.960						1.960
TH-14	0.190						0.190
TH-15	0.330						0.330
TH-16	0.910						0.910
<b>CLASS 2 - Ramps</b>							
TH-11	0.020						0.020
<b>CLASS 3</b>							
							33.04
							<b>TOTAL TOWN</b>
							<b>51.882</b>

STATE HIGHWAY	NSH-MJSH	NSH-MGH	TOTAL STATE HIGHWAY
	0.757	0.854	1.611
<b>STATE HIGHWAY - Ramps</b>			
NSH-MJSH	0.196		0.196
<b>TOTAL STATE</b>			
			<b>1.807</b>

INTERSTATE	I-89	TOTAL INTERSTATE
	1.545	1.545
<b>INTERSTATE - Ramps</b>		
I-89	0.780	0.780
<b>TOTAL INTERSTATE</b>		
		<b>2.325</b>

**TOTAL, TRAVELED HIGHWAYS, FEB. 10, 2019: 56.014**  
(Excludes Class 4 and Legal Trail Mileage)

- HIGHWAYS**
- INTERSTATE
  - U.S. ROUTE
  - STATE ROUTE
  - CLASS 1
  - CLASS 2
  - CLASS 3
  - CLASS 4
  - LEGAL TRAIL
  - GRAVEL
  - SOIL OR GRADED AND DRAINED EARTH
  - UNIMPROVED OR PRIMITIVE
  - IMPASSABLE OR UNTRAVELED
  - LEGAL TRAIL
  - DISCONTINUED
  - HIGHWAY CLASS CHANGE
  - RAILROAD
  - INACTIVE RAILROAD
  - PUBLIC LAND - NATIONAL FOREST
  - PUBLIC LAND - STATE/MUNICIPAL
- POLITICAL SUBDIVISIONS**
- STATE BOUNDARY
  - COUNTY BOUNDARY
  - TOWN BOUNDARY
  - VILLAGE BOUNDARY
  - URBAN COMPACT BOUNDARY
  - WATER BODY
  - STREAM OR BROOK
- BRIDGE OR CULVERT**
- BRIDGE OR CULVERT > 20'
  - BRIDGE OR CULVERT 6' - 20'
  - BIKE PATH STRUCTURE
  - VT CULVERTS
  - VT CULVERTS CULVERT > 6'
- B34 / C34** STATE BRIDGE OR CULVERT IDENTIFIER  
**B34 / C34** TOWN BRIDGE OR CULVERT IDENTIFIER
- NFR** NATIONAL FOREST ROAD  
**SFH** STATE FOREST HIGHWAY  
**P** PARK AND RIDE
- FEDERAL CLASSIFICATION IDENTIFIER**
- MA MINOR ARTERIAL
  - MJC MAJOR COLLECTOR
  - MNC MINOR COLLECTOR
  - PA PRINCIPAL ARTERIAL
- DISCLAIMER:**  
 The untraveled highways (laid-out town highways), discontinued highways, and legal trails hereon are those of which the Agency of Transportation has record; others may exist.
- Vermont State Plane Coordinate System  
 North American Datum of 1983  
 SPCS Zone Identifier: 4400  
 Geoidetic Reference System 80  
 2,000-meter grid, Easting - Northing

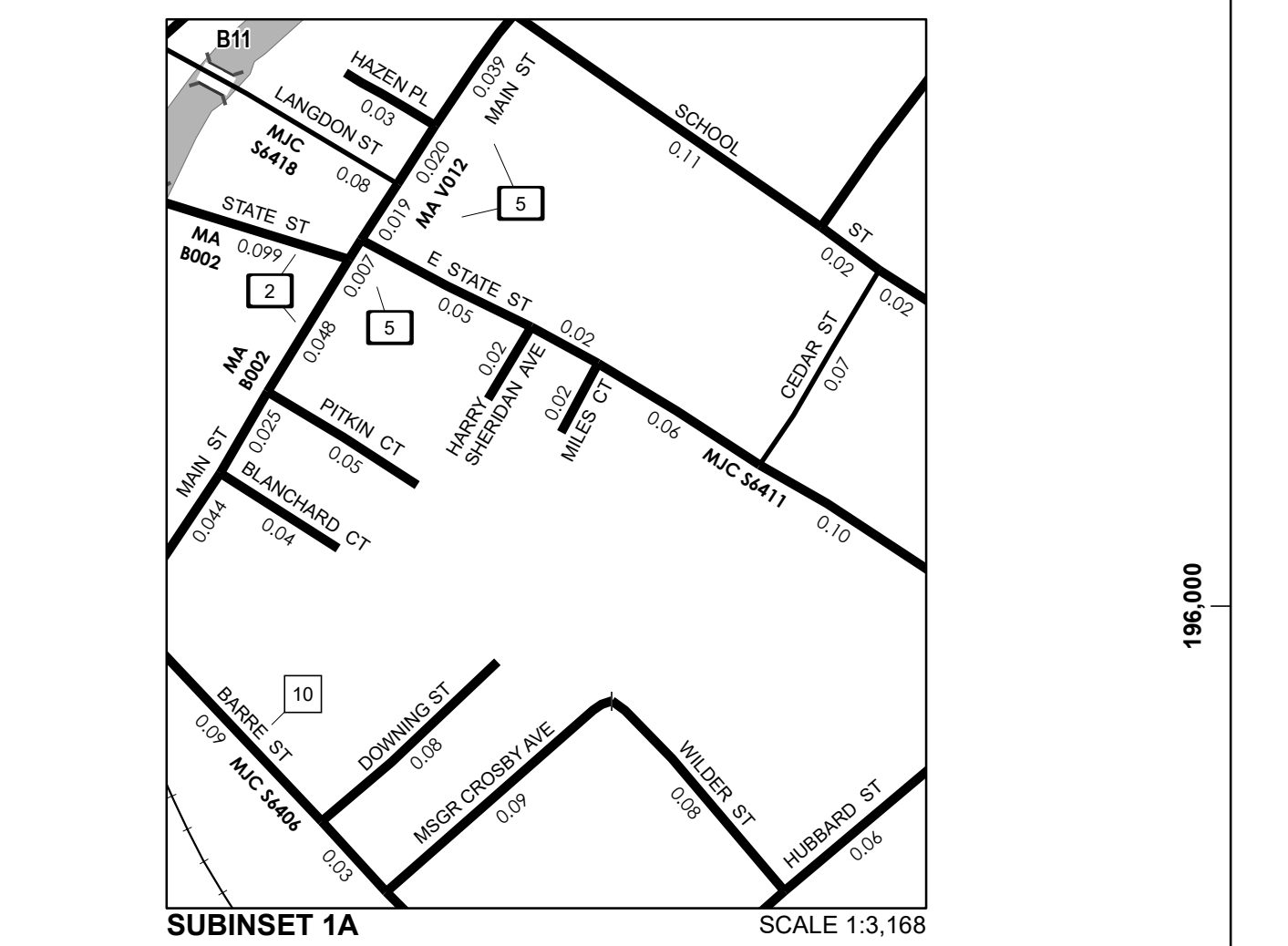
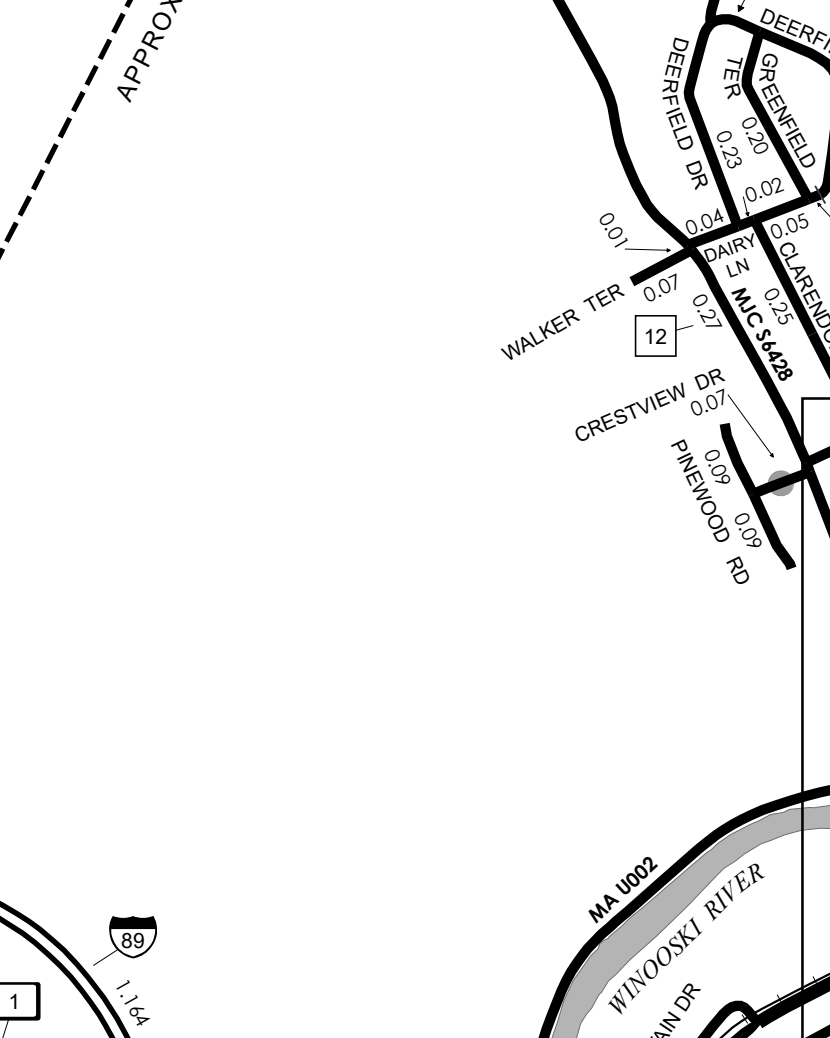
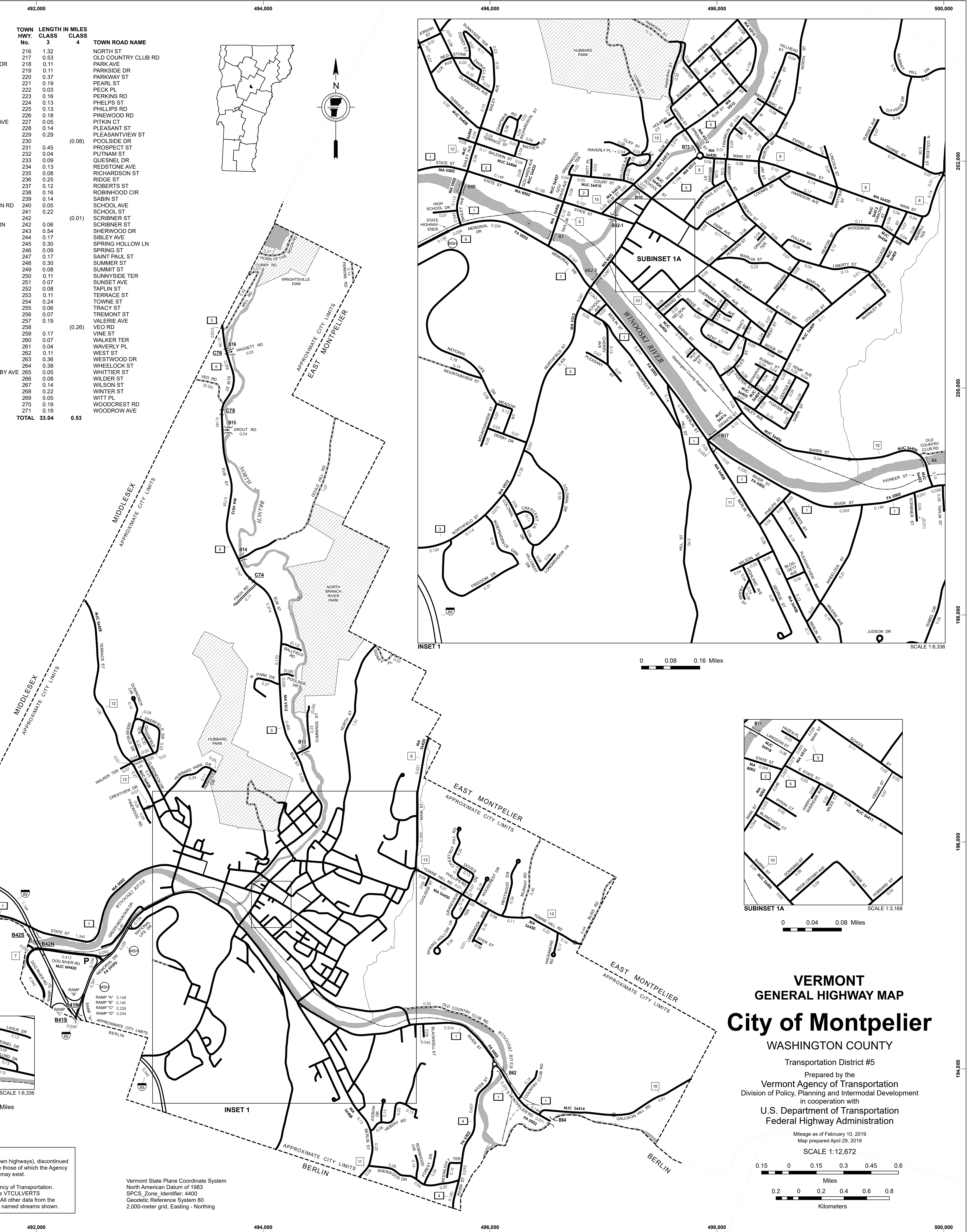

**VERMONT GENERAL HIGHWAY MAP**  
**City of Montpelier**  
 WASHINGTON COUNTY  
 Transportation District #5

Prepared by the  
 Vermont Agency of Transportation  
 Division of Policy, Planning and Intermodal Development  
 in cooperation with  
 U.S. Department of Transportation  
 Federal Highway Administration

Mileage as of February 10, 2019  
 Map prepared April 29, 2019  
 SCALE 1:12,672

0 0.15 0.3 0.45 0.6 Miles  
 0 0.2 0.4 0.6 0.8 Kilometers