

TOWN HWY. NO.	LENGTH IN MILES CLASS 3	LENGTH IN MILES CLASS 4		
5	3.450		37	1.800
6		(1.300)	38	3.900
7		(0.500)	39	0.400
8		(1.600)	40	0.420 (0.390)
9	3.200		41	0.910
10	1.900		42	2.450
11		(0.200)	43	0.190 (0.410)
12	1.460		44	1.240 (0.020)
13	0.530		45	1.300
14		(0.300)	46	4.660
15	0.730		47	0.100
16	1.400	(1.400)	48	1.750
17	0.200		49	0.780 (0.720)
18	1.940	(0.540)	50	0.880
19	0.800		51	0.600 (0.800)
20	0.850		52	0.120 (0.930)
21	1.330		53	1.300
22		(0.150)	54	0.400
23	0.330		56	0.450
24		(0.180)	57	0.950
25	1.200		59	0.300
26	0.100		60	1.300
27	1.570		61	0.800
28	0.300	(0.800)	62	0.150
30	0.550		63	
31		(0.200)	64	0.140 (0.370)
32	1.350		65	0.250
33	2.450		66	0.080
34		(0.300)	67	0.040
35	0.540	(0.740)	68	0.150
36	0.710	(0.690)	69	0.060
TOTAL	54.760		12.540	

MILEAGE SUMMARY

CLASS 2		
TH-1	8.120	
TH-2	2.350	
TH-3	3.200	
TH-4	2.000	
TH-5	2.100	
TH-6	0.350	
TH-7	0.330	
TOTAL CLASS 2	18.450	
TOTAL CLASS 3	54.760	
TOTAL TOWN	73.210	
STATE HIGHWAY		
VT-14	6.902	
TOTAL STATE HIGHWAY	6.902	
TOTAL STATE	6.902	

TOTAL, TRAVELED HIGHWAYS, FEB. 10, 2007: 80.112
(Excludes Class 4 and Legal Trail Mileage)

- HIGHWAYS**
- INTERSTATE
 - U.S. ROUTE
 - STATE ROUTE
 - CLASS 1
 - CLASS 2
 - CLASS 3
 - CLASS 4
 - STATE - HARD SURFACE OR PAVED
 - TOWN - HARD SURFACE OR PAVED
 - GRAVEL
 - SOIL OR GRADED AND DRAINED EARTH
 - UNIMPROVED OR PRIMITIVE
 - IMPASSABLE OR UNTRAVELED
 - LEGAL TRAIL
 - DISCONTINUED
 - HIGHWAY CLASS CHANGE
 - RAILROAD
- PUBLIC LAND**
- PUBLIC LAND
- POLITICAL SUBDIVISIONS**
- STATE BOUNDARY
 - COUNTY BOUNDARY
 - TOWN BOUNDARY
 - VILLAGE BOUNDARY
 - URBAN COMPACT BOUNDARY
- WATER BODIES**
- OPEN WATER
 - SWAMP
 - STREAM OR BROOK
- BRIDGE OR CULVERT**
- BRIDGE OR CULVERT GREATER THAN 20'
 - BRIDGE OR CULVERT 6' - 20'
 - B34 STATE BRIDGE IDENTIFIER
 - B34 TOWN BRIDGE IDENTIFIER
- FEDERAL CLASSIFICATION IDENTIFIER**
- FAU URBAN ARTERIAL OR COLLECTOR
 - MA MINOR ARTERIAL
 - MJC MAJOR COLLECTOR
 - MNC MINOR COLLECTOR
 - PA PRINCIPAL ARTERIAL

DISCLAIMER:
Highway and bridge data by the Agency of Transportation, Policy & Planning Division. All other data from the Vermont Center for Geographic Information.

Vermont State Plane Coordinate System
North American Datum of 1983
SPCS Zone Identifier: 4400
Geodetic Reference System 80
4,000-meter grid, Easting - Northing

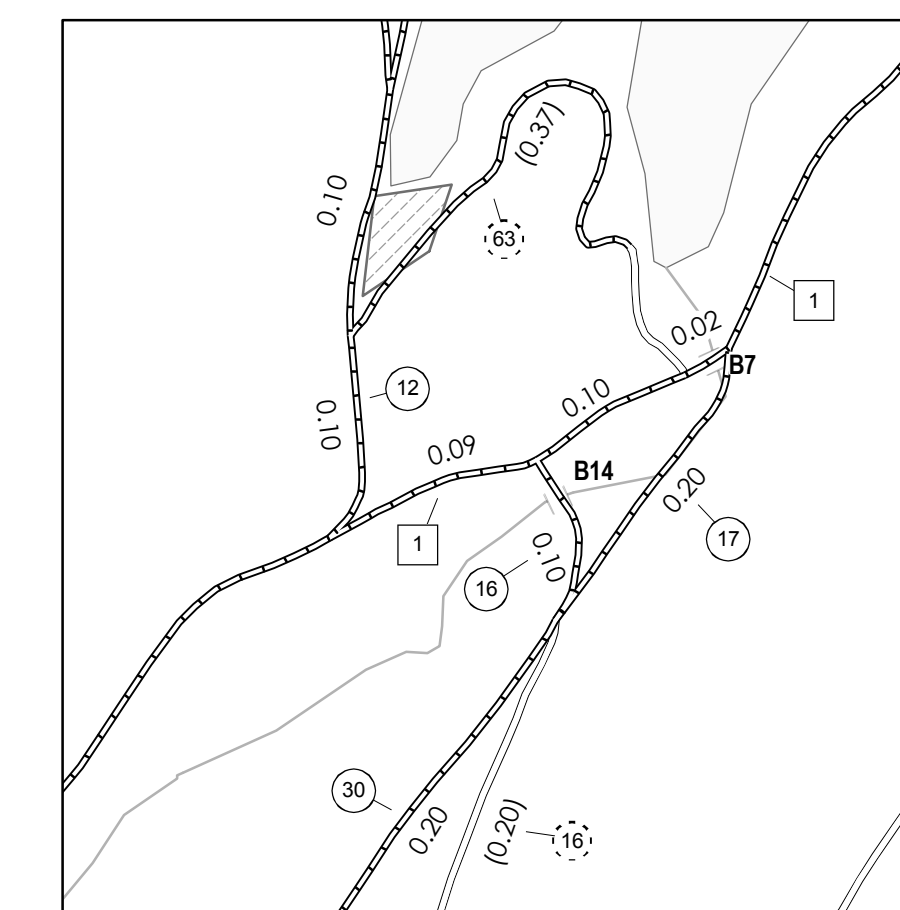

NORTH CALAIS INSET 1
SCALE 1:6336
0 0.15 0.3 0.45
MILES
SCALE FOR INSETS (UNLESS OTHERWISE NOTED)

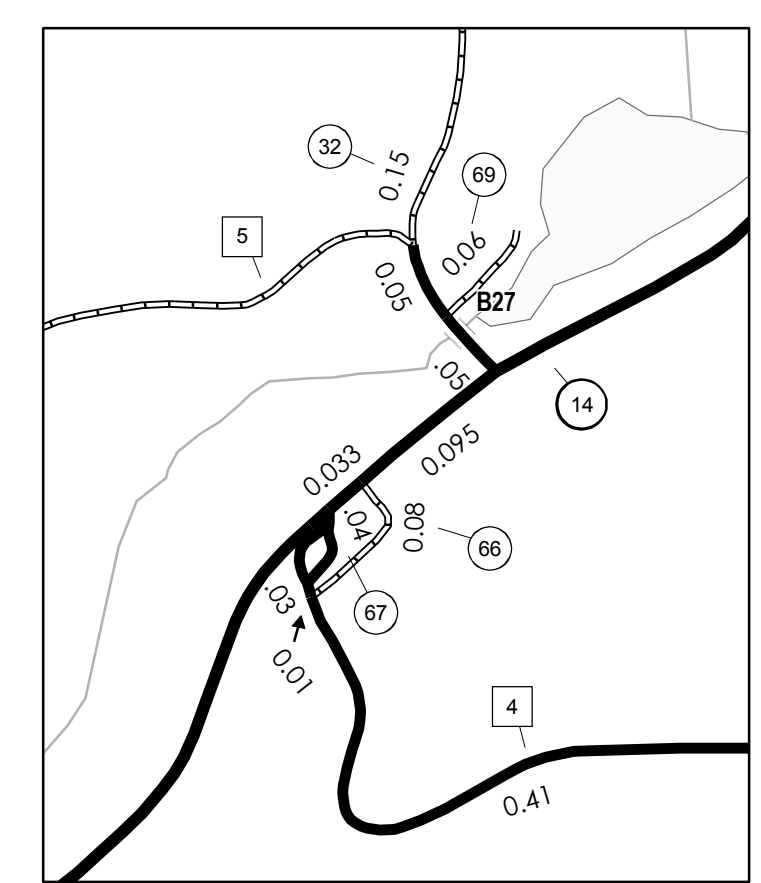

EAST CALAIS INSET 2

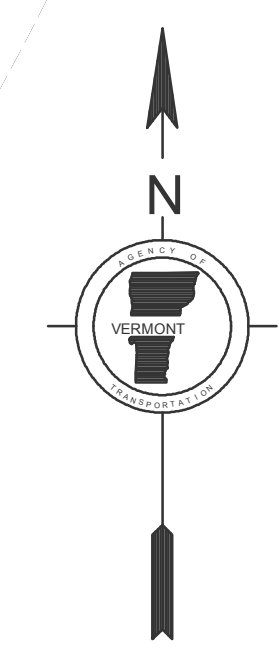

VERMONT GENERAL HIGHWAY MAP
Town of Calais
WASHINGTON COUNTY

Transportation District #6

Prepared by the
Vermont Agency of Transportation
Policy & Planning Division
in cooperation with
U.S. Department of Transportation
Federal Highway Administration

Mileage as of: Feb. 10, 2007
Map generated: October, 2007

