

TOWN HWY. NO.	LENGTH IN MILES	CLASS 3	CLASS 4
4	0.180		49
5	4.130		50
6	0.650	(0.130)	51
7	0.850		52
8	0.180		53
9	0.230		54
10	0.640		55
11	0.400		56
12	0.450		57
13	1.390	(0.250)	58
14	0.240		59
15	0.600		60
16	0.810		61
17	0.650	(0.780)	62
18	1.320		63
19	0.300		64
20	0.880		65
21	0.260		66
22	0.220	(0.250)	67
23	0.450		68
24	0.290		69
25	0.780		70
26	0.160		71
27	0.160		72
28	0.460		73
29	0.420	(1.170)	74
30	0.150		75
31	0.350		76
32	2.160	(0.380)	77
33	0.480	(0.480)	78
34	0.500	(0.500)	79
35	0.200	(0.080)	80
36	1.620		81
37	0.690		82
38	0.530	(0.470)	83
39	0.090	(0.610)	84
40	0.190		85
41	0.530		86
42	0.320		87
43			88
44			89
45			169
46			
47			
48			
TOTAL	42.120		8.540

* This portion of town highway is Class 3, but is functionally Class 4

MILEAGE SUMMARY	
CLASS 2	
TH-1	2.420
TH-2	1.470
TOTAL CLASS 2	3.890
CLASS 3	
TOTAL CLASS 3	42.120
TOTAL TOWN	46.010
STATE HIGHWAY	
VT-7B	0.774
VT-103	2.132
VT-140	6.343
VT-155	0.412
TOTAL STATE HIGHWAY	9.661
US HIGHWAY	
US-7	7.094
TOTAL US HIGHWAY	7.094
TOTAL STATE	16.755

TOTAL, TRAVELED HIGHWAYS, FEB. 10, 2007: 62.765
(Excludes Class 4 and Legal Trail Mileage)

- HIGHWAYS**
 - INTERSTATE
 - U.S. ROUTE
 - STATE ROUTE
 - CLASS 1
 - CLASS 2
 - CLASS 3
 - CLASS 4
 - INTERSTATE OR DIVIDED HIGHWAY
 - STATE - HARD SURFACE OR PAVED
 - TOWN - HARD SURFACE OR PAVED
 - NATIONAL FOREST - HARD SURFACE OR PAVED
 - GRAVEL
 - SOIL OR GRADED AND DRAINED EARTH
 - UNIMPROVED OR PRIMITIVE
 - IMPASSABLE OR UNTRAVELED
 - LEGAL TRAIL
 - DISCONTINUED
 - HIGHWAY CLASS CHANGE
 - RAILROAD
- FEDERAL CLASSIFICATION IDENTIFIER**
 - FAU URBAN ARTERIAL OR COLLECTOR
 - MA MINOR ARTERIAL
 - MJC MAJOR COLLECTOR
 - MNC MINOR COLLECTOR
 - PA PRINCIPAL ARTERIAL
- PUBLIC LAND**
- POLITICAL SUBDIVISIONS**
 - STATE BOUNDARY
 - COUNTY BOUNDARY
 - TOWN BOUNDARY
 - VILLAGE BOUNDARY
 - URBAN COMPACT
- WATER BODIES**
 - OPEN WATER
 - SWAMP
 - STREAM OR BROOK
- BRIDGE OR CULVERT**
 - BRIDGE OR CULVERT GREATER THAN 20'
 - BRIDGE OR CULVERT 6' - 20'
- STATE BRIDGE IDENTIFIER**
 - B34 STATE BRIDGE IDENTIFIER
 - B34 TOWN BRIDGE IDENTIFIER

DISCLAIMER:
The untraveled highways (laid-out town highways), discontinued highways, and legal trails shown hereon are those of which the Agency of Transportation has record; others may exist.
Highway and bridge data by the Agency of Transportation, Policy & Planning Division. All other data from the Vermont Center for Geographic Information.

Vermont State Plane Coordinate System
North American Datum of 1983
SPCS Zone Identifier: 4400
Geodetic Reference System 80
4,000-meter grid, Easting - Northing

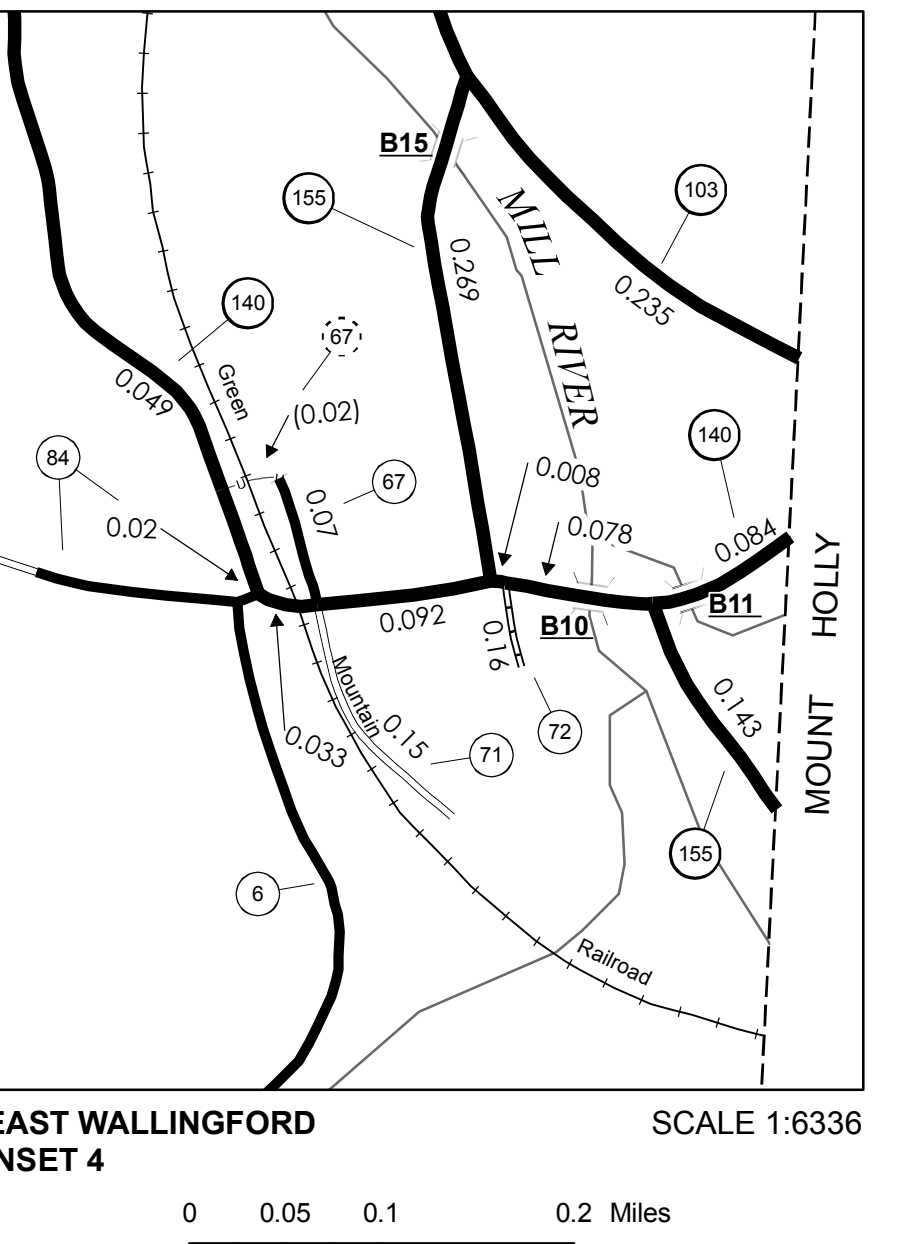
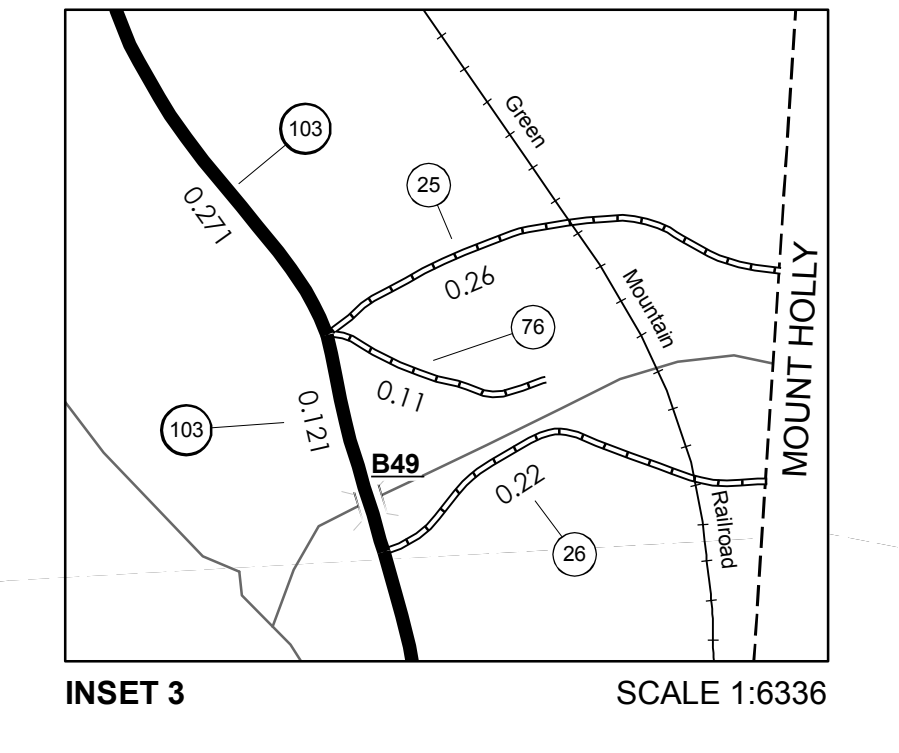
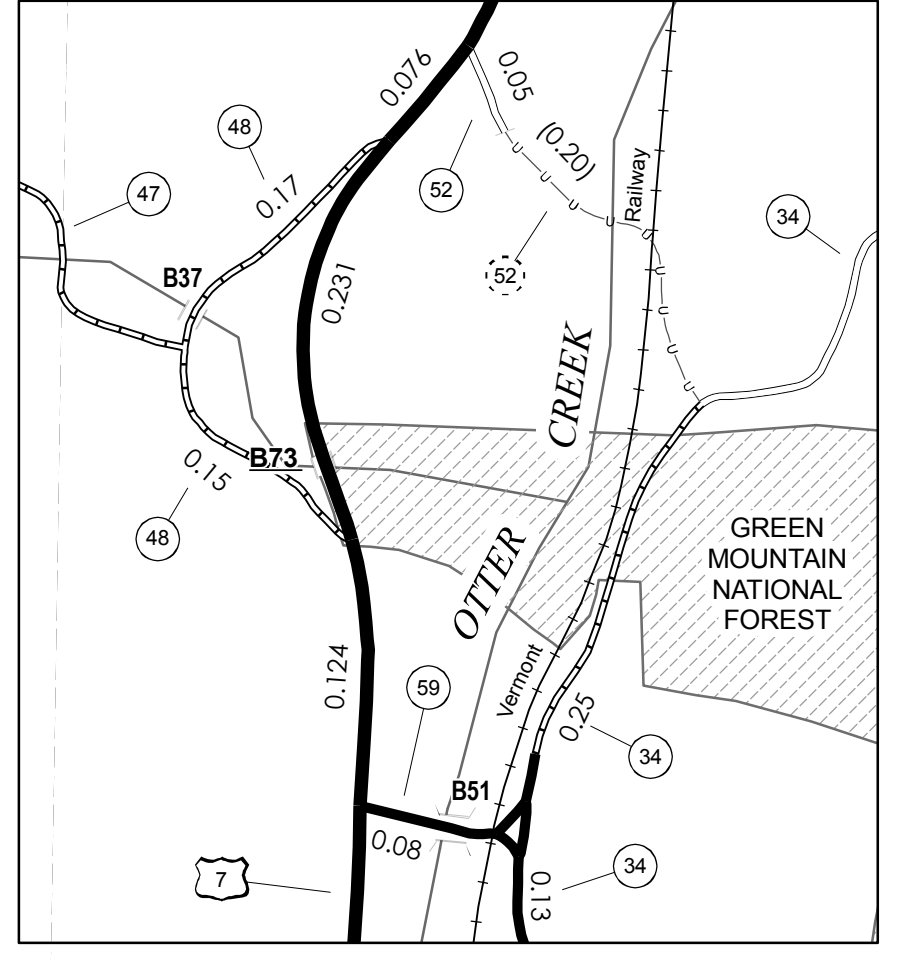
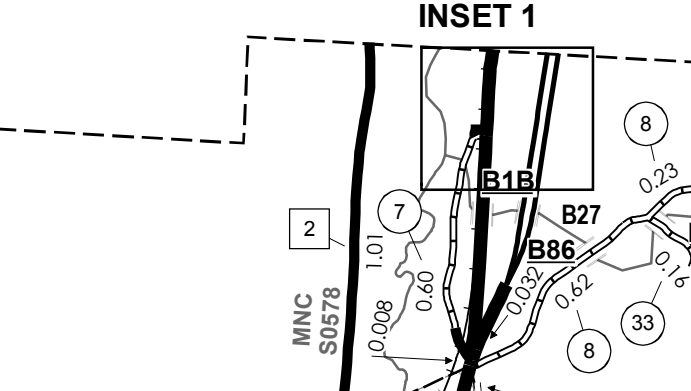
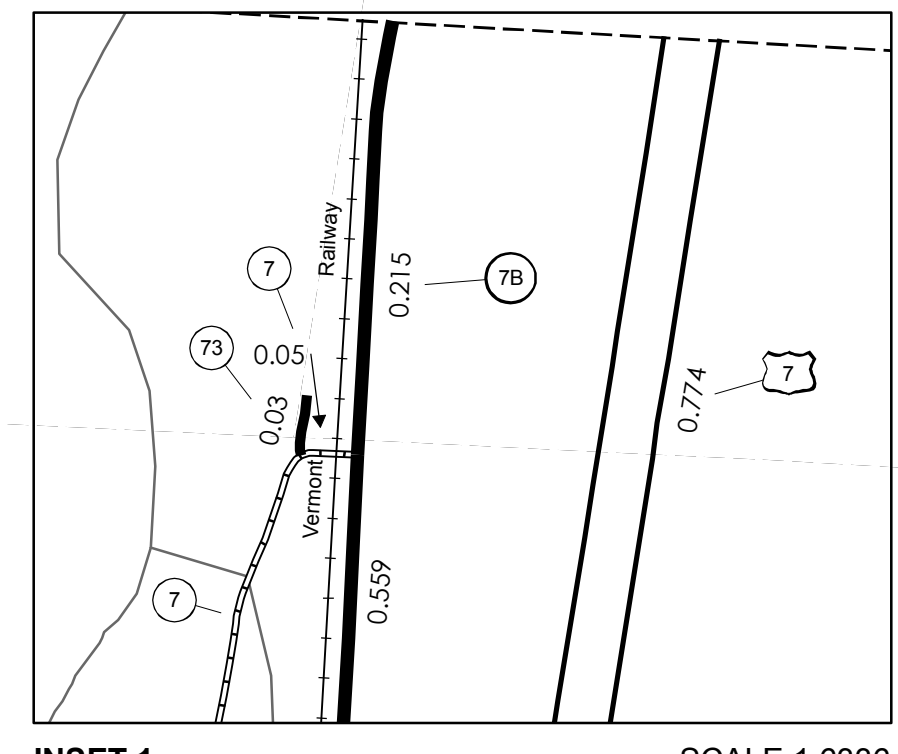

VERMONT GENERAL HIGHWAY MAP

Town of Wallingford

RUTLAND COUNTY

Transportation District #3

Prepared by the
Vermont Agency of Transportation
Policy & Planning Division
in cooperation with
U.S. Department of Transportation
Federal Highway Administration

Mileage as of: Feb. 10, 2007
Map generated: October, 2007

