

TOWN HWY. NO.	LENGTH IN MILES CLASS 3	LENGTH IN MILES CLASS 4
3	3.12	
4	1.31	
5		(0.94)
6		(2.70)
7		(0.40)
8		(0.80)
9	0.19	
10	0.23	
11	0.24	
12	1.85	
13		(0.40)
14		(0.50)
16	1.32	
17		(0.40)
18	0.07	(0.37)
18		(0.06)
19	1.80	
20	0.70	
21	0.23	
22		(0.03)
23	0.45	
24		(0.25)
25	0.10	
26	0.05	(1.15)
27	0.12	
28	0.12	
29	0.59	
30	0.38	
31	1.65	
32	0.23	
33	0.71	
34	0.65	
35	0.43	
36	0.20	
37	0.07	
38	0.10	
39	0.08	
40	0.58	
41	0.08	
42	0.08	
43	0.85	
44	0.50	
45	0.31	
46	0.14	
47	0.10	
48	0.44	
49	0.30	
50	0.20	
51	0.10	
52	0.10	
TOTAL	20.77	8.00

* This portion of town highway is Class 3, but is functionally Class 4

MILEAGE SUMMARY

CLASS 2			
TH-1	3.310		
	TOTAL CLASS 2	3.310	
CLASS 3			
	TOTAL CLASS 3	20.770	
	TOTAL TOWN	24.080	
STATE HIGHWAY			
VT-105	8.376		
VT-242	5.092		
	TOTAL STATE HIGHWAY	13.468	
	TOTAL STATE	13.468	

TOTAL, TRAVELED HIGHWAYS, FEB. 10, 2011: 37.548
(Excludes Class 4, Legal Trail, and Unidentified Corridor Mileage)

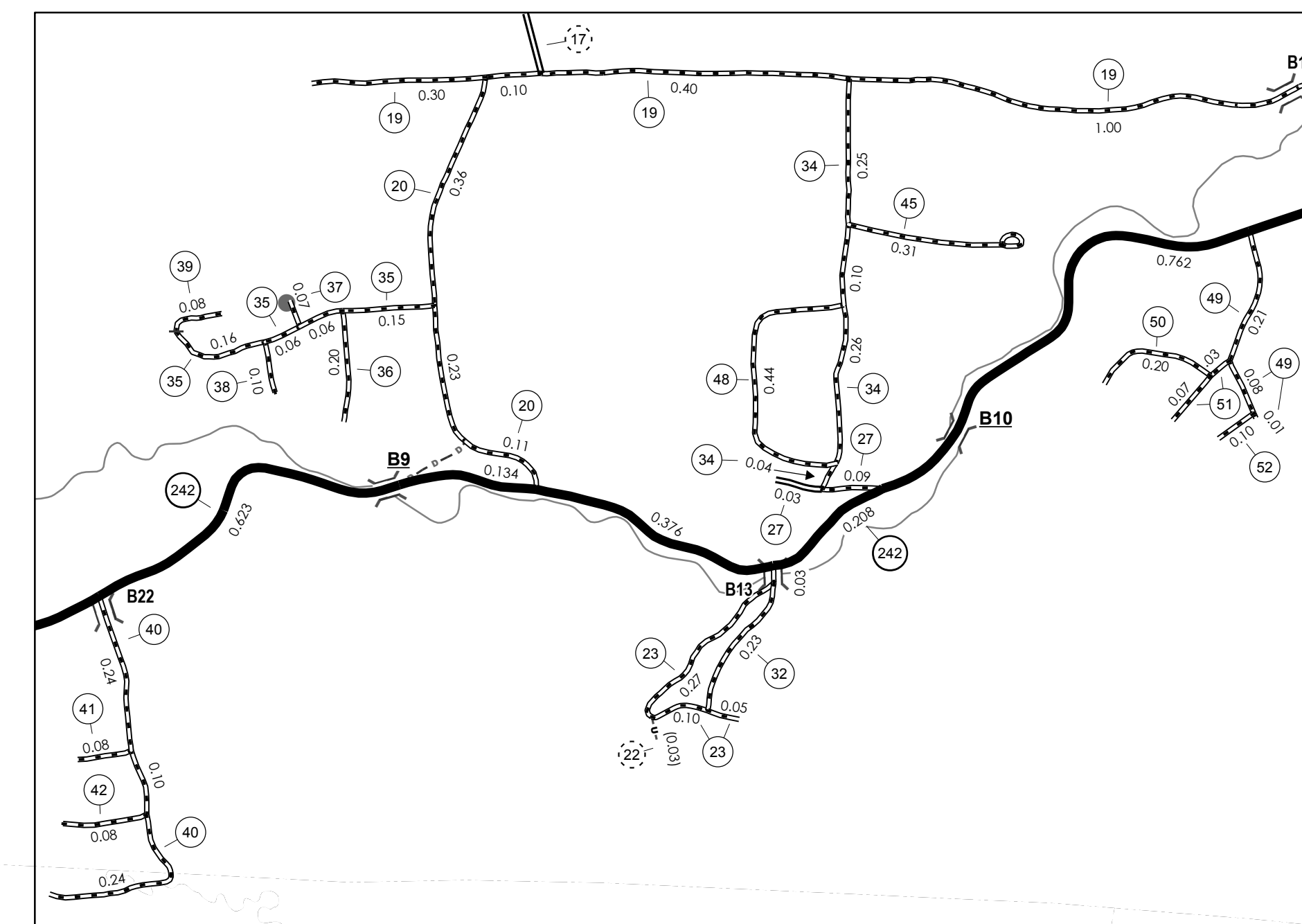

INSET 1
0 0.2 0.4 Miles
INSET SCALE 1:12672

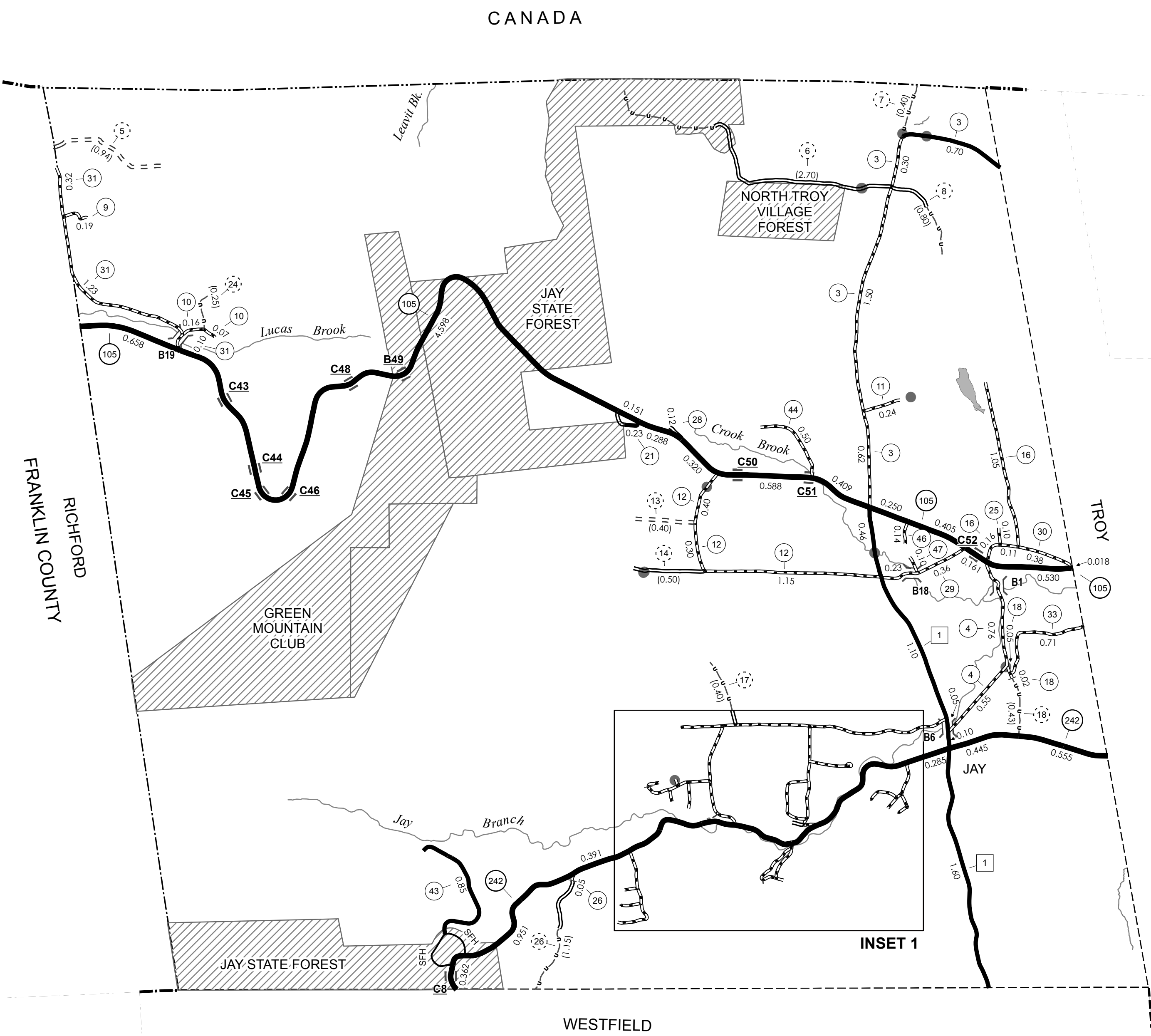

- HIGHWAYS**
- INTERSTATE
 - U.S. ROUTE
 - STATE ROUTE
 - CLASS 1
 - CLASS 2
 - CLASS 3
 - CLASS 4
 - LEGAL TRAIL
 - INTERSTATE OR DIVIDED HIGHWAY
 - STATE - HARD SURFACE OR PAVED
 - TOWN - HARD SURFACE OR PAVED
 - STATE FOREST HIGHWAY
 - GRAVEL
 - SOIL OR GRADED AND DRAINED EARTH
 - UNIMPROVED OR PRIMITIVE
 - IMPASSABLE OR UNTRAVELED
 - LEGAL TRAIL
 - DISCONTINUED
 - HIGHWAY CLASS CHANGE
 - RAILROAD
 - INACTIVE RAILROAD
- POLITICAL SUBDIVISIONS**
- PUBLIC LAND
 - STATE BOUNDARY
 - COUNTY BOUNDARY
 - TOWN BOUNDARY
 - VILLAGE BOUNDARY
 - URBAN COMPACT BOUNDARY
 - WATER BODY
 - STREAM OR BROOK
- BRIDGE OR CULVERT**
- BRIDGE OR CULVERT GREATER THAN 20'
 - BRIDGE OR CULVERT 6' - 20'
 - TOWN SHORT STRUCTURE
- FEDERAL CLASSIFICATION IDENTIFIER**
- FAU URBAN ARTERIAL OR COLLECTOR
 - MA MINOR ARTERIAL
 - MJC MAJOR COLLECTOR
 - MNC MINOR COLLECTOR
 - PA PRINCIPAL ARTERIAL
- STATE BRIDGE OR CULVERT IDENTIFIER**
- B34 / C34 STATE BRIDGE OR CULVERT IDENTIFIER
 - B34 / C34 TOWN BRIDGE OR CULVERT IDENTIFIER

STRUCTURES - SURFACE WATER NOTE:

STRUCTURES:
Town short structures (bridges or culverts from 6-feet to less than 20-feet) are drawn from the Vermont Online Bridge & Culvert Inventory Tool (VOBCIT) database.
NOTE: Town shorts are not consistently tagged within VOBCIT.

SURFACE WATERS:
The surface waters are from the Vermont Hydrological Dataset (VHD). Only the named streams are shown.

DISCLAIMER:

The untraveled highways (laid-out town highways), discontinued highways, and legal trails shown hereon are those of which the Agency of Transportation has record; others may exist.

Highway and bridge data by the Agency of Transportation. All other data from the Vermont Center for Geographic Information.

Vermont State Plane Coordinate System
North American Datum of 1983
SPCS Zone Identifier: 4400
Geodetic Reference System 80
4,000-meter grid, Easting - Northing

VERMONT
GENERAL HIGHWAY MAP
Town of Jay
ORLEANS COUNTY

Transportation District #9
Prepared by the
Vermont Agency of Transportation
Division of Policy, Planning & Intermodal Development
in cooperation with
U.S. Department of Transportation
Federal Highway Administration

