

TOWN HWY. No.	LENGTH IN MILES CLASS 3	LENGTH IN MILES CLASS 4
6	4.50	
7		(0.15)
8	1.92	(0.30)
9		(0.44)
10	0.71	
11	0.39	
12	3.25	
13	0.25	
14	0.51	
15	3.85	
16	0.84	
17	1.03	(0.19)
18	1.69	(1.26)
19	0.13	
20	0.30	
21	0.25	
22		(0.10)
23	0.20	
24	0.14	(0.40)
25	1.11	
26	0.10	(0.35)
27	0.34	
28	0.55	(0.84)
30	3.27	
31	0.02	(0.52)
32		(0.25)
33	0.15	
34	0.45	
35		(0.50)
36		(1.00)
37	0.15	
38	0.24	
39	0.06	
40	0.05	
41	0.03	
42	0.31	
43	0.07	
44	0.07	
45	0.13	
46	0.22	
47	0.06	
48	1.75	
TOTAL	28.89	6.55

MILEAGE SUMMARY

CLASS 2		
TH-1	1.400	
TH-2	5.200	
TH-3	2.700	
TH-4	1.680	
TOTAL CLASS 2	10.980	
CLASS 3		
TOTAL CLASS 3	28.89	
TOTAL TOWN	39.870	
STATE HIGHWAY		
VT-5A	3.712	
VT-58	3.362	
TOTAL STATE HIGHWAY	7.074	
TOTAL STATE	7.074	
INTERSTATE		
I-91	0.759	
TOTAL INTERSTATE	0.759	
TOTAL, TRAVELED HIGHWAYS, FEB. 10, 2012:	47.703	

(Excludes Class 4, Legal Trail, and Unidentified Corridor Mileage)

TOWN HWY. No.	LENGTH IN MILES "NOT UP TO STANDARD"
8	(0.05)
11	(0.10)
17	(0.20)
26	(0.15)
28	(0.11)
29	(0.05)
31	(0.36)
47	(0.02)
TOTAL	1.04

* The sections of the town highways listed above are legally Class 3, but have been deemed "Not Up To Standard" and are functionally Class 4 Town Highways

- HIGHWAYS**
- INTERSTATE
 - STATE - HARD SURFACE OR PAVED
 - TOWN - HARD SURFACE OR PAVED
 - U.S. ROUTE
 - STATE ROUTE
 - CLASS 1
 - CLASS 2
 - CLASS 3
 - CLASS 4
 - LEGAL TRAIL
- INTERSTATE OR DIVIDED HIGHWAY
STATE - HARD SURFACE OR PAVED
TOWN - HARD SURFACE OR PAVED
GRAVEL
SOIL OR GRADED AND DRAINED EARTH
UNIMPROVED OR PRIMITIVE
IMPASSABLE OR UNTRAVELED
LEGAL TRAIL
DISCONTINUED
HIGHWAY CLASS CHANGE
RAILROAD
INACTIVE RAILROAD
P PARK AND RIDE
- POLITICAL SUBDIVISIONS**
- STATE BOUNDARY
 - COUNTY BOUNDARY
 - TOWN BOUNDARY
 - VILLAGE BOUNDARY
 - URBAN COMPACT BOUNDARY
 - WATER BODY
 - STREAM OR BROOK
- BRIDGE OR CULVERT**
- BRIDGE OR CULVERT GREATER THAN 20'
 - BRIDGE OR CULVERT 6' - 20'
- FEDERAL CLASSIFICATION IDENTIFIER**
- FAU URBAN ARTERIAL OR COLLECTOR
 - MA MINOR ARTERIAL
 - MJC MAJOR COLLECTOR
 - MNC MINOR COLLECTOR
 - PA PRINCIPAL ARTERIAL
- B34 / C34 STATE BRIDGE OR CULVERT IDENTIFIER**
B34 / C34 TOWN BRIDGE OR CULVERT IDENTIFIER

DISCLAIMER:
The untraveled highways (laid-out town highways), discontinued highways, and legal trails hereon are those of which the Agency of Transportation has record; others may exist.
Highway and bridge data by the Agency of Transportation. All other data from the Vermont Center for Geographic Information. Only named streams are shown.

Vermont State Plane Coordinate System
North American Datum of 1983
SPCS_Zone_Identifier: 4400
Geodetic Reference System 80
4,000-meter grid, Easting - Northing

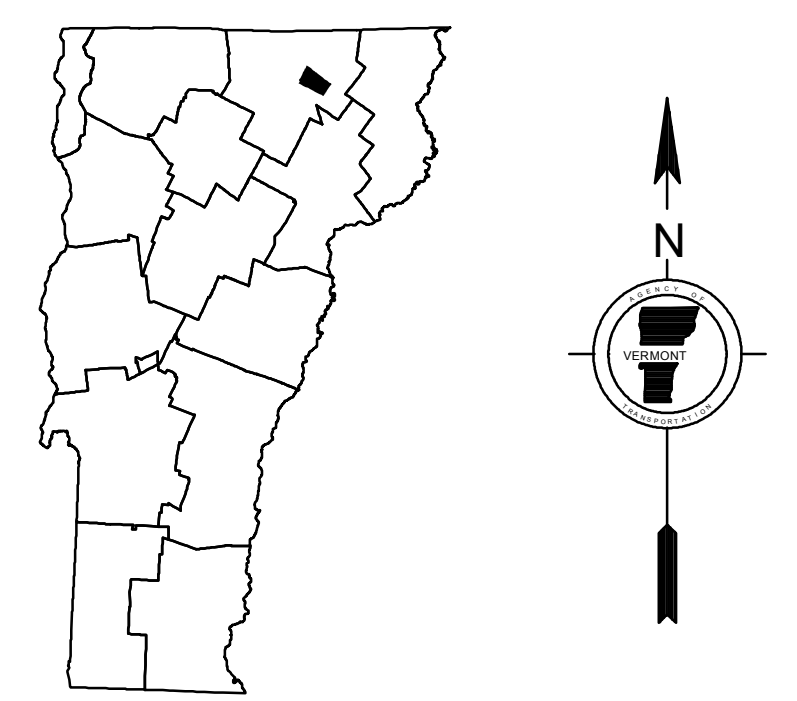
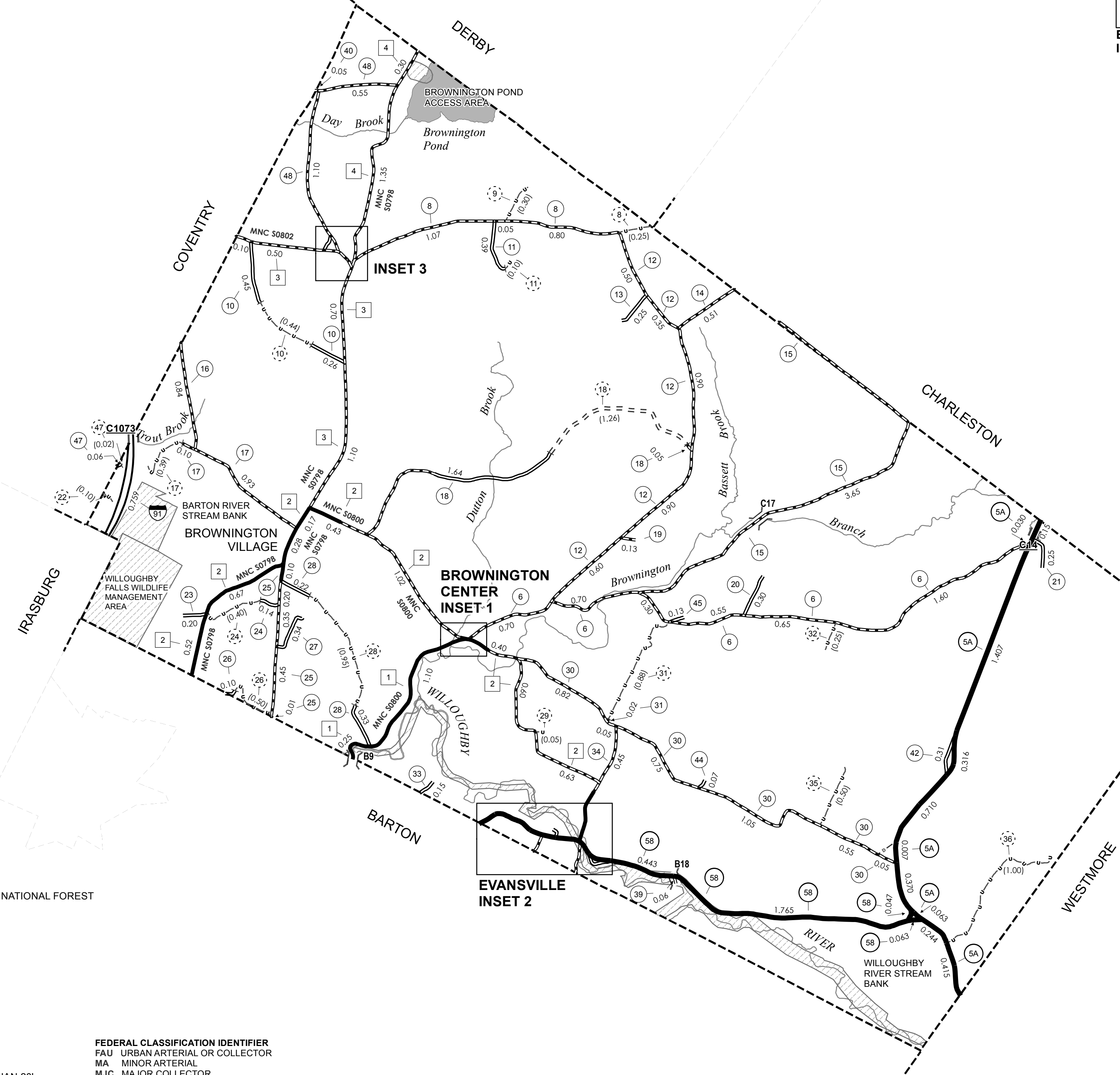
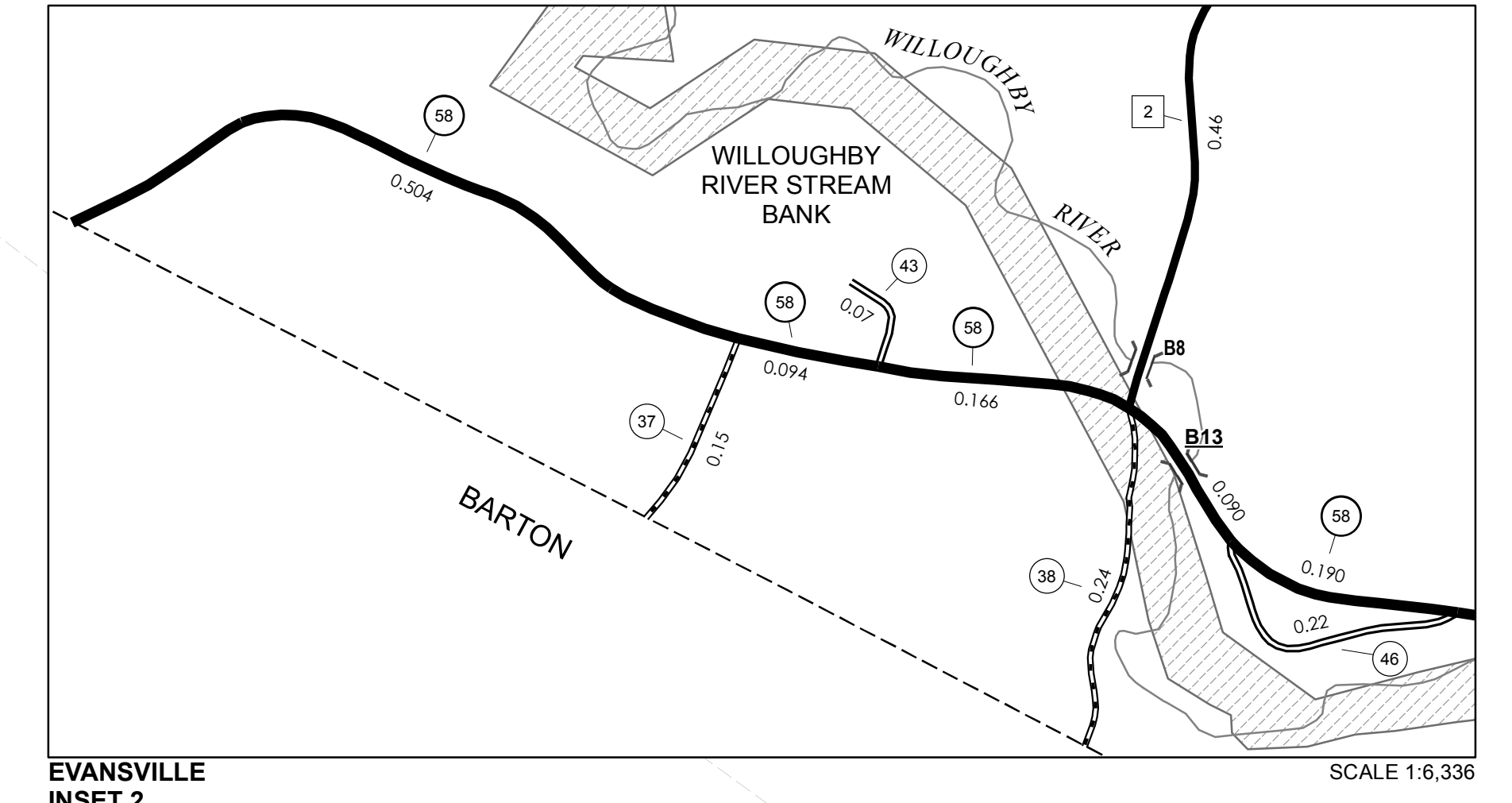
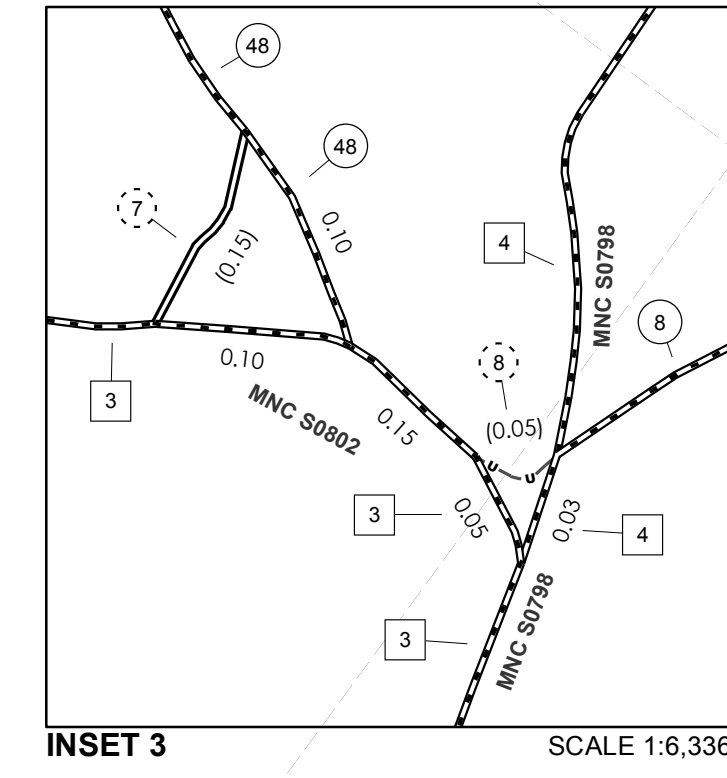
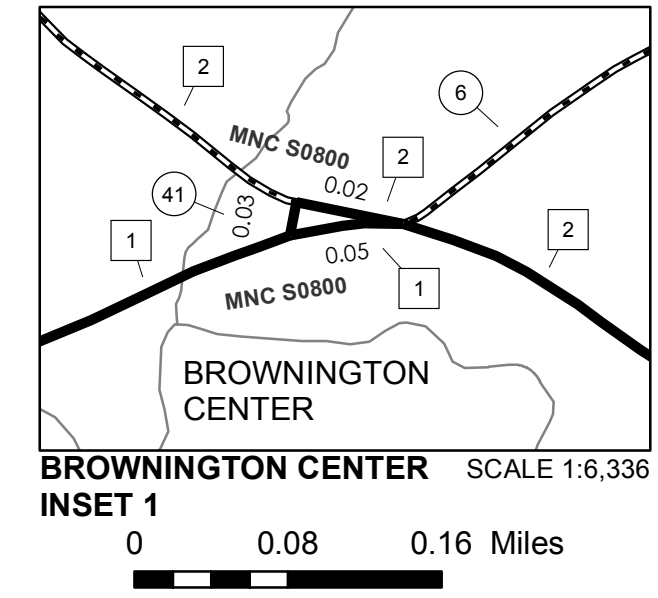

VERMONT
GENERAL HIGHWAY MAP
Town of Brownington
ORLEANS COUNTY
Transportation District #9
Prepared by the
Vermont Agency of Transportation
Division of Policy, Planning and Intermodal Development
in cooperation with
U.S. Department of Transportation
Federal Highway Administration

