

TOWN HWY. No.	LENGTH IN MILES		TOWN ROAD NAME
	CLASS 3	CLASS 4	
27	0.45		NEW ST
30	0.25		OLD ST
31		(0.055)	LOCKE DR
TOTAL	0.70	0.055	

LEGAL TRAIL No.	LENGTH IN MILES	
	LEGAL TRAIL	
5	(0.005)	
TOTAL	0.005	

MILEAGE SUMMARY			
CLASS 2			
TH-3	0.470		0.470
	TOTAL CLASS 2		
CLASS 3			0.70
	TOTAL CLASS 3		
	TOTAL TOWN		1.170
STATE HIGHWAY			
VT-14	1.600		1.600
	TOTAL STATE HIGHWAY		
	TOTAL STATE		1.6
TOTAL, TRAVELED HIGHWAYS, FEB. 10, 2025:			2.770
(Excludes Class 4 and Legal Trail Mileage)			

- HIGHWAYS**
- INTERSTATE
 - U.S. ROUTE
 - STATE ROUTE
 - CLASS 1
 - CLASS 2
 - CLASS 3
 - CLASS 4
 - LEGAL TRAIL
 - GRAVEL
 - SOIL OR GRADED AND DRAINED EARTH
 - UNIMPROVED OR PRIMITIVE
 - IMPASSABLE OR UNTRAVELED
 - LEGAL TRAIL
 - DISCONTINUED
 - HIGHWAY CLASS CHANGE
 - RAILROAD
 - INACTIVE RAILROAD
 - PUBLIC LAND - NATIONAL FOREST
 - PUBLIC LAND - STATE/MUNICIPAL
- POLITICAL SUBDIVISIONS**
- STATE BOUNDARY
 - COUNTY BOUNDARY
 - TOWN BOUNDARY
 - VILLAGE BOUNDARY
 - URBAN COMPACT BOUNDARY
 - WATER BODY
 - STREAM OR BROOK
- BRIDGE OR CULVERT**
- BRIDGE OR CULVERT > 20'
 - BRIDGE OR CULVERT 6' - 20'
 - BIKE PATH STRUCTURE
 - VT CULVERTS BRIDGE
 - VT CULVERTS CULVERT > 6'
- B34 / C34** STATE BRIDGE OR CULVERT IDENTIFIER
- B34 / C34** TOWN BRIDGE OR CULVERT IDENTIFIER
- NFR** NATIONAL FOREST ROAD
- ACE** ARMY CORPS OF ENGINEERS
- USGH** UNITED STATES GOV. HWY.
- P** PARK AND RIDE
- FEDERAL CLASSIFICATION IDENTIFIER**
- MA MINOR ARTERIAL
 - MJC MAJOR COLLECTOR
 - MNC MINOR COLLECTOR
 - PA PRINCIPAL ARTERIAL

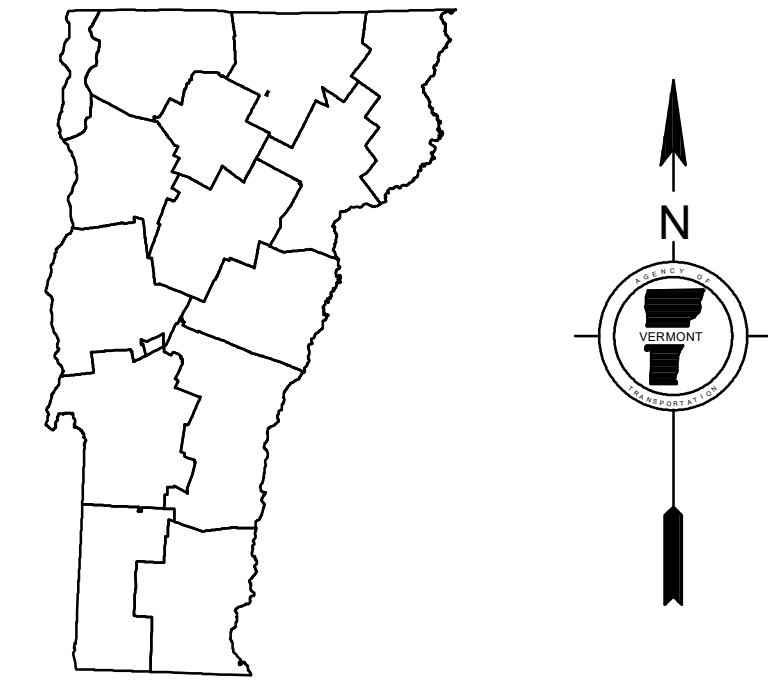
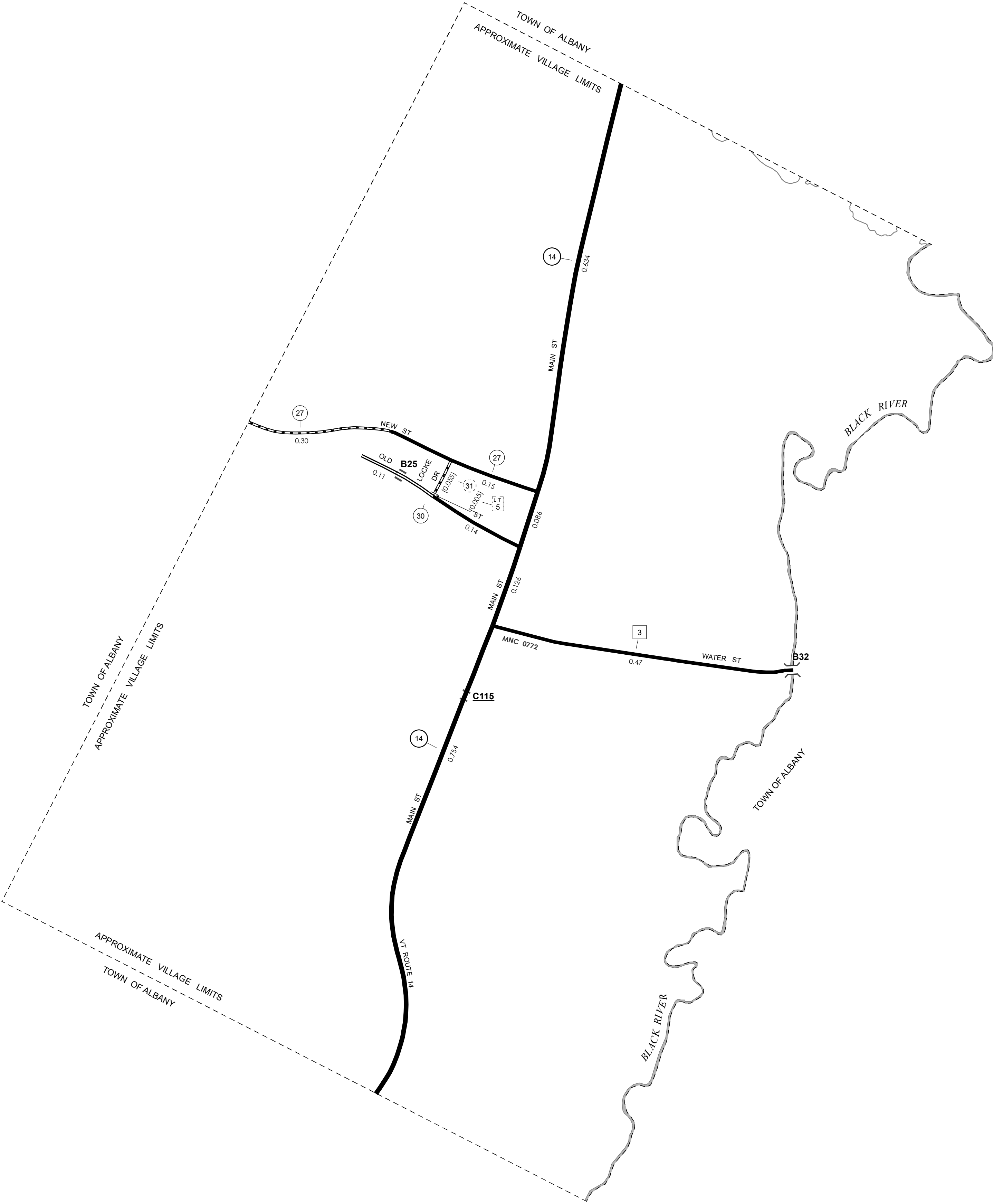

VERMONT
GENERAL HIGHWAY MAP
Village of Albany
ORLEANS COUNTY

Transportation District #9
Prepared by the
Vermont Agency of Transportation
Division of Policy, Planning and Intermodal Development
in cooperation with
U.S. Department of Transportation
Federal Highway Administration

Mileage as of February 10, 2025
Map prepared September 19, 2025

SCALE 1:6,336

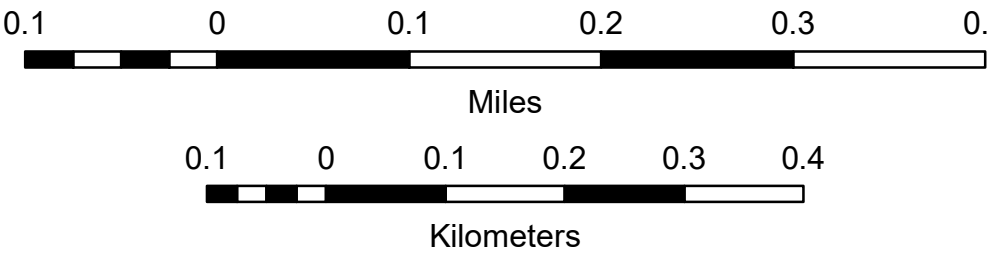

DISCLAIMER:
The untraveled highways (laid-out town highways), discontinued highways, and legal trails hereon are those of which the Agency of Transportation has record; others may exist.

Highway and bridge data by the Agency of Transportation.
Town short structures drawn from the VTCULVERTS (formerly VOBCT) online database. All other data from the Vermont Open Geodata Portal. Only named streams shown.

Vermont State Plane Coordinate System
North American Datum of 1983
SPCS_Zone_Identifier: 4400
Geodetic Reference System 80
2,000-meter grid, Easting - Northing