

TOWN HWY. No.	LENGTH IN MILES		TOWN ROAD NAME
	CLASS 3	CLASS 4	
27	0.45		NEW ST
30	0.25		OLD ST
31	0.06		LOCKE DR
TOTAL	0.76	0.00	

MILEAGE SUMMARY

CLASS 2	0.470		
TH-3			0.470
CLASS 3		TOTAL CLASS 3	0.76
		TOTAL TOWN	1.230
STATE HIGHWAY	1.600		
VT-14		TOTAL STATE HIGHWAY	1.600
		TOTAL STATE	1.6
TOTAL, TRAVELED HIGHWAYS, FEB. 10, 2018:			2.830

(Excludes Class 4 and Legal Trail Mileage)

- HIGHWAYS**
- INTERSTATE
 - U.S. ROUTE
 - STATE ROUTE
 - CLASS 1
 - CLASS 2
 - CLASS 3
 - CLASS 4
 - LEGAL TRAIL
 - GRAVEL
 - SOIL OR GRADED AND DRAINED EARTH
 - UNIMPROVED OR PRIMITIVE
 - IMPASSABLE OR UNTRAVELED
 - LEGAL TRAIL
 - DISCONTINUED
 - HIGHWAY CLASS CHANGE
 - RAILROAD
 - INACTIVE RAILROAD
 - PUBLIC LAND - NATIONAL FOREST
 - PUBLIC LAND - STATE/MUNICIPAL
- POLITICAL SUBDIVISIONS**
- STATE BOUNDARY
 - COUNTY BOUNDARY
 - TOWN BOUNDARY
 - VILLAGE BOUNDARY
 - URBAN COMPACT BOUNDARY
 - WATER BODY
 - STREAM OR BROOK
- BRIDGE OR CULVERT**
- BRIDGE OR CULVERT > 20'
 - BRIDGE OR CULVERT 6' - 20'
 - BIKE PATH STRUCTURE
 - VTCULVERTS BRIDGE
 - VTCULVERTS CULVERT > 6'
- B34 / C34** STATE BRIDGE OR CULVERT IDENTIFIER
B34 / C34 TOWN BRIDGE OR CULVERT IDENTIFIER
NFR NATIONAL FOREST ROAD
SFH STATE FOREST HIGHWAY
P PARK AND RIDE
- FEDERAL CLASSIFICATION IDENTIFIER**
- MA** MINOR ARTERIAL
 - MJC** MAJOR COLLECTOR
 - MNC** MINOR COLLECTOR
 - PA** PRINCIPAL ARTERIAL

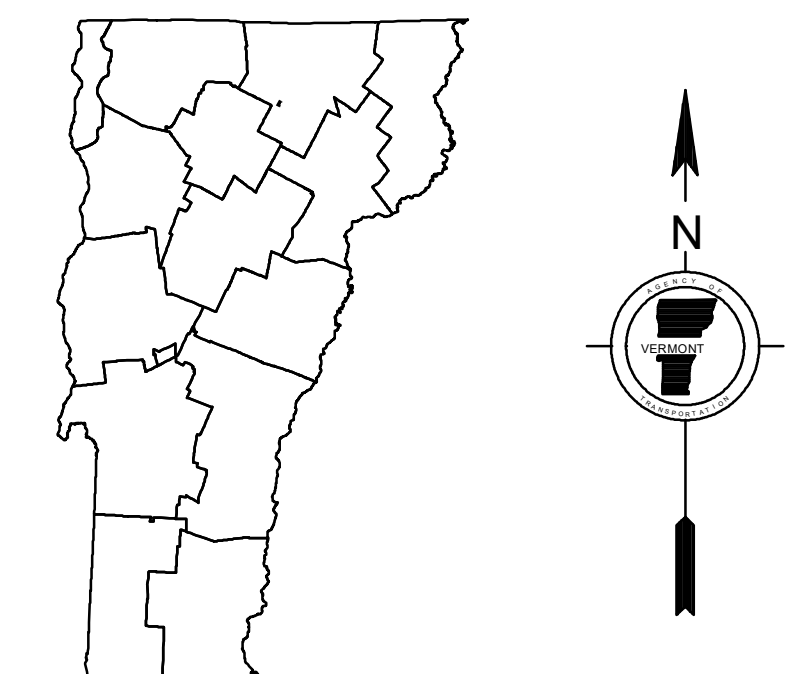
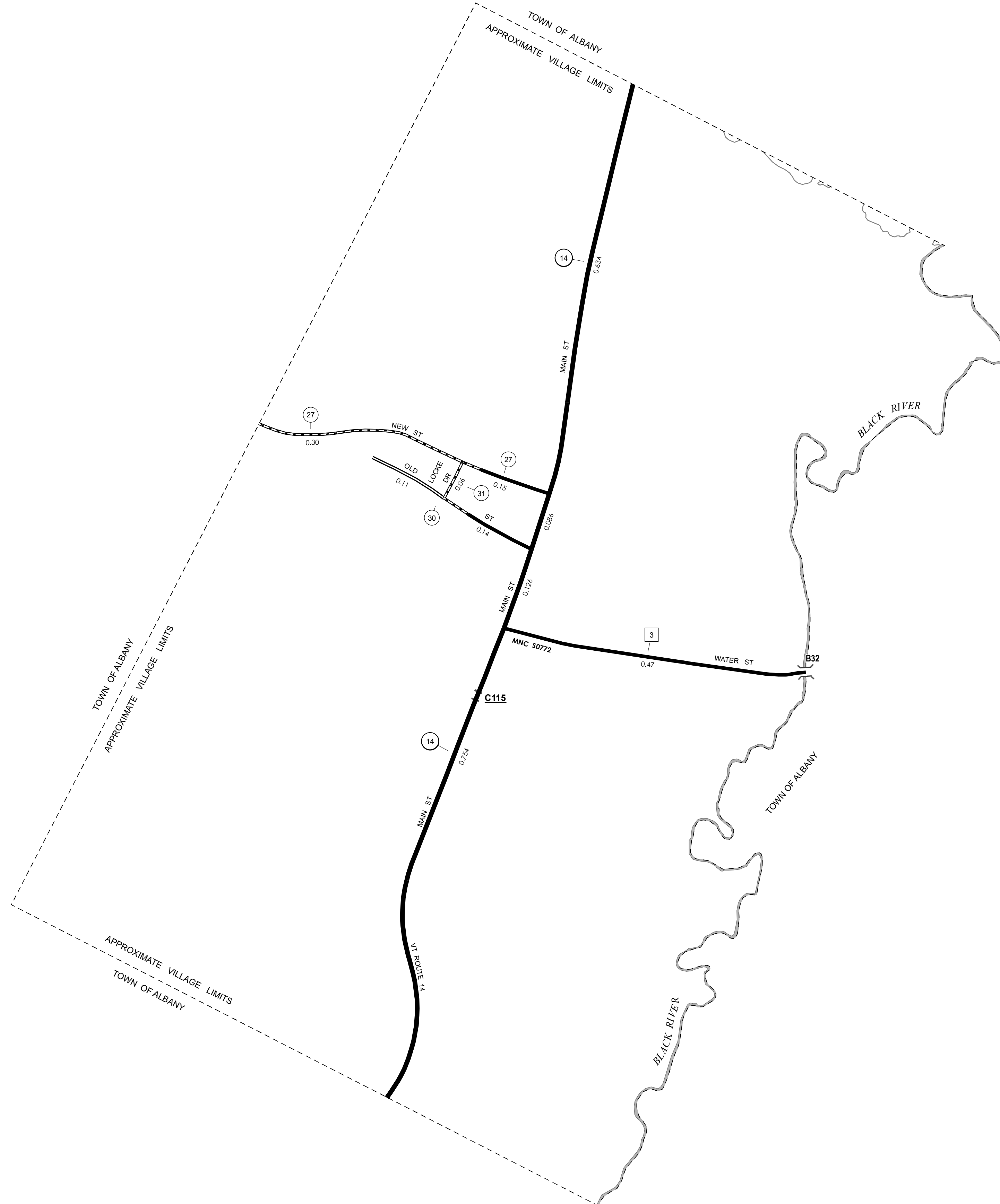

VERMONT
GENERAL HIGHWAY MAP
Village of Albany
ORLEANS COUNTY

Transportation District #9
 Prepared by the
 Vermont Agency of Transportation
 Division of Policy, Planning and Intermodal Development
 in cooperation with
 U.S. Department of Transportation
 Federal Highway Administration

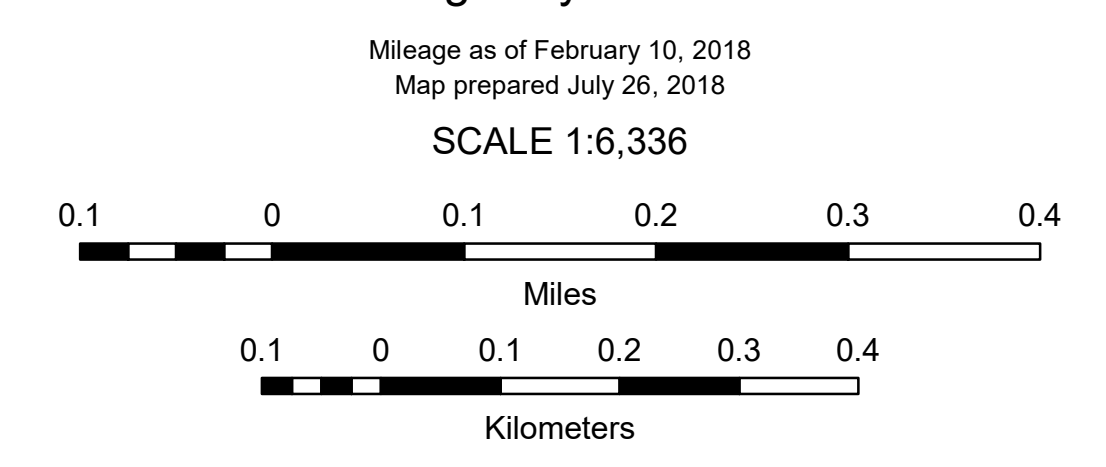

DISCLAIMER:
 The untraveled highways (laid-out town highways), discontinued highways, and legal trails hereon are those of which the Agency of Transportation has record; others may exist.

Highway and bridge data by the Agency of Transportation. Town short structures drawn from the VTCULVERTS (formerly VOB/CIT) online database. All other data from the Vermont Center for Geographic Information. Only named streams shown.

Vermont State Plane Coordinate System
 North American Datum of 1983
 SPCS_Zone_Identifier: 4400
 Geodetic Reference System 80
 2,000-meter grid, Easting - Northing