

MILEAGE SUMMARY

CLASS	LENGTH IN MILES	TOTAL
CLASS 2	19.180	19.180
CLASS 3	41.83	41.83
STATE HIGHWAY	17.424	17.424
INTERSTATE	6.166	6.166
TOTAL TRAVELED HIGHWAYS, FEB. 10, 2015:	84.600	84.600

(Excludes Class 4, Legal Trail, and Unidentified Corridor Mileage)

TOWN HWY. No. LENGTH IN MILES "NOT UP TO STANDARD"

59	0.02
TOTAL	0.02

* The sections of the town highways listed above are legally Class 3, but have been deemed "Not Up To Standard" and are functionally Class 4 Town Highways

LEGAL TRAIL No. LENGTH IN MILES

1	0.60
2	0.98
3	0.30
TOTAL	1.88

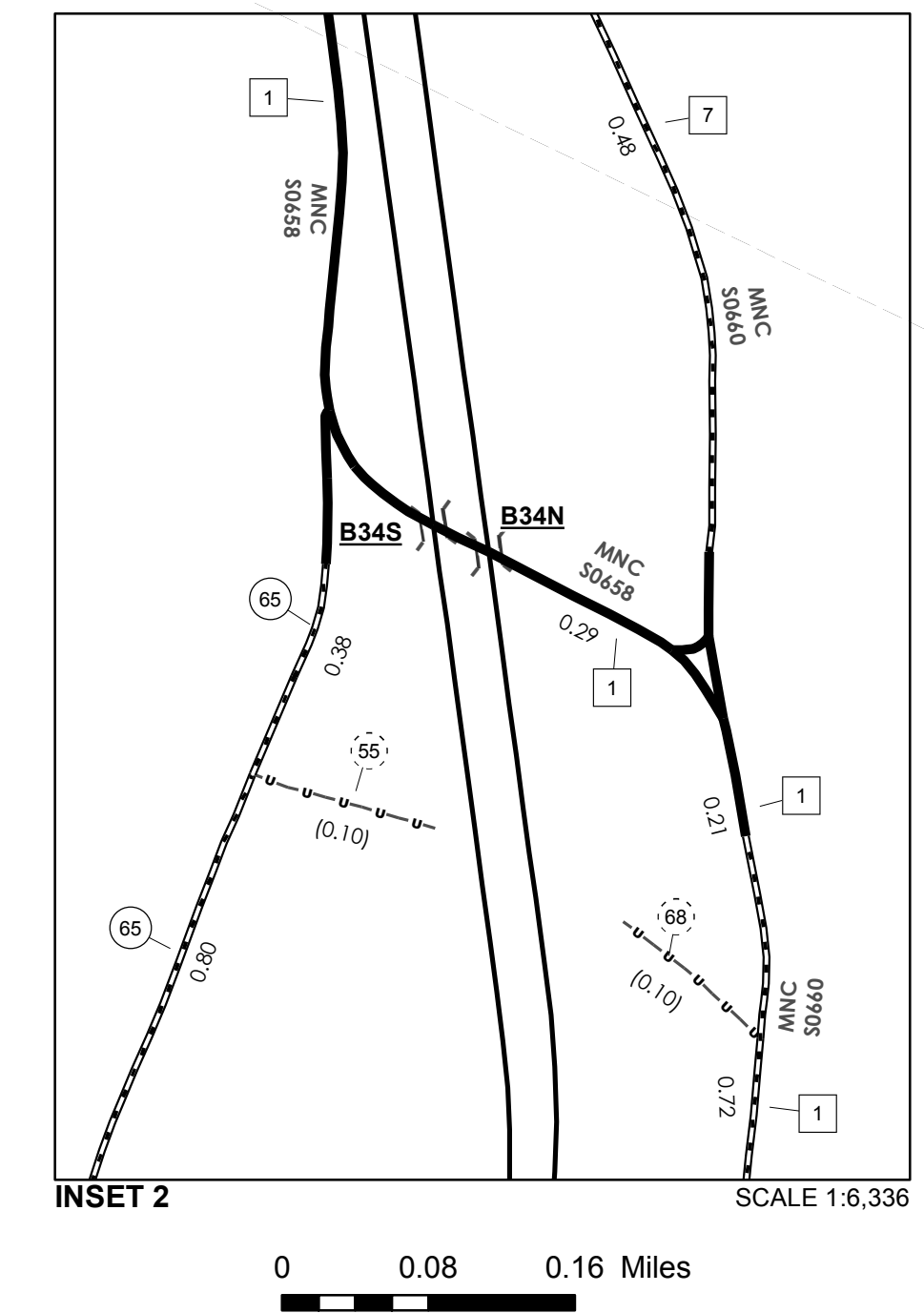
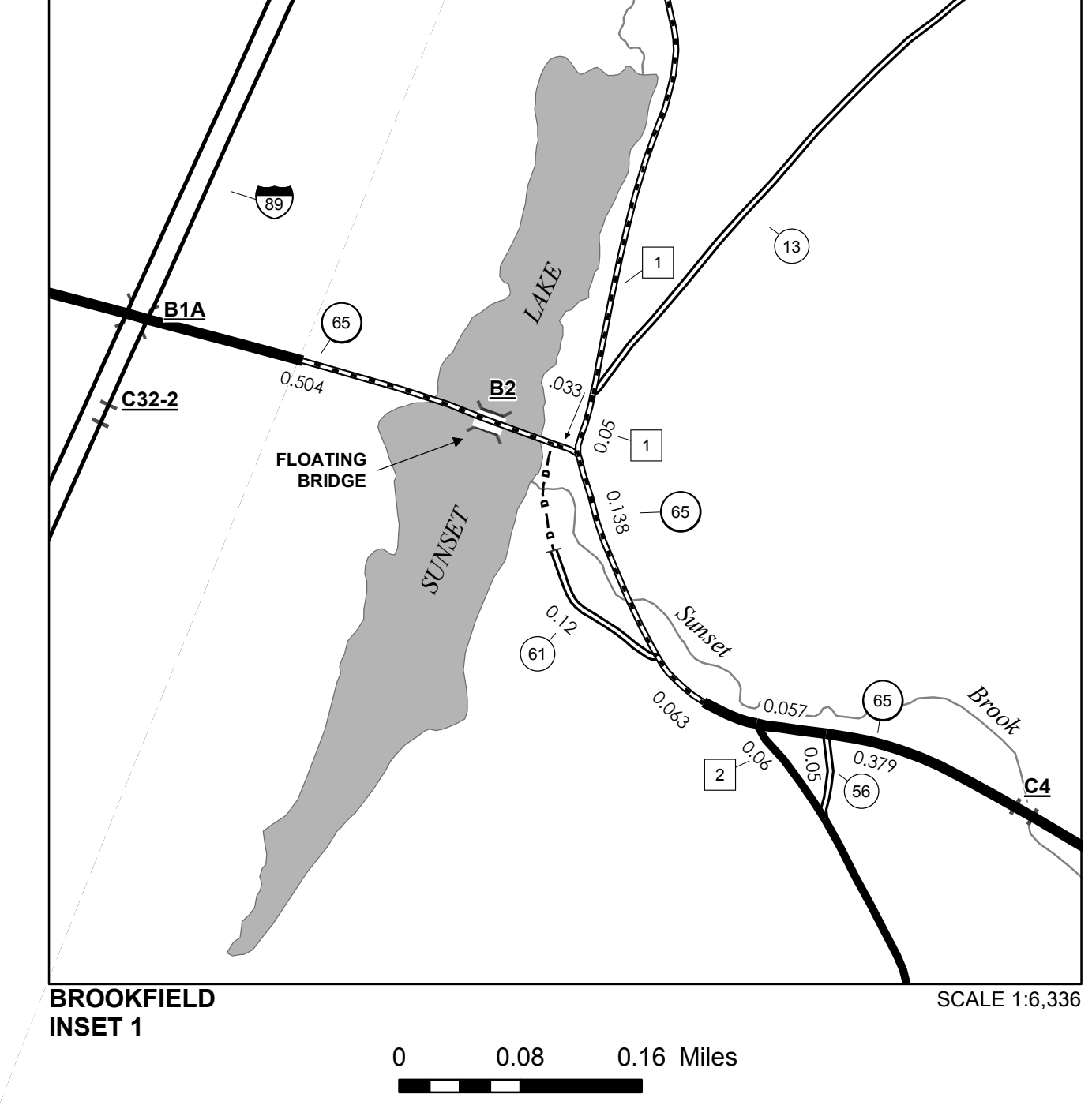
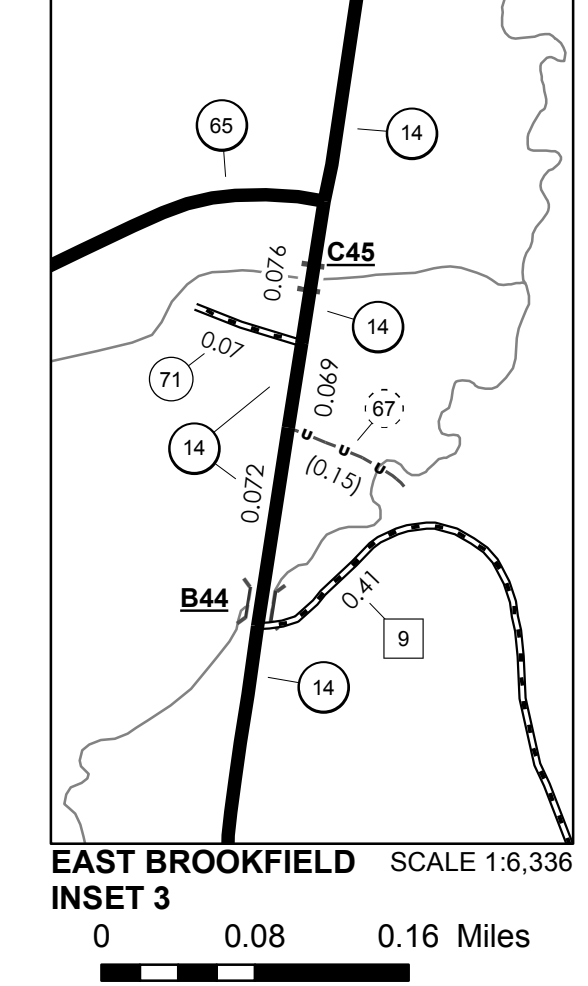
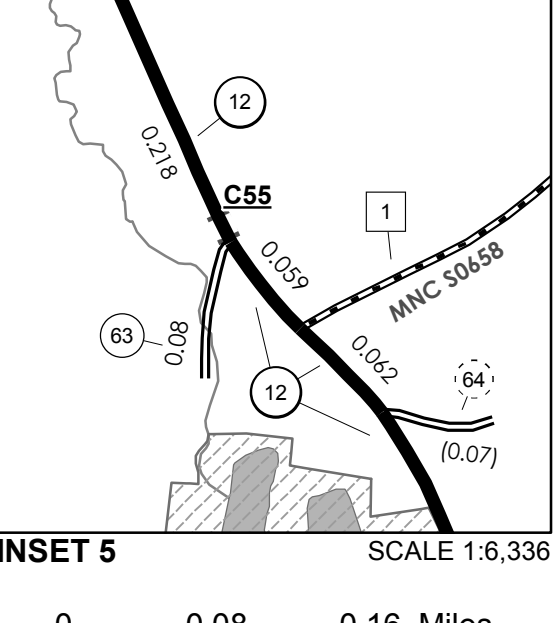
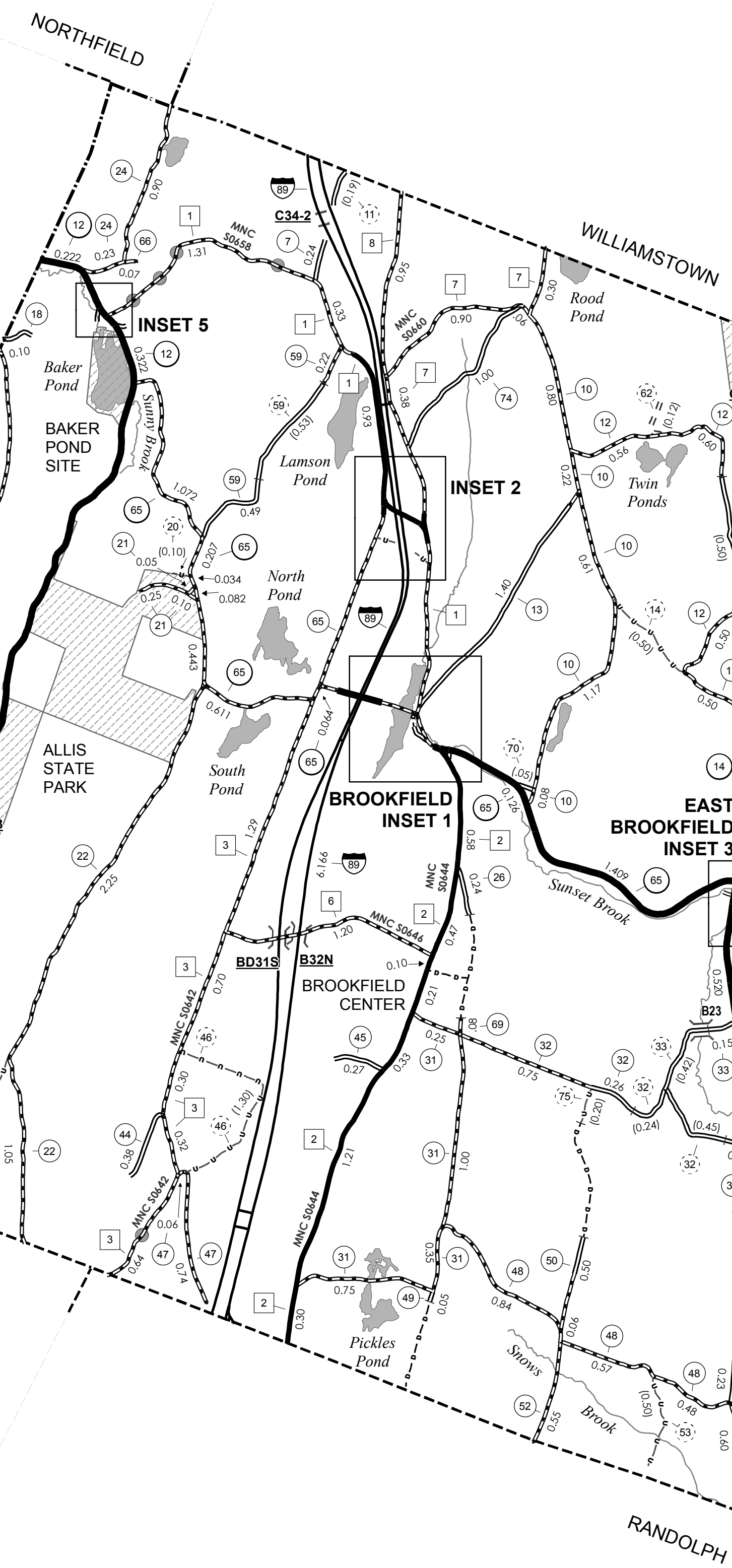
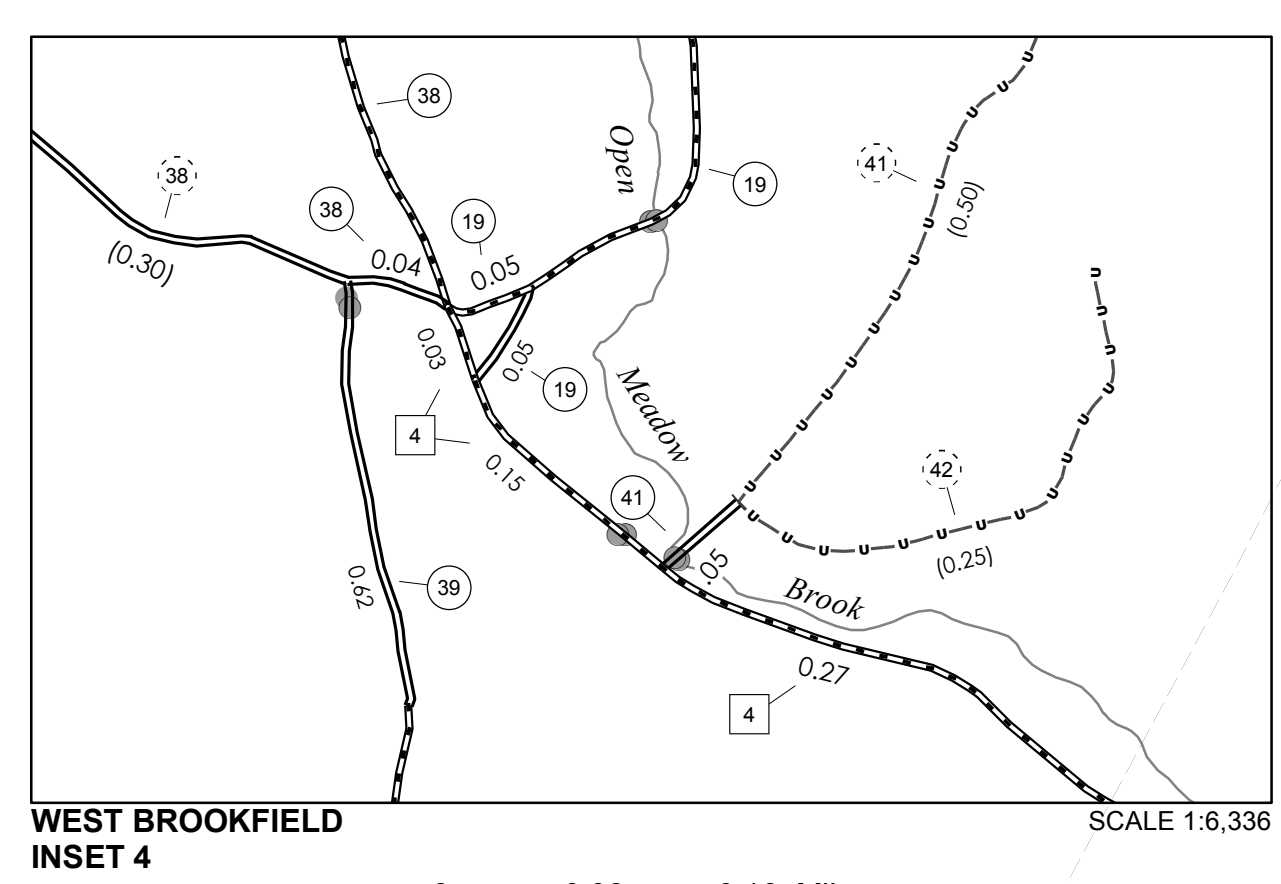

VERMONT GENERAL HIGHWAY MAP
Town of Brookfield

ORANGE COUNTY
Transportation District #6
Prepared by the
Vermont Agency of Transportation
Division of Policy, Planning and Intermodal Development
in cooperation with
U.S. Department of Transportation
Federal Highway Administration

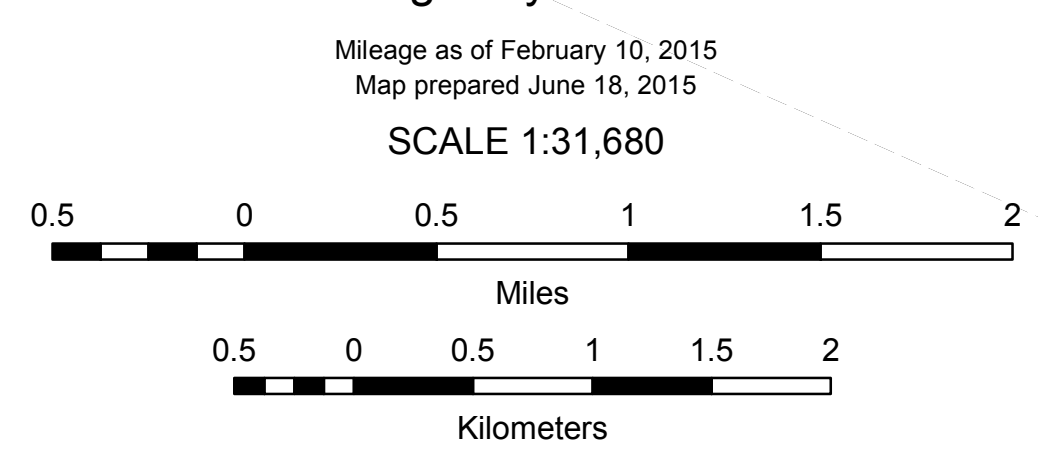

DISCLAIMER:
The untraveled highways (laid-out town highways), discontinued highways, and legal trails herein are those of which the Agency of Transportation has record; others may exist.

Highway and bridge data by the Agency of Transportation. Town short structures are drawn from the Vermont Online Bridge & Culvert Inventory Tool (VOBCIT) database. All other data from the Vermont Center for Geographic Information. Only named streams are shown.

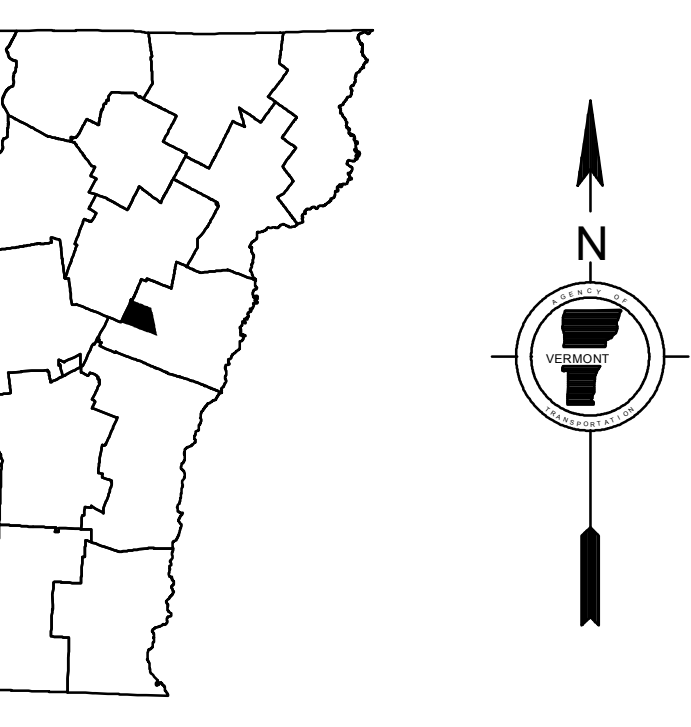

Vermont State Plane Coordinate System
North American Datum of 1983
SPCS_Zone_Identifier: 4400
Geodetic Reference System 80
4,000-meter grid, Easting - Northing