

TOWN HWY. No.	LENGTH IN MILES CLASS 3	CLASS 4
6	4.50	
7	7.80	
8	0.25	
9		(0.33)
10	1.65	
11		(0.20)
12		(0.50)
13	2.70	
14	0.32	
15	0.22	(1.98)
16	1.71	
17	0.50	
18	0.16	
19	0.16	
21	0.45	
22		(0.44)
23		(0.25)
25	0.26	(0.14)
26	2.50	
27		(0.05)
29	0.23	(0.07)
30	0.58	(0.32)
31	0.80	(0.40)
32	0.20	
33	0.15	
34	0.09	
35	0.45	
36	1.40	
37	0.40	
38	0.35	(0.85)
39	0.27	(0.03)
40	0.75	
41	0.45	
42		(0.05)
43	0.04	
44	0.70	
46		(0.10)
47	1.75	
48	0.15	
49	0.20	
50	1.00	
51	3.35	(0.38)
52	0.05	(0.10)
53	0.08	
54	1.80	
55	0.15	
56	0.10	
57	0.15	(0.20)
58	0.50	
59	1.30	(0.55)
60	0.94	
61	0.74	
62	0.15	
63		(0.04)
64	0.10	
65	0.35	
66	0.08	
67	0.10	
68	0.20	
69	0.12	(0.08)
70	0.09	
71	0.08	
72	0.14	
73		(0.06)
74	0.12	(0.05)
75	0.55	(0.54)
76		(0.30)
77	0.21	
78	0.57	
79	0.36	(0.11)
80	0.17	
81	0.62	
82	0.12	
83	0.11	
84	0.18	
86	0.15	
87	0.41	
88	0.73	
89	0.31	
90	0.18	
91	0.40	
92	0.09	
93	0.42	
94	0.10	
95	0.23	
TOTAL	49.72	8.12

MILEAGE SUMMARY		
CLASS 2		
TH-1	7.350	
TH-2	0.280	
TH-3	4.530	
TH-4	1.200	
TH-5	0.300	
TH-6	0.170	
TOTAL CLASS 2	13.830	
CLASS 3		
TOTAL CLASS 3	49.72	
TOTAL TOWN	63.550	
STATE HIGHWAY		
VT-15	2.955	
VT-100	6.527	
VT-100C	0.087	
TOTAL STATE HIGHWAY	9.569	
STATE HIGHWAY - Ramps		
VT-15	0.033	
TOTAL STATE HIGHWAY - Ramps	0.033	
TOTAL STATE	9.602	

**TOTAL, TRAVELED HIGHWAYS, FEB. 10, 2015: 73.152**  
 (Excludes Class 4, Legal Trail, and Unidentified Corridor Mileage)

TOWN HWY. No.	LENGTH IN MILES "NOT UP TO STANDARD"
31	(0.02)
TOTAL	0.02

\*The sections of the town highways listed above are legally Class 3, but have been deemed "Not Up To Standard" and are functionally Class 4 Town Highways

LEGAL TRAIL No.	LENGTH IN MILES LEGAL TRAIL
1	(0.67)
2	(0.30)
3	(0.99)
TOTAL	1.96

**DISCLAIMER:**  
 The untraveled highways (laid-out town highways), discontinued highways, and legal trails herein are those of which the Agency of Transportation has record; others may exist.

Highway and bridge data by the Agency of Transportation. Town short structures are drawn from the Vermont Online Bridge & Culvert Inventory Tool (VOBCIT) database. All other data from the Vermont Center for Geographic Information. Only named streams are shown.

Vermont State Plane Coordinate System  
 North American Datum of 1983  
 SPCS\_Zone\_Identifier: 4400  
 Geodetic Reference System 80  
 4,000-meter grid, Easting - Northing

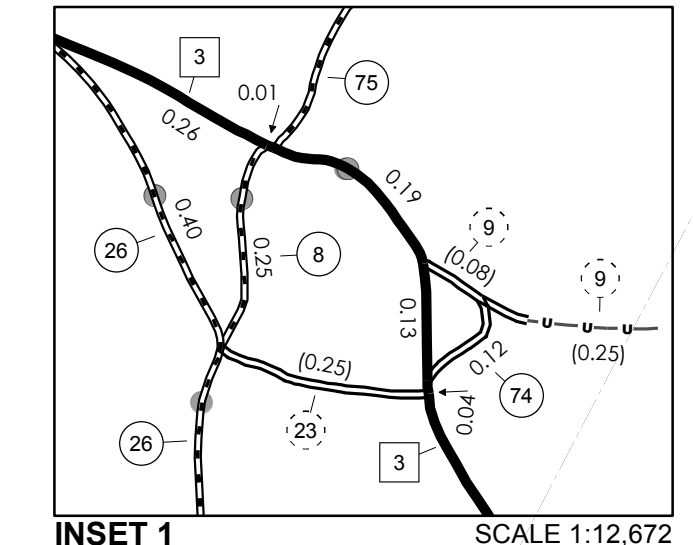
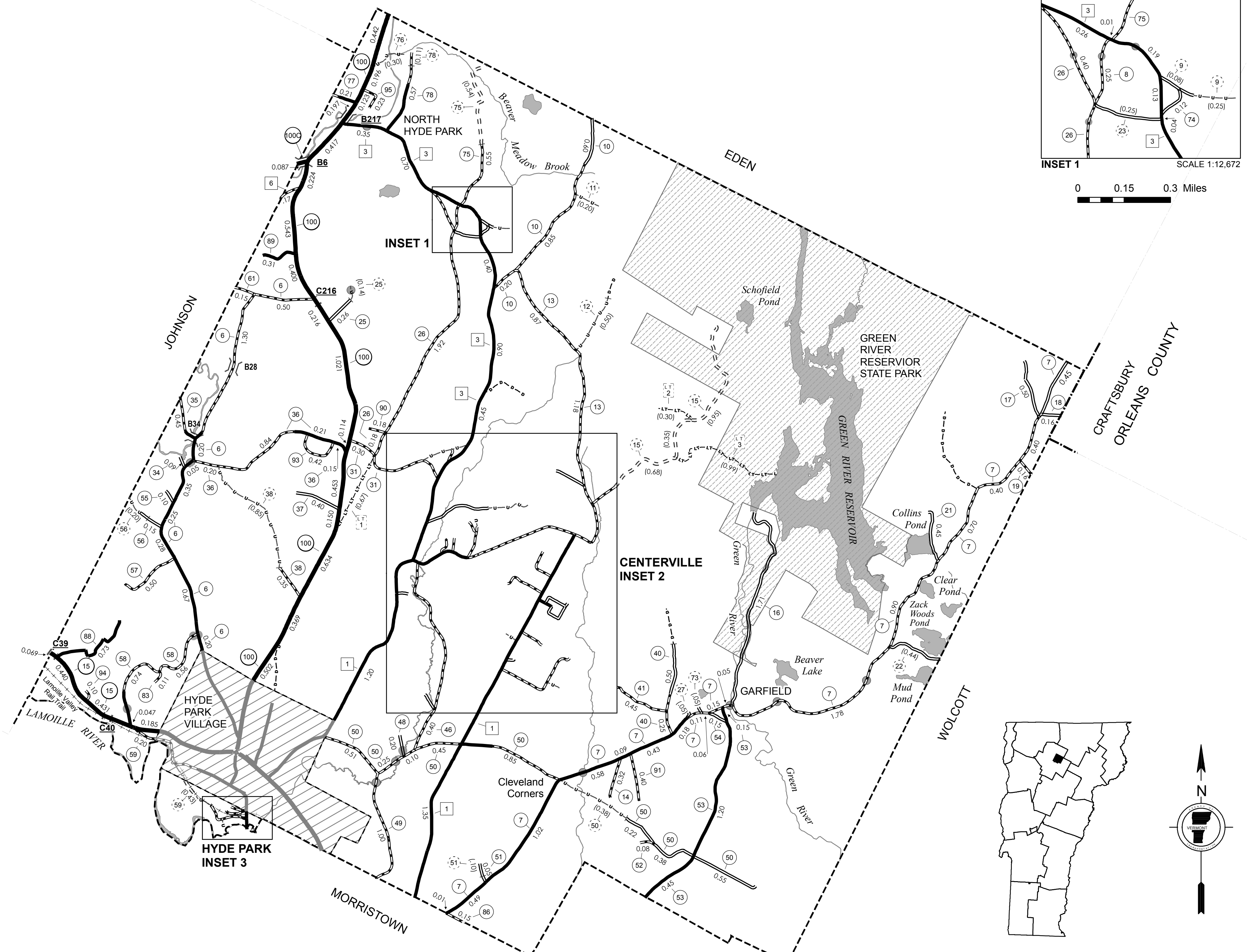
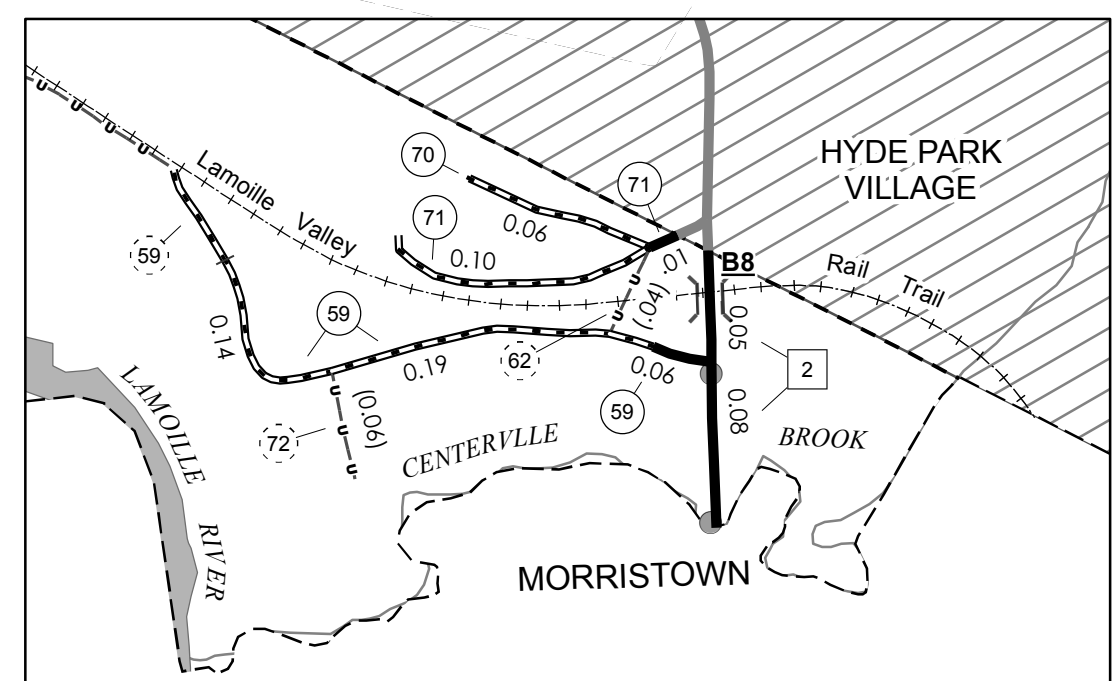
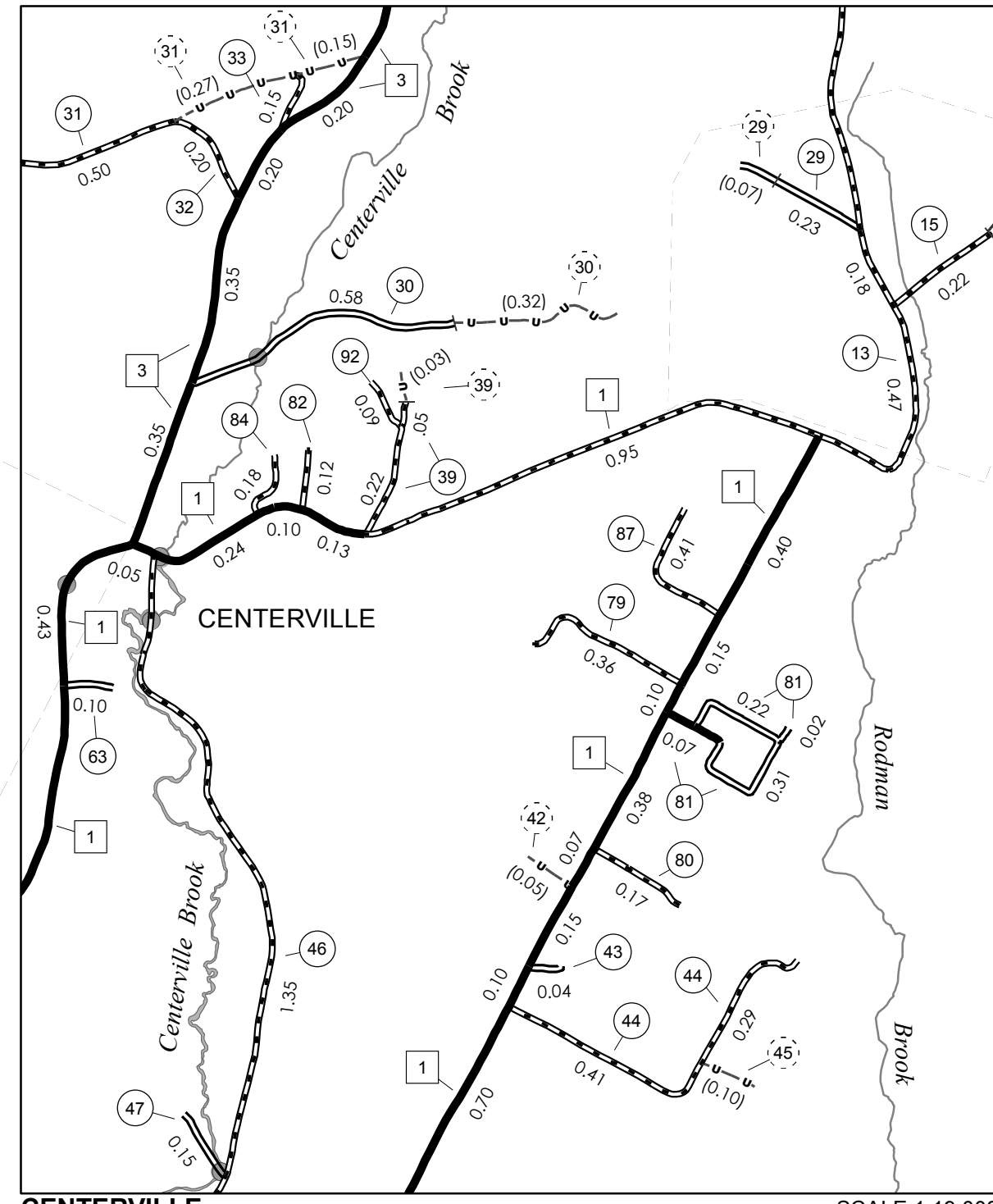

0 0.15 0.3 Miles

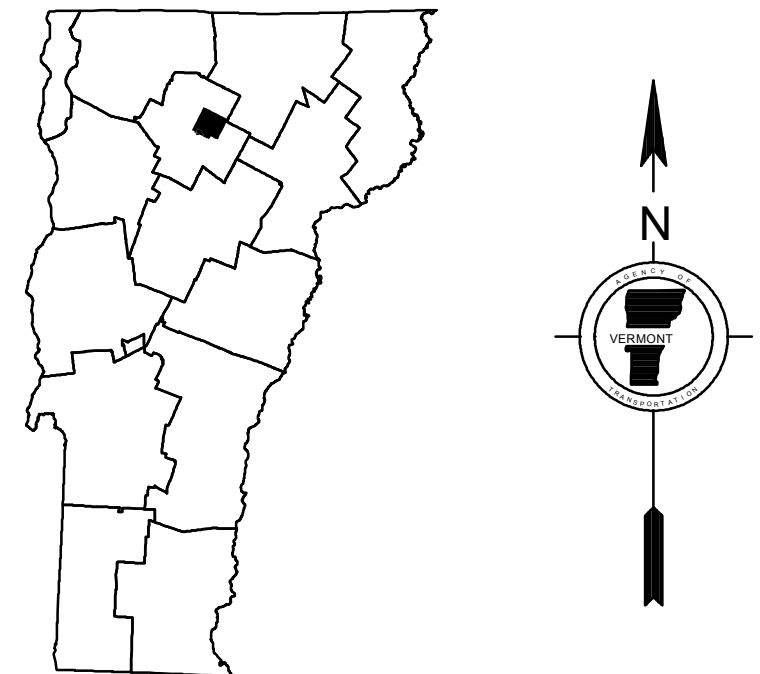

**VERMONT GENERAL HIGHWAY MAP**  
**Town of Hyde Park**

LAMOILLE COUNTY

Transportation District #8

Prepared by the  
 Vermont Agency of Transportation  
 Division of Policy, Planning and Intermodal Development  
 in cooperation with  
 U.S. Department of Transportation  
 Federal Highway Administration

Mileage as of February 10, 2015  
 Map prepared June 04, 2015

SCALE 1:31,680

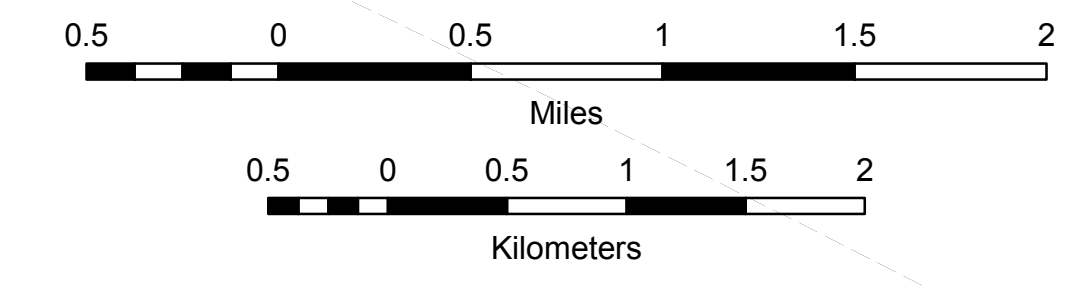

- HIGHWAYS**
- INTERSTATE OR DIVIDED HIGHWAY
  - INTERSTATE
  - U.S. ROUTE
  - STATE ROUTE
  - CLASS 1
  - CLASS 2
  - CLASS 3
  - CLASS 4
  - LEGAL TRAIL
- OTHER FEATURES**
- GRAVEL
  - SOIL OR GRADED AND DRAINED EARTH
  - UNIMPROVED OR PRIMITIVE
  - IMPASSABLE OR UNTRAVELED
  - LEGAL TRAIL
  - DISCONTINUED
  - HIGHWAY CLASS CHANGE
  - RAILROAD
  - INACTIVE RAILROAD
  - NFR NATIONAL FOREST ROAD
  - SFH STATE FOREST HIGHWAY
  - PARK AND RIDE
- POLITICAL SUBDIVISIONS**
- STATE BOUNDARY
  - COUNTY BOUNDARY
  - TOWN BOUNDARY
  - VILLAGE BOUNDARY
  - URBAN COMPACT BOUNDARY
  - WATER BODY
  - STREAM OR BROOK
- BRIDGE OR CULVERT**
- BRIDGE OR CULVERT > 20'
  - BRIDGE OR CULVERT 6' - 20'
  - VOBCIT BRIDGE
  - VOBCIT CULVERT > 6'
  - STATE BRIDGE OR CULVERT IDENTIFIER
  - TOWN BRIDGE OR CULVERT IDENTIFIER
- FEDERAL CLASSIFICATION IDENTIFIER**
- FAU URBAN ARTERIAL OR COLLECTOR
  - MA MINOR ARTERIAL
  - MJC MAJOR COLLECTOR
  - MNC MINOR COLLECTOR
  - PA PRINCIPAL ARTERIAL