

TOWN HWY. No.	LENGTH IN MILES CLASS 3	LENGTH IN MILES CLASS 4
8	1.10	
9	2.10	
10	1.05	
11	1.85	
13	0.50	
14	0.30	
15	0.77	
16	5.65	
17	0.90	(1.15)
18		(0.40)
19	0.40	
21	0.40	(0.13)
22	1.10	
23	0.20	
24	0.89	
26		(0.45)
28	2.10	
29	1.10	
30	0.15	
32		(0.19)
33	1.74	
34	0.30	
35	0.60	
36	1.38	
38	0.25	
39	0.32	
40	0.30	
41	0.13	(0.14)
43	0.42	
44	0.39	
45	0.15	
46	0.07	
47	0.23	
48	0.20	
49	0.24	
50	0.29	
51	0.89	
52	0.12	
53	0.10	
54	0.19	
55		(0.13)
56		(0.15)
TOTAL	28.87	2.74

LEGAL TRAIL No.	LENGTH IN MILES LEGAL TRAIL
1	(0.45)
3	(0.63)
4	(0.98)
TOTAL	2.06

MILEAGE SUMMARY

CLASS 2	LENGTH	TOTAL CLASS 2
TH-1	1.580	
TH-2	6.680	
TH-3	1.070	
TH-4	2.160	
TH-5	1.650	
TH-6	1.650	
TH-7	1.200	
TOTAL CLASS 2		15.990

CLASS 3	LENGTH	TOTAL CLASS 3
VT-78	1.841	
VT-105	11.015	
VT-120	1.731	
VT-236	1.224	
TOTAL CLASS 3		28.87

STATE HIGHWAY	LENGTH	TOTAL STATE HIGHWAY
VT-78	1.841	
VT-105	11.015	
VT-120	1.731	
VT-236	1.224	
TOTAL STATE HIGHWAY		15.811

TOTAL, TRAVELED HIGHWAYS, FEB. 10, 2020: 60.671
(Excludes Class 4 and Legal Trail Mileage)

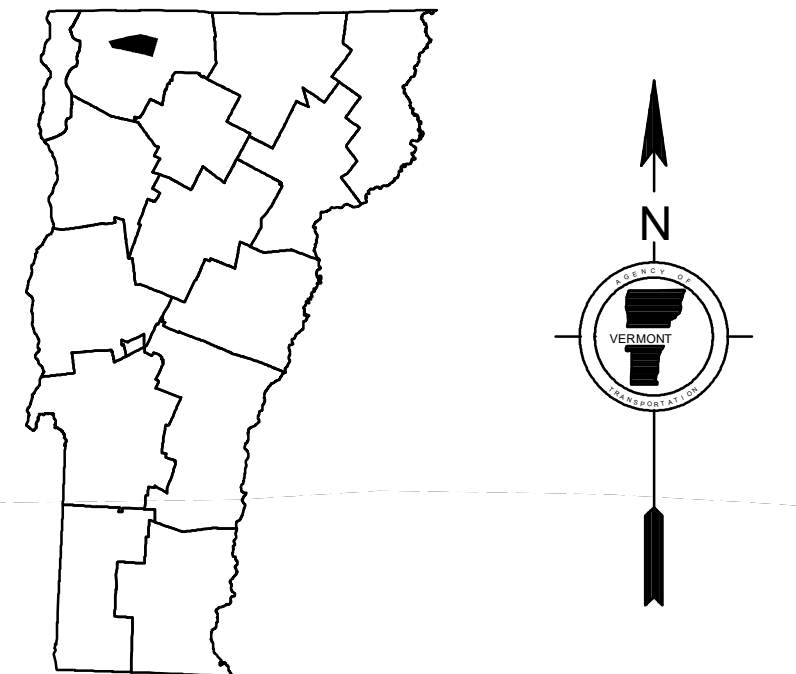
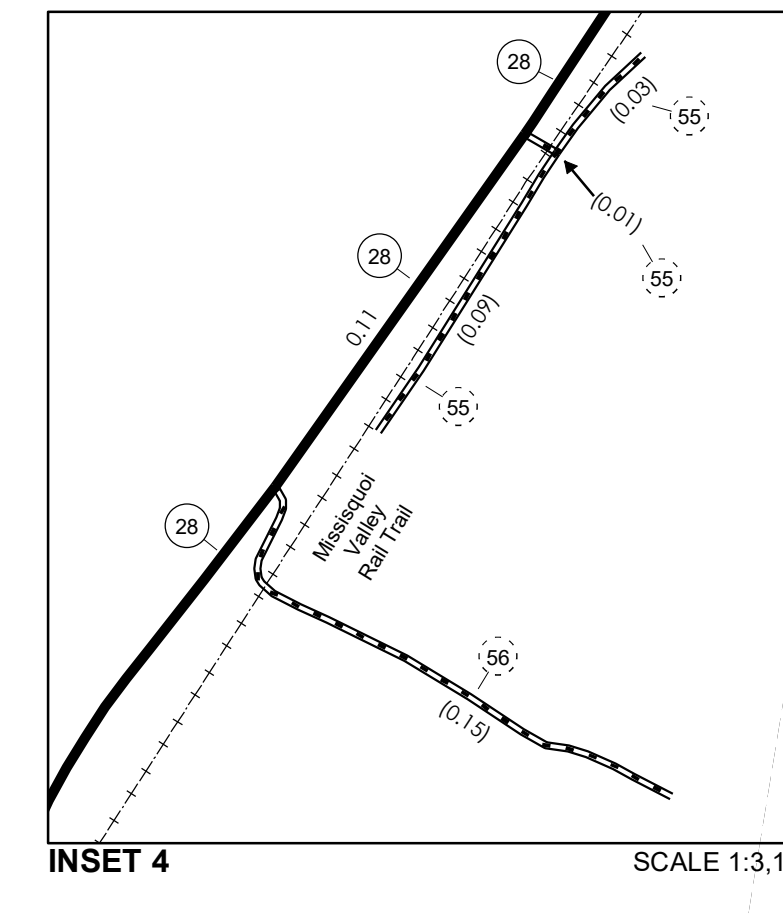
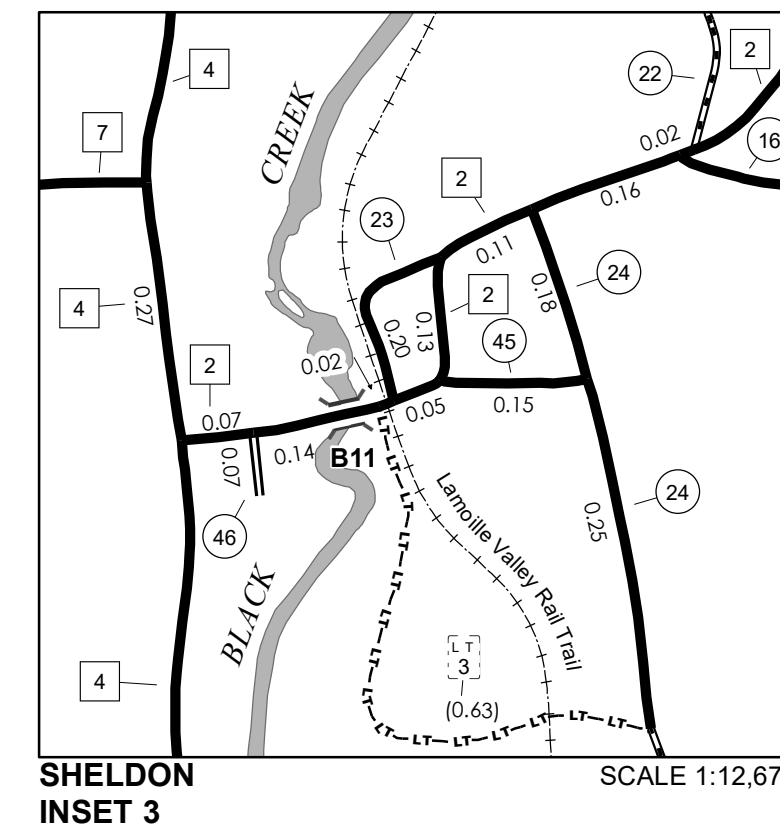
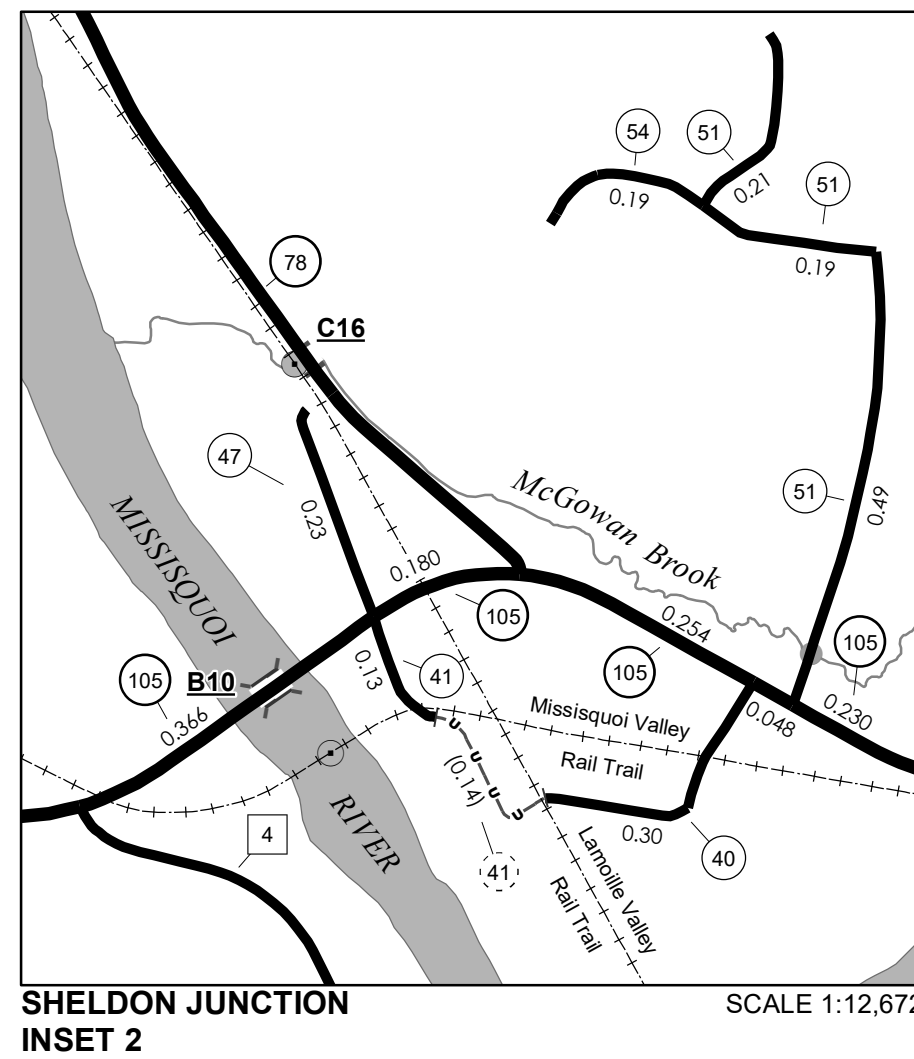
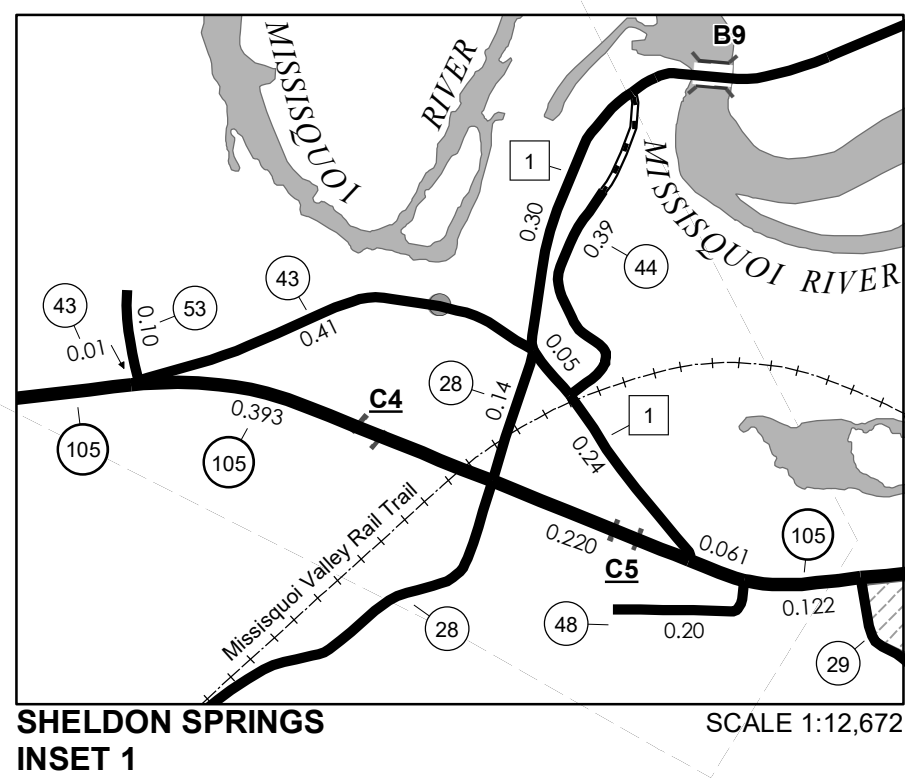

VERMONT
GENERAL HIGHWAY MAP
Town of Sheldon

FRANKLIN COUNTY

Transportation District #8

Prepared by the
Vermont Agency of Transportation
Division of Policy, Planning and Intermodal Development
in cooperation with

U.S. Department of Transportation
Federal Highway Administration

Mileage as of February 10, 2020
Map prepared July 15, 2020

SCALE 1:31,680

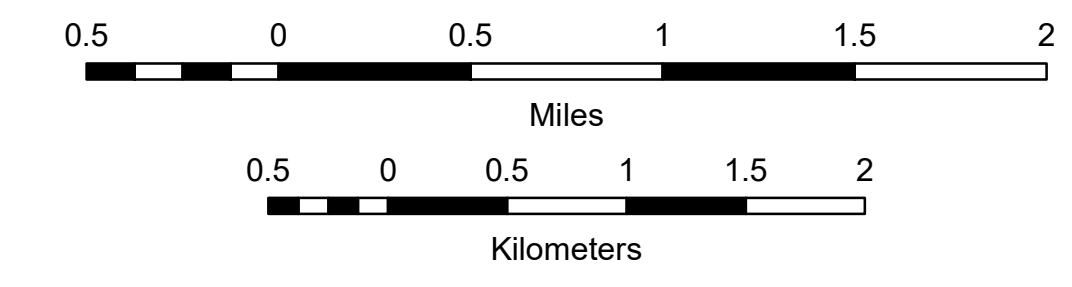

- HIGHWAYS**
 - INTERSTATE OR DIVIDED HIGHWAY
 - STATE - HARD SURFACE OR PAVED
 - TOWN - HARD SURFACE OR PAVED
 - GRAVEL
 - SOIL OR GRADED AND DRAINED EARTH
 - UNIMPROVED OR PRIMITIVE
 - IMPASSABLE OR UNTRAVELED
 - LEGAL TRAIL
 - DISCONTINUED
 - HIGHWAY CLASS CHANGE
 - RAILROAD
 - INACTIVE RAILROAD
 - PUBLIC LAND - NATIONAL FOREST
 - PUBLIC LAND - STATE/MUNICIPAL
 - NFR NATIONAL FOREST ROAD
 - SFH STATE FOREST HIGHWAY
- POLITICAL SUBDIVISIONS**
 - STATE BOUNDARY
 - COUNTY BOUNDARY
 - TOWN BOUNDARY
 - VILLAGE BOUNDARY
 - URBAN COMPACT BOUNDARY
 - WATER BODY
 - STREAM OR BROOK
- BRIDGE OR CULVERT**
 - BRIDGE OR CULVERT > 20'
 - BRIDGE OR CULVERT 6' - 20'
 - BIKE PATH STRUCTURE
 - VT CULVERTS BRIDGE
 - VT CULVERTS CULVERT > 6'
 - STATE BRIDGE OR CULVERT IDENTIFIER
 - TOWN BRIDGE OR CULVERT IDENTIFIER
- FEDERAL CLASSIFICATION IDENTIFIER**
 - MA MINOR ARTERIAL
 - MJC MAJOR COLLECTOR
 - MNC MINOR COLLECTOR
 - PA PRINCIPAL ARTERIAL

DISCLAIMER:
The untraveled highways (laid-out town highways), discontinued highways, and legal trails herein are those of which the Agency of Transportation has record; others may exist.

Highway and bridge data by the Agency of Transportation. Town short structures drawn from the VTCULVERTS (formerly VOBCIT) online database. All other data from the Vermont Open Geodata Portal. Only named streams shown.

Vermont State Plane Coordinate System
North American Datum of 1983
SPCS_Zone_Identifier: 4400
Geodetic Reference System 80
4,000-meter grid, Easting - Northing