

TOWN HWY. NO.	CLASS 3	CLASS 4	LENGTH IN MILES
7	2.420		0.040
* 7		(0.050)	0.070
8	0.700		0.260
9	1.000		0.290
10	0.200		0.050
11	3.150		0.080
* 12	0.600		0.120
12		(0.020)	0.190
13	0.100		0.250
14	0.200		0.250
15	0.200		0.190
16	0.420		0.240
17	0.100		0.100
18	4.020		0.130
19	0.080		0.050
20	0.100		0.090
21	2.550		0.060
22		(0.600)	0.090
23	3.200		0.050
24	0.440	(0.260)	0.140
25	0.550		0.050
26	0.150		0.110
27	0.610		0.360
28	0.400		0.090
29	0.220		0.060
30	0.700		0.110
31	2.240		0.070
32	0.760		0.080
33		(0.400)	0.140
34	1.740	(0.060)	0.290
35	0.150		0.260
36		(0.900)	0.170
37		(0.100)	0.220
38	0.100		0.170
39		(0.070)	0.030
40	0.130		0.040
41	3.000		0.170
42	1.200		0.110
43	0.200		0.340
44	0.480		0.060
45	0.140		0.060
<b>TOTAL</b>	<b>37.920</b>		<b>2.460</b>

\* This portion of town highway is Class 3, but is functionally Class 4

MILEAGE SUMMARY	
CLASS 1	
TH-1	0.982
TH-2	1.822
<b>TOTAL CLASS 1</b>	<b>2.804</b>
CLASS 2	
TH-1	1.900
TH-2	5.330
TH-3	1.150
<b>TOTAL CLASS 2</b>	<b>8.380</b>
CLASS 3	
<b>TOTAL CLASS 3</b>	<b>37.920</b>
<b>TOTAL TOWN</b>	<b>49.104</b>
STATE HIGHWAY	
VT-105	8.248
VT-105A	1.799
<b>TOTAL STATE HIGHWAY</b>	<b>10.047</b>
<b>TOTAL STATE</b>	<b>10.047</b>

**TOTAL, TRAVELED HIGHWAYS, FEB. 10, 2007: 59.151**  
(Excludes Class 4 and Legal Trail Mileage)

- HIGHWAYS**
- INTERSTATE
- U.S. ROUTE
- STATE ROUTE
- CLASS 1
- CLASS 2
- CLASS 3
- CLASS 4
- LEGAL TRAIL
- INTERSTATE OR DIVIDED HIGHWAY
- STATE - HARD SURFACE OR PAVED
- TOWN - HARD SURFACE OR PAVED
- GRAVEL
- SOIL OR GRADED AND DRAINED EARTH
- UNIMPROVED OR PRIMITIVE
- IMPASSABLE OR UNTRAVELED
- LEGAL TRAIL
- DISCONTINUED
- HIGHWAY CLASS CHANGE
- RAILROAD
- FEDERAL CLASSIFICATION IDENTIFIER**
- FAU URBAN ARTERIAL OR COLLECTOR
- MA MINOR ARTERIAL
- MJC MAJOR COLLECTOR
- MNC MINOR COLLECTOR
- PA PRINCIPAL ARTERIAL
- PUBLIC LAND**
- POLITICAL SUBDIVISIONS**
- STATE BOUNDARY
- COUNTY BOUNDARY
- TOWN BOUNDARY
- VILLAGE BOUNDARY
- URBAN COMPACT BOUNDARY
- WATER BODIES**
- OPEN WATER
- SWAMP
- STREAM OR BROOK
- BRIDGE OR CULVERT**
- BRIDGE OR CULVERT GREATER THAN 20'
- BRIDGE OR CULVERT 6' - 20'
- B34 STATE BRIDGE IDENTIFIER**
- B34 TOWN BRIDGE IDENTIFIER**

**DISCLAIMER:**  
The untraveled highways (laid-out town highways), discontinued highways, and legal trails shown hereon are those of which the Agency of Transportation has record; others may exist.  
Highway and bridge data by the Agency of Transportation, Policy & Planning Division. All other data from the Vermont Center for Geographic Information.

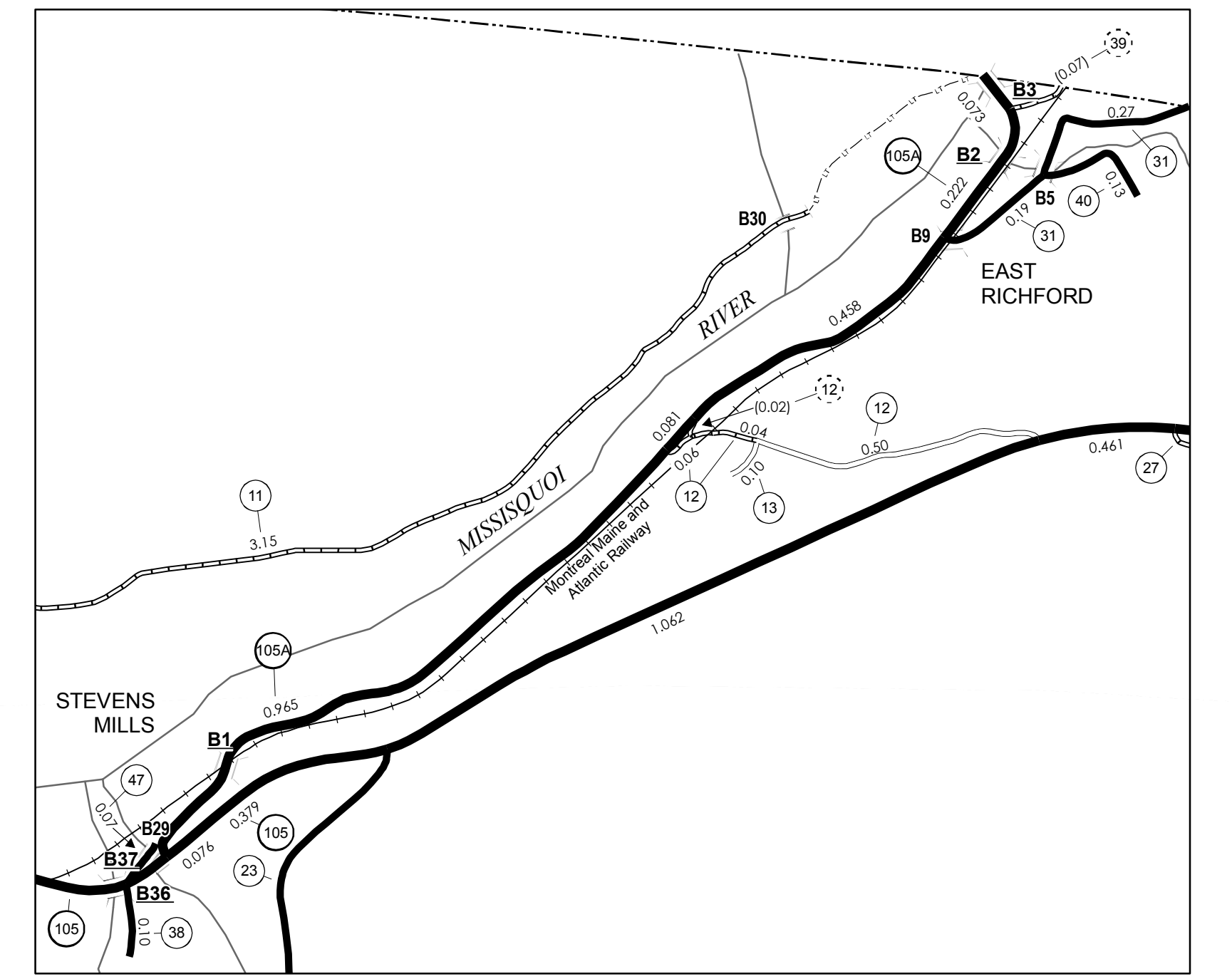
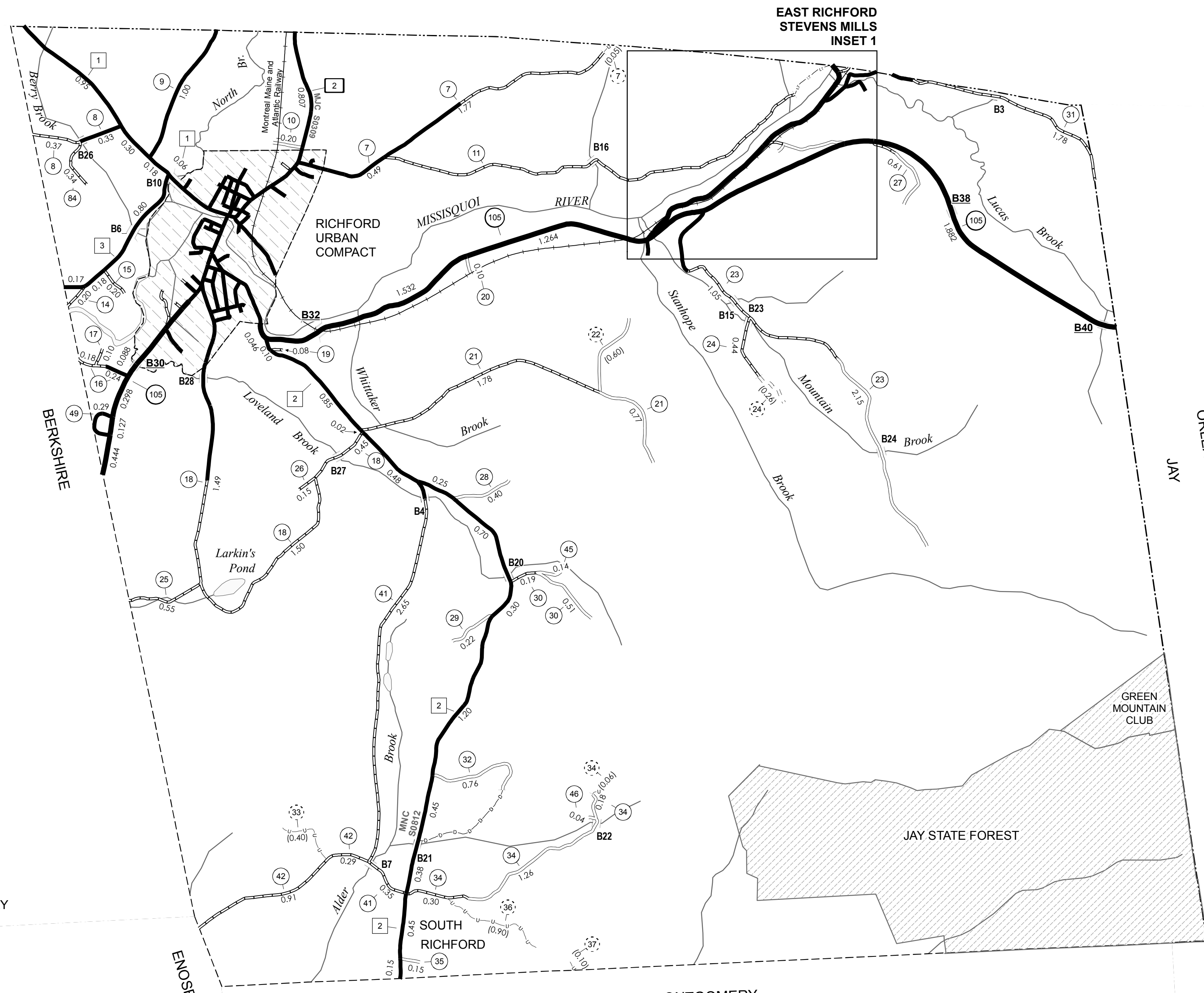

EAST RICHFORD STEVENS MILLS INSET 1  
SCALE 1:12672

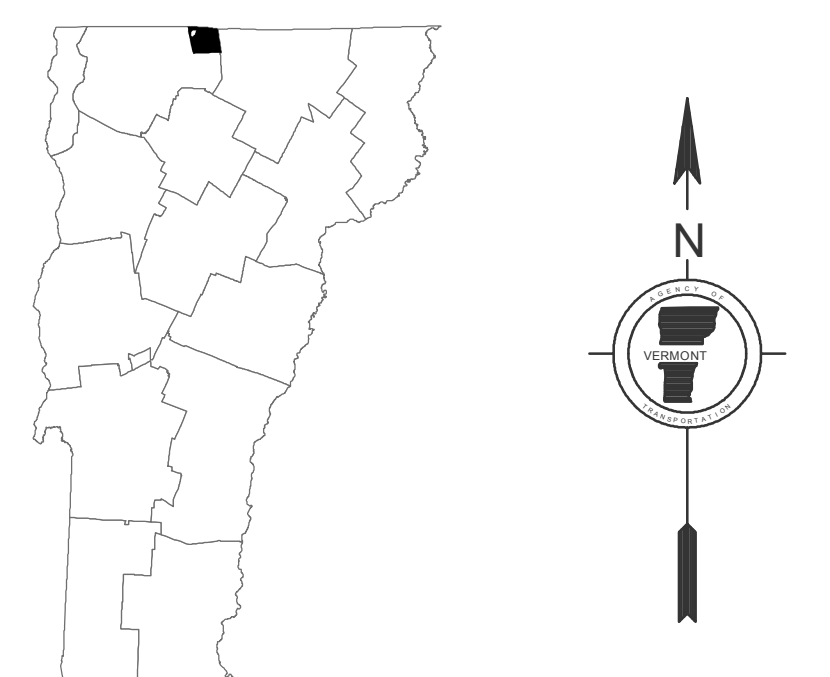
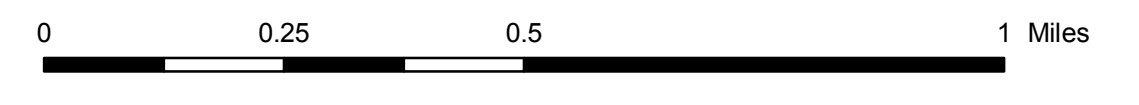

**VERMONT**  
**GENERAL HIGHWAY MAP**  
**Town of Richford**  
FRANKLIN COUNTY

Transportation District #8

Prepared by the  
Vermont Agency of Transportation  
Policy & Planning Division  
in cooperation with  
U.S. Department of Transportation  
Federal Highway Administration

Mileage as of: Feb. 10, 2007  
Map generated: October, 2007

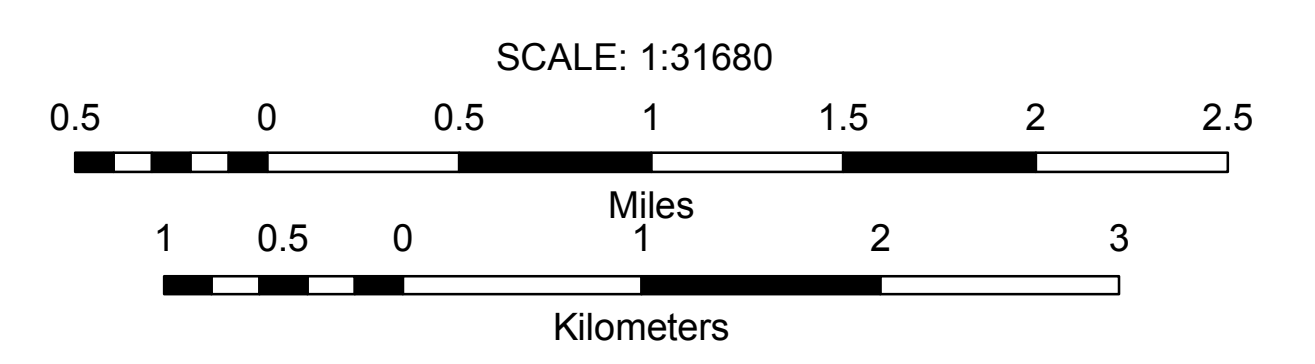

Vermont State Plane Coordinate System  
North American Datum of 1983  
SPCS\_Zone\_Identifier: 4400  
Geodetic Reference System 80  
4,000-meter grid, Easting - Northing