

| TOWN HWY. No. | LENGTH CLASS 3 | IN MILES CLASS 4 | TOWN HWY. No. | LENGTH CLASS 3 | LENGTH IN MILES CLASS 4 |
|---------------|----------------|------------------|---------------|----------------|-------------------------|
| 6 | 0.66 | (0.26) | 36 | 0.30 | |
| 7 | 0.70 | | 37 | 1.47 | |
| 9 | 0.65 | | 38 | | (0.63) |
| 10 | 2.61 | | 39 | 3.80 | |
| 11 | 2.36 | | 40 | 0.42 | (1.18) |
| 12 | 0.70 | | 41 | 0.60 | |
| 13 | 3.30 | | 42 | 0.40 | |
| 14 | 0.60 | | 43 | 0.10 | |
| 15 | 2.60 | | 44 | 0.55 | |
| 16 | 1.15 | | 45 | 0.30 | |
| 17 | 2.25 | | 46 | 0.70 | |
| 18 | | (0.15) | 47 | 0.30 | |
| 19 | | (0.63) | 48 | 0.05 | |
| 20 | 0.70 | | 49 | 0.15 | |
| 21 | 2.60 | | 50 | 0.21 | |
| 22 | 0.28 | (1.07) | 51 | 1.86 | |
| 23 | 0.25 | | 52 | 0.70 | |
| 24 | 0.65 | | 53 | 0.15 | |
| 25 | 3.73 | | 54 | 0.05 | |
| 26 | 0.50 | | 55 | 0.43 | |
| 27 | | (0.45) | 56 | 0.30 | |
| 28 | 2.05 | | 57 | 0.10 | |
| 29 | 2.50 | | 58 | 0.05 | |
| 30 | 0.25 | | 59 | 0.42 | |
| 31 | 1.05 | | 60 | 0.46 | |
| 32 | 0.65 | | 61 | 0.12 | |
| 33 | 1.92 | (0.50) | 62 | 0.04 | |
| 34 | 0.08 | | 64 | | (0.59) |
| 35 | 1.30 | | | | |
| TOTAL | | | 50.12 | | 5.46 |

MILEAGE SUMMARY

| CLASS | Subclass | Mileage | Total |
|-------------------------------------------------|----------------------------|---------|---------------|
| CLASS 2 | | | |
| | TH-1 | 5.200 | |
| | TH-2 | 3.620 | |
| | TH-3 | 0.030 | |
| | TH-4 | 0.570 | |
| | TH-5 | 1.900 | |
| | TOTAL CLASS 2 | | 11.320 |
| CLASS 3 | | | |
| | TOTAL CLASS 3 | | 50.12 |
| TOTAL TOWN | | | 61.440 |
| STATE HIGHWAY | | | |
| | VT-104 | 14.185 | |
| | VT-104A | 1.165 | |
| | VT-128 | 0.787 | |
| | TOTAL STATE HIGHWAY | | 16.137 |
| TOTAL STATE | | | 16.137 |
| INTERSTATE | | | |
| | I-89 | 1.240 | |
| | TOTAL INTERSTATE | | 1.240 |
| TOTAL, TRAVELED HIGHWAYS, FEB. 10, 2013: | | | 78.817 |

(Excludes Class 4, Legal Trail, and Unidentified Corridor Mileage)

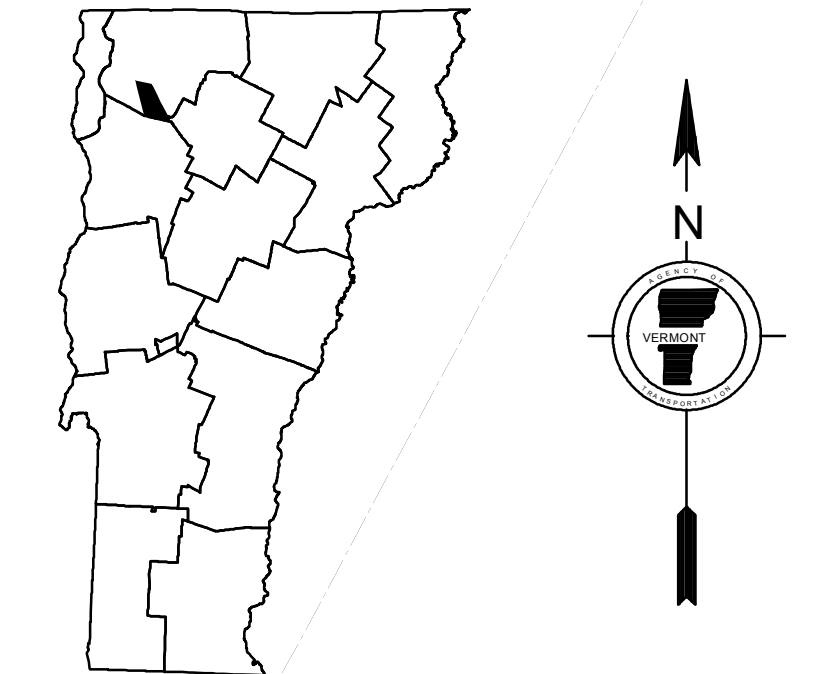
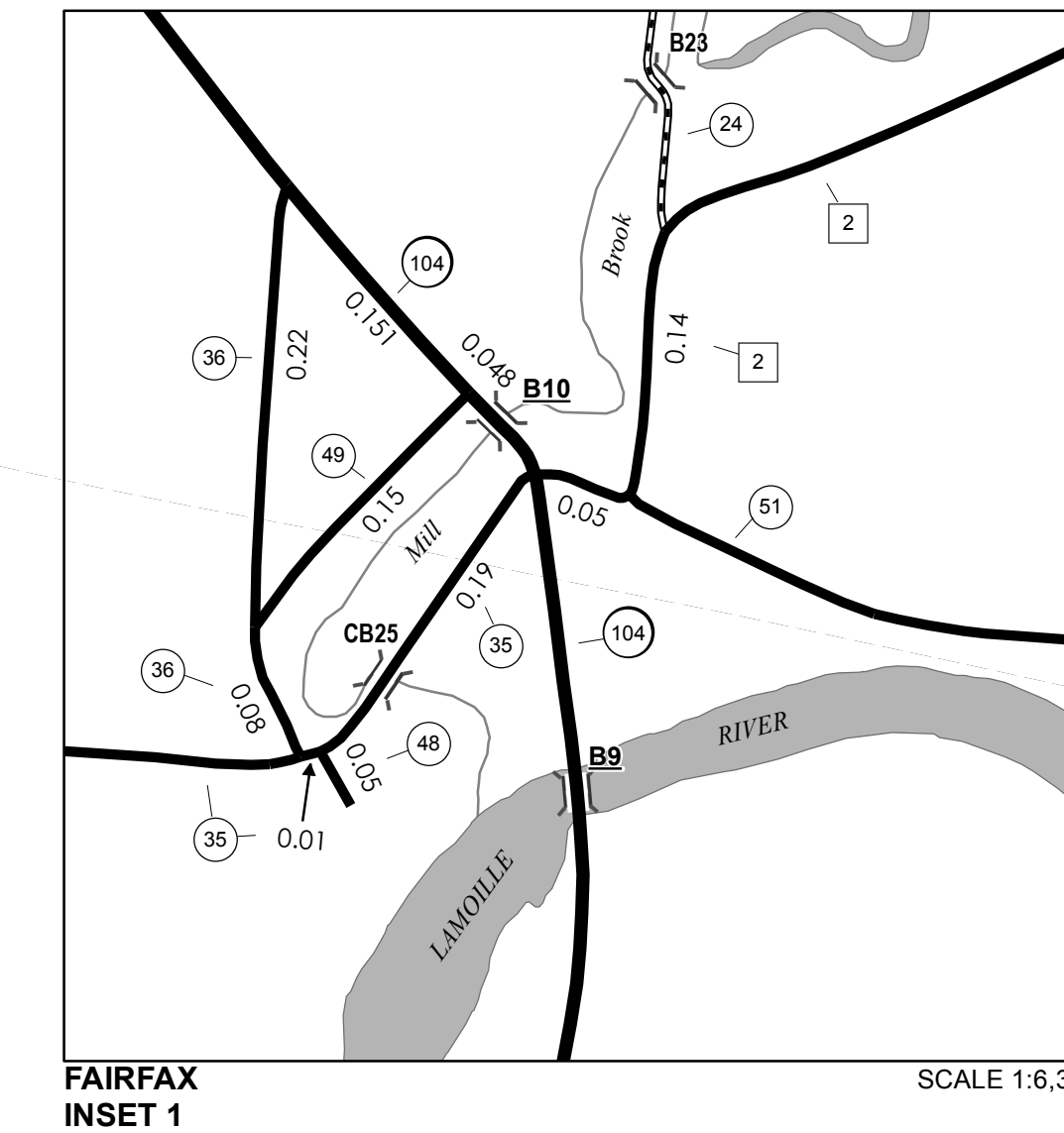

VERMONT
GENERAL HIGHWAY MAP
Town of Fairfax
 FRANKLIN COUNTY
 Transportation District #8
 Prepared by the
 Vermont Agency of Transportation
 Division of Policy, Planning and Intermodal Development
 in cooperation with
 U.S. Department of Transportation
 Federal Highway Administration

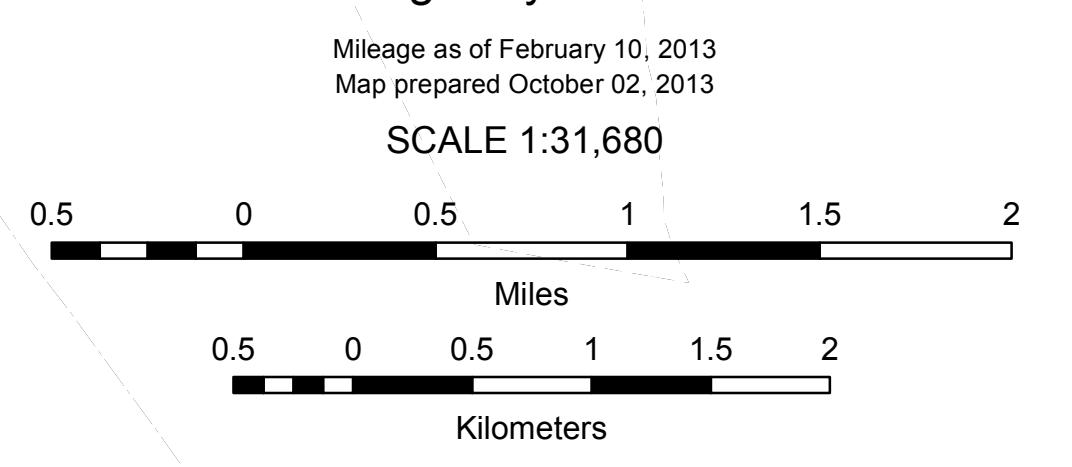

- HIGHWAYS**
- INTERSTATE OR DIVIDED HIGHWAY
 - INTERSTATE
 - U.S. ROUTE
 - STATE ROUTE
 - CLASS 1
 - CLASS 2
 - CLASS 3
 - CLASS 4
 - LEGAL TRAIL
 - INTERSTATE OR DIVIDED HIGHWAY
 - STATE - HARD SURFACE OR PAVED
 - TOWN - HARD SURFACE OR PAVED
 - GRAVEL
 - SOIL OR GRADED AND DRAINED EARTH
 - UNIMPROVED OR PRIMITIVE
 - IMPASSABLE OR UNTRAVELED
 - LEGAL TRAIL
 - DISCONTINUED
 - HIGHWAY CLASS CHANGE
 - RAILROAD
 - INACTIVE RAILROAD
 - NFR NATIONAL FOREST ROAD
 - SFH STATE FOREST HIGHWAY
 - P PARK AND RIDE
- POLITICAL SUBDIVISIONS**
- STATE BOUNDARY
 - COUNTY BOUNDARY
 - TOWN BOUNDARY
 - VILLAGE BOUNDARY
 - URBAN COMPACT BOUNDARY
 - WATER BODY
 - STREAM OR BROOK
- BRIDGE OR CULVERT**
- BRIDGE OR CULVERT GREATER THAN 20'
 - BRIDGE OR CULVERT 6' - 20'
 - STATE BRIDGE OR CULVERT IDENTIFIER
 - TOWN BRIDGE OR CULVERT IDENTIFIER
- FEDERAL CLASSIFICATION IDENTIFIER**
- FAU URBAN ARTERIAL OR COLLECTOR
 - MA MINOR ARTERIAL
 - MJC MAJOR COLLECTOR
 - MNC MINOR COLLECTOR
 - PA PRINCIPAL ARTERIAL
- B34 / C34**
B34 / C34
B34 / C34

DISCLAIMER:
 The untraveled highways (laid-out town highways), discontinued highways, and legal trails hereon are those of which the Agency of Transportation has record; others may exist.
 Highway and bridge data by the Agency of Transportation. All other data from the Vermont Center for Geographic Information. Only named streams are shown.

Vermont State Plane Coordinate System
 North American Datum of 1983
 SPCS_Zone_Identifier: 4400
 Geodetic Reference System 80
 4,000-meter grid, Easting - Northing