

TOWN HWY. No.	LENGTH IN MILES CLASS 3	CLASS 4
3	0.90	(2.00)
4	0.55	(0.08)
5	0.36	
6	0.90	
7	0.07	
8	1.19	(1.04)
9	0.44	
10	0.03	
11	0.50	
12	1.30	(1.40)
14	0.48	(0.48)
15	3.76	(0.61)
16	1.37	(1.76)
17	1.37	(0.83)
18	0.45	
19		(2.45)
20	1.57	(0.10)
21	0.06	
22	0.17	
23	0.07	
24	0.16	
25	0.04	
26	0.06	
27	0.10	
28	0.11	
29	0.18	
31	0.05	
32	0.10	
33	0.20	
34	0.07	
35	0.10	
36	0.04	
37	0.20	
38		
TOTAL	15.08	10.75

TOWN HWY. No.	LENGTH IN MILES "NOT UP TO STANDARD"
8	(0.07)
29	(0.04)
TOTAL	0.11

*The sections of the town highways listed above are legally Class 3, but have been deemed "Not Up To Standard" and are functionally Class 4 Town Highways

MILEAGE SUMMARY		
CLASS 2	TH-1	2.350
	TOTAL CLASS 2	2.350
CLASS 3		15.08
	TOTAL CLASS 3	15.08
	TOTAL TOWN	17.430
STATE HIGHWAY		
VT-102	6.830	
VT-114	8.358	
VT-141	0.457	
VT-253	2.159	
TOTAL STATE HIGHWAY	17.804	
STATE HIGHWAY - Ramps		
VT-141	0.036	
TOTAL STATE HIGHWAY - Ramps	0.036	
TOTAL STATE	17.840	
TOTAL, TRAVELED HIGHWAYS, FEB. 10, 2015:	35.270	

(Excludes Class 4, Legal Trail, and Unidentified Corridor Mileage)

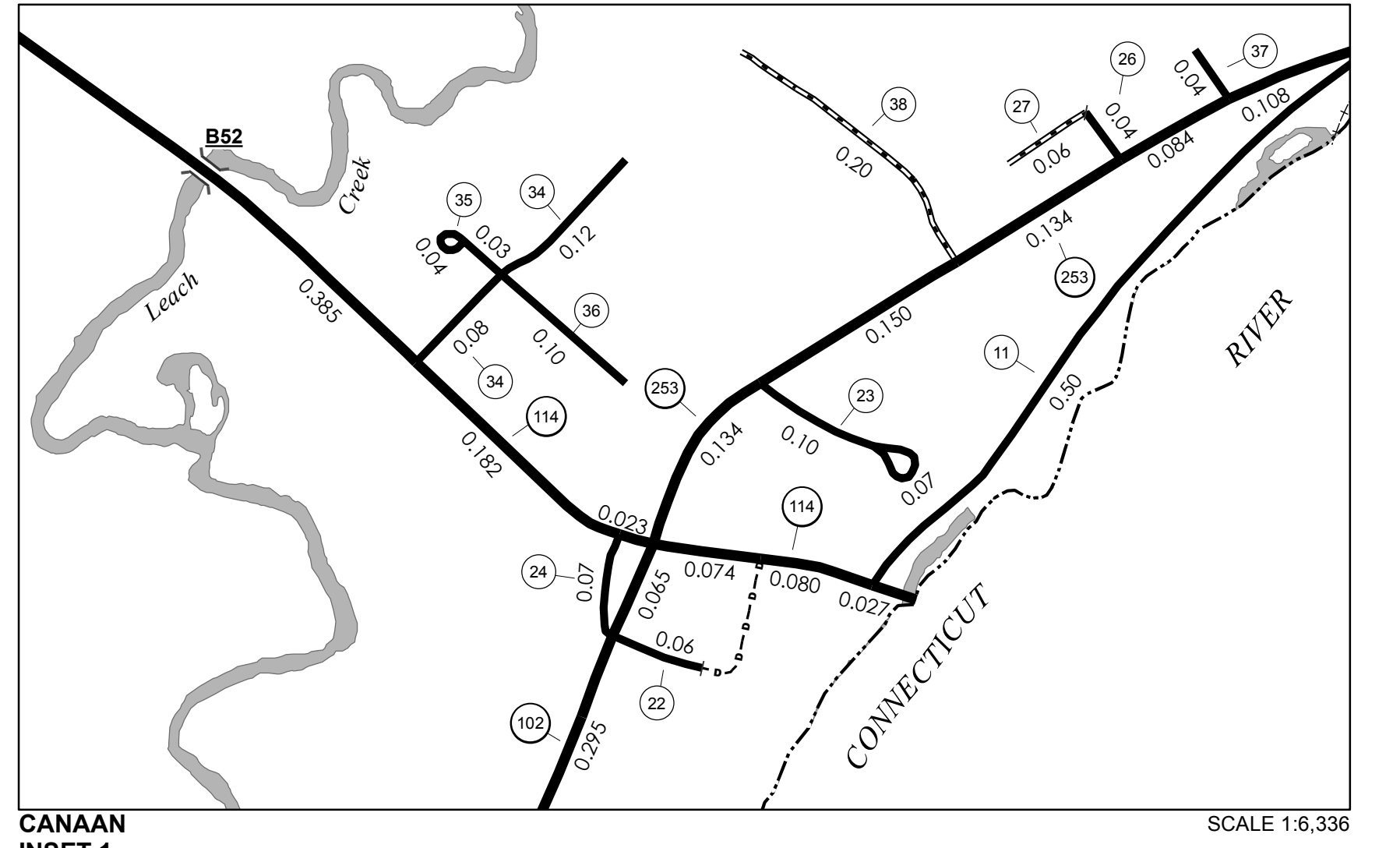
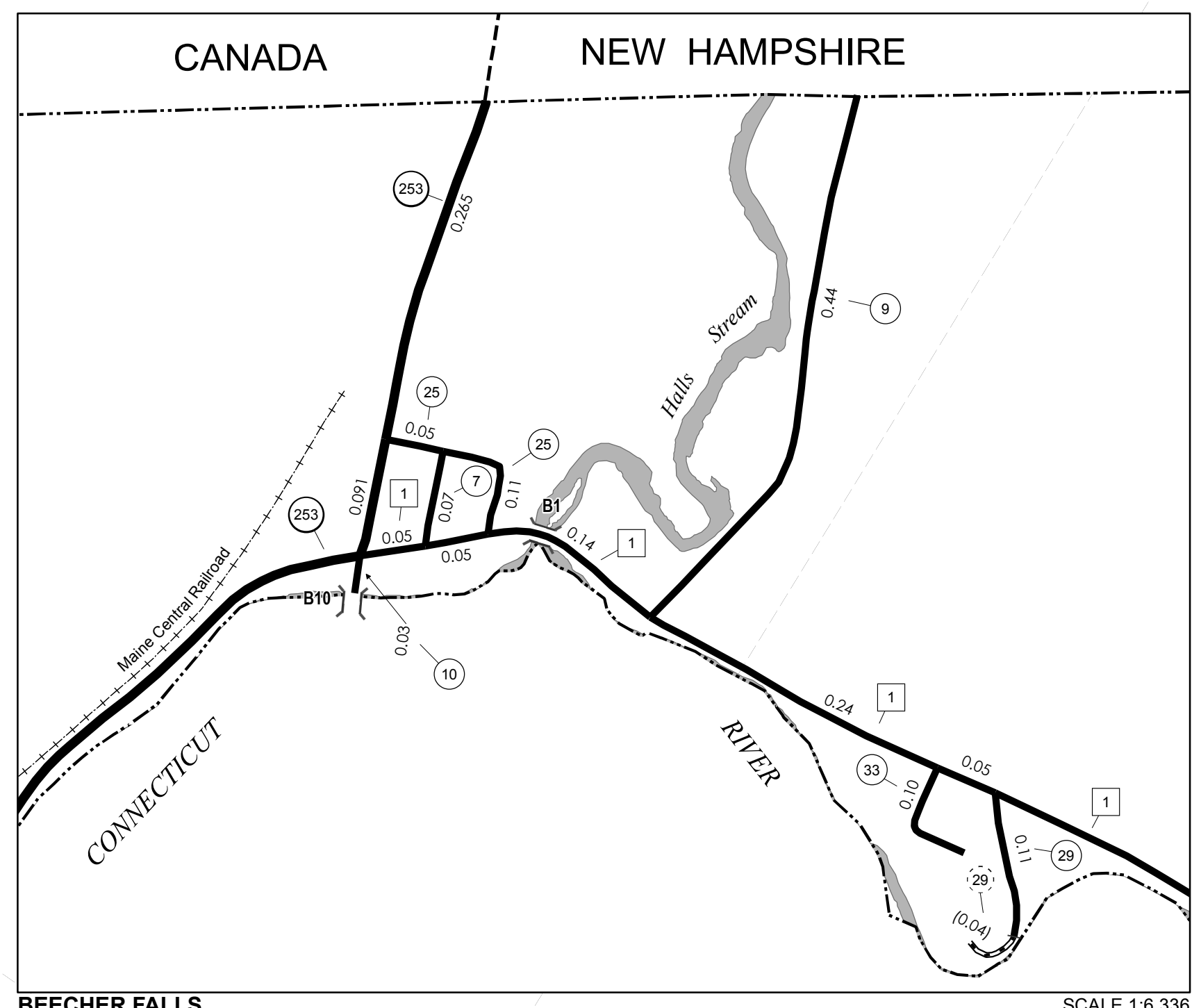

- HIGHWAYS**
 - INTERSTATE
 - U.S. ROUTE
 - STATE ROUTE
 - CLASS 1
 - CLASS 2
 - CLASS 3
 - CLASS 4
 - LEGAL TRAIL
- INTERSTATE OR DIVIDED HIGHWAY
- STATE - HARD SURFACE OR PAVED
- TOWN - HARD SURFACE OR PAVED
- GRAVEL
- SOIL OR GRADED AND DRAINED EARTH
- UNIMPROVED OR PRIMITIVE
- IMPASSABLE OR UNTRAVELED
- LEGAL TRAIL
- DISCONTINUED
- HIGHWAY CLASS CHANGE
- RAILROAD
- INACTIVE RAILROAD
- NFR NATIONAL FOREST ROAD
- SFH STATE FOREST HIGHWAY
- P PARK AND RIDE

- PUBLIC LAND - GREEN MOUNTAIN NATIONAL FOREST
- PUBLIC LAND - STATE/MUNICIPAL
- POLITICAL SUBDIVISIONS**
 - STATE BOUNDARY
 - COUNTY BOUNDARY
 - TOWN BOUNDARY
 - VILLAGE BOUNDARY
 - URBAN COMPACT BOUNDARY
 - WATER BODY
 - STREAM OR BROOK
- BRIDGE OR CULVERT**
 - BRIDGE OR CULVERT > 20'
 - BRIDGE OR CULVERT 6' - 20'
 - VOBCIT BRIDGE
 - VOBCIT CULVERT > 6'
 - STATE BRIDGE OR CULVERT IDENTIFIER
 - TOWN BRIDGE OR CULVERT IDENTIFIER

- FEDERAL CLASSIFICATION IDENTIFIER
 - FAU URBAN ARTERIAL OR COLLECTOR
 - MA MINOR ARTERIAL
 - MJC MAJOR COLLECTOR
 - MNC MINOR COLLECTOR
 - PA PRINCIPAL ARTERIAL

Vermont State Plane Coordinate System
 North American Datum of 1983
 SPCS_Zone_Identifier: 4400
 Geodetic Reference System 80
 4,000-meter grid, Easting - Northing

DISCLAIMER:
 The untraveled highways (laid-out town highways), discontinued highways, and legal trails herein are those of which the Agency of Transportation has record; others may exist.
 Highway and bridge data by the Agency of Transportation. Town short structures are drawn from the Vermont Online Bridge & Culvert Inventory Tool (VOBCIT) database. All other data from the Vermont Center for Geographic Information. Only named streams are shown.

VERMONT
GENERAL HIGHWAY MAP
Town of Canaan
 ESSEX COUNTY
 Transportation District #9
 Prepared by the
 Vermont Agency of Transportation
 Division of Policy, Planning and Intermodal Development
 in cooperation with
 U.S. Department of Transportation
 Federal Highway Administration
 Mileage as of February 10, 2015
 Map prepared June 18, 2015
 SCALE 1:31,680