

TOWN HWY. No.	LENGTH IN MILES CLASS 3	LENGTH IN MILES CLASS 4
4	0.78	(0.15)
5	0.21	
7	1.05	
9	0.74	
10	0.96	(0.63)
12	1.17	
13	0.90	(0.89)
14	3.14	(0.51)
15	0.34	(0.15)
16	0.65	
18	1.30	(0.62)
19	2.27	
20	1.36	(0.77)
22	0.36	
23	0.19	
24	0.54	(0.36)
25	0.15	(0.36)
26	0.66	(1.28)
27	1.36	
28	0.86	
29	1.36	
30	0.15	(1.25)
31	0.08	(0.52)
32	0.86	(0.86)
33	0.85	
34	0.55	(0.57)
35	2.26	
36	1.41	
37	0.13	
38	3.95	
39	1.75	
40	0.08	(0.10)
41	0.02	
43	1.22	
44	0.05	
45	0.35	
46	0.03	
47	0.30	
48	0.29	(0.29)
49	0.14	
50	0.14	
TOTAL	32.60	8.95

MILEAGE SUMMARY	
CLASS 2	
TH-1	1,260
TH-2	5,190
TH-3	5,620
TH-4	3,440
TOTAL CLASS 2	15,510
CLASS 3	
TOTAL CLASS 3	32,60
TOTAL TOWN	48,110
STATE HIGHWAY	
VT-18	7,622
TOTAL STATE HIGHWAY	7,622
US HIGHWAY	
US-5	1,091
TOTAL US HIGHWAY	1,091
INTERSTATE	
I-91	1,608
I-93	10,547
TOTAL INTERSTATE	12,155
INTERSTATE - Ramps	
I-91	1,307
I-93	0,936
TOTAL INTERSTATE - Ramps	2,243
TOTAL INTERSTATE	14,398
TOTAL TRAVELED HIGHWAYS, FEB. 10, 2013:	71,221
<small>(Excludes Class 4, Legal Trail, and Unidentified Corridor Mileage)</small>	

TOWN HWY. No.	LENGTH IN MILES "NOT UP TO STANDARD"
40	(0.12)
TOTAL	0.12

* The sections of the town highways listed above are legally Class 3, but have been deemed "Not Up To Standard" and are functionally Class 4 Town Highways

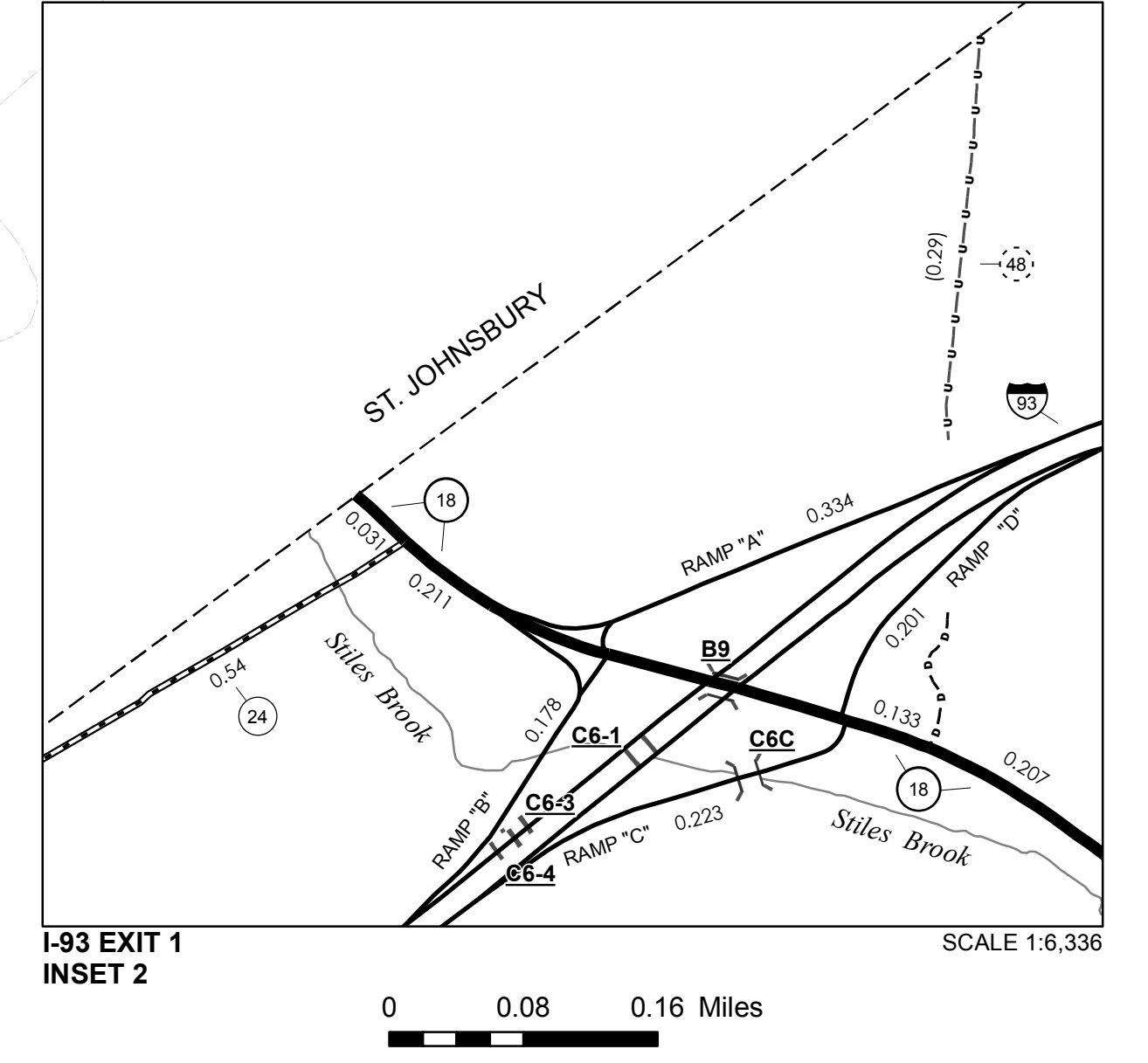
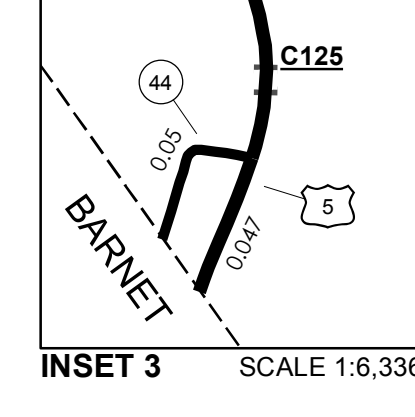
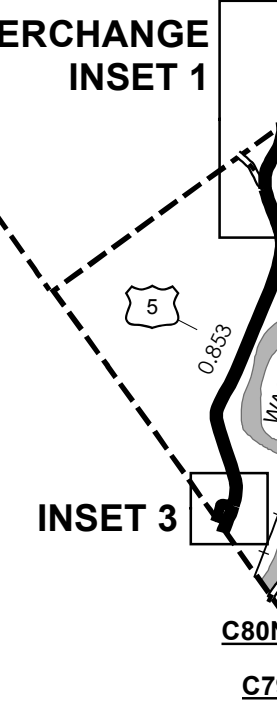
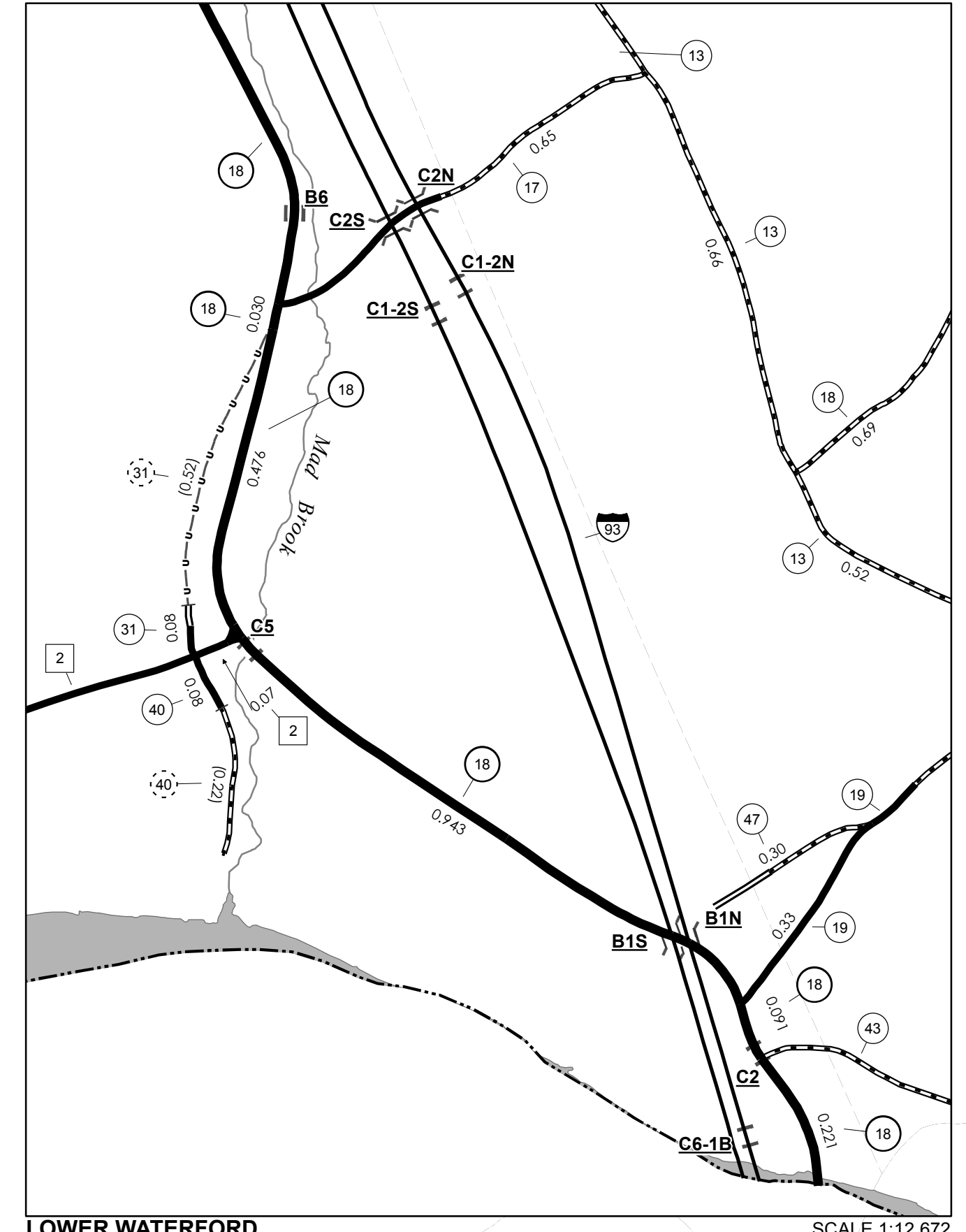
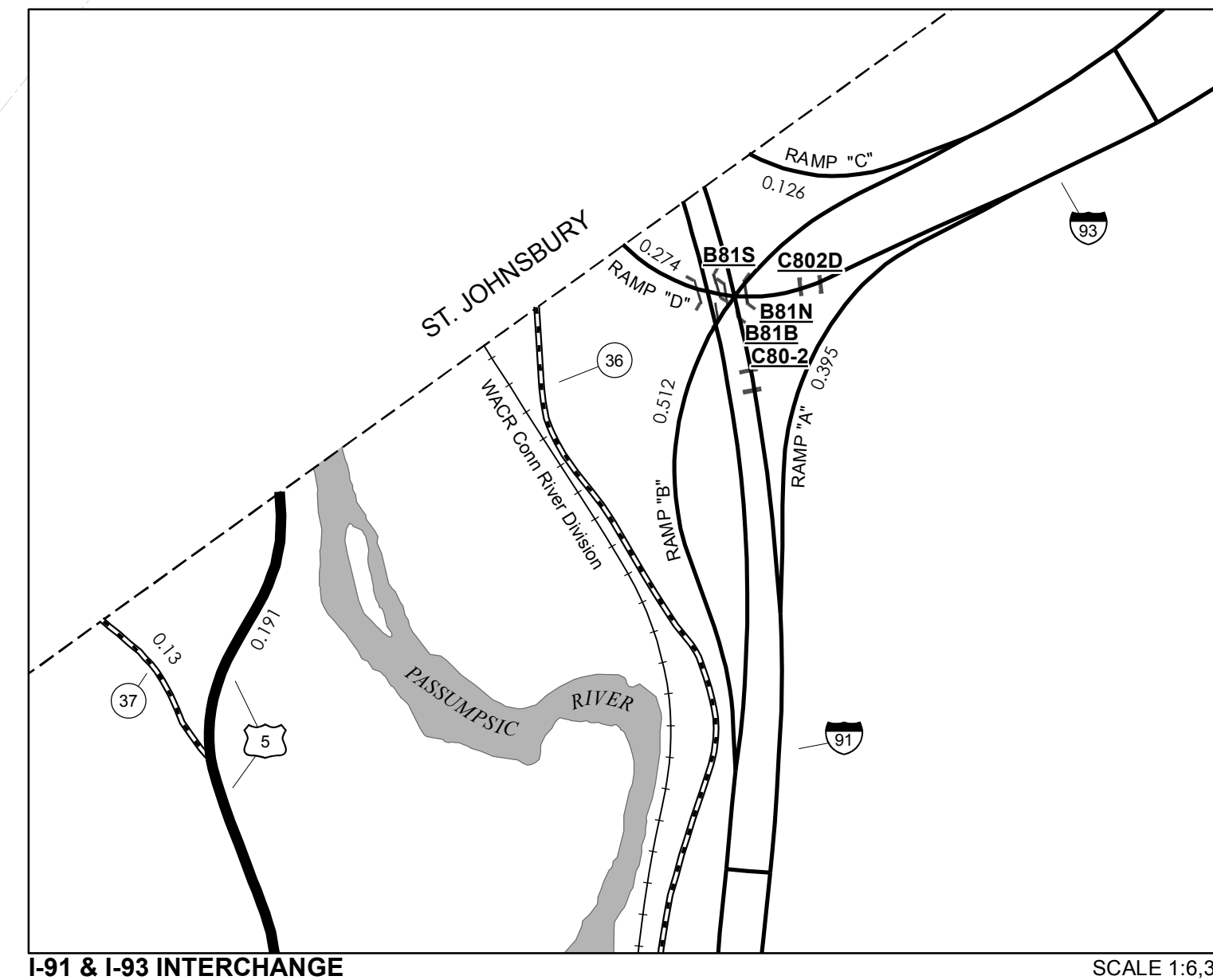
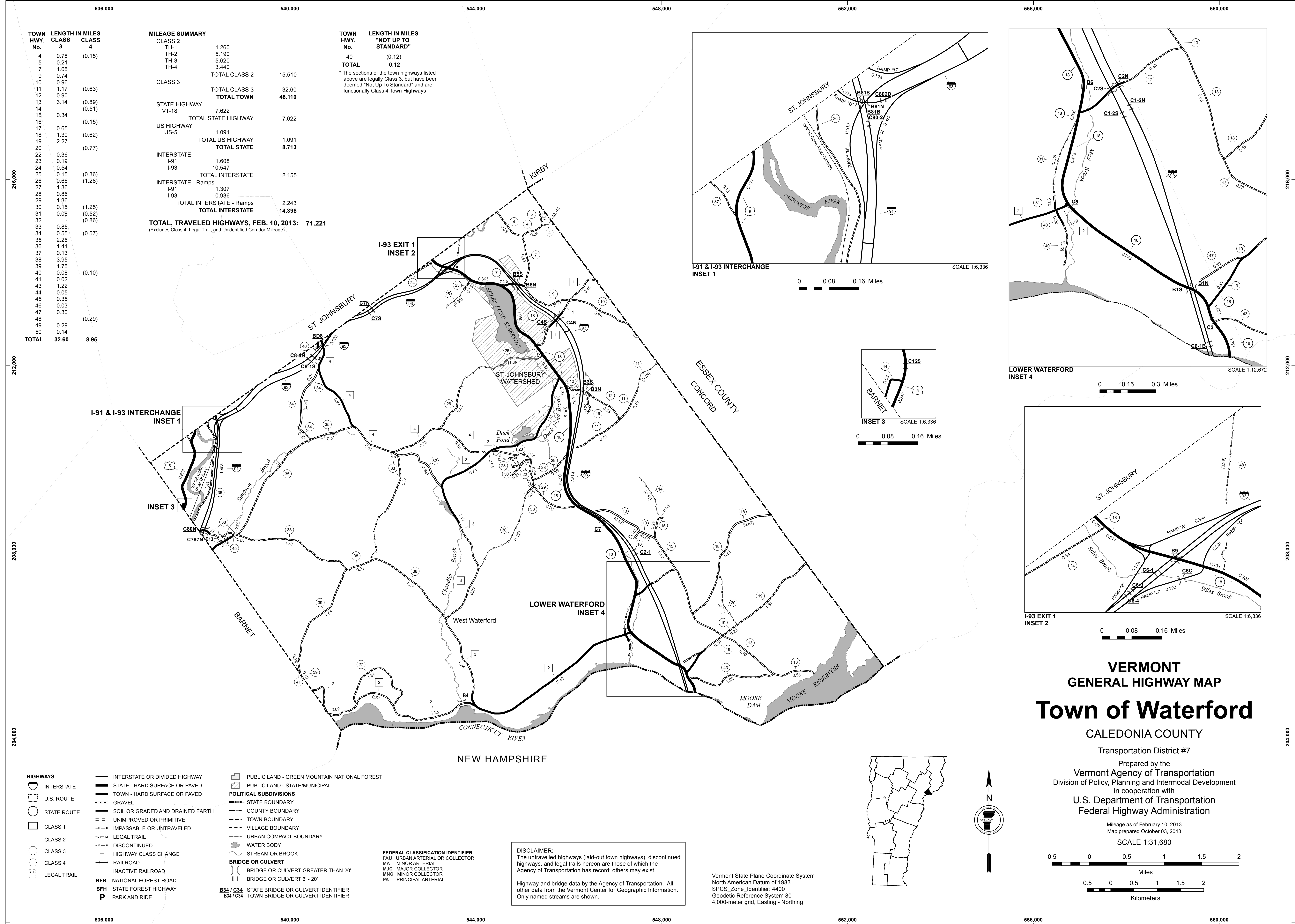

- HIGHWAYS**
 - INTERSTATE
 - U.S. ROUTE
 - STATE ROUTE
 - CLASS 1
 - CLASS 2
 - CLASS 3
 - CLASS 4
 - LEGAL TRAIL
- INTERSTATE OR DIVIDED HIGHWAY
- STATE - HARD SURFACE OR PAVED
- TOWN - HARD SURFACE OR PAVED
- GRAVEL
- SOIL OR GRADED AND DRAINED EARTH
- UNIMPROVED OR PRIMITIVE
- IMPASSABLE OR UNTRAVELED
- LEGAL TRAIL
- DISCONTINUED
- HIGHWAY CLASS CHANGE
- RAILROAD
- INACTIVE RAILROAD
- NFR NATIONAL FOREST ROAD
- SFH STATE FOREST HIGHWAY
- P PARK AND RIDE
- PUBLIC LAND - GREEN MOUNTAIN NATIONAL FOREST
- PUBLIC LAND - STATE/MUNICIPAL
- POLITICAL SUBDIVISIONS**
 - STATE BOUNDARY
 - COUNTY BOUNDARY
 - TOWN BOUNDARY
 - VILLAGE BOUNDARY
 - URBAN COMPACT BOUNDARY
 - WATER BODY
 - STREAM OR BROOK
 - BRIDGE OR CULVERT**
 - BRIDGE OR CULVERT GREATER THAN 20'
 - BRIDGE OR CULVERT 6' - 20'
 - STATE BRIDGE OR CULVERT IDENTIFIER
 - TOWN BRIDGE OR CULVERT IDENTIFIER
- FEDERAL CLASSIFICATION IDENTIFIER**
 - FAU URBAN ARTERIAL OR COLLECTOR
 - MA MINOR ARTERIAL
 - MJC MAJOR COLLECTOR
 - MNC MINOR COLLECTOR
 - PA PRINCIPAL ARTERIAL

DISCLAIMER:
The untraveled highways (laid-out town highways), discontinued highways, and legal trails hereon are those of which the Agency of Transportation has record; others may exist.
Highway and bridge data by the Agency of Transportation. All other data from the Vermont Center for Geographic Information. Only named streams are shown.

Vermont State Plane Coordinate System
North American Datum of 1983
SPCS_Zone_Identifier: 4400
Geodetic Reference System 80
4,000-meter grid, Easting - Northing

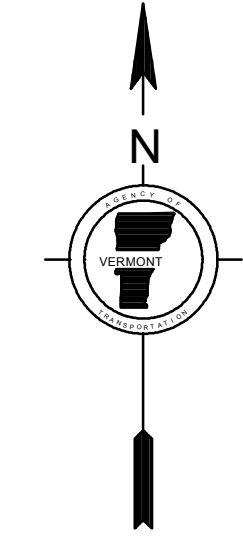
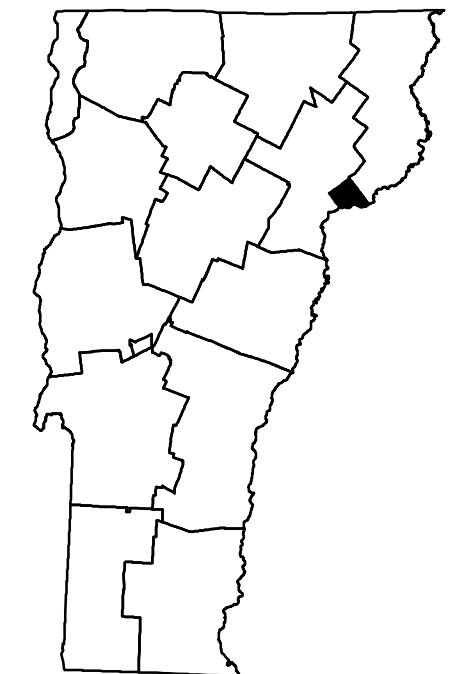

**VERMONT
GENERAL HIGHWAY MAP
Town of Waterford
CALEDONIA COUNTY**

Transportation District #7
Prepared by the
Vermont Agency of Transportation
Division of Policy, Planning and Intermodal Development
in cooperation with
U.S. Department of Transportation
Federal Highway Administration

Mileage as of February 10, 2013
Map prepared October 03, 2013
SCALE 1:31,680

0.5 0 0.5 1 1.5 2
Miles
0.5 0 0.5 1 1.5 2
Kilometers