

TOWN HWY. NO.	CLASS 3	CLASS 4
5	2.230	
6	0.200	
7	0.300	
9	2.000	
10	0.400	(0.200)
11	0.600	
11*		(0.080)
12	3.000	
13	3.460	(2.990)
14		(0.080)
15	0.070	(0.540)
16		(2.150)
18	2.100	
19	0.350	
20	0.150	(0.150)
21	0.140	
22	0.060	
23	0.350	
24	0.080	
25	0.400	
26	1.850	
27		(0.080)
28	2.020	
29	0.120	
30	0.700	(1.030)
31	0.680	(1.220)
32		(0.210)
33	0.100	
34	1.750	
35	2.100	
37	1.300	
38	0.990	(0.490)
39		(0.100)
40	0.400	
41	0.220	
42	0.550	
44	0.770	
45	1.150	(0.700)
46	1.100	1 (0.900)
48	0.600	2 (0.400)
49		3 (0.080)
50	0.080	3 (1.000)
51	0.250	4 (1.100)
52		(0.620)
54	0.050	TOTAL 3.400
55	0.050	
56	0.060	
<b>TOTAL</b>	<b>32.780</b>	<b>10.720</b>

\* This portion of town highway is Class 3, but is functionally Class 4

**MILEAGE SUMMARY**

CLASS 2		
TH-1	1.590	
TH-2	6.200	
TH-3	0.950	
TH-4	0.400	
TOTAL CLASS 2	9.140	
CLASS 3		
TOTAL CLASS 3	32.780	
TOTAL TOWN	41.920	
STATE HIGHWAY		
VT-15	7.164	
TOTAL STATE HIGHWAY	7.164	
TOTAL STATE	7.164	

**TOTAL, TRAVELED HIGHWAYS, FEB. 10, 2007: 49.084**  
(Excludes Class 4 and Legal Trail Mileage)

LEGAL TRAIL NO.	LENGTH IN MILES
1	(0.900)
2	(0.400)
3	(1.000)
4	(1.100)
TOTAL	3.400

- HIGHWAYS**
- INTERSTATE
  - U.S. ROUTE
  - STATE ROUTE
  - CLASS 1
  - CLASS 2
  - CLASS 3
  - CLASS 4
  - LEGAL TRAIL
  - INTERSTATE OR DIVIDED HIGHWAY
  - STATE - HARD SURFACE OR PAVED
  - TOWN - HARD SURFACE OR PAVED
  - GRAVEL
  - SOIL OR GRADED AND DRAINED EARTH
  - UNIMPROVED OR PRIMITIVE
  - IMPASSABLE OR UNTRAVELED
  - LEGAL TRAIL
  - DISCONTINUED
  - HIGHWAY CLASS CHANGE
  - RAILROAD

- PUBLIC LAND**
- POLITICAL SUBDIVISIONS**
- STATE BOUNDARY
  - COUNTY BOUNDARY
  - TOWN BOUNDARY
  - VILLAGE BOUNDARY
  - URBAN COMPACT
- WATER BODIES**
- OPEN WATER
  - SWAMP
  - STREAM OR BROOK
- BRIDGE OR CULVERT**
- BRIDGE OR CULVERT GREATER THAN 20'
  - BRIDGE OR CULVERT 6' - 20'

B34 STATE BRIDGE IDENTIFIER  
B34 TOWN BRIDGE IDENTIFIER

- FEDERAL CLASSIFICATION IDENTIFIER**
- FAU URBAN ARTERIAL OR COLLECTOR
  - MA MINOR ARTERIAL
  - MJC MAJOR COLLECTOR
  - MNC MINOR COLLECTOR
  - PA PRINCIPAL ARTERIAL

**DISCLAIMER:**  
The untraveled highways (laid-out town highways), discontinued highways, and legal trails shown herein are those of which the Agency of Transportation has record; others may exist.  
Highway and bridge data by the Agency of Transportation, Policy & Planning Division. All other data from the Vermont Center for Geographic Information.

Vermont State Plane Coordinate System  
North American Datum of 1983  
SPCS\_Zone\_Identifier: 4400  
Geodetic Reference System 80  
4,000-meter grid, Easting - Northing

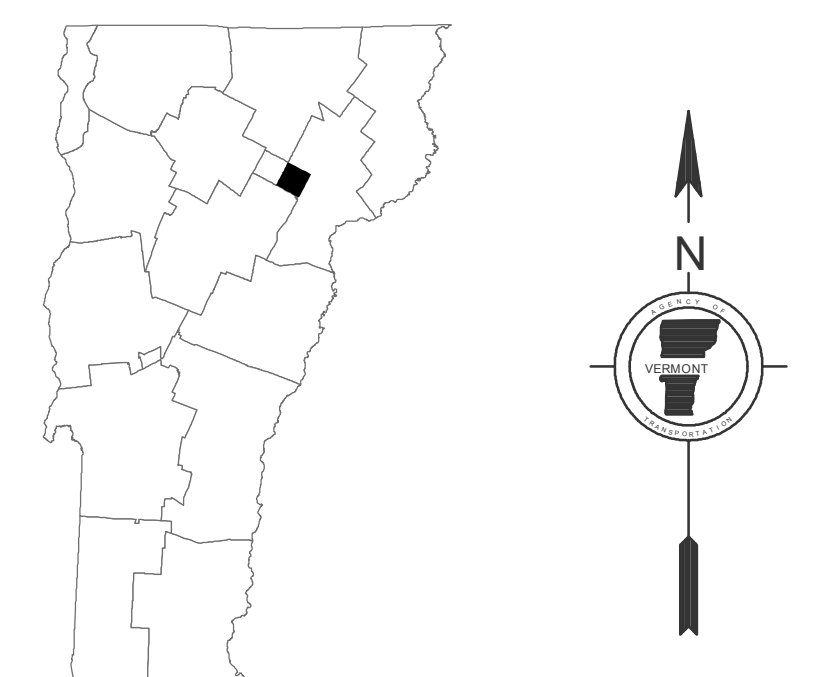
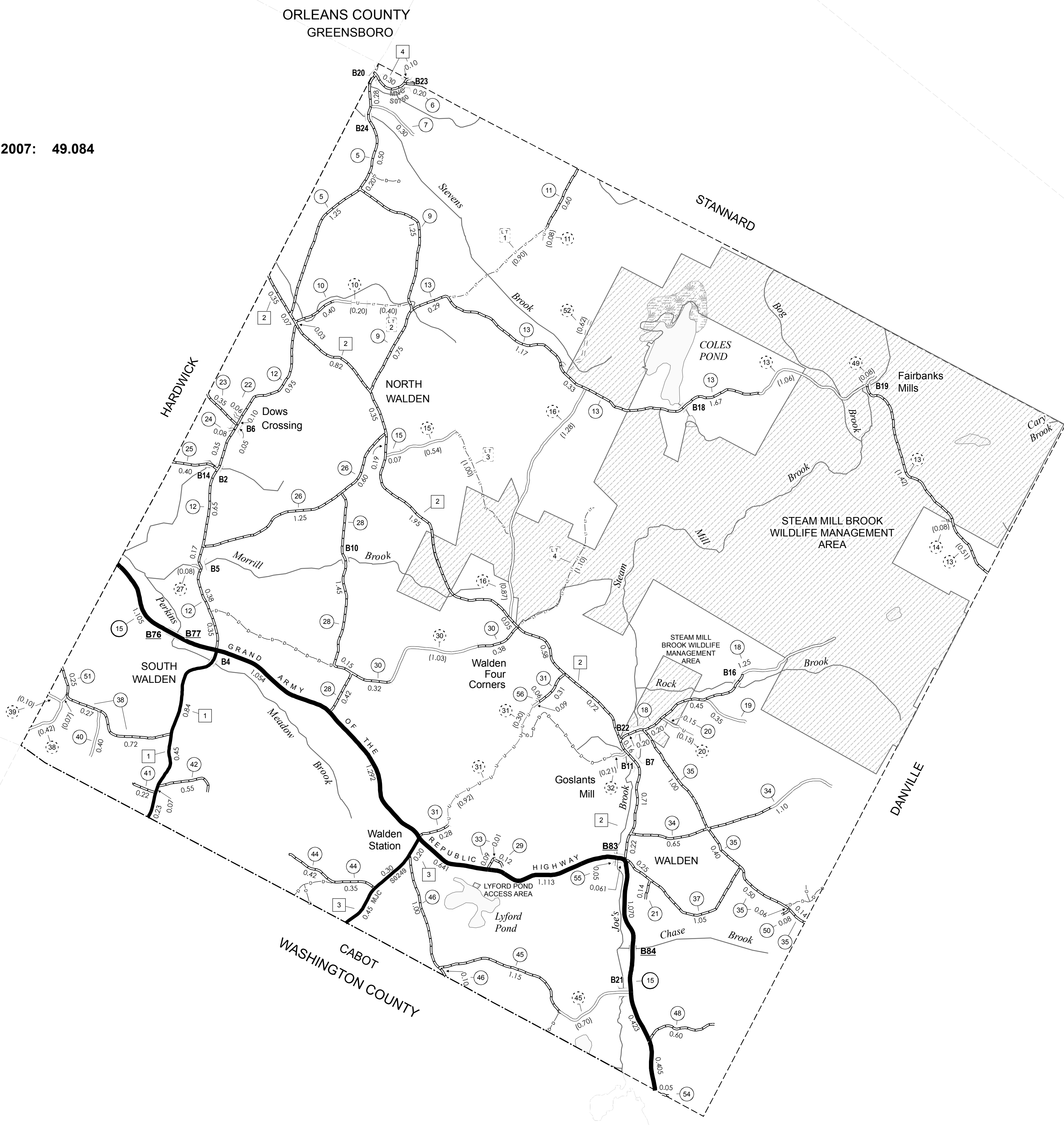

**VERMONT**  
**GENERAL HIGHWAY MAP**  
**Town of Walden**  
CALEDONIA COUNTY

Transportation District #7

Prepared by the  
Vermont Agency of Transportation  
Policy & Planning Division  
in cooperation with  
U.S. Department of Transportation  
Federal Highway Administration

Mileage as of: Feb. 10, 2007  
Map generated: October, 2007

