

TOWN HWY. No.	LENGTH IN MILES	
	CLASS 3	CLASS 4
4		(0.20)
5	2.15	
6		(0.06)
7	1.97	(0.79)
8		(0.15)
9	3.42	
10	0.60	
11	0.60	
12	0.15	
13	0.33	
14	0.95	(0.31)
15	1.70	
16		(0.20)
17	1.50	
18	0.45	
19	1.37	
21	0.70	
22	0.11	(0.14)
23	3.15	
24	1.90	
25	0.03	
26	0.65	
28	0.34	
30	0.06	
32	0.32	(0.63)
33	0.60	
35		(0.28)
36	0.10	(0.30)
37	1.09	
38	2.98	
39	0.40	
40	0.10	
41	1.60	
42		(0.75)
43	0.40	(0.30)
44	1.85	
45	1.98	
48	0.35	
49	0.10	(0.55)
50	0.10	
51	0.38	
52	0.19	
TOTAL	34.67	4.66

MILEAGE SUMMARY

CLASS 2		
TH-1	7.820	
TH-2	1.900	
TH-3	2.590	
TOTAL CLASS 2		12.310
CLASS 3		
TOTAL CLASS 3		34.67
TOTAL TOWN		46.980

STATE HIGHWAY VT-5A 3.204

TOTAL STATE HIGHWAY 3.204

US HIGHWAY US-5 7.329

TOTAL US HIGHWAY 7.329

TOTAL STATE 10.533

TOTAL, TRAVELED HIGHWAYS, FEB. 10, 2025: 57.513
(Excludes Class 4 and Legal Trail Mileage)

LEGAL TRAIL No.	LENGTH IN MILES
1	(0.37)
2	(1.20)
3	(0.75)
4	(1.05)
5	(0.40)
TOTAL	3.77

- HIGHWAYS**

 - INTERSTATE
 - U.S. ROUTE
 - STATE ROUTE
 - CLASS 1
 - CLASS 2
 - CLASS 3
 - CLASS 4
 - LEGAL TRAIL
 - PARK AND RIDE
- INTERSTATE OR DIVIDED HIGHWAY

STATE - HARD SURFACE OR PAVED

TOWN - HARD SURFACE OR PAVED

GRAVEL

SOIL OR GRADED AND DRAINED EARTH

UNIMPROVED OR PRIMITIVE

IMPASSABLE OR UNTRAVELED

LEGAL TRAIL

DISCONTINUED

HIGHWAY CLASS CHANGE

RAILROAD

INACTIVE RAILROAD

PUBLIC LAND - NATIONAL FOREST

PUBLIC LAND - STATE/MUNICIPAL

NFR NATIONAL FOREST ROAD

ACE ARMY CORPS OF ENGINEERS

USGH UNITED STATES GOV. HWY.
- POLITICAL SUBDIVISIONS**

 - STATE BOUNDARY
 - COUNTY BOUNDARY
 - TOWN BOUNDARY
 - VILLAGE BOUNDARY
 - URBAN COMPACT BOUNDARY
 - WATER BODY
 - STREAM OR BROOK

BRIDGE OR CULVERT

 - BRIDGE OR CULVERT > 20'
 - BRIDGE OR CULVERT 6' - 20'
 - BIKE PATH STRUCTURE
 - VT CULVERTS BRIDGE
 - VT CULVERTS CULVERT > 6'

STATE BRIDGE OR CULVERT IDENTIFIER

TOWN BRIDGE OR CULVERT IDENTIFIER
- FEDERAL CLASSIFICATION IDENTIFIER**

 - MA MINOR ARTERIAL
 - MJC MAJOR COLLECTOR
 - MNC MINOR COLLECTOR
 - PA PRINCIPAL ARTERIAL

DISCLAIMER:
The untraveled highways (laid-out town highways), discontinued highways, and legal trails herein are those of which the Agency of Transportation has record; others may exist.

Highway and bridge data by the Agency of Transportation.
Town short structures drawn from the VT CULVERTS (formerly VOBCIT) online database. All other data from the Vermont Open Geodata Portal. Only named streams shown.

Vermont State Plane Coordinate System
North American Datum of 1983
SPCS_Zone_Identifier: 4400
Geodetic Reference System 80
4,000-meter grid, Easting - Northing

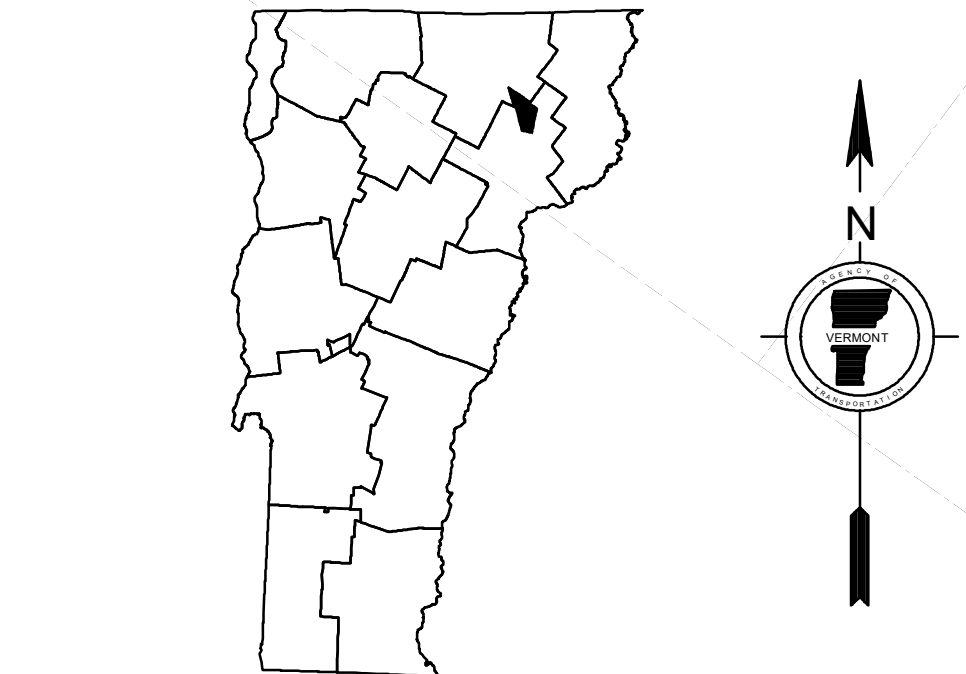
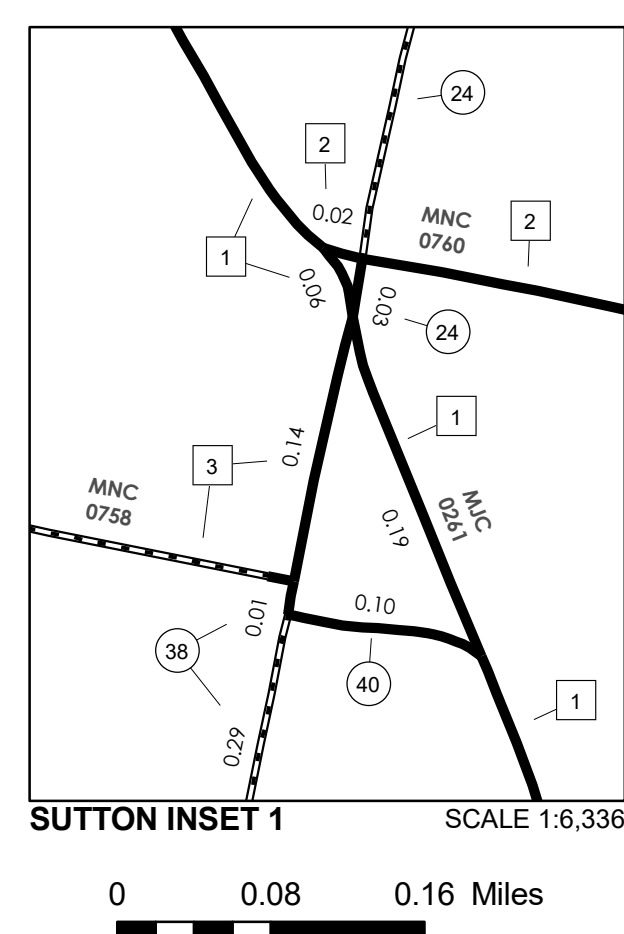
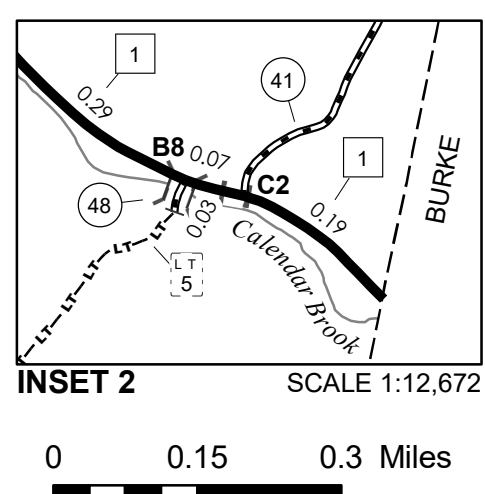

VERMONT
GENERAL HIGHWAY MAP
Town of Sutton
CALEDONIA COUNTY
Transportation District #7
Prepared by the
Vermont Agency of Transportation
Division of Policy, Planning and Intermodal Development
in cooperation with
U.S. Department of Transportation
Federal Highway Administration
Mileage as of February 10, 2025
Map prepared September 03, 2025
SCALE 1:31,680

0.5 0 0.5 1 1.5 2 Miles

0.5 0 0.5 1 1.5 2 Kilometers