

TOWN HWY. No.	LENGTH IN MILES		TOWN ROAD NAME
	CLASS 3	CLASS 4	
300	0.10		MACKENNON DR
302	0.36		STONE RD
304	0.16		COWIE HILL RD
306	0.06		SMITH ST
308	0.61		HALL RD
310	0.17		GILFILLAN RD
312	0.04		TOWN HWY 312
314	0.23		STONESHED RD
318	0.30		PLEASANT ST
320	0.05		TERRY HILL RD
322	0.07		PINEHURST RD
324	0.06		BROWN DR
TOTAL	2.21	0.00	

TOWN HWY. No.	LENGTH IN MILES "NOT UP TO STANDARD"
316	(0.19)
TOTAL	0.19

* The sections of the town highways listed above are legally Class 3, but have been deemed "Not Up To Standard" and are functionally Class 4 Town Highways

MILEAGE SUMMARY

CLASS 2		
TH-2	0.350	
TH-5	0.800	
TOTAL CLASS 2		1.150
CLASS 3		
TOTAL CLASS 3		2.21
TOTAL TOWN		3.360
US HIGHWAY		
US-302	1.065	
TOTAL US HIGHWAY		1.065
TOTAL STATE		1.065
TOTAL, TRAVELED HIGHWAYS, FEB. 10, 2024:		4.425
<small>(Excludes Class 4 and Legal Trail Mileage)</small>		

188,000

188,000

528,000

530,000

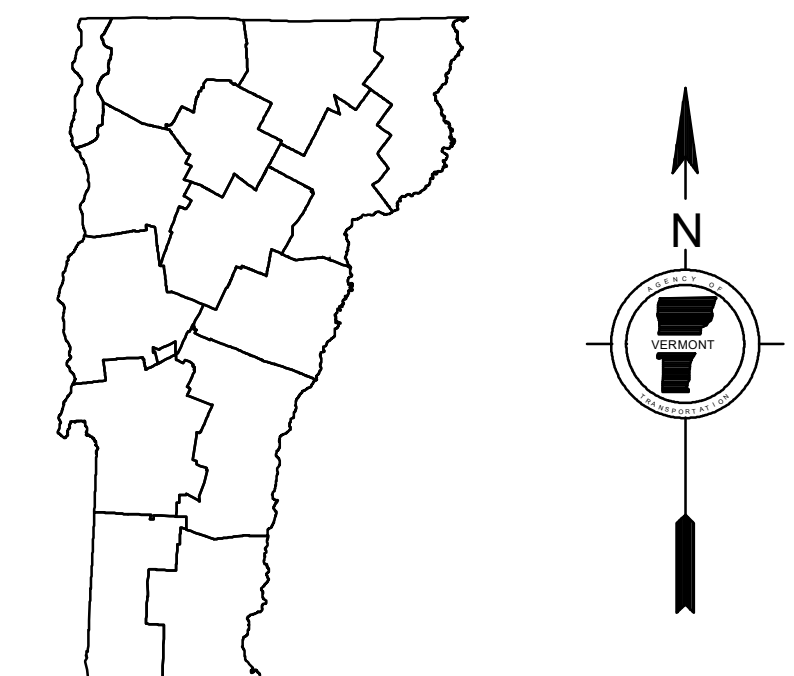
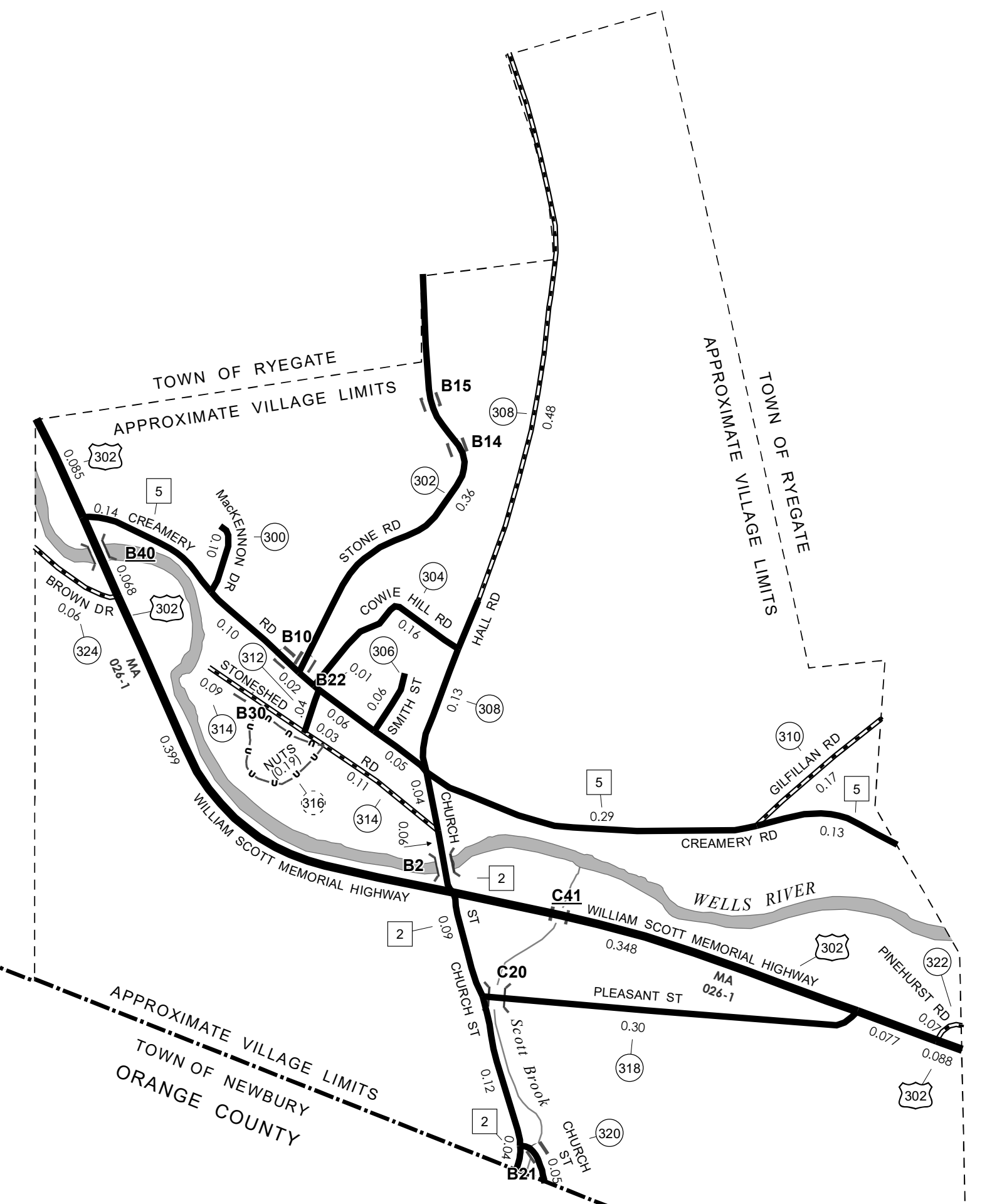

- | | | | |
|--|--|--|--|
| <p>HIGHWAYS</p> <ul style="list-style-type: none"> — INTERSTATE — U.S. ROUTE ○ STATE ROUTE □ CLASS 1 □ CLASS 2 ○ CLASS 3 ○ CLASS 4 — LEGAL TRAIL P PARK AND RIDE | <ul style="list-style-type: none"> — INTERSTATE OR DIVIDED HIGHWAY — STATE - HARD SURFACE OR PAVED — TOWN - HARD SURFACE OR PAVED — GRAVEL — SOIL OR GRADED AND DRAINED EARTH — UNIMPROVED OR PRIMITIVE — IMPASSABLE OR UNTRAVELED — LEGAL TRAIL — DISCONTINUED — HIGHWAY CLASS CHANGE — RAILROAD — INACTIVE RAILROAD — PUBLIC LAND - NATIONAL FOREST — PUBLIC LAND - STATE/MUNICIPAL NFR NATIONAL FOREST ROAD ACE ARMY CORPS OF ENGINEERS USGH UNITED STATES GOV. HWY. | <p>POLITICAL SUBDIVISIONS</p> <ul style="list-style-type: none"> — STATE BOUNDARY — COUNTY BOUNDARY — TOWN BOUNDARY — VILLAGE BOUNDARY — URBAN COMPACT BOUNDARY — WATER BODY — STREAM OR BROOK <p>BRIDGE OR CULVERT</p> <ul style="list-style-type: none"> — BRIDGE OR CULVERT > 20' — BRIDGE OR CULVERT 6' - 20' ● BIKE PATH STRUCTURE ● VTCULVERTS BRIDGE ● VTCULVERTS CULVERT > 6' B34 / C34 STATE BRIDGE OR CULVERT IDENTIFIER B34 / C34 TOWN BRIDGE OR CULVERT IDENTIFIER | <p>FEDERAL CLASSIFICATION IDENTIFIER</p> <ul style="list-style-type: none"> MA MINOR ARTERIAL MJC MAJOR COLLECTOR MNC MINOR COLLECTOR PA PRINCIPAL ARTERIAL |
|--|--|--|--|

DISCLAIMER:
The untraveled highways (laid-out town highways), discontinued highways, and legal trails hereon are those of which the Agency of Transportation has record; others may exist.

Highway and bridge data by the Agency of Transportation.
Town short structures drawn from the VTCULVERTS (formerly VOBCT) online database. All other data from the Vermont Open Geodata Portal. Only named streams shown.

Vermont State Plane Coordinate System
North American Datum of 1983
SPCS_Zone_Identifier: 4400
Geodetic Reference System 80
2,000-meter grid, Easting - Northing

VERMONT
GENERAL HIGHWAY MAP
Village of South Ryegate
CALEDONIA COUNTY

Transportation District #7
Prepared by the
Vermont Agency of Transportation
Division of Policy, Planning and Intermodal Development
in cooperation with
U.S. Department of Transportation
Federal Highway Administration

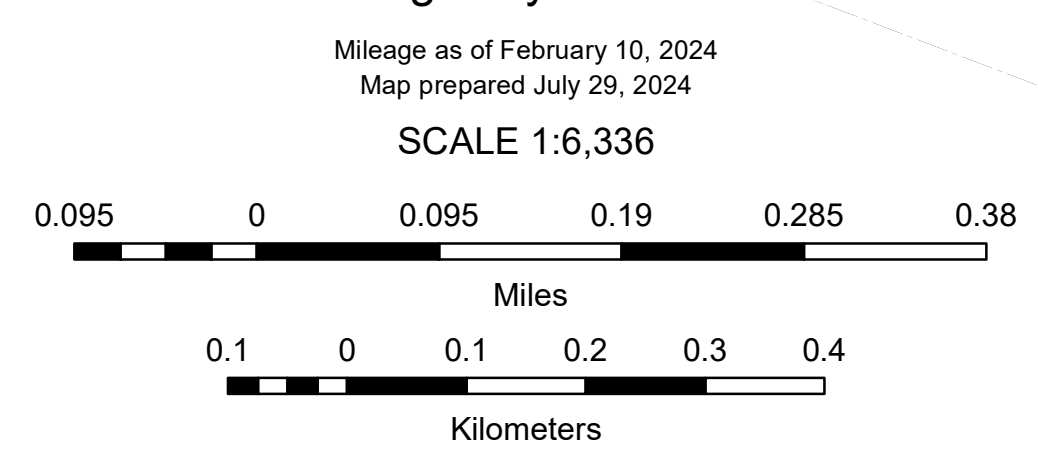

528,000

530,000