

TOWN HWY. No.	LENGTH IN MILES CLASS 3	CLASS 4	TOWN HWY. No.	LENGTH IN MILES CLASS 3	CLASS 4	TOWN HWY. No.	LENGTH IN MILES CLASS 3	CLASS 4
9	2.05		57	1.65		107	0.20	
10	0.10		58	0.10		108	0.44	
11	1.81	(0.03)	59	1.41		109	0.02	
12	0.10		60	0.30		110	0.11	
13	0.65		61	0.08	(0.25)	111	0.18	
14	3.68		62	0.09		112	0.28	(0.17)
15	0.40	(0.25)	63	0.19		113	0.06	
16	1.78		64	0.10		114	0.21	
17	0.22		65	0.35		115	0.74	
18	0.22		66	0.18		116	0.16	
19	1.28		67	0.25		117	0.09	
20	0.04	(0.46)	68	1.58		118	0.10	
21	1.04		69	0.70		119	0.10	
22	0.11		70	0.20	(0.34)	120	0.09	
23	1.17	(0.12)	71	0.20	(0.12)	121	0.07	
24	2.14	(0.41)	72	0.20		124	0.08	
25	0.33		73	0.20	(0.27)	125	0.06	
26	0.96		74	0.28		126	0.03	
27	0.04		75	0.29		127	0.07	
28	0.58		76	0.86		129	0.10	
29	0.30	(0.20)	77	0.20		130	0.24	
30	1.45		78	0.20		131	0.08	
31	1.64		79	0.49		132	0.06	
32	1.40		80	0.20		133	0.15	
33	0.17		81	0.05	(0.07)	134	0.20	
34	0.35		82	0.10		135	0.09	
37	0.55		83	0.07		136	0.12	
38	0.83		85	0.23		137	0.26	
39	0.63	(0.19)	87	0.10		138	0.05	
40	1.77		90	0.05		139	0.05	
41	0.32		91	0.10		140	0.05	
42	0.25		92	0.90		141	0.78	
43	0.75	(0.13)	93	0.27		142	0.11	
44	0.30	(1.70)	94	0.56		143	0.11	
45	1.49		95	0.09		144	0.15	
46	1.84		96	0.15		145	0.51	
47	0.04	(0.71)	97	0.25		146	0.20	
48	0.89	(0.94)	98	0.38		147	0.31	
49	1.05		99	0.26		149	0.14	(0.24)
50	0.64	(0.23)	100	0.16		150	0.10	(0.33)
51	0.55		101	0.19		151	0.19	
52	0.35		102	0.18		152	0.19	
53	0.13	(0.11)	103	0.19		153	0.25	
54	0.94	(0.36)	104	0.07		154	0.29	
55	0.45		105	0.17				
56	0.19	(0.61)	106	0.12				
			<b>TOTAL</b>	<b>59.65</b>	<b>8.81</b>			

MILEAGE SUMMARY		LEGAL TRAIL LENGTH IN MILES	
CLASS 1		LEGAL TRAIL	LEGAL TRAIL
TH-8	0.689	No.	(0.20)
TOTAL CLASS 1	0.689	TOTAL	0.20
CLASS 2			
TH-1	4.050		
TH-2	3.910		
TH-4	0.600		
TH-5	2.980		
TH-6	1.050		
TH-7	0.260		
TH-9	2.060		
TH-10	1.420		
TH-11	2.960		
TOTAL CLASS 2	19.390		
CLASS 3			
TOTAL CLASS 3	59.65		
TOTAL TOWN	79.729		
STATE HIGHWAY			
VT-114	4.030		
VT-122	4.353		
TOTAL STATE HIGHWAY	8.383		
STATE HIGHWAY - Ramps			
VT-114	0.085		
TOTAL STATE HIGHWAY - Ramps	0.085		
US HIGHWAY			
US-5	5.565		
TOTAL US HIGHWAY	5.565		
TOTAL STATE	14.033		
INTERSTATE			
I-91	6.846		
TOTAL INTERSTATE	6.846		
INTERSTATE - Ramps			
I-91	2.144		
TOTAL INTERSTATE - Ramps	2.144		
TOTAL INTERSTATE	8.990		
<b>TOTAL, TRAVELED HIGHWAYS, FEB. 10, 2017:</b>	<b>102.752</b>		

- HIGHWAYS**
- INTERSTATE
  - U.S. ROUTE
  - STATE ROUTE
  - CLASS 1
  - CLASS 2
  - CLASS 3
  - CLASS 4
  - LEGAL TRAIL
  - GRAVEL
  - SOIL OR GRADED AND DRAINED EARTH
  - UNIMPROVED OR PRIMITIVE
  - IMPASSABLE OR UNTRAVELED
  - LEGAL TRAIL
  - DISCONTINUED
  - HIGHWAY CLASS CHANGE
  - RAILROAD
  - INACTIVE RAILROAD
  - PUBLIC LAND - NATIONAL FOREST
  - PUBLIC LAND - STATE/MUNICIPAL
- POLITICAL SUBDIVISIONS**
- STATE BOUNDARY
  - COUNTY BOUNDARY
  - TOWN BOUNDARY
  - VILLAGE BOUNDARY
  - URBAN COMPACT BOUNDARY
  - WATER BODY
  - STREAM OR BROOK
- BRIDGE OR CULVERT**
- BRIDGE OR CULVERT > 20'
  - BRIDGE OR CULVERT 6' - 20'
  - BIKE PATH STRUCTURE
  - VOBCIT BRIDGE
  - VOBCIT CULVERT > 6'
- BRIDGE OR CULVERT IDENTIFIER**
- B34/C34 STATE BRIDGE OR CULVERT IDENTIFIER
  - B34/C34 TOWN BRIDGE OR CULVERT IDENTIFIER
- FEDERAL CLASSIFICATION IDENTIFIER**
- MA MINOR ARTERIAL
  - MJC MAJOR COLLECTOR
  - MNC MINOR COLLECTOR
  - PA PRINCIPAL ARTERIAL

**DISCLAIMER:**  
 The untraveled highways (laid-out town highways), discontinued highways, and legal trails hereon are those of which the Agency of Transportation has record; others may exist.  
 Highway and bridge data by the Agency of Transportation. Town short structures drawn from the Vermont Online Bridge & Culvert Inventory Tool (VOBCIT) database. All other data from the Vermont Center for Geographic Information. Only named streams shown.  
 Vermont State Plane Coordinate System  
 North American Datum of 1983  
 SPCS Zone Identifier: 4400  
 Geodetic Reference System 80  
 4,000-meter grid, Easting - Nothing

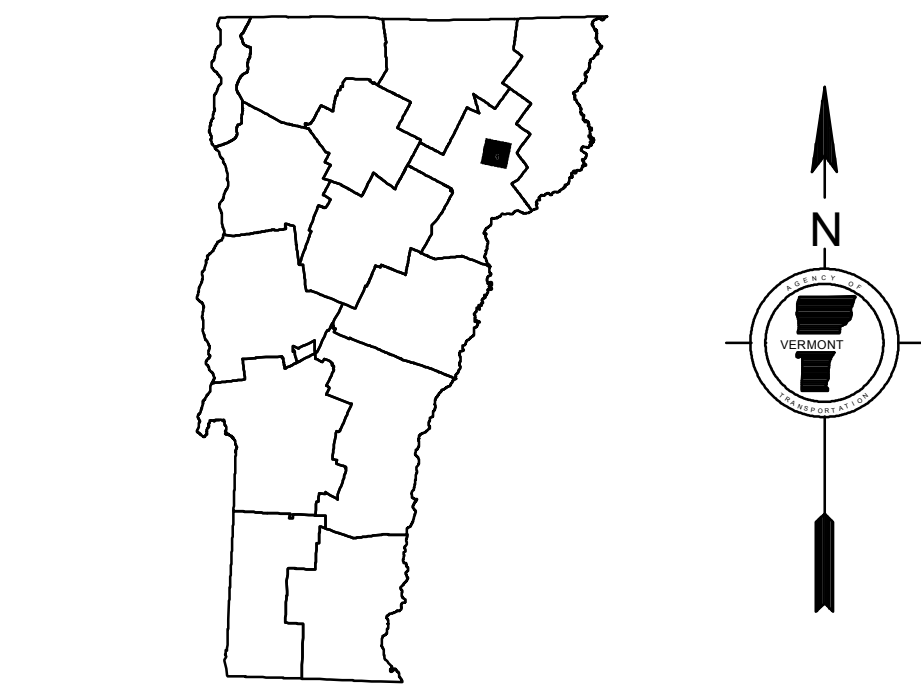
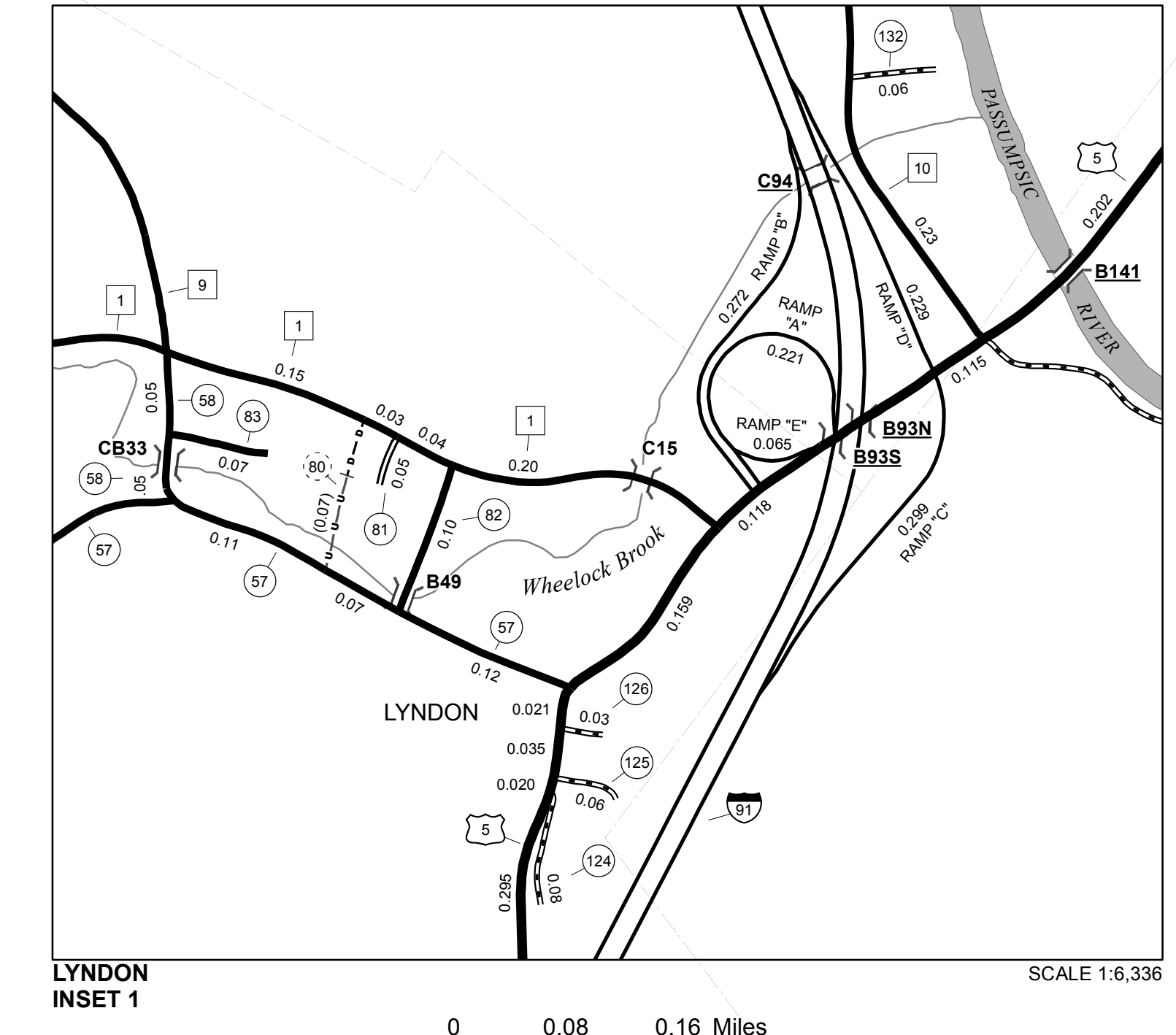
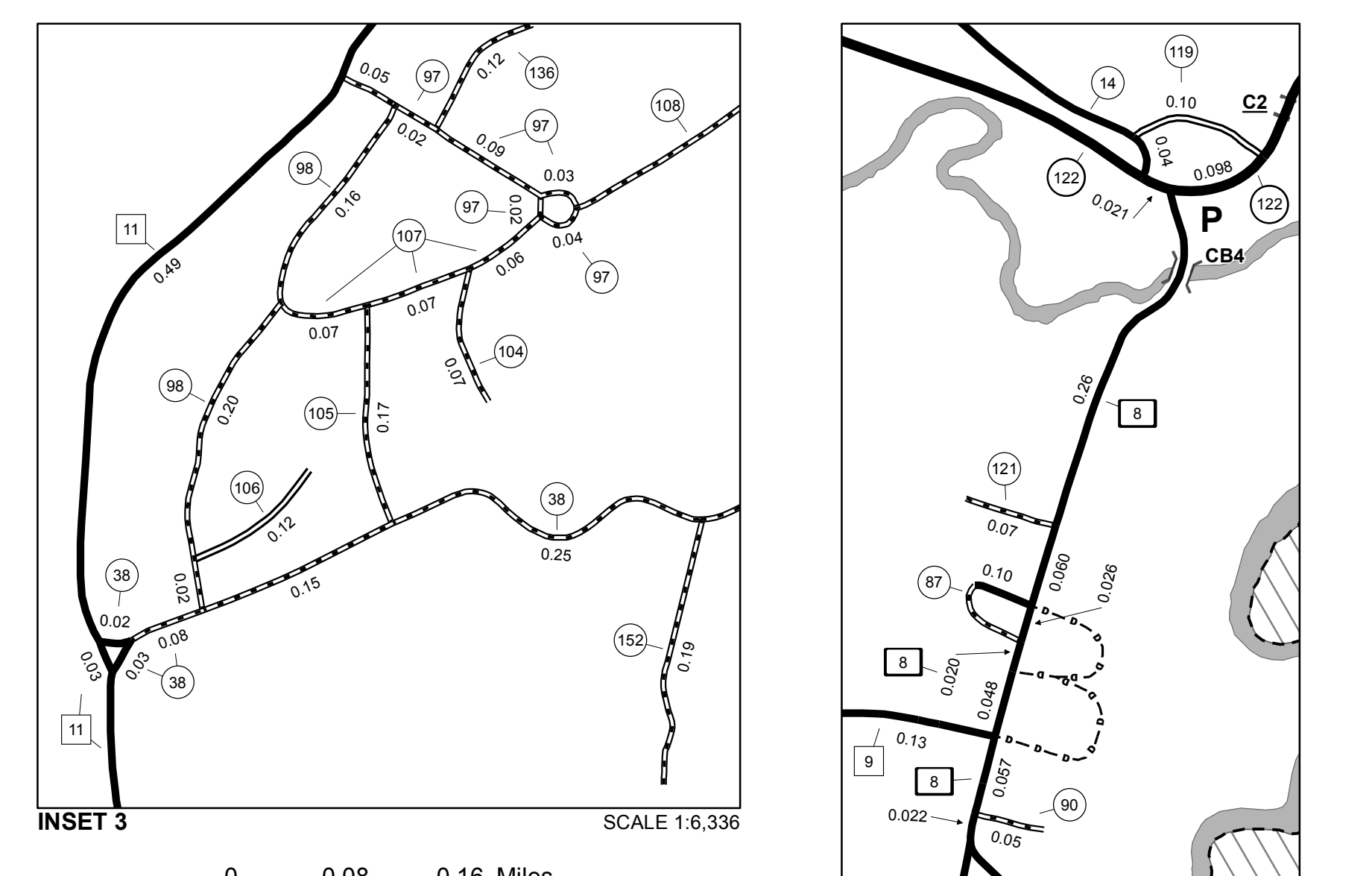
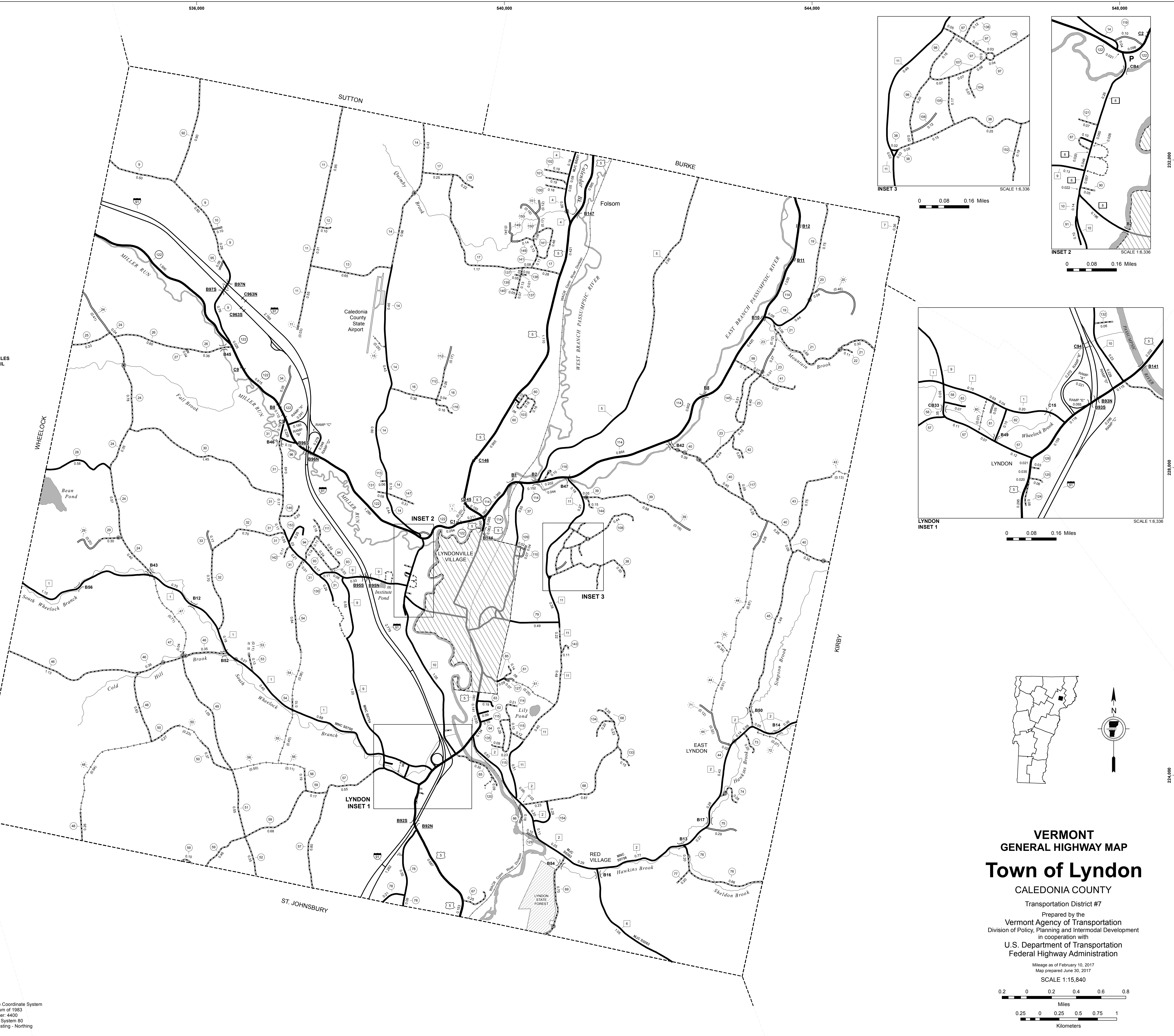

**VERMONT**  
**GENERAL HIGHWAY MAP**  
**Town of Lyndon**  
 CALEDONIA COUNTY  
 Transportation District #7  
 Prepared by the  
 Vermont Agency of Transportation  
 Division of Policy, Planning and Intermodal Development  
 in cooperation with  
 U.S. Department of Transportation  
 Federal Highway Administration  
 Mileage as of February 10, 2017  
 Map prepared June 30, 2017  
 SCALE 1:15,840  
 0.2 0 0.2 0.4 0.6 0.8  
 Miles  
 0 0.25 0.5 0.75 1  
 Kilometers