

TOWN HWY. No.	LENGTH IN MILES CLASS 3	LENGTH IN MILES CLASS 4	TOWN HWY. No.	LENGTH IN MILES CLASS 3	LENGTH IN MILES CLASS 4	TOWN HWY. No.	LENGTH IN MILES CLASS 3	LENGTH IN MILES CLASS 4
7	3.55		35	0.88		66	0.51	
8	1.27		36	0.19		67	1.88	
9	7.05		37	0.13		68	0.38	
10	1.55		38	0.73		71	0.43	
11	0.27		39	0.69		72	0.40	
12	0.54		40	0.75		73	0.10	
13	0.17		41	0.57		74	0.36	
14	0.35		42	1.35		76	0.14	
15	0.50		43	1.61		77	0.25	
16	0.34		44	0.85		78		
17	0.23	(0.22)	45	1.05		81	0.55	(0.26)
18	1.31		46	0.30		82	0.06	
19	0.08		47	0.51		83	0.08	
20	1.60		48	0.13		86	0.14	
21	0.25		49	0.17		87	0.07	
22	0.85		50	0.20		88	0.20	
23	0.04		52	0.28		90	0.15	
24	0.07		53	0.14		91	0.14	
25	0.60		54	2.72		92	0.32	
26	2.08		55	0.13		93	0.20	
27	1.25		56	0.13		94	0.06	
28	0.45		58	0.14		95	0.09	
29	0.71		59	0.13		96	0.48	
30	0.72		60	0.21		97	0.18	
31	0.16		61	0.12		98	0.09	
32	0.13		62	0.07		99	0.24	
33	1.18		63	0.10		100	0.13	
34	0.36		64	0.87		101		(0.95)
<b>TOTAL</b>							<b>50.44</b>	<b>1.43</b>

MILEAGE SUMMARY

CLASS 2		
TH-1	2.010	
TH-2	0.270	
TH-3	2.840	
TH-4	0.470	
TH-5	7.120	
TH-6	2.000	
TH-7	5.280	
<b>TOTAL CLASS 2</b>	<b>19.990</b>	
CLASS 3		
<b>TOTAL CLASS 3</b>	<b>50.44</b>	
<b>TOTAL TOWN</b>	<b>70.430</b>	
STATE HIGHWAY		
VT-7A	6.895	
VT-67	3.590	
<b>TOTAL STATE HIGHWAY</b>	<b>10.485</b>	
US HIGHWAY		
US-7	5.364	
<b>TOTAL US HIGHWAY</b>	<b>5.364</b>	
<b>TOTAL STATE</b>	<b>15.849</b>	

TOTAL, TRAVELED HIGHWAYS, FEB. 10, 2015: 86.279 (Excludes Class 4, Legal Trail, and Unidentified Corridor Mileage)

TOWN HWY. No.	LENGTH IN MILES "NOT UP TO STANDARD"	LEGAL TRAIL No.	LENGTH IN MILES LEGAL TRAIL
77	(0.27)	1	(0.80)
		2	(0.43)
		3	(0.32)
		4	(0.75)
		5	(0.35)
		6	(0.15)
		7	(0.40)
		8	(0.03)
		9	(0.06)
		10	(0.06)
<b>TOTAL</b>	<b>0.27</b>	<b>10</b>	<b>3.35</b>

\* The sections of the town highways listed above are legally Class 3, but have been deemed "Not Up To Standard" and are functionally Class 4 Town Highways

Vermont State Plane Coordinate System North American Datum of 1983 SPCS\_Zone\_Identifier: 4400 Geodetic Reference System 80 4,000-meter grid, Easting - Northing

DISCLAIMER: The untraveled highways (laid-out town highways), discontinued highways, and legal trails hereon are those of which the Agency of Transportation has record; others may exist.

Highway and bridge data by the Agency of Transportation. Town short structures are drawn from the Vermont Online Bridge & Culvert Inventory Tool (VOBCIT) database. All other data from the Vermont Center for Geographic Information. Only named streams are shown.

- HIGHWAYS**
  - INTERSTATE OR DIVIDED HIGHWAY
  - INTERSTATE
  - U.S. ROUTE
  - STATE ROUTE
  - CLASS 1
  - CLASS 2
  - CLASS 3
  - CLASS 4
  - LEGAL TRAIL
- INTERSTATE OR DIVIDED HIGHWAY
- STATE - HARD SURFACE OR PAVED
- TOWN - HARD SURFACE OR PAVED
- GRAVEL
- SOIL OR GRADED AND DRAINED EARTH
- UNIMPROVED OR PRIMITIVE
- IMPASSABLE OR UNTRAVELED
- LEGAL TRAIL
- DISCONTINUED
- HIGHWAY CLASS CHANGE
- RAILROAD
- INACTIVE RAILROAD
- NFR NATIONAL FOREST ROAD
- SFH STATE FOREST HIGHWAY
- P PARK AND RIDE

- PUBLIC LAND - GREEN MOUNTAIN NATIONAL FOREST
- PUBLIC LAND - STATE/MUNICIPAL
- POLITICAL SUBDIVISIONS**
  - STATE BOUNDARY
  - COUNTY BOUNDARY
  - TOWN BOUNDARY
  - VILLAGE BOUNDARY
  - URBAN COMPACT BOUNDARY
- WATER BODY
- STREAM OR BROOK
- BRIDGE OR CULVERT**
  - BRIDGE OR CULVERT > 20'
  - BRIDGE OR CULVERT 6' - 20'
  - VOBCIT BRIDGE
  - VOBCIT CULVERT > 6'
  - B34 / C34 STATE BRIDGE OR CULVERT IDENTIFIER
  - B34 / C34 TOWN BRIDGE OR CULVERT IDENTIFIER
- FEDERAL CLASSIFICATION IDENTIFIER**
  - FAU URBAN ARTERIAL OR COLLECTOR
  - MA MINOR ARTERIAL
  - MJC MAJOR COLLECTOR
  - MNC MINOR COLLECTOR
  - PA PRINCIPAL ARTERIAL

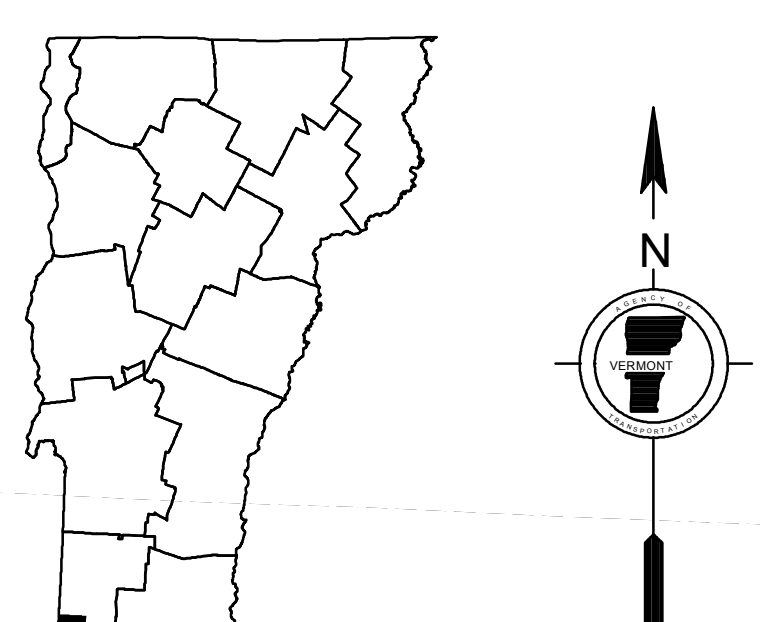
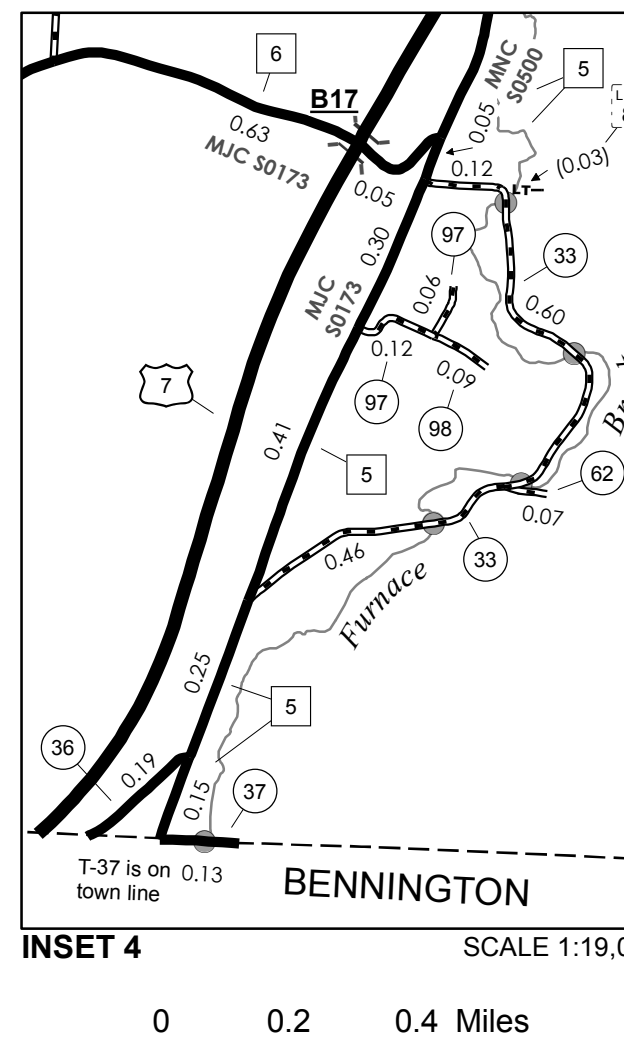
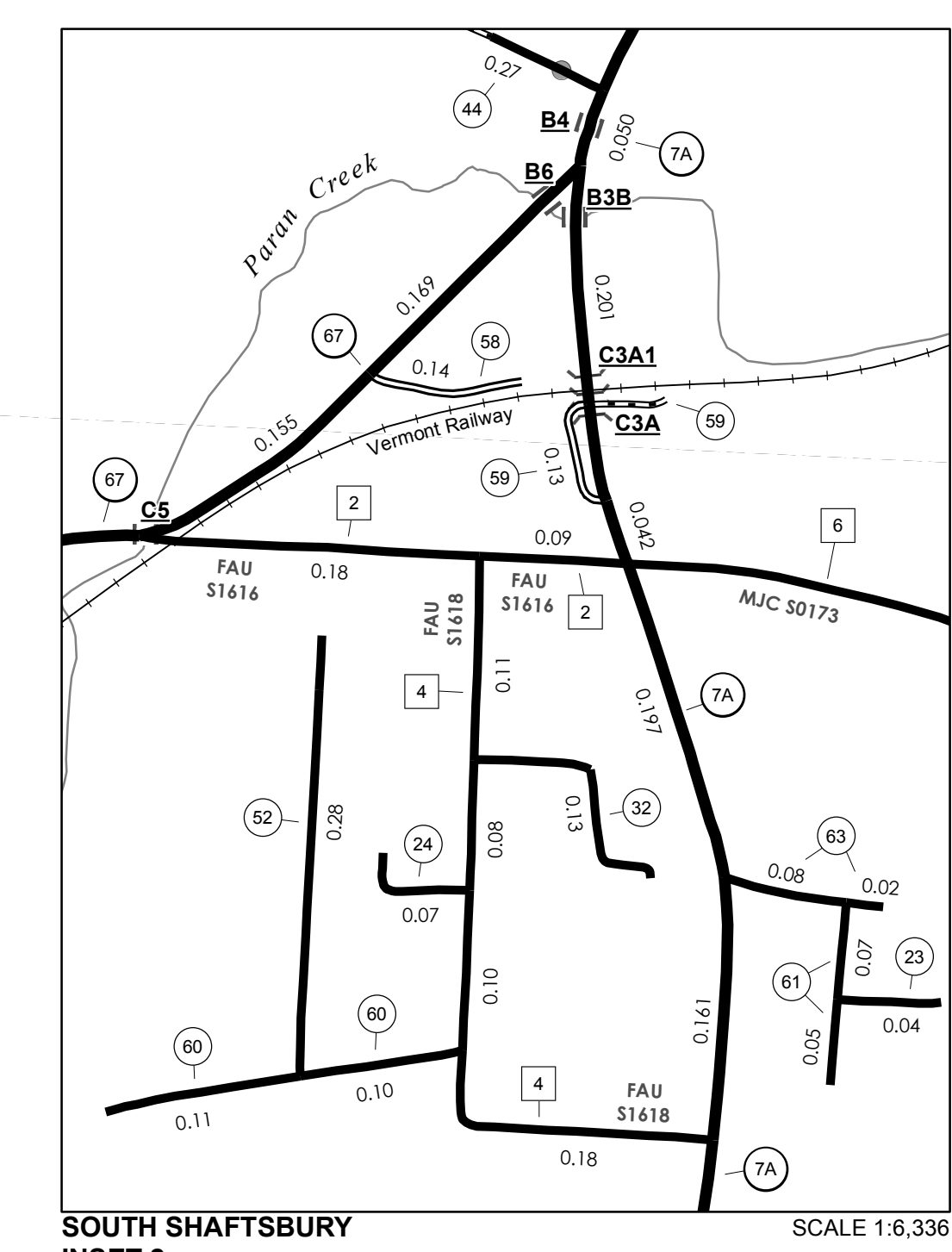
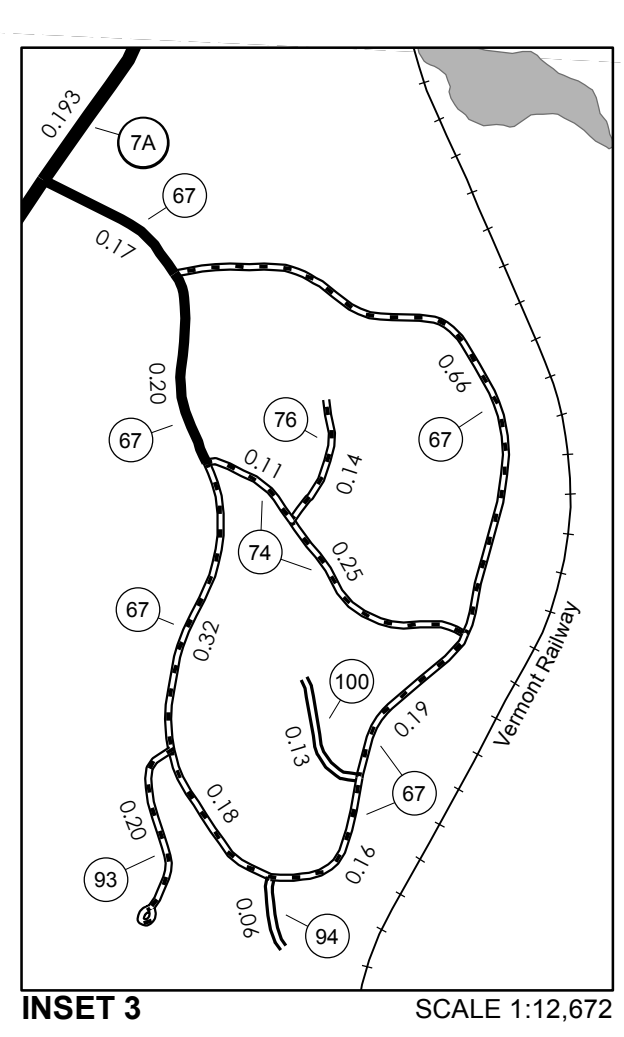
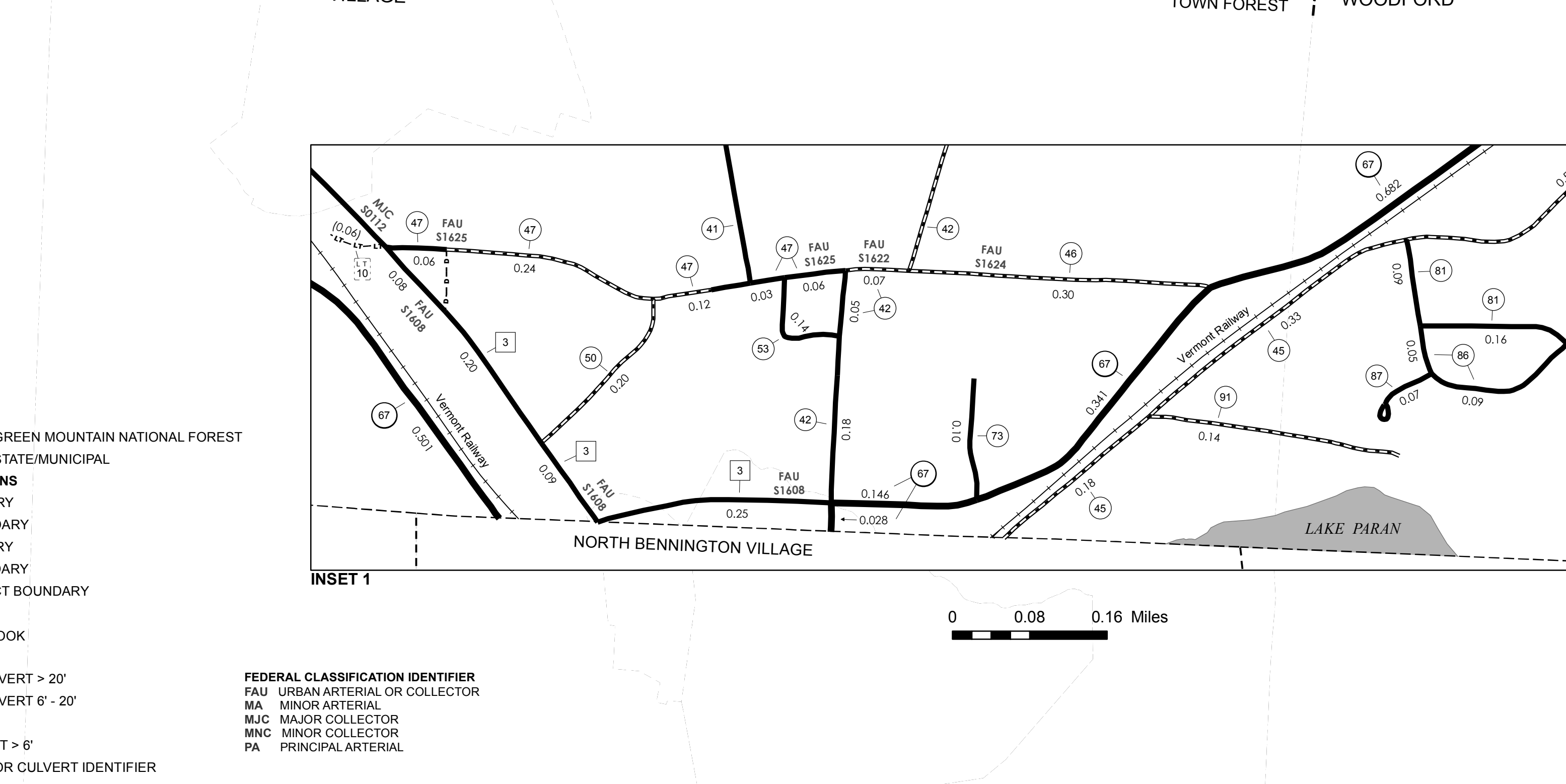
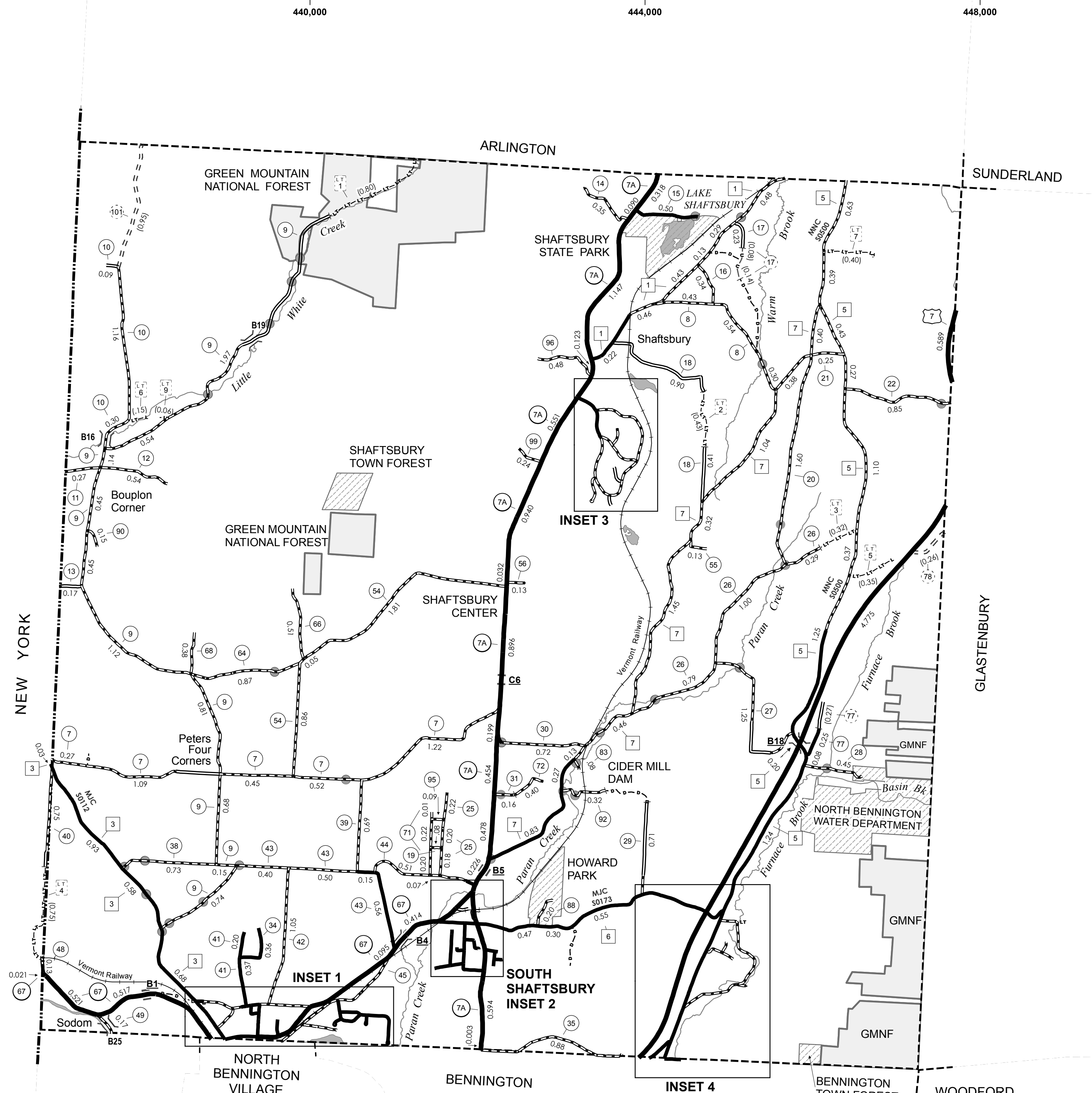

# VERMONT GENERAL HIGHWAY MAP

## Town of Shaftsbury

BENNINGTON COUNTY  
 Transportation District #1  
 Prepared by the  
 Vermont Agency of Transportation  
 Division of Policy, Planning and Intermodal Development  
 in cooperation with  
 U.S. Department of Transportation  
 Federal Highway Administration

Mileage as of February 10, 2015  
 Map prepared June 09, 2015  
 SCALE 1:31,680