

440,000 444,000 448,000 452,000 456,000 460,000 464,000

**MILEAGE SUMMARY**

CLASS	LENGTH IN MILES	TOTAL CLASS
CLASS 1		4.583
TH-1	3.019	
TH-2	0.305	
TH-3	1.259	
TOTAL CLASS 1		4.583
CLASS 2		15.650
TH-3	2.170	
TH-4	1.980	
TH-5	0.400	
TH-6	3.870	
TH-7	1.750	
TH-8	2.100	
TH-9	0.070	
TH-10	1.520	
TH-11	1.790	
TOTAL CLASS 2		15.650

CLASS	LENGTH IN MILES	TOTAL CLASS
CLASS 3		23.550
TOTAL CLASS 3		23.550
TOTAL TOWN		43.783

STATE HIGHWAY	LENGTH IN MILES	TOTAL STATE HIGHWAY
VT-7A	3.047	7.518
VT-11	1.991	
VT-30	2.480	
TOTAL STATE HIGHWAY		7.518
US HIGHWAY	LENGTH IN MILES	TOTAL US HIGHWAY
US-7	7.520	7.520
TOTAL US HIGHWAY - Ramp		
US-7	1.581	
TOTAL US HIGHWAY - Ramp		1.581
TOTAL STATE		16.619

**TOTAL, TRAVELED HIGHWAYS, FEB. 10, 2008: 60.402**

(Includes mileage change due to enactment of Act 117 of 2008, 2.105 miles of VT-7A reclassified to Class 1 TH-1, 0.695 miles of VT-11 reclassified to Class 1 TH-3, effective July 1, 2008)

(Excludes Class 4 and Legal Trail Mileage)

TOWN HWY. NO.	LENGTH IN MILES CLASS 3	LENGTH IN MILES CLASS 4								
8	0.500		24	0.380		42	0.200		61	0.220
9	0.220		25	0.140		43	0.190		62	0.160
10	0.350		26	0.600	(1.870)	44	0.110		63	0.300
11	1.800	(0.060)	28	0.230		45	0.120		64	0.420
12	0.790		29	0.110		46	0.180		65	0.160
13		(2.850)	31	0.540		48	0.610		66	0.100
14	0.340	(0.500)	32	0.340		49	0.290		67	0.280
15	0.320		33	0.150		50	0.060	(0.200)	68	0.250
16		(0.860)	34	0.200		51	0.160		69	0.090
17	0.040		35	0.620		52	0.470		70	0.090
18	0.450		36	0.790		53	0.380		72	0.720
19	0.690		37	0.520	(1.000)	54	0.250		75	0.210
20	1.040		38	0.130	(0.150)	55	1.160		76	0.170
21	1.180		39			56	0.450		77	0.500
22	0.580		40	0.040		57	0.330		78	0.370
23	0.090		41	0.190		58	0.110		79	0.360
						60	0.070		80	0.160
									81	0.210
									82	0.270
<b>TOTAL</b>						<b>TOTAL</b>	<b>23.550</b>	<b>7.490</b>		

\* Portion of this town highway is Class 3, but is functionally Class 4

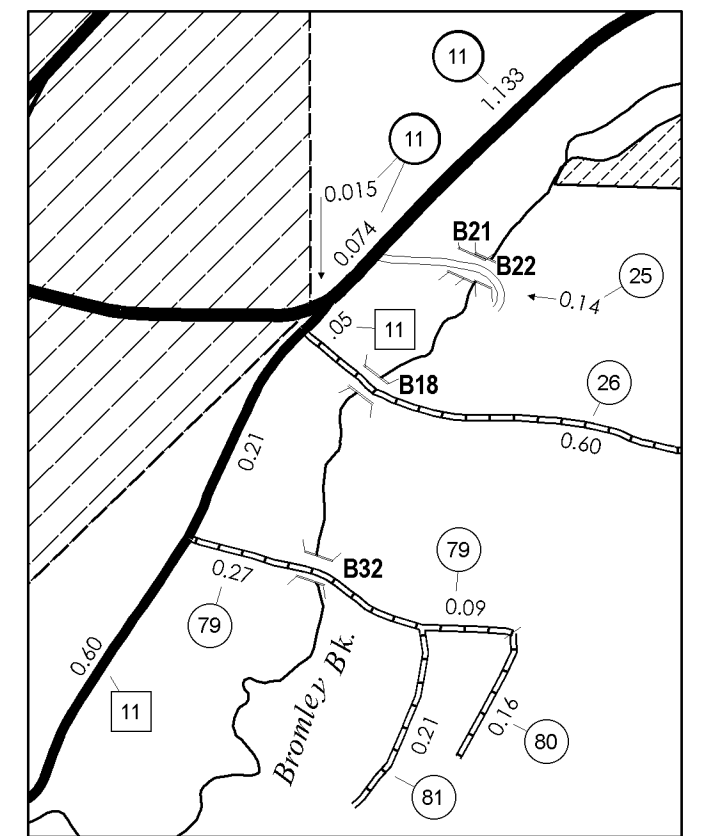
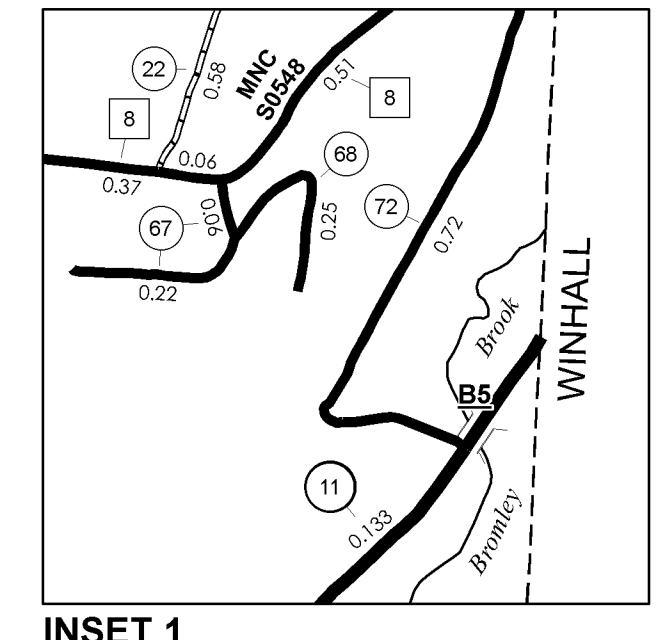
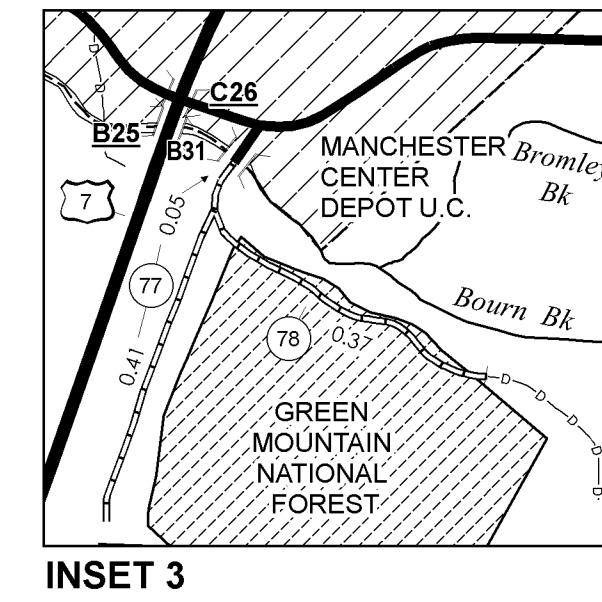

SCALE FOR INSETS 1:12672 (UNLESS OTHERWISE NOTED)  
0 0.2 0.4 Miles

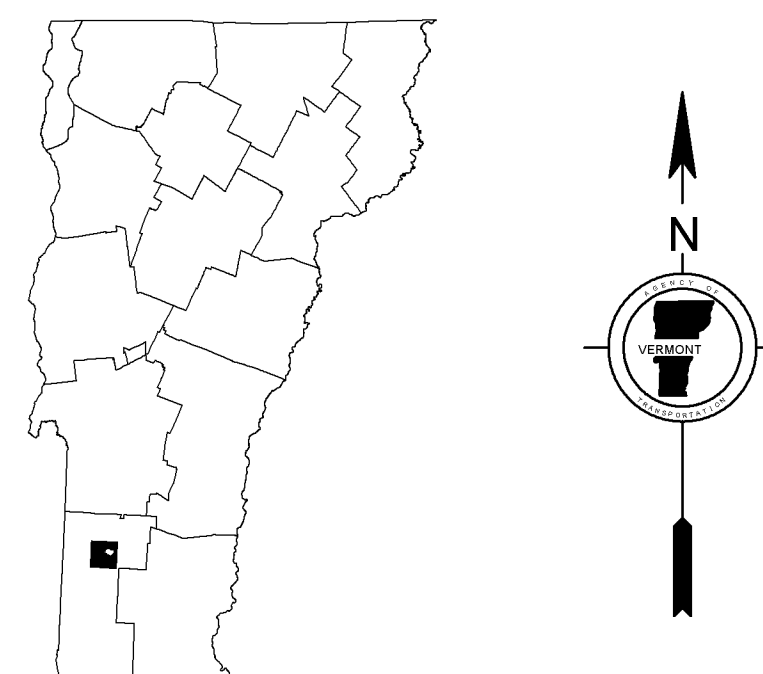

**VERMONT GENERAL HIGHWAY MAP**  
**Town of Manchester**  
BENNINGTON COUNTY

Transportation District #1  
Prepared by the Vermont Agency of Transportation Policy & Planning Division in cooperation with U.S. Department of Transportation Federal Highway Administration

Mileage as of: February 10, 2008  
Map generated: September, 2008

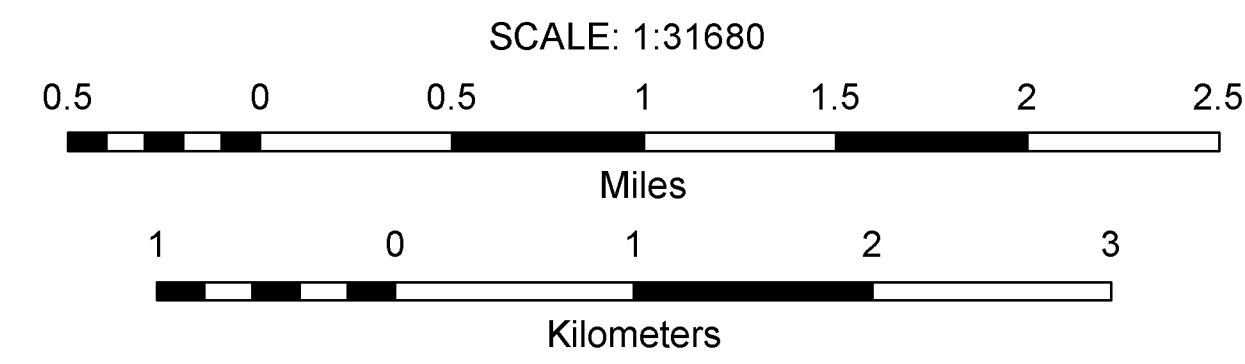

- HIGHWAYS**
  - INTERSTATE
  - U.S. ROUTE
  - STATE ROUTE
  - CLASS 1
  - CLASS 2
  - CLASS 3
  - CLASS 4
  - LEGAL TRAIL
  - INTERSTATE OR DIVIDED HIGHWAY
  - STATE - HARD SURFACE OR PAVED
  - TOWN - HARD SURFACE OR PAVED; 9 GRAVEL
  - SOIL OR GRADED AND DRAINED EARTH
  - UNIMPROVED OR PRIMITIVE
  - IMPASSABLE OR UNTRAVELED
  - LEGAL TRAIL
  - DISCONTINUED
  - HIGHWAY CLASS CHANGE
  - RAILROAD
- POLITICAL SUBDIVISIONS**
  - STATE BOUNDARY
  - COUNTY BOUNDARY
  - TOWN BOUNDARY
  - VILLAGE BOUNDARY
  - URBAN COMPACT BOUNDARY
  - OPEN WATER
  - STREAM OR BROOK
  - BRIDGE OR CULVERT
    - BRIDGE OR CULVERT GREATER THAN 20'
    - BRIDGE OR CULVERT 6' - 20'
  - STATE BRIDGE OR CULVERT IDENTIFIER
  - TOWN BRIDGE OR CULVERT IDENTIFIER
- FEDERAL CLASSIFICATION IDENTIFIER**
  - FAU URBAN ARTERIAL OR COLLECTOR
  - MA MINOR ARTERIAL
  - MJC MAJOR COLLECTOR
  - MNC MINOR COLLECTOR
  - PA PRINCIPAL ARTERIAL

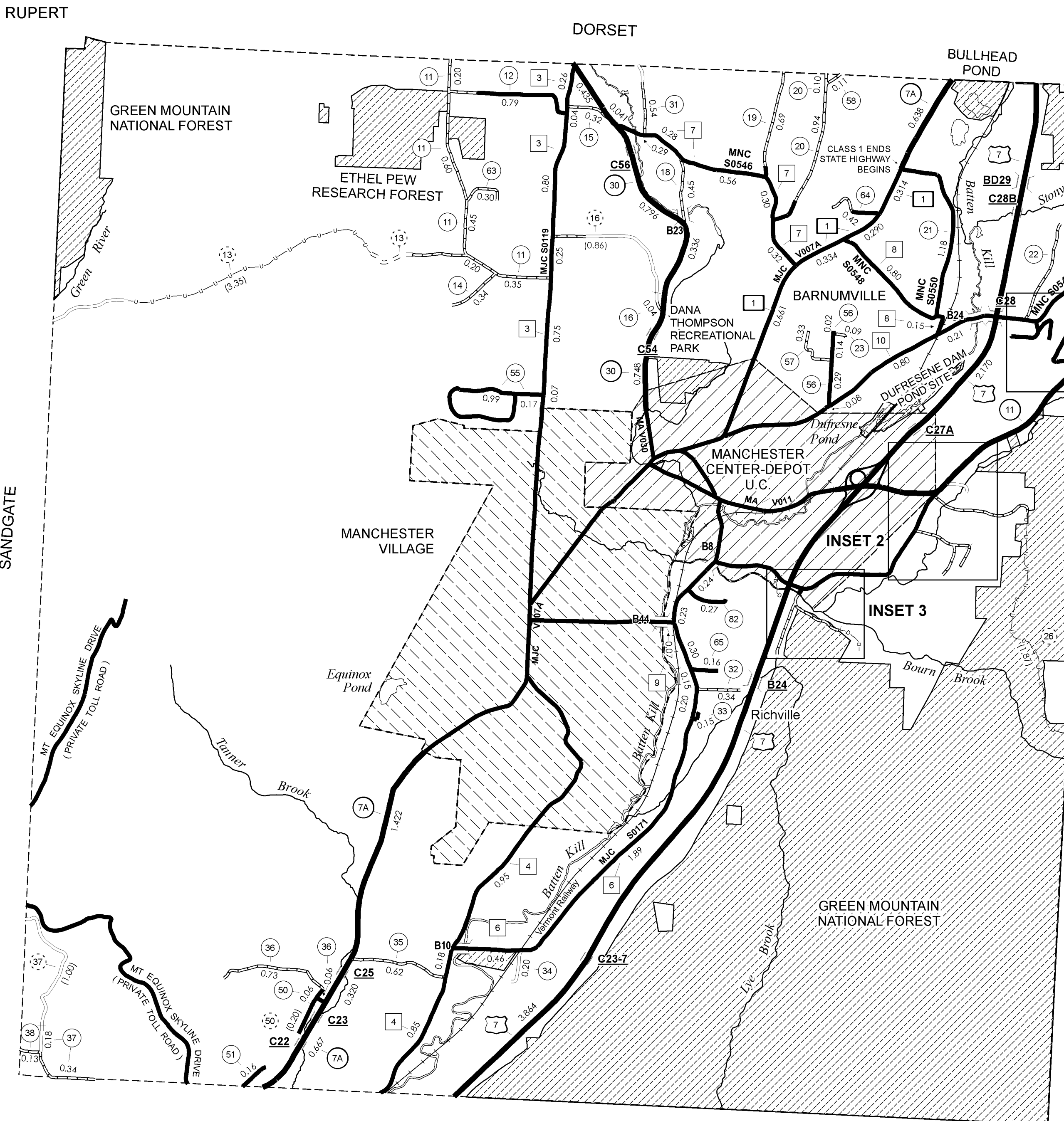

**DISCLAIMER:**  
The untraveled highways (laid-out town highways), discontinued highways, and legal trails shown hereon are those of which the Agency of Transportation has record; others may exist.  
Highway and bridge data by the Agency of Transportation, Policy & Planning Division. All other data from the Vermont Center for Geographic Information.

**STRUCTURES - SURFACE WATER NOTE:**  
Town short structures (bridges or culverts from 6-feet to less than 20-feet) were not represented due to inconsistencies in the data.  
The surface waters are from the Vermont Hydrological Dataset (VHD). Only the named streams are shown.

Vermont State Plane Coordinate System  
North American Datum of 1983  
SPCS\_Zone\_Identifier: 4400  
Geodetic Reference System 80  
4,000-meter grid, Easting - Northing

440,000 444,000 448,000 452,000 456,000 460,000 464,000

