

TOWN HWY. No.	LENGTH IN MILES CLASS 3	CLASS 4	TOWN HWY. No.	LENGTH IN MILES CLASS 3	CLASS 4
6	3.87		71	0.09	
7	1.80		72	0.15	
8	1.56		73	1.54	
9	1.05		74	0.57	
10	0.36		75	0.11	
11	1.44		76	0.11	
13	1.10		77	0.34	
14	0.32	(0.10)	78	0.20	
15	0.36		79	0.04	
16		(0.50)	80	0.09	
17	0.70		81	0.09	
19	3.70		82	0.32	
20	0.92	(0.96)	83	0.16	
21	0.32		84	0.32	
22	0.67		85	0.08	
23	0.80		86	0.11	
24	1.26		87	0.07	
25	0.09		88	0.07	
26	0.35		89	0.16	
27	1.95		90	0.43	
28	0.42		91	0.39	
29	0.25		92	0.26	
30		(0.07)	93	0.10	
31	0.51	(0.04)	94	0.15	
33	0.10		95	0.08	
34	0.33		96	0.12	
35	1.95		97	0.69	
36	0.69		98	0.18	
37		(0.10)	99	0.15	
38	0.26		100	0.25	
39	0.27		101	0.35	
40	0.56		105	0.24	
41	0.15		106	0.06	
42	0.10		107	0.04	
43	0.21		108	0.04	
44	0.10		109	0.34	
45	0.27		110	0.10	
46	0.49		111	0.85	
47	0.17		112	0.20	
48	0.03		113	0.34	
49	0.05		114		(0.93)
50	0.05		115		
51	0.21		116		
52	0.16		117		
53	0.04		118		
54	0.26		119		
55	0.26		120		
56	0.09		121		
57	0.19		122		
58	0.17		123		
59	0.17		124		
61	0.23		125		
62	0.06		126		
63	0.12		127		
64	0.53		128		
65	0.19		129		
66	0.25		130		
68	0.20		131		
69	0.06		132		
70	0.21		133		
			TOTAL	46.62	2.70

LEGAL TRAIL

LEGAL TRAIL No.	LENGTH IN MILES LEGAL TRAIL
1	(0.65)
TOTAL	0.65

TOWN HWY. "NOT UP TO STANDARD"

TOWN HWY. No.	LENGTH IN MILES "NOT UP TO STANDARD"
31	(0.13)
60	(0.03)
TOTAL	0.16

* The sections of the town highways listed above are legally Class 3, but have been deemed "Not Up To Standard" and are functionally Class 4 Town Highways

MILEAGE SUMMARY

CLASS	LENGTH	TOTAL CLASS
CLASS 1		
TH-1	1.538	
TH-2	1.326	
TH-3	0.646	
TH-4	0.065	
TH-5	0.314	
TOTAL CLASS 1		3.889
CLASS 2		
TH-4	0.770	
TH-5	0.960	
TH-6	4.280	
TH-7	3.500	
TH-8	0.100	
TH-9	2.000	
TH-10	2.120	
TH-11	0.700	
TH-12	1.260	
TH-13	0.030	
TOTAL CLASS 2		15.720
CLASS 3		
TOTAL CLASS 3		46.62
TOTAL TOWN		66.229
STATE HIGHWAY		
VT-30	0.550	
VT-116	6.759	
VT-125	3.427	
TOTAL STATE HIGHWAY		10.736
US HIGHWAY		
US-7	6.032	
TOTAL US HIGHWAY		6.032
TOTAL STATE		16.768

TOTAL, TRAVELED HIGHWAYS, FEB. 10, 2014: 82.997
(Excludes Class 4, Legal Trail, and Unidentified Corridor Mileage)

DISCLAIMER:
The untraveled highways (laid-out town highways), discontinued highways, and legal trails hereon are those of which the Agency of Transportation has record; others may exist.

Highway and bridge data by the Agency of Transportation. Town short structures are drawn from the Vermont Online Bridge & Culvert Inventory Tool (VOBCIT) database. All other data from the Vermont Center for Geographic Information. Only named streams are shown.

Vermont State Plane Coordinate System
North American Datum of 1983
SPCS_Zone_Identifier: 4400
Geocentric Reference System 80
4,000-meter grid, Easting - Northing

- HIGHWAYS**
- INTERSTATE
 - U.S. ROUTE
 - STATE ROUTE
 - CLASS 1
 - CLASS 2
 - CLASS 3
 - CLASS 4
 - LEGAL TRAIL
- INTERSTATE OR DIVIDED HIGHWAY**
- STATE - HARD SURFACE OR PAVED
 - TOWN - HARD SURFACE OR PAVED
 - GRAVEL
 - SOIL OR GRADED AND DRAINED EARTH
 - UNIMPROVED OR PRIMITIVE
 - IMPASSABLE OR UNTRAVELED
 - LEGAL TRAIL
 - DISCONTINUED
 - HIGHWAY CLASS CHANGE
 - RAILROAD
 - INACTIVE RAILROAD
 - NFR NATIONAL FOREST ROAD
 - SFH STATE FOREST HIGHWAY
 - P PARK AND RIDE
- PUBLIC LAND - GREEN MOUNTAIN NATIONAL FOREST**
- PUBLIC LAND - STATE/MUNICIPAL
- POLITICAL SUBDIVISIONS**
- STATE BOUNDARY
 - COUNTY BOUNDARY
 - TOWN BOUNDARY
 - VILLAGE BOUNDARY
 - URBAN COMPACT BOUNDARY
 - WATER BODY
 - STREAM OR BROOK
- BRIDGE OR CULVERT**
- BRIDGE OR CULVERT > 20'
 - BRIDGE OR CULVERT 6' - 20'
 - VOBCIT BRIDGE
 - VOBCIT CULVERT > 6'
 - STATE BRIDGE OR CULVERT IDENTIFIER
 - TOWN BRIDGE OR CULVERT IDENTIFIER
- FEDERAL CLASSIFICATION IDENTIFIER**
- FAU URBAN ARTERIAL OR COLLECTOR
 - MA MINOR ARTERIAL
 - MJC MAJOR COLLECTOR
 - MNC MINOR COLLECTOR
 - PA PRINCIPAL ARTERIAL

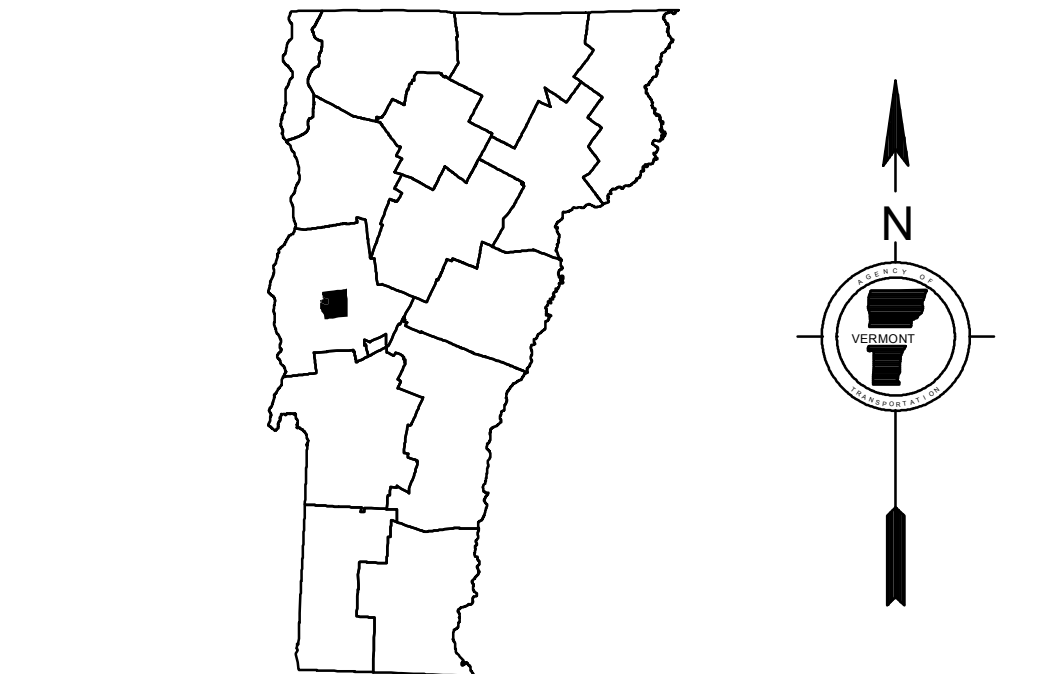
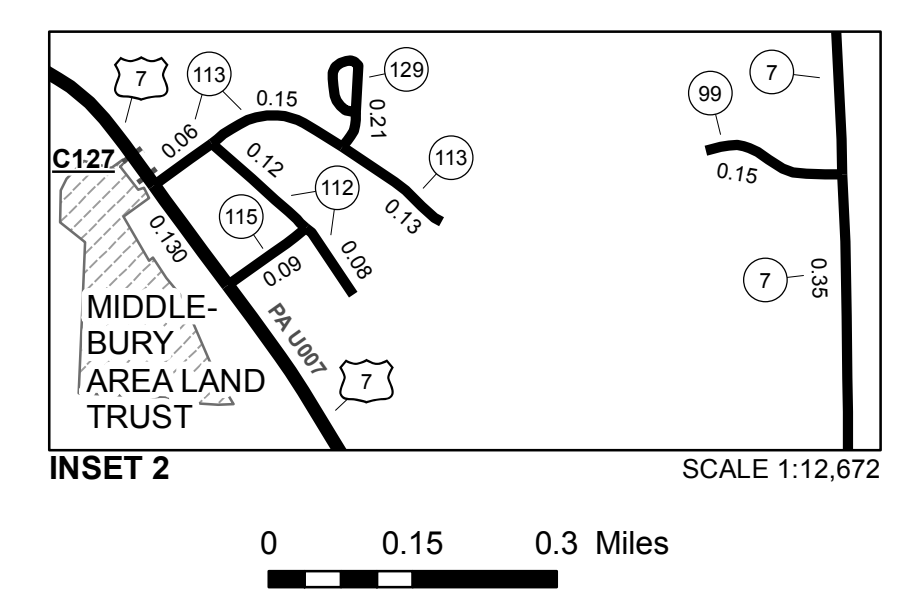
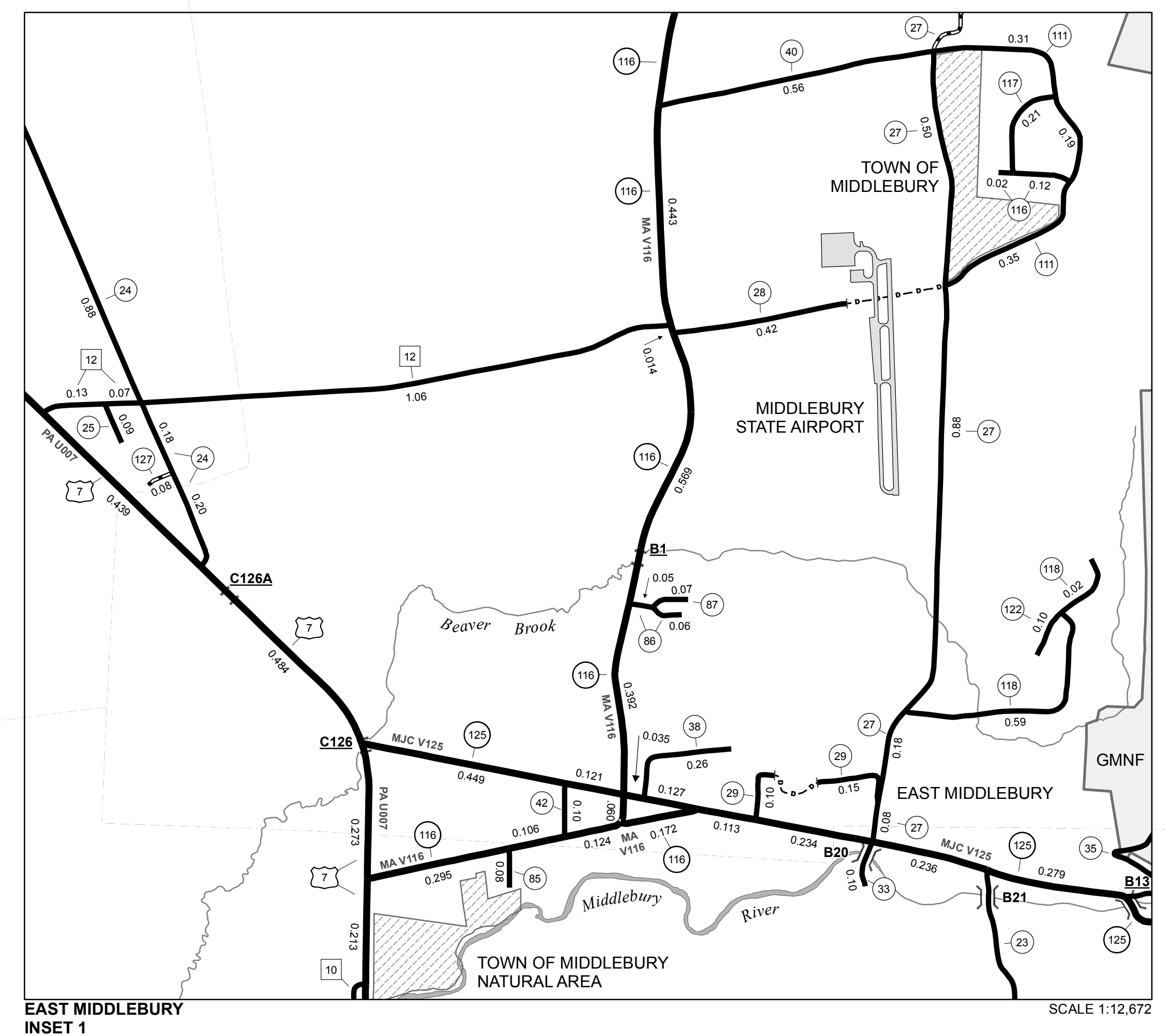
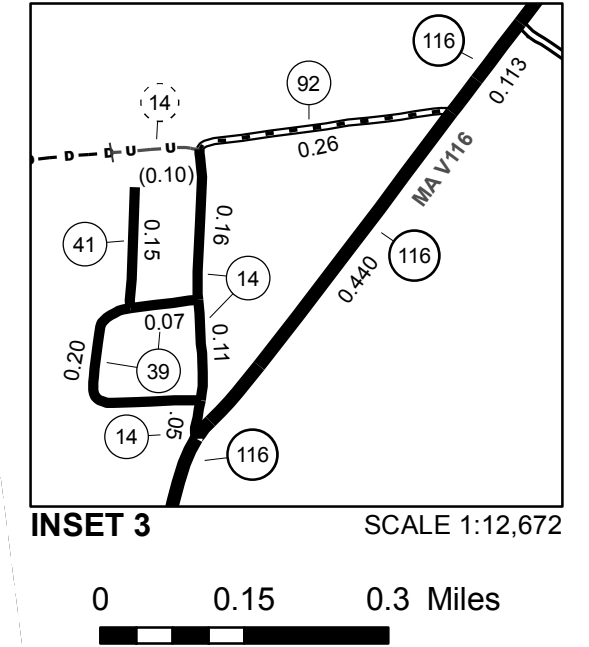

VERMONT
GENERAL HIGHWAY MAP
Town of Middlebury

ADDISON COUNTY

Transportation District #5

Prepared by the
Vermont Agency of Transportation
Division of Policy, Planning and Intermodal Development
in cooperation with
U.S. Department of Transportation
Federal Highway Administration

Mileage as of February 10, 2014
Map prepared October 06, 2014

SCALE 1:31,680

