

CERTIFICATE OF HIGHWAY MILEAGE

YEAR ENDING FEBRUARY 10, 2008

Fill out form, make and file copy with the Town Clerk, and mail ORIGINAL, before February 20, 2008 to: Vermont Agency of Transportation, Policy and Planning Division, One National Life Drive, Montpelier, VT 05633.

We, the Selectmen or Aldermen or Trustees of WOODSTOCK VILLAGE in WINDSOR County

on an oath state that the mileage of highways, according to Title 19, V.S.A, Sec #305, added 1985, is as follows:

PART I - CHANGES TOTALS - Please fill in and calculate totals.

Table with 6 columns: Town Highways, Previous Mileage, Added Mileage, Subtracted Mileage, Total, Scenic Highways. Rows include Class 1, Class 1 Lane, Class 2, Class 3, State Highway, Class 4, Legal Trail, and Total.

\* Mileage for Class 1 Lane, Class 4, and Legal Trail classifications is NOT included in total.

PART II - INFORMATION AND DESCRIPTION OF CHANGES SHOWN ABOVE. Totals by S. Moulton 2/21/08

1. NEW HIGHWAYS: Please attach Selectmen's "Certificate of Completion and Opening"

2. DISCONTINUED: Please attach SIGNED copy of proceedings (minutes of meeting)

3. RECLASSIFIED/REMEASURED: Please attach SIGNED copy of proceedings (minutes of meeting)

Class 2 Transfer - CL3 Pleasant St (0.10 mi) to CL2 TH-5 Pleasant St (0.10 mi)

4. SCENIC HIGHWAYS: Please attach a copy of order designating/discontinuing Scenic Highways.

IF THERE ARE NO CHANGES IN MILEAGE: Check box and sign below. [ ]

PART III - SIGNATURES - PLEASE SIGN.

Selectmen/ Aldermen/ Trustees Signatures:

Handwritten signatures of selectmen/aldermen/trustees.

T/C/V Clerk Signature:

Handwritten signature of Donald Blouin.

Date Filed:

2/15/08

Please sign ORIGINAL and return it for Transportation signature.

AGENCY OF TRANSPORTATION APPROVAL:

Signed copy will be returned to T/C/V Clerk.

APPROVED:

Handwritten signature and text: Representative, Agency of Transportation

DATE:

4/17/2008

POLICY & PLANNING DIVISION

FEB 19 2008

AGENCY OF TRANSPORTATION  
WESTERN

Blue Hill

## Moulton, Sara

---

**From:** McCusker, Angus  
**Sent:** Monday, September 22, 2008 10:07 AM  
**To:** Moulton, Sara  
**Subject:** RE: Woodstock Village

Your interpretation is correct. It's very confusing and it will be changed soon – will send you the shapes when that happens.

Thanks,

Angus McCusker  
GIS Technician  
State of Vermont Enhanced 911 Board  
802.828.0366  
cell 802.318.7848  
[angus.mccusker@state.vt.us](mailto:angus.mccusker@state.vt.us)

---

**From:** Moulton, Sara  
**Sent:** Thursday, September 18, 2008 12:52 PM  
**To:** McCusker, Angus  
**Subject:** RE: Woodstock Village

Attached are two files covering the area I have a question about. The black & white one shows how the streets in the Slayton-Highland area have been drawn in the past. The color one shows my interpretation of what I think is going on. I just need to have you confirm my interpretation, next week when you are in the office.

Sara Moulton  
Mapping & GIS Specialist  
Policy & Planning Division - Mapping Unit  
Vermont Agency of Transportation (VTrans)  
Tel: 802-828-2109

-----Original Message-----

**From:** McCusker, Angus  
**Sent:** Thursday, September 18, 2008 12:02 PM  
**To:** Moulton, Sara  
**Subject:** Re: Woodstock Village

Hi Sara,

We are in the process of readressing woodstock. The town has requested several rd name changes as well. Once I get back to the office next week Ill send you some shapes as well as a copy of the rd name change list signed by the town of Woodstock. There will be a 6 month waiting period before the new rds names and #'s become effective. Add 1-2 months of work that Pete and I have left to do - we're looking at 7-8 months from now. I will keep you posted.

Angus

---

**From:** Moulton, Sara  
**To:** McCusker, Angus  
**Sent:** Thu Sep 18 10:49:20 2008  
**Subject:** Woodstock Village

I am working on this year's map of Woodstock Village and am confused about the alignment and naming of the roads in the Slayton Terr and Highland Av area. You said earlier this year that you were

planning to do field work in Woodstock. Did you, and is there a possibility you could share your road centerlines for that area? I just need those specific roads, plus one possibly named Carbonneau PI in that area.

Thanks.

Sara Moulton  
Mapping & GIS Specialist  
Policy & Planning Division - Mapping Unit  
Vermont Agency of Transportation (VTrans)  
Tel: 802-828-2109

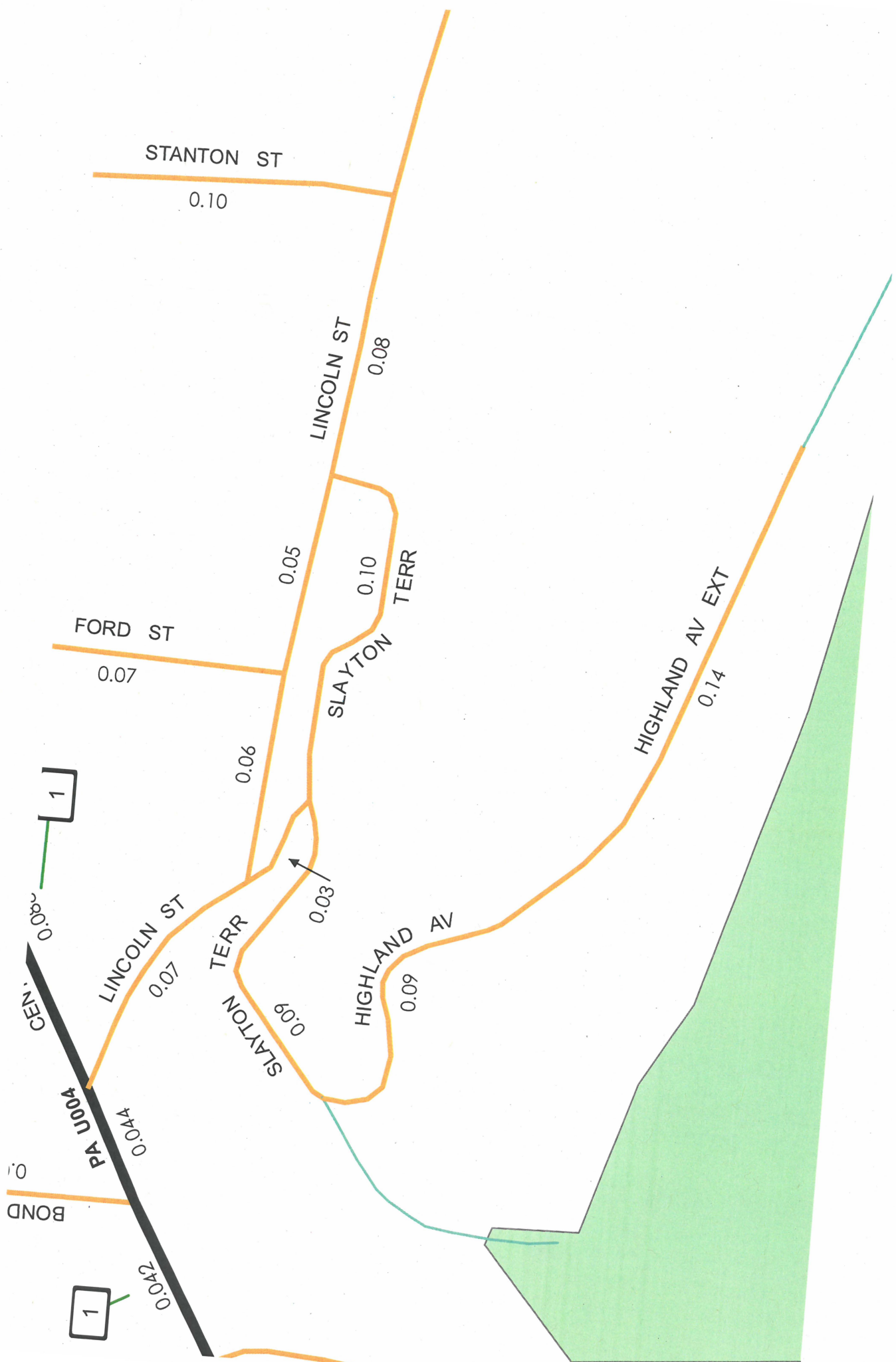

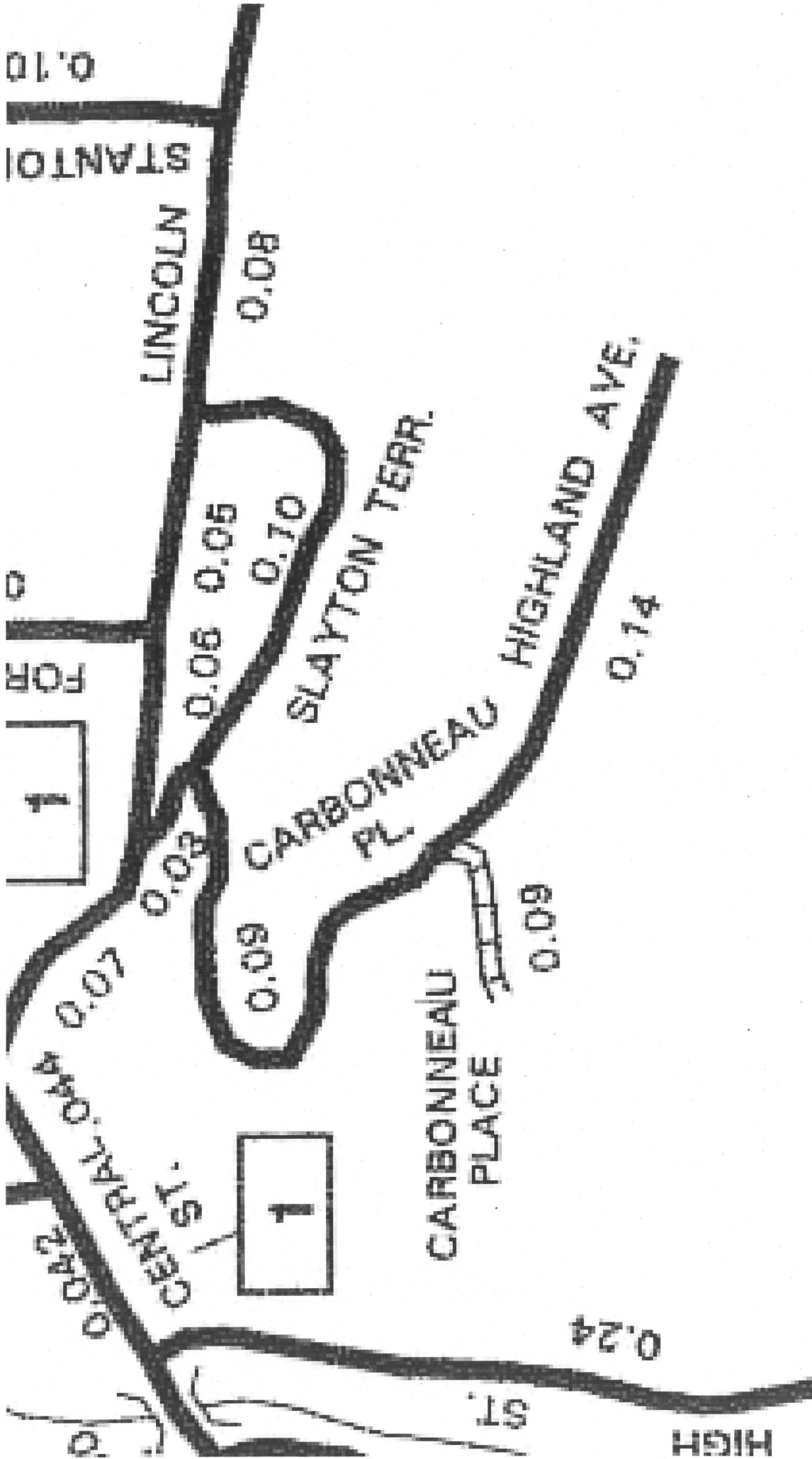

0.10

STANTON

LINCOLN

0.08

FOR

1

0.05 0.05

0.10

SLAYTON TERR.

0.03

CARBONNEAU PL.

0.09

HIGHLAND AVE.

0.14

CENTRAL ST.

0.02

1

CARBONNEAU PLACE

0.09

0.24

ST.

HIGH