

**CERTIFICATE OF HIGHWAY MILEAGE
YEAR ENDING FEBRUARY 10, 2010**

Fill out form, make and file copy with the Town Clerk, and mail ORIGINAL, before February 20, 2010 to:
Vermont Agency of Transportation, Division of Planning, Outreach and Community Affairs, One National Life
Drive, Montpelier, VT 05633.

We, the members of the legislative body of WOODSTOCK in WINDSOR County
on an oath state that the mileage of highways, according to Vermont Statutes Annotated, Title 19, Section 305,
added 1985, is as follows:

PART I - CHANGES TOTALS - Please fill in and calculate totals.

Town Highways	Previous Mileage	Added Mileage	Subtracted Mileage	Total	Scenic Highways
Class 1	0.000				0.000
Class 1 Lane	0.000				
Class 2	9.180	1.20		10.38	0.000
Class 3	60.83	0.15	1.38	59.60	1.490
State Highway	17.925			17.925	0.000
Class 4	14.71	0.48	1.04	14.15	0.000
Legal Trail	0.00	0.39		0.39	
Total	87.935			87.905	1.490

* Mileage for Class 1 Lane, Class 4, and Legal Trail classifications is NOT included in total.

PART II - INFORMATION AND DESCRIPTION OF CHANGES SHOWN ABOVE.

1. NEW HIGHWAYS: Please attach Selectmen's "Certificate of Completion and Opening".

0.15 mi CL3 TH-4 (Randall Rd)

2. DISCONTINUED: Please attach SIGNED copy of proceedings (minutes of meeting).

0.70 mi TH-48 (was CL4) ; 0.29 mi TH-19 (Kaufman Rd, was CL4)
0.05 mi TH-82 (was CL4) ; 0.18 mi TH-88 (Britton Ln, was CL3)

3. RECLASSIFIED/REMEASURED: Please attach SIGNED copy of proceedings (minutes of meeting).

Class 2 Transfer - 1.20 mi CL3 TH-18 to CL2 TH-6
+0.40 mi CL4 (Road ID 2N, Potwin Ln) ; +0.05 mi CL4 (Road ID 3N, Whitcomb Ln)
+0.39 mi LT (Road ID 6N, Pinnacle Spur) ; +0.03 mi CL4 (Road ID 15N, Ottauquechee Ln)

4. SCENIC HIGHWAYS: Please attach a copy of order designating/discontinuing Scenic Highways.

IF THERE ARE NO CHANGES IN MILEAGE: Check box and sign below. []

PART III - SIGNATURES - PLEASE SIGN.

Selectmen/ Aldermen/ Trustees Signatures:

Jack Audin
Margaret Howe

T/C/V Clerk Signature:

[Signature]

Date Filed: Feb 20, 2010

Please sign ORIGINAL and return it for Transportation signature.

AGENCY OF TRANSPORTATION APPROVAL: Signed copy will be returned to T/C/V Clerk.

APPROVED:

[Signature]
Representative, Agency of Transportation

DATE:

5/17/2010

Supplemental information related to this certificate
is stored in a separate storage box labeled

"Certificate of Highway Mileage
Supplemental Documentation"

SELECT BOARD

November 3, 2009

PRESENT: Bruce Gould, Preston Bristow, John Doten, Margaretta Howe, Phil Swanson,
Mary Riley, Gareth Henderson.

I. CALL TO ORDER

Mr. Gould called the meeting to order at 7:30 P.M.

II. CITIZEN COMMENTS

There were no citizens present for comment at this meeting

III. PUBLIC HEARING

Compliance with 1 V.S.A. §316 Access to Public Records and Documents

The Board reviewed the statute for Access to Public Records and a proposal to update the charges of the Town due to changes in medium for producing electronic records.

On a motion of Mr. Bristow, second Ms. Howe the Select Board voted to approve the charges for Access to Public Records. Motion approved.

IV. OLD BUSINESS

A. Schedule for Interviews - Economic Development Commission

After the ad runs a few more weeks the Board will schedule at a couple of meetings to invite interested parties. Mr. Gould suggests some on a night when the Select Board meets and others on a night when the Trustees meet and both Boards can attend the meeting of the other Board.

V. NEW BUSINESS

A. Randall Road Resolution

The Board reviewed a resolution to formally add an extension of Randall Road to the town highway map. The town is recipient of a right of way for road maintenance purposes and the town has maintained the road on this extension for a number of years. This will formally establish this section as a town highway.

Following brief discussion, on a motion of Ms. Howe, second Mr. Bristow the Select Board voted to approve a Resolution to add an extension of Randall Road to the town highway map. Motion approved.

RESOLUTION

ADD an extension of Randall Rd TO TOWN OF WOODSTOCK HIGHWAY MAP

Whereas The Town of Woodstock is the recipient of an easement for use by Town of Woodstock Highway Department road equipment to turn around in this driveway that was granted by Michael L. Ertel and Joanne M. Ertel on January 9, 2001.

Whereas the Town of Woodstock has been maintaining a public highway to the residence of Michael and Joanne Ertel on a continuous basis for a period in excess of fifty years.

Whereas the Select Board did approve a name for this highway of Randall Road, TH 4 on January 3, 2008 when approving a list of town highway names for E-911.

Whereas This road segment has become a public right of way under the doctrine of dedication and acceptance.

Be it Resolved by the Select Board of the Town of Woodstock that the Class III road extending at a right angle from Randall Rd. At its intersection with Brown Hill Road, a distance of 0.145 mi. shall be a class III road and will be a continuation of Randall Road and so named.

This document to be recorded in the land records of the Town of Woodstock.

Date 11-4-09
Klitz & Juanson
Witness

Woodstock Select Board
Bruce Gould
Bruce Gould, Chair

Jack Anderson
Preston Bristow
John D. Doten, Jr.

Margaretta Howe
Margaretta F. Howe

WOODSTOCK, VT TOWN CLERK'S OFFICE
RECEIVED FOR RECORD
November 4 A.D. 20 09
at 4 o'clock 15 minutes P M
and recorded in Book Roads Page 241
Attest: F.C. Regener III
Asst. Town Clerk

TOWN HWY. NO.	LENGTH IN MILES CLASS 3	LENGTH IN MILES CLASS 4	CLASS 3	CLASS 4
4	2.59 (0.36)	61	0.62	
5	1.09 (0.18)	63	0.80	
6		64	0.95	
7	2.51 (0.16)	65	0.80	
8	0.11	66	1.25 (0.78)	
10	0.48	67	0.33 (0.06)	
11	0.61 (0.09)	68	0.12	
12	2.96 (1.55)	69	0.12	
13	0.24	70	0.60 (0.08)	
16	1.56	71		
17	1.90 (0.19)	72	0.16	
18	1.20	74	0.98	
19	0.21 (0.29)	75	1.88	
20	0.91 (1.94)	77	0.61	
21	0.84	78	0.25	
22	0.85	79	0.03	
23	2.92	80	0.17	
24	1.10	82		(0.12)
25		83	0.04	
26	0.10 (1.80)	84	0.23	
28	0.35	85	0.20	
29	0.69 (0.19)	86	0.06	
30	0.98	87	0.38	
31	0.90	88	0.23	
32	0.52	89	0.04	
33	0.27	91	0.25	
34	0.96 (0.74)	92	0.17	
35	2.91	93		(0.16)
36	1.70 (0.48)	94	0.13	
37	0.92 (0.60)	96	0.50	
38	0.13 (0.12)	97	0.27 (0.07)	
39	0.22 (1.33)	98	0.27	
40	0.75	99	0.28	
41	(0.20)	100	0.09	
42	(0.41)	102	0.24	
43	0.05	103	0.12	
44	0.45	104	0.14	
45	1.65	105	0.04	
46		106	0.33 (0.45)	
47	1.22	107	0.03	
48	0.60 (0.70)	108	0.39	
49	1.91	109	0.17	
50	0.16	110	0.19	
51		111	0.34 (0.11)	
52	0.89	112	0.17	
53	1.49	114	0.08	
54	1.87	116		(0.27)
55	0.20	117	0.23	
56	0.78	118	0.27	
57	0.20	119		(0.90)
58	0.15	120		(0.19)
59	1.14	121	0.13	
60		121		(0.28)
TOTAL		60.83	14.71	

MILEAGE SUMMARY

CLASS 2	
TH-1	0.880
TH-2	0.110
TH-3	2.430
TH-4	3.970
TH-5	1.790
TOTAL CLASS 2	9.180
CLASS 3	
TOTAL CLASS 3	60.830
TOTAL TOWN	70.610
STATE HIGHWAY	
VT-12	3.298
VT-106	6.553
TOTAL STATE HIGHWAY	9.851
US HIGHWAY	
US-4	8.074
TOTAL US HIGHWAY	8.074
TOTAL STATE	17.925

TOTAL, TRAVELED HIGHWAYS, FEB. 10, 2008: 87.935
(Excludes Class 4 and Legal Trail Mileage)

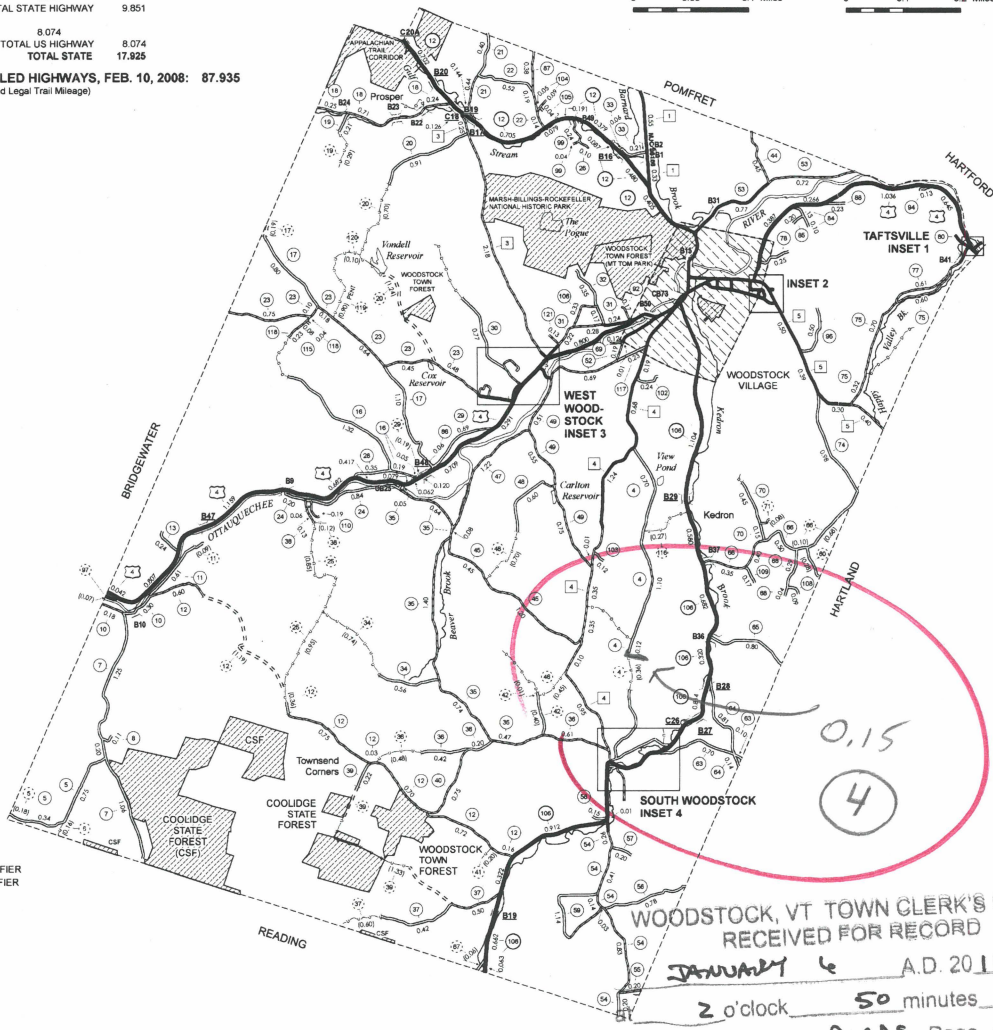
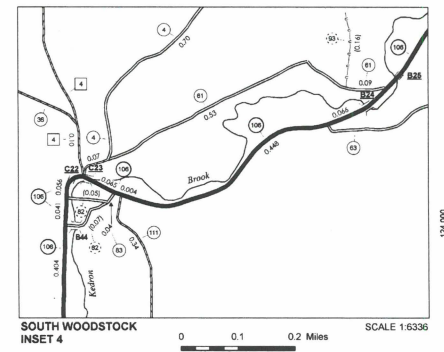
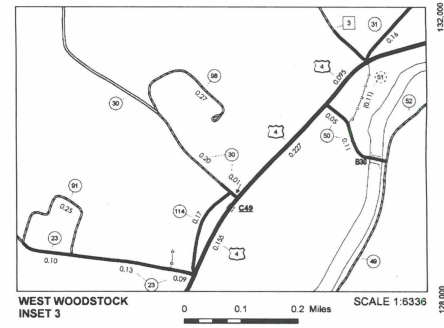
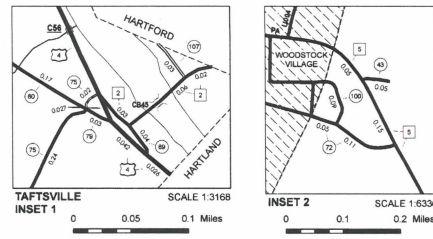

- HIGHWAYS**
- INTERSTATE
 - U.S. ROUTE
 - STATE ROUTE
 - CLASS 1
 - CLASS 2
 - CLASS 3
 - CLASS 4
 - LEGAL TRAIL
 - INTERSTATE OR DIVIDED HIGHWAY
 - STATE - HARD SURFACE OR PAVED
 - TOWN - HARD SURFACE OR PAVED
 - GRAVEL
 - SOIL OR GRADED AND DRAINED EARTH
 - UNIMPROVED OR PRIMITIVE
 - HIGHWAY OR UNTRAVELED
 - LEGAL TRAIL
 - DISCONTINUED
 - HIGHWAY CLASS CHANGE
 - RAILROAD
- PUBLIC LAND**
- POLITICAL SUBDIVISIONS
 - STATE BOUNDARY
 - COUNTY BOUNDARY
 - TOWN BOUNDARY
 - VILLAGE BOUNDARY
 - URBAN COMPACT
 - OPEN WATER
 - STREAM OR BROOK
 - BRIDGE OR CULVERT GREATER THAN 20'
 - BRIDGE OR CULVERT 6' - 20'
 - B34 / C24 STATE BRIDGE OR CULVERT IDENTIFIER
 - B34 / C24 TOWN BRIDGE OR CULVERT IDENTIFIER
- FEDERAL CLASSIFICATION IDENTIFIER**
- FAU URBAN ARTERIAL OR COLLECTOR
 - MA MINOR ARTERIAL
 - MAJ MAJOR COLLECTOR
 - MIC MINOR COLLECTOR
 - PA PRINCIPAL ARTERIAL

DISCLAIMER
The untraveled highways (aid-out town highways), discontinued highways, and legal trails shown here are those of which the Agency of Transportation has record; others may exist.
Highway and bridge data by the Agency of Transportation, Policy & Planning Division. All other data from the Vermont Center for Geographic Information.

STRUCTURES - SURFACE WATER NOTE
Town short structures (bridges or culverts from 6-feet to less than 20-feet) were not represented due to inconsistencies in the data.
The surface waters are from the Vermont Hydrological Dataset (VHD). Only the named streams are shown.

Vermont State Plane Coordinate System
North American Datum of 1983
SPCB_Zone_Identifier: 4400
Geodetic Reference System: 83
4,000-meter grid, Easting - Northing

WOODSTOCK, VT TOWN CLERK'S OFFICE
RECEIVED FOR RECORD
JANUARY 6 A.D. 2010
2 o'clock 50 minutes 8 M
and recorded in Book ROADS Page 244
Attest: *[Signature]* Town Clerk
'RANDALL ROAD'

VERMONT
GENERAL HIGHWAY MAP
Town of Woodstock
WINDSOR COUNTY
Transportation District #4

Prepared by the
Vermont Agency of Transportation
Policy & Planning Division
in cooperation with
U.S. Department of Transportation
Federal Highway Administration

Mileage as of February 10, 2008
Map generated October, 2008

SCALE: 1:31680

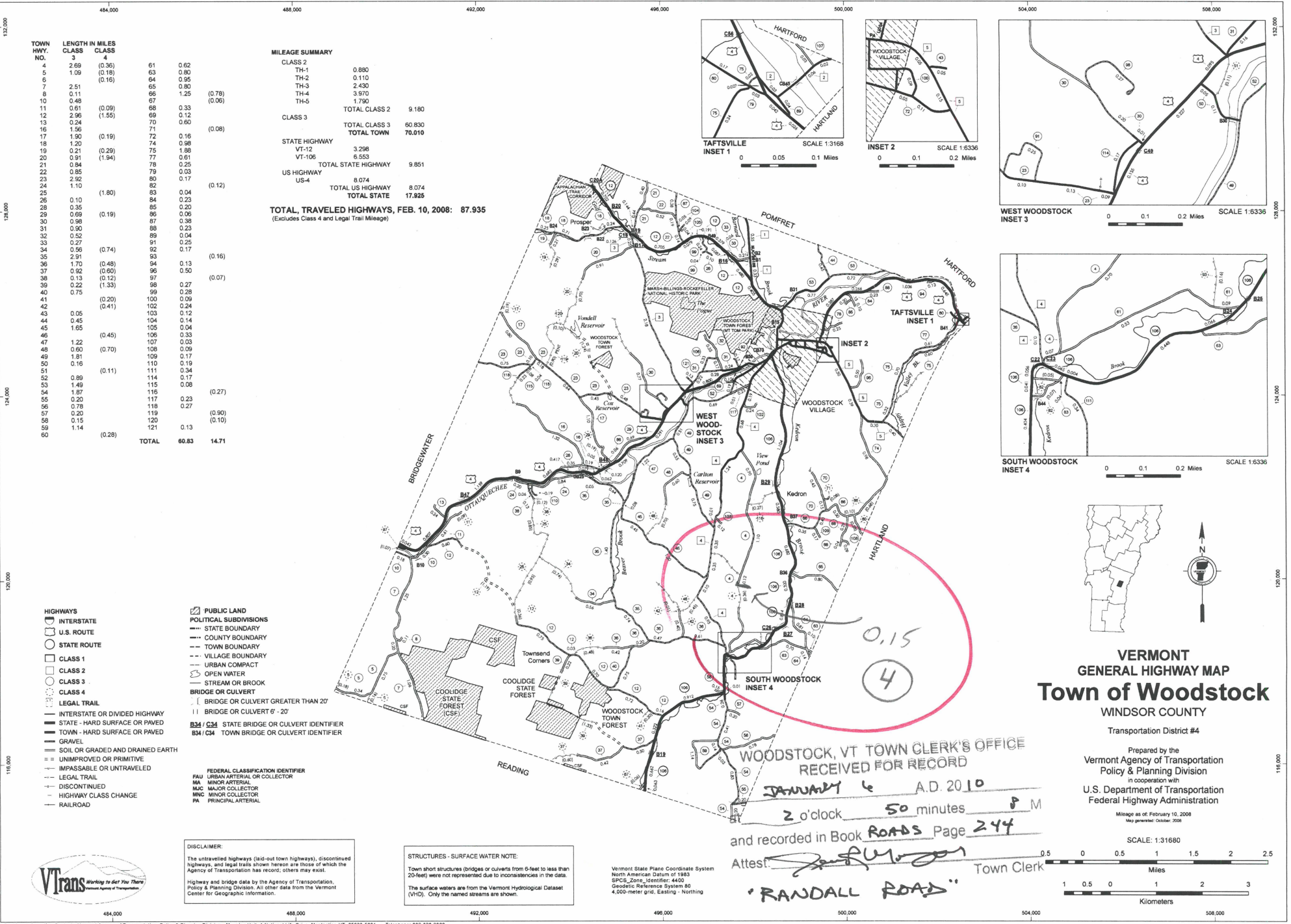
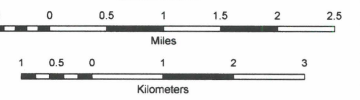

CERTIFICATE of COMPLETION and OPENING
of a HIGHWAY for PUBLIC TRAVEL

Jerome R. Morgan _____, Town _____ Clerk of the Town _____ of
(Clerk's Name) (City/Town/Village) (City/Town/Village)
Woodstock _____, Vermont.
(City/Town/Village Name)

Pursuant to Title 19, V.S.A., Chapter 7, this is to certify that the following described section of
Class 3 Highway in the Town _____ of Woodstock _____ was COMPLETED AND
(1,2,3 or 4) (City/Town/Village) (City/Town/Village)
OPENED FOR PUBLIC TRAVEL on January 19 _____, 2010 .
(Month - Day) (Year)

DESCRIPTION OF RIGHT OF WAY: Beginning 1.2 mile southerly of the intersection
of TH 116 Hedgehog Brook Road, turning at an approximate right angle in
an easterly direction and traveling a distance of 0.15 mile.

and as shown on a Highway Map of the Town _____ of Woodstock _____, dated
(City/Town/Village) (City/Town/Village)
January 6 _____, 2010 _____, and filed in Book Roads on page 244 of the Records of the
(Month - Day) (Year) (Book #) (Page #)
Town _____ of Woodstock _____ by the Town _____ Clerk of said Town _____
(City/Town/Village) (City/Town/Village Name) (City/Town/Village) (City/Town/Village)
incorporated herein by reference and attested to on said map by said the Town _____ Clerk.
(City/Town/Village)

Dated at Woodstock _____, County of Windsor _____ and State of Vermont,
(City/Town/Village Name) (County Name)
this 19th day of January _____, A.D., 2010 .
(Date - Day) (Date - Month) (Date - Year)

BOARD
OF
SELECTMEN,
ALDERMAN,
or TRUSTEES

Jack Anderson _____
(Selectman/Alderman/Trustee Signature)

(Selectman/Alderman/Trustee Signature)

(Selectman/Alderman/Trustee Signature)

[Signature] _____
(Selectman/Alderman/Trustee Signature)
[Signature] _____
(Selectman/Alderman/Trustee Signature)
[Signature] _____
(Selectman/Alderman/Trustee Signature)

(Manager/Mayor Signature)
and the Manager/Mayor of the City/Town/Village of Woodstock _____.
(City/Town/Village Name)

Woodstock _____, VERMONT _____, January 19 _____, 2010 _____
(City/Town/Village Name) (Month - Day) (Year)

THE ABOVE IS A TRUE COPY OF THE DESCRIPTION OF CLASS 3 HIGHWAY COMPLETED AND
(1,2,3 or 4)
OPENED FOR PUBLIC TRAVEL, RECORDED IN BOOK Roads ON PAGE 244 OF THE WOODSTOCK RECORDS
(Book #) (Page #)
OF THE Town _____ OF WOODSTOCK _____ ON THE 6 DAY OF JANUARY _____,
(City/Town/Village) (City/Town/Village Name) (Date - Day) (Date - Month)
2010 _____, AT 2:50 _____ O'CLOCK, P. M.
(Date - Year) (Time) (A or P)

ATTEST: [Signature] _____
(Clerk's Name)

Town _____ CLERK OF WOODSTOCK _____, VERMONT
(City/Town/Village) (City/Town/Village Name)