

CERTIFICATE OF HIGHWAY MILEAGE

YEAR ENDING FEBRUARY 10, 2008

Fill out form, make and file copy with the Town Clerk, and mail ORIGINAL, before February 20, 2008 to: Vermont Agency of Transportation, Policy and Planning Division, One National Life Drive, Montpelier, VT 05633.

We, the Selectmen or Aldermen or Trustees of HARTLAND in WINDSOR County

on an oath state that the mileage of highways, according to Title 19, V.S.A, Sec #305, added 1985, is as follows:

PART I - CHANGES TOTALS - Please fill in and calculate totals.

Table with 6 columns: Town Highways, Previous Mileage, Added Mileage, Subtracted Mileage, Total, Scenic Highways. Rows include Class 1, Class 1 Lane, Class 2, Class 3, State Highway, Class 4, Legal Trail, and Total.

\* Mileage for Class 1 Lane, Class 4, and Legal Trail classifications is NOT included in total.

PART II - INFORMATION AND DESCRIPTION OF CHANGES SHOWN ABOVE.

- 1. NEW HIGHWAYS: Please attach Selectmen's "Certificate of Completion and Opening"
2. DISCONTINUED: Please attach SIGNED copy of proceedings (minutes of meeting)
3. RECLASSIFIED/REMEASURED: Please attach SIGNED copy of proceedings (minutes of meeting)
4. SCENIC HIGHWAYS: Please attach a copy of order designating/discontinuing Scenic Highways

IF THERE ARE NO CHANGES IN MILEAGE: Check box and sign below. [ ]

PART III - SIGNATURES - PLEASE SIGN.

Selectmen/ Aldermen/ Trustees Signatures: [Signatures of Sherman White, Gordon Richardson, Martha McKeinn, Richard Wadsworth, May T. O'Brien]

T/C/V Clerk Signature: Clyde A. Jenne Date Filed: February 11, 2008

Please sign ORIGINAL and return it for Transportation signature.

AGENCY OF TRANSPORTATION APPROVAL: Signed copy will be returned to T/C/V Clerk.

APPROVED: [Signature] Representative, Agency of Transportation DATE: 4/17/2008

Agency

**FEB 13 2008**

Policy & Planning Division

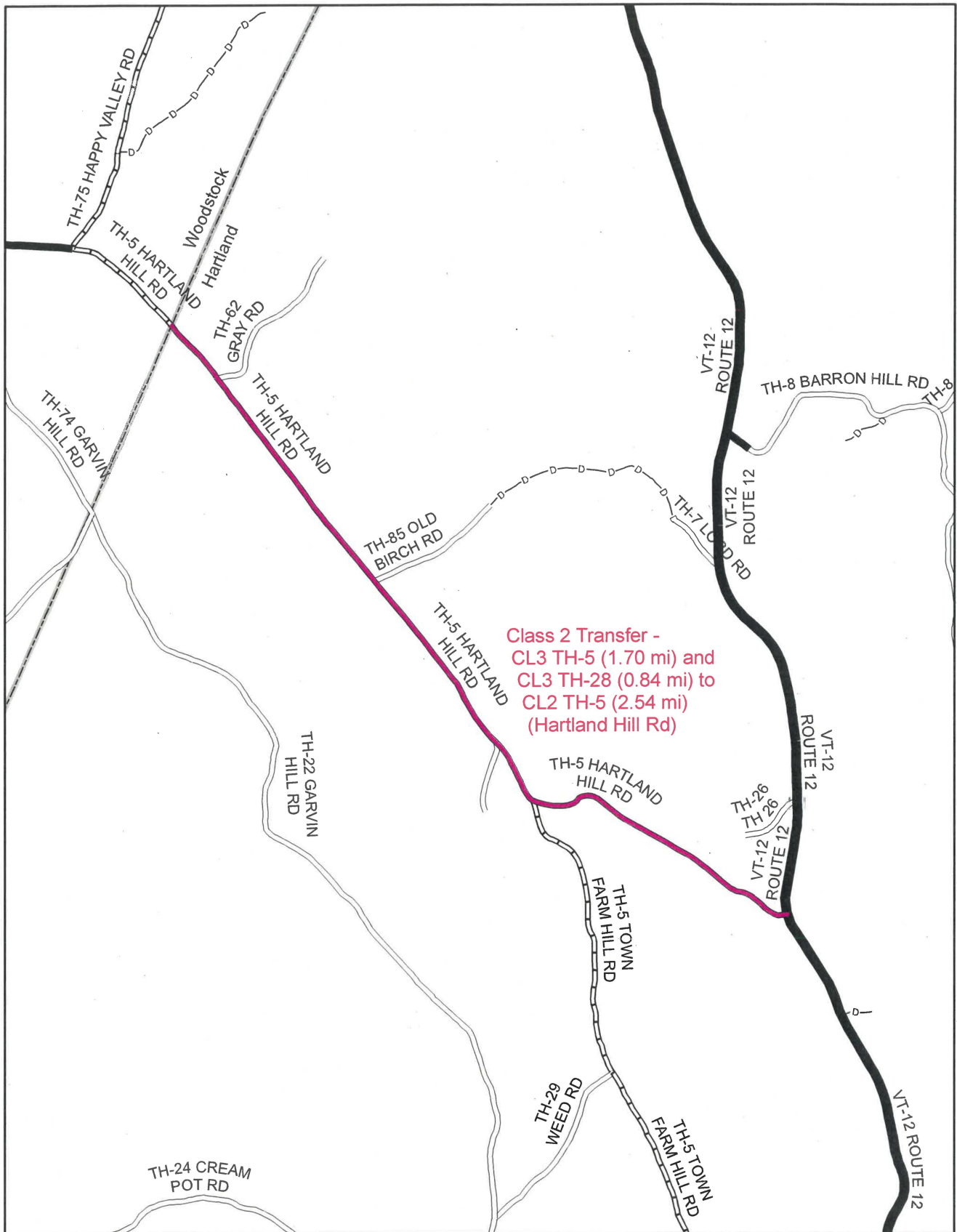

Class 2 Transfer -  
 CL3 TH-5 (1.70 mi) and  
 CL3 TH-28 (0.84 mi) to  
 CL2 TH-5 (2.54 mi)  
 (Hartland Hill Rd)

**Mileage Certificate Change 2008 -- HARTLAND**

Mapping Unit  
 Policy & Planning Division  
 Vermont Agency of Transportation -- February 2008





State of Vermont  
Policy & Planning Division-Mapping Unit  
1 National Life Drive  
Montpelier, VT 05633-5001  
<http://www.aot.state.vt.us>

*Agency of Transportation*

Telephone: 802-828-2109  
Fax: 802-828-2334  
Email: [sara.moulton@state.vt.us](mailto:sara.moulton@state.vt.us)

January 29, 2008

Mr. Robert Stacey  
Town Manager, Hartland  
PO Box 349  
Hartland, VT 05048

Dear Mr. Stacey:

In response to your telephone call on January 23, I reviewed Hartland's Class 2 Transfer request with our Highway Research Unit. They are the ones who process the Class 2 transfers.

To recap, you stated that Hartland wanted only the road known as Hartland Hill Rd reclassified as Class 2. This included the northern portion of TH-5 (1.70 miles) and all of TH-28 (0.84 miles) for a total of 2.54 miles. The transfer, as it was originally processed, included all of TH-5 (including Hartland Hill Rd and Town Farm Hill Rd) for a total of 5.62 miles.

Highway Research has corrected the error and reprocessed the change.

Enclosed is a revised 2008 Certificate of Highway Mileage reflecting the above change.

If you have any questions, please call me at 802-828-2109 or send e-mail to [sara.moulton@state.vt.us](mailto:sara.moulton@state.vt.us)

Thank you.

Sincerely,

*Sara Moulton*

Sara Moulton  
Mapping & GIS Specialist



PROGRAM DEVELOPMENT DIVISION

TO: Distribution List

FROM: Mary C. Spicer, Highway Research Supervisor *MS*

DATE: January 2, 2008

SUBJECT: Class 3 to class 2 Town Highway Transfer Requests (REVISED MILEAGE)

The following Town highways that were submitted to this Agency for review and analysis for transfer from Class 3 to Class 2 town highway designation have been approved by the Secretary of Transportation. The results are listed below.

DTAs should contact the towns they represent and let them know the outcome. Please see attached copies of letters.

<u>Town</u>	<u>Town Highway#</u>	<u>Mileage</u>	<u>Qualify for Transfer</u>
Bridgewater	3	5.69	No
Woodstock	18	1.20	No
Woodstock	73	1.79	Yes
Woodstock Village	Pleasant ST	0.10	Yes
Hartland	5	1.70	Yes
Hartland	28	0.84	Yes

cc: DTA 4, Tammy Ellis  
 Regional Planning Coordinator, Susan Clark  
 Jonathan Croft, Mapping  
 PDD Business Manager  
 Highway research Files

POLICY AND PLANNING

**TO:** Neale Lunderville, Secretary of Transportation

**From:** Mel Adams, Director of Policy and Planning Division *MS*  
 By: Mary Spicer, Highway Research Supervisor *MS*

**Date:** **January 23, 2007**

**Subject:** Class 2 Town Highway Transfer  
 Town: HARTLAND  
 Description: TH 5 & TH 28, HARTLAND HILL ROAD(REVISED MILEAGE).

We have reviewed the subject Class 2 Town Highway transfer request (attached) in accordance with AOT guidelines with the following results:

<u>Policy Guidelines</u>	<u>This Road</u>
Classification Rating: 70 Points	62 Points
Paved Typical: 22 Ft. (shld. to shld.)	
Gravel Typical: 20 Ft. (shld. to shld.)	20 ft.
Class 2 Mileage Percent: 25% Hartland	Without Transfer: 18.1%
	With Transfer: 21.4%

This road does not meet the Classification Rating Guidelines by eight points. They do have a community need for Class 2 highways, and the approval of this road would also benefit Woodstock who does have a great community need. We do recommend transfer to the Class 2 Town Highway system.

APPROVED: *David C. Quie*  
*fa* Neale Lunderville  
 Secretary of Transportation

Date: 1/24/08

Attach.  
 CC: DTA 4, Tammy Ellis  
 Regional Planning Coordinator, Susan Clark  
 Johnathan Croft, Mapping  
 PDD Business Manager  
 Highway Research Files

492,000 496,000 500,000 504,000 508,000 512,000 516,000

TOWN HWY. NO.	LENGTH IN MILES	CLASS 3	CLASS 4
4	4.210	(0.570)	48 1.140
5	5.620		50 0.320
6	3.080		51 0.150
7	0.190		52 0.660
8	2.550	(0.160)	53 1.580
9	0.220		54 0.210
10	0.690		55 0.160
11		(0.080)	56 2.010
12	1.540		57 0.790
15	1.070		58 0.400
16	0.490		59 0.300
18	4.540		60 0.200
19	1.610	(0.100)	61 0.210
20	0.100		62 0.470
22	5.330		63
23	3.400		64 2.230
24	1.700		65 0.080
26	0.200		66 0.050
27	0.230		67 0.090
28	0.840		68 0.250
29	0.570		69 0.070
30	1.100		70 0.100
31	0.300		72 0.060
32	0.170		73 0.270
33	1.730	(0.390)	74 0.140
34	1.040		76
35	0.100		77 0.120
37	0.260		78 1.470
38	0.470		79 0.040
39	0.200		80 0.130
40	0.180		81
41	0.750	(0.130)	82 0.090
42	0.250		83 0.140
43	0.280		84 0.100
44		(0.200)	85 0.410
45	0.580	(0.500)	86 0.180
46	1.230		89 0.530
47	0.200		
<b>TOTAL</b>		<b>62.180</b>	<b>2.960</b>

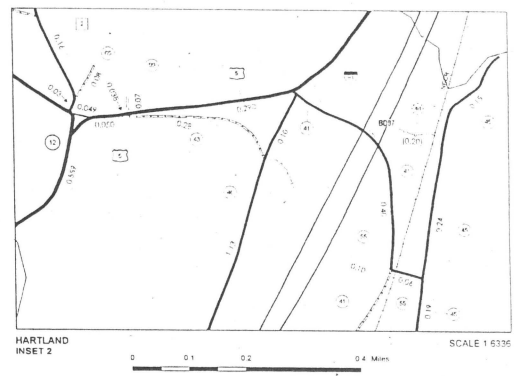
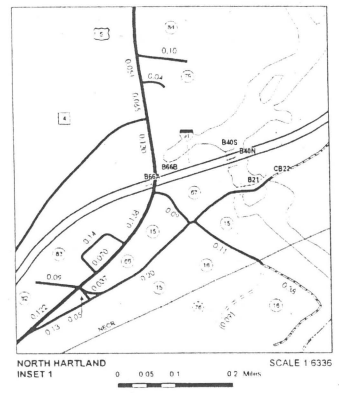

**MILEAGE SUMMARY**

CLASS 2	
TH-1	2.520
TH-2	6.050
TH-3	1.120
TH-4	4.030
<b>TOTAL CLASS 2</b>	<b>13.720</b>
CLASS 3	
<b>TOTAL CLASS 3</b>	<b>62.180</b>
<b>TOTAL TOWN</b>	<b>75.900</b>
STATE HIGHWAY	
VT-12	7.963
<b>TOTAL STATE HIGHWAY</b>	<b>7.963</b>
STATE HIGHWAY - Ramp	
VI-12	0.042
<b>TOTAL STATE HIGHWAY - Ramp</b>	<b>0.042</b>
US HIGHWAY	
US-4	0.773
US-5	7.672
<b>TOTAL US HIGHWAY</b>	<b>8.445</b>
<b>TOTAL STATE</b>	<b>16.150</b>
INTERSTATE	
I-91	7.629
<b>TOTAL INTERSTATE</b>	<b>7.629</b>
INTERSTATE - Ramp	
I-91	0.901
<b>TOTAL INTERSTATE - Ramp</b>	<b>0.901</b>
<b>TOTAL INTERSTATE</b>	<b>8.530</b>

**TOTAL TRAVELED HIGHWAYS, FEB. 10, 2006: 100.580**  
(Excludes Class 4 Mileage)

TH#6 - 1.7 MILES  
TH#28 - 0.84 MILES

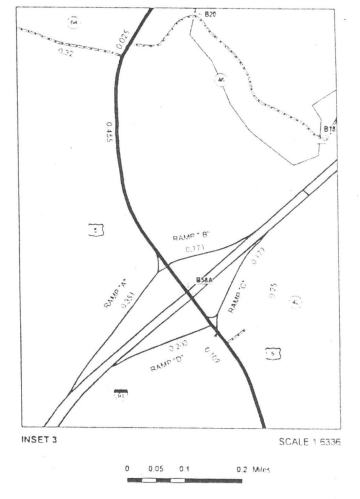
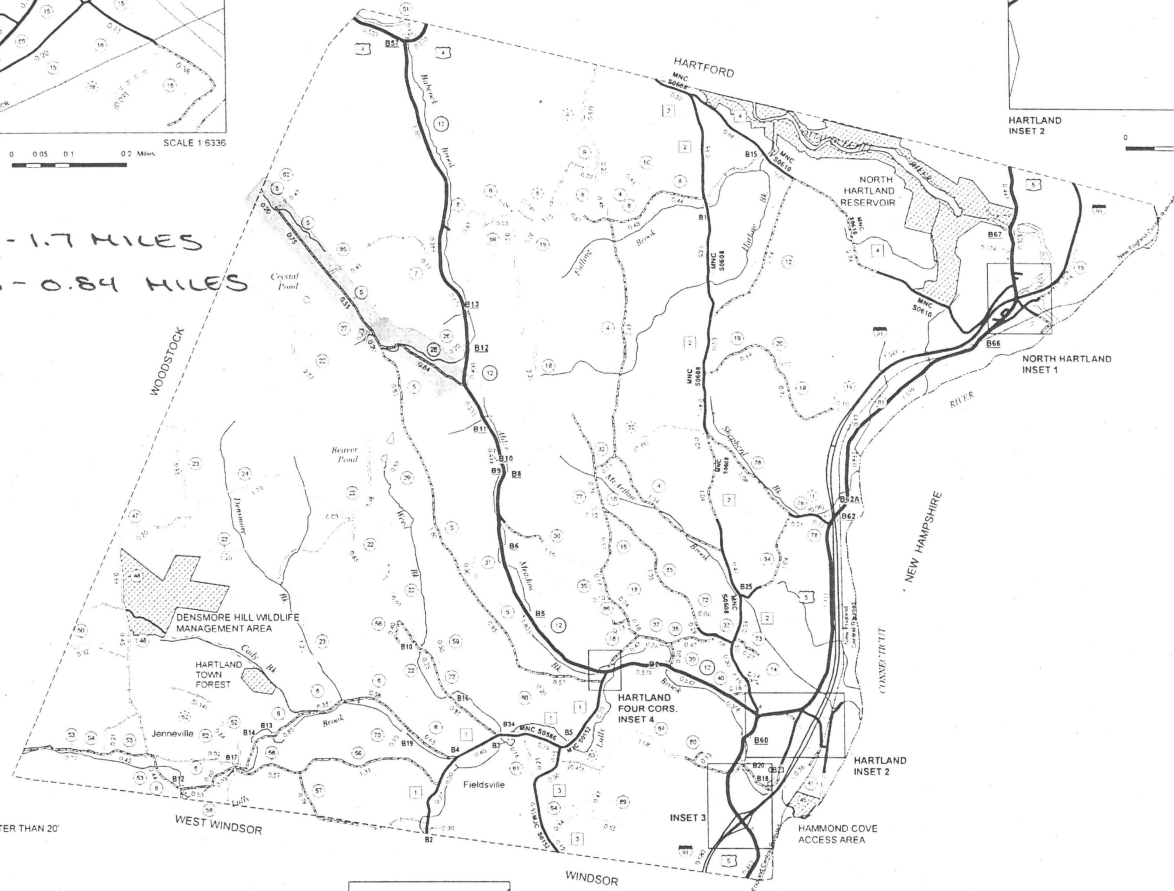

- HIGHWAYS**
- INTERSTATE
  - U.S. ROUTE
  - STATE ROUTE
  - CLASS 1
  - CLASS 2
  - CLASS 3
  - CLASS 4
  - INTERSTATE OR DIVIDED HIGHWAY
  - STATE - HARD SURFACE OR PAVED
  - TOWN - HARD SURFACE OR PAVED
  - GRAVEL
  - SOL. OR GRADED AND DRAINED EARTH
  - UNIMPROVED OR PRIMITIVE
  - IMPASSABLE OR UNTRAVELED
  - LEGAL TRAIL
  - DISCONTINUED
  - HIGHWAY CLASS CHANGE
  - RAILROAD
- FEDERAL CLASSIFICATION IDENTIFIER**
- FAU URBAN ARTERIAL OR COLLECTOR
  - MA MINOR ARTERIAL
  - MJC MAJOR COLLECTOR
  - MIC MINOR COLLECTOR
  - PA PRINCIPAL ARTERIAL
- PUBLIC LAND**
- POLITICAL SUBDIVISIONS
  - STATE BOUNDARY
  - COUNTY BOUNDARY
  - TOWN BOUNDARY
  - VILLAGE BOUNDARY
  - URBAN COMPACT
- WATER BODIES**
- OPEN WATER
  - SWAMP
  - STREAM OR BROOK
  - BRIDGE OR CULVERT
  - BRIDGE OR CULVERT GREATER THAN 20'
  - BRIDGE OR CULVERT 6' - 20'
- B34 STATE BRIDGE IDENTIFIER**  
**B34 TOWN BRIDGE IDENTIFIER**

**DISCLAIMER**

The untraveled highways (lead-out town highways), discontinued highways, and legal trails shown hereon are those of which the Agency of Transportation has record; others may exist.

Highway and bridge data by the Agency of Transportation, Policy & Planning Division. All other data from the Vermont Center for Geographic Information.

Vermont State Plane Coordinate System  
North American Datum of 1983  
SPCS Zone 18N UTM 4409  
Geoid: National System 80  
4 000-meter grid. Easting - Northing

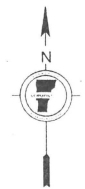
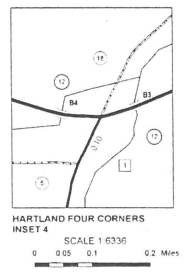

**VERMONT**  
**GENERAL HIGHWAY MAP**  
**Town of Hartland**  
**WINDSOR COUNTY**  
Transportation District #4

Prepared by the  
Vermont Agency of Transportation  
Policy & Planning Division  
in cooperation with  
U.S. Department of Transportation  
Federal Highway Administration

Mileage as of Feb. 10, 2006  
Map generated November 2006

SCALE 1:31680

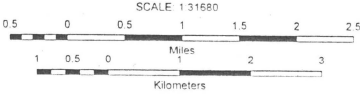

POLICY AND PLANNING

**TO:** Neale Lunderville, Secretary of Transportation

**From:** Mel Adams, Director of Policy and Planning Division  
 By: Mary Spicer, Highway Research Supervisor *M Sp.*

**Date:** December 5, 2007

**Subject:** Class 2 Town Highway Transfer  
 Town: HARTLAND  
 Description: TH 5, HARTLAND HILL ROAD.

VOID

We have reviewed the subject Class 2 Town Highway transfer request (attached) in accordance with AOT guidelines with the following results:

<u>Policy Guidelines</u>	<u>This Road</u>
Classification Rating: 70 Points	62 Points
Paved Typical: 22 Ft. (shld. to shld.)	
Gravel Typical: 20 Ft. (shld. to shld.)	20 ft.
Class 2 Mileage Percent: 25% Hartland	Without Transfer: 18.1%
	With Transfer: 25.5%

This road does not meet the Classification Rating Guidelines by eight points. They do have a community need for Class 2 highways, and the approval of this road would also benefit Woodstock who does have a great community need. We do recommend transfer to the Class 2 Town Highway system.

APPROVED: David C. Die  
 for Neale Lunderville  
 Secretary of Transportation

Date: 12/7/07

Attach.

CC: DTA 4, Tammy Ellis  
 Regional Planning Coordinator, Tammy Benjamin  
 Johnathan Croft, Mapping  
 PDD Business Manager  
 Highway Research Files



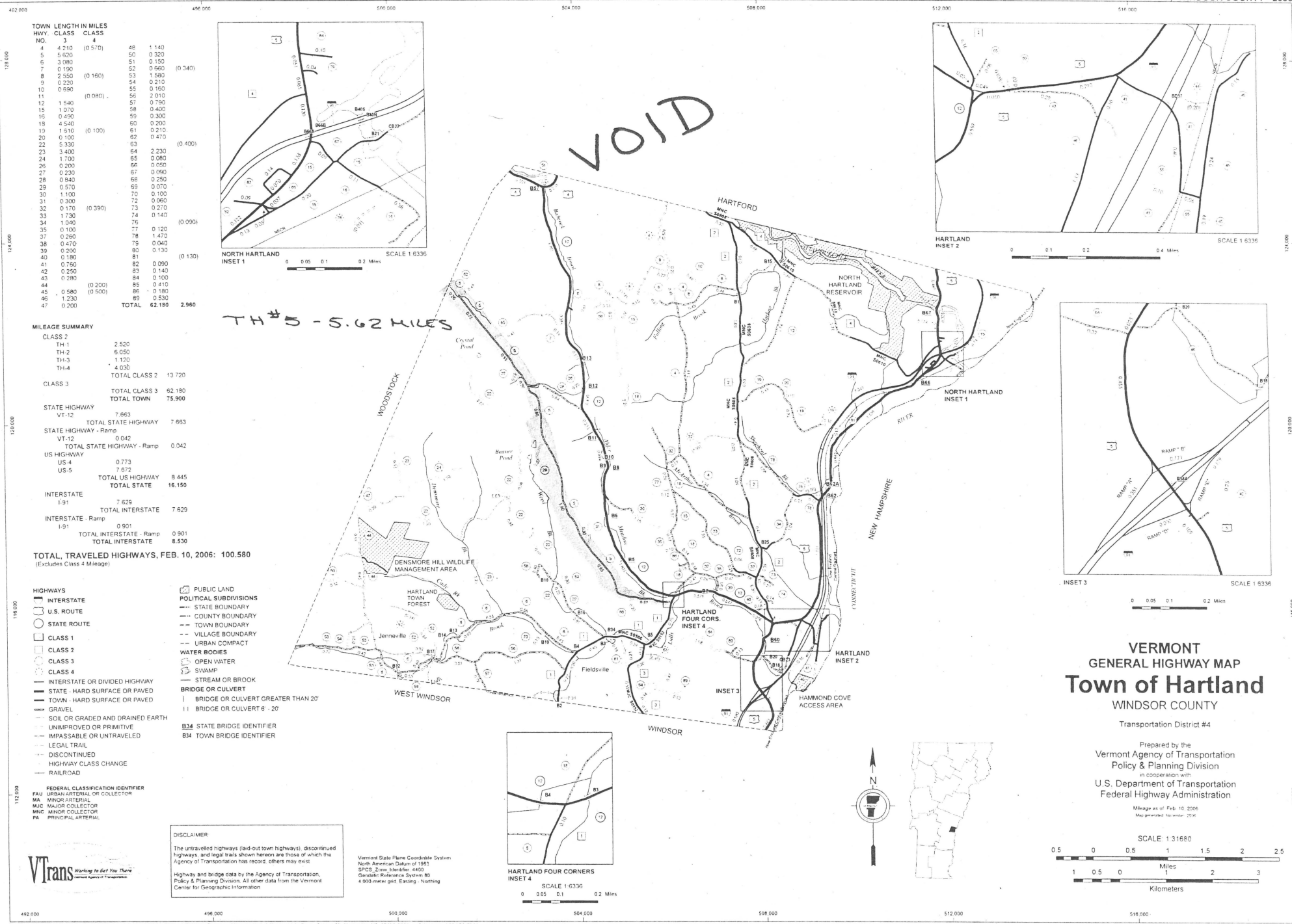

TOWN HWY NO.	LENGTH IN MILES	CLASS	CLASS	
4	4.210	(0.570)	48	1.140
5	5.520		50	0.320
6	3.080		51	0.150
7	0.190		52	0.660
8	2.550	(0.160)	53	1.580
9	2.220		54	0.210
10	0.990		55	0.160
11		(0.080)	56	2.010
12	1.540		57	0.790
15	1.070		58	0.400
16	0.490		59	0.300
18	4.540		60	0.200
19	1.610	(0.100)	61	0.210
20	0.100		62	0.470
22	5.330		63	
23	3.400		64	2.230
24	1.700		65	0.080
26	0.200		66	0.050
27	0.230		67	0.090
28	0.840		68	0.250
29	0.570		69	0.070
30	1.100		70	0.100
31	0.300		72	0.060
32	0.170	(0.390)	73	0.270
33	1.730		74	0.140
34	1.040		75	
35	0.100		77	0.120
37	0.260		78	1.470
38	0.470		79	0.040
39	0.200		80	0.130
40	0.180		81	
41	0.760		82	0.090
42	0.250		83	0.140
43	0.280		84	0.000
44	0.580	(0.200)	85	0.410
46	1.230	(0.500)	86	0.180
47	0.200		89	0.530
TOTAL			62.180	2.960

**MILEAGE SUMMARY**

CLASS 2	
TH-1	2.520
TH-2	6.050
TH-3	1.120
TH-4	4.030
TOTAL CLASS 2	13.720
CLASS 3	
TOTAL CLASS 3	62.180
TOTAL TOWN	75.900
STATE HIGHWAY	
VT-12	7.663
TOTAL STATE HIGHWAY	7.663
STATE HIGHWAY - Ramp	
VT-12	0.042
TOTAL STATE HIGHWAY - Ramp	0.042
US HIGHWAY	
US-4	0.773
US-5	7.672
TOTAL US HIGHWAY	8.445
TOTAL STATE	16.150
INTERSTATE	
I-91	7.629
TOTAL INTERSTATE	7.629
INTERSTATE - Ramp	
I-91	0.901
TOTAL INTERSTATE - Ramp	0.901
TOTAL INTERSTATE	8.530

**TOTAL TRAVELED HIGHWAYS, FEB. 10, 2006: 100.580**  
(Excludes Class 4 Mileage)

- HIGHWAYS**
- INTERSTATE
  - U.S. ROUTE
  - STATE ROUTE
  - CLASS 1
  - CLASS 2
  - CLASS 3
  - CLASS 4
  - INTERSTATE OR DIVIDED HIGHWAY
  - STATE - HARD SURFACE OR PAVED
  - TOWN - HARD SURFACE OR PAVED
  - GRAVEL
  - SOIL OR GRADED AND DRAINED EARTH
  - UNIMPROVED OR PRIMITIVE
  - IMPASSABLE OR UNTRAVELED
  - LEGAL TRAIL
  - DISCONTINUED
  - HIGHWAY CLASS CHANGE
  - RAILROAD
- FEDERAL CLASSIFICATION IDENTIFIER**
- FAU URBAN ARTERIAL OR COLLECTOR
  - MA MAJOR ARTERIAL
  - MJC MAJOR COLLECTOR
  - MIC MINOR COLLECTOR
  - PA PRINCIPAL ARTERIAL

- PUBLIC LAND
- POLITICAL SUBDIVISIONS
- STATE BOUNDARY
- COUNTY BOUNDARY
- TOWN BOUNDARY
- VILLAGE BOUNDARY
- URBAN COMPACT
- WATER BODIES
- OPEN WATER
- SWAMP
- STREAM OR BROOK
- BRIDGE OR CULVERT
- BRIDGE OR CULVERT GREATER THAN 20'
- BRIDGE OR CULVERT 6' - 20'
- STATE BRIDGE IDENTIFIER
- TOWN BRIDGE IDENTIFIER

**DISCLAIMER**

The untraveled highways (lad-out town highways), discontinued highways, and legal trails shown hereon are those of which the Agency of Transportation has received others may exist.

Highways and bridge data by the Agency of Transportation, Policy & Planning Division. All other data from the Vermont Center for Geographic Information.

Vermont State Plane Coordinate System  
North American Datum of 1983  
SPCS Zone, Meridian 4400  
Geoid Reference System 80  
4,000-meter grid. Easting - Northing



**Moulton, Sara**

---

**From:** Moulton, Sara  
**Sent:** Wednesday, January 23, 2008 1:05 PM  
**To:** 'hartlandvttm@vermontel.net'  
**Subject:** Hartland Class 2 Transfer

In response to your telephone call, I talked with our Highway Research Unit. They are the ones who process the Class 2 transfers. They understand the error and will be reprocessing the change to include only Hartland Hill Rd which includes the northern 1.70 miles of TH-5 and 0.84 miles of TH-28, for a total of 2.54 miles.

They will exclude the section of TH-5 which covers Town Farm Hill Rd from the transfer.

Once the revised transfer paperwork has been completed, I can reissue a new Certificate of Highway Mileage for Hartland. I expect the paperwork to be completed by the end of this week.

Please let me know if this is acceptable with you, or if you have any questions.

I'm sorry for any inconvenience this might have caused.

Sara Moulton  
Mapping & GIS Specialist  
Policy & Planning Division - Mapping Unit  
Vermont Agency of Transportation (VTrans)  
Tel: 802-828-2109

**CERTIFICATE OF HIGHWAY MILEAGE  
YEAR ENDING FEBRUARY 10, 2008**

Fill out form, make and file copy with the Town Clerk, and mail ORIGINAL, before February 20, 2008 to:  
Vermont Agency of Transportation, Policy and Planning Division, One National Life Drive, Montpelier, VT 05633.

We, the Selectmen or Aldermen or Trustees of HARTLAND in WINDSOR County  
on an oath state that the mileage of highways, according to Title 19, V.S.A, Sec #305, added 1985, is as follows:

**PART I - CHANGES TOTALS - Please fill in and calculate totals.**

Town Highways	Previous Mileage	Added Mileage	Subtracted Mileage	Total	Scenic Highways
Class 1	0.000				0.000
* Class 1 Lane	0.000				
Class 2	13.720	5.62			0.000
Class 3	62.180		5.62		0.000
State Highway	24.680				0.000
* Class 4	2.960				0.000
* Legal Trail	0.000				
<b>Total</b>	<b>100.580</b>				<b>0.000</b>

\* Mileage for Class 1 Lane, Class 4, and Legal Trail classifications is NOT included in total.

**PART II - INFORMATION AND DESCRIPTION OF CHANGES SHOWN ABOVE.**

1. NEW HIGHWAYS: Please attach Selectmen's "Certificate of Completion and Opening"

2. DISCONTINUED: Please attach SIGNED copy of proceedings (minutes of meeting)

3. RECLASSIFIED/REMEASURED: Please attach SIGNED copy of proceedings (minutes of meeting)  
Class 2 Transfer - CL3 TH-5 (5.62 mi) to CL2 TH-5 (5.62 mi)

4. SCENIC HIGHWAYS: Please attach a copy of order designating/discontinuing Scenic Highways.

IF THERE ARE NO CHANGES IN MILEAGE: Check box and sign below. [ ]

**PART III - SIGNATURES - PLEASE SIGN.**

Selectmen/ Aldermen/ Trustees Signatures: \_\_\_\_\_  
\_\_\_\_\_

T/C/V Clerk Signature: \_\_\_\_\_ Date Filed: \_\_\_\_\_

Please sign ORIGINAL and return it for Transportation signature.

AGENCY OF TRANSPORTATION APPROVAL: Signed copy will be returned to T/C/V Clerk.

APPROVED: \_\_\_\_\_ DATE: \_\_\_\_\_  
Representative, Agency of Transportation

TOWN LENGTH IN MILES	CLASS	CLASS	
4	3	4	
4	4.210	(0.570)	48 1 140
5	5.620		50 0 320
6	3.080		51 0 150
7	0.190		52 0 660
8	2.550	(0.160)	53 1 580
9	0.220		54 0 210
10	0.690		55 0 160
11		(0.080)	56 2 010
12	1.540		57 0 790
13	1.070		58 0 460
16	0.490		59 0 300
18	4.540		60 0 200
19	1.610	(0.100)	61 0 210
20	0.100		62 0 470
22	5.330		63 0 300
23	3.400		64 2 230
24	1.700		65 0 080
26	0.200		66 0 050
27	0.230		67 0 090
28	0.840		68 0 250
29	0.570		69 0 070
30	1.100		70 0 100
31	0.300	(0.390)	72 0 160
32	0.170		73 0 270
33	1.730		74 0 140
34	1.040	(0.090)	76 0 120
35	0.100		77 0 120
37	0.290		78 1 470
38	0.470		79 0 040
39	0.200		80 0 130
40	0.180		81 0 100
41	0.150	(0.130)	82 0 090
42	0.250		83 0 140
43	0.280		84 0 100
44		(0.200)	85 0 410
45	0.580	(0.500)	86 0 180
46	1.230		89 0 530
47	0.200		
<b>TOTAL</b>	<b>62.180</b>		<b>2.960</b>

**MILEAGE SUMMARY**

CLASS 2	2.520	2.230
TH-1	6.050	0.460
TH-2	1.120	0.040
TH-3	4.030	0.042
TH-4		
<b>TOTAL CLASS 2</b>	<b>13.720</b>	
CLASS 3		
<b>TOTAL CLASS 3</b>	<b>62.180</b>	
<b>TOTAL TOWN</b>	<b>75.900</b>	
STATE HIGHWAY		
VT-12	7.663	7.663
STATE HIGHWAY - Ramp	0.042	0.042
<b>TOTAL STATE HIGHWAY</b>	<b>7.663</b>	
US HIGHWAY		
US-4	0.773	0.773
US-5	7.672	7.672
<b>TOTAL US HIGHWAY</b>	<b>8.445</b>	
<b>TOTAL STATE</b>	<b>16.150</b>	
INTERSTATE		
I-91	7.629	7.629
INTERSTATE - Ramp	0.901	0.901
<b>TOTAL INTERSTATE</b>	<b>8.530</b>	

**TOTAL TRAVELED HIGHWAYS, FEB. 10, 2006: 100.580**  
(Excludes Class 4 Mileage)

- HIGHWAYS**
- INTERSTATE
  - U.S. ROUTE
  - STATE ROUTE
  - CLASS 1
  - CLASS 2
  - CLASS 3
  - CLASS 4
  - INTERSTATE OR DIVIDED HIGHWAY
  - STATE - HARD SURFACE OR PAVED
  - TOWN - HARD SURFACE OR PAVED
  - GRAVEL
  - SOIL OR GRADED AND DRAINED EARTH
  - UNIMPROVED OR PRIMITIVE
  - IMPASSABLE OR UNTRAVELED
  - LEGAL TRAIL
  - DISCONTINUED
  - HIGHWAY CLASS CHANGE
  - RAILROAD
- PUBLIC LAND**
- HARTLAND TOWN FOREST
  - DENSMORE HILL WILDLIFE MANAGEMENT AREA
- POLITICAL SUBDIVISIONS**
- STATE BOUNDARY
  - COUNTY BOUNDARY
  - TOWN BOUNDARY
  - VILLAGE BOUNDARY
  - URBAN COMPACT
- WATER BODIES**
- OPEN WATER
  - SWAMP
  - STREAM OR BROOK
- BRIDGE OR CULVERT**
- BRIDGE OR CULVERT GREATER THAN 20'
  - BRIDGE OR CULVERT 6' - 20'
  - STATE BRIDGE IDENTIFIER
  - TOWN BRIDGE IDENTIFIER
- FEDERAL CLASSIFICATION IDENTIFIER**
- FAU URBAN ARTERIAL OR COLLECTOR
  - MA MINOR ARTERIAL
  - MJC MAJOR COLLECTOR
  - MNC MINOR COLLECTOR
  - PA PRINCIPAL ARTERIAL

**DISCLAIMER**

The untraveled highways (lead-out town highways), discontinued highways, and legal trails shown hereon are those of which the Agency of Transportation has record; others may exist.

Highway and bridge data by the Agency of Transportation, Policy & Planning Division. All other data from the Vermont Center for Geographic Information.

Vermont State Plane Coordinate System  
North American Datum of 1983  
SPCE Zone 18N/44E/4450  
Geoid Reference System 83  
4 000-meter grid. Easting - Northing

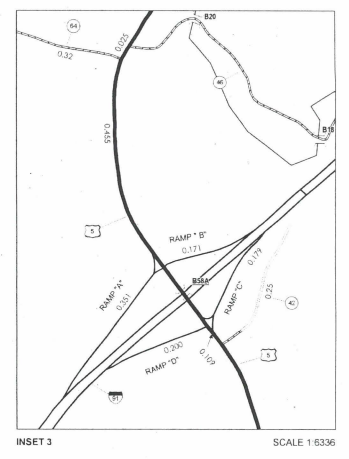
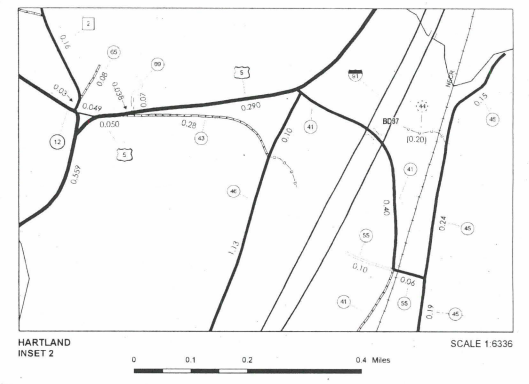
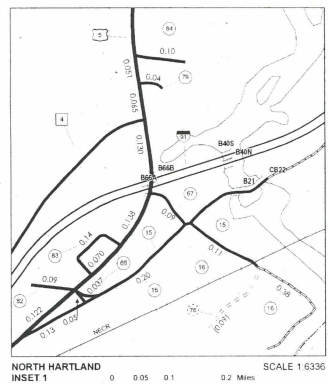
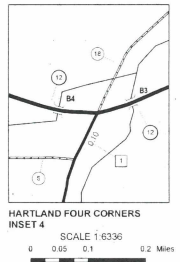

**VERMONT GENERAL HIGHWAY MAP**  
**Town of Hartland**  
WINDSOR COUNTY

Transportation District #4

Prepared by the  
Vermont Agency of Transportation  
Policy & Planning Division  
in cooperation with  
U.S. Department of Transportation  
Federal Highway Administration

Mileage as of Feb. 10, 2006  
Map generated November, 2006

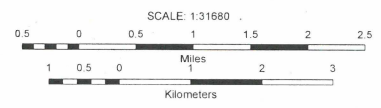

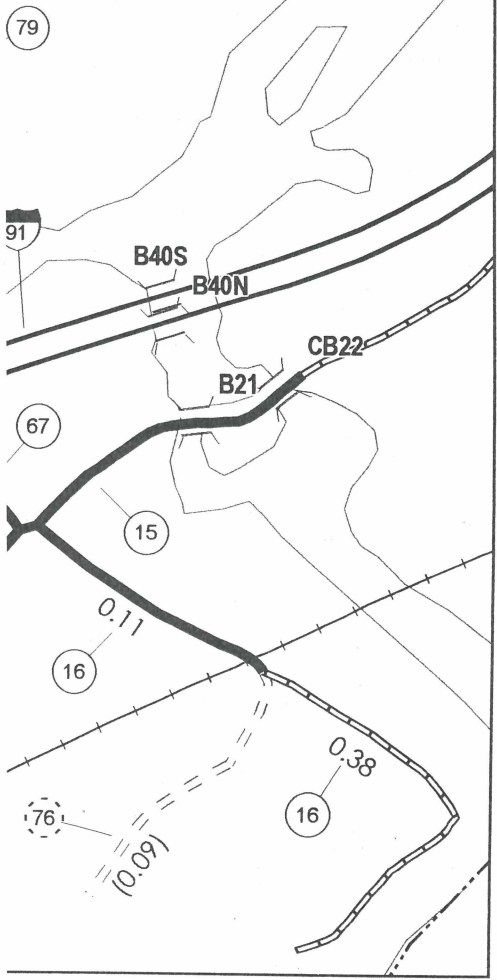

Hartland Hill Rd 2.54 miles

TH-3 CL3 5.62 miles

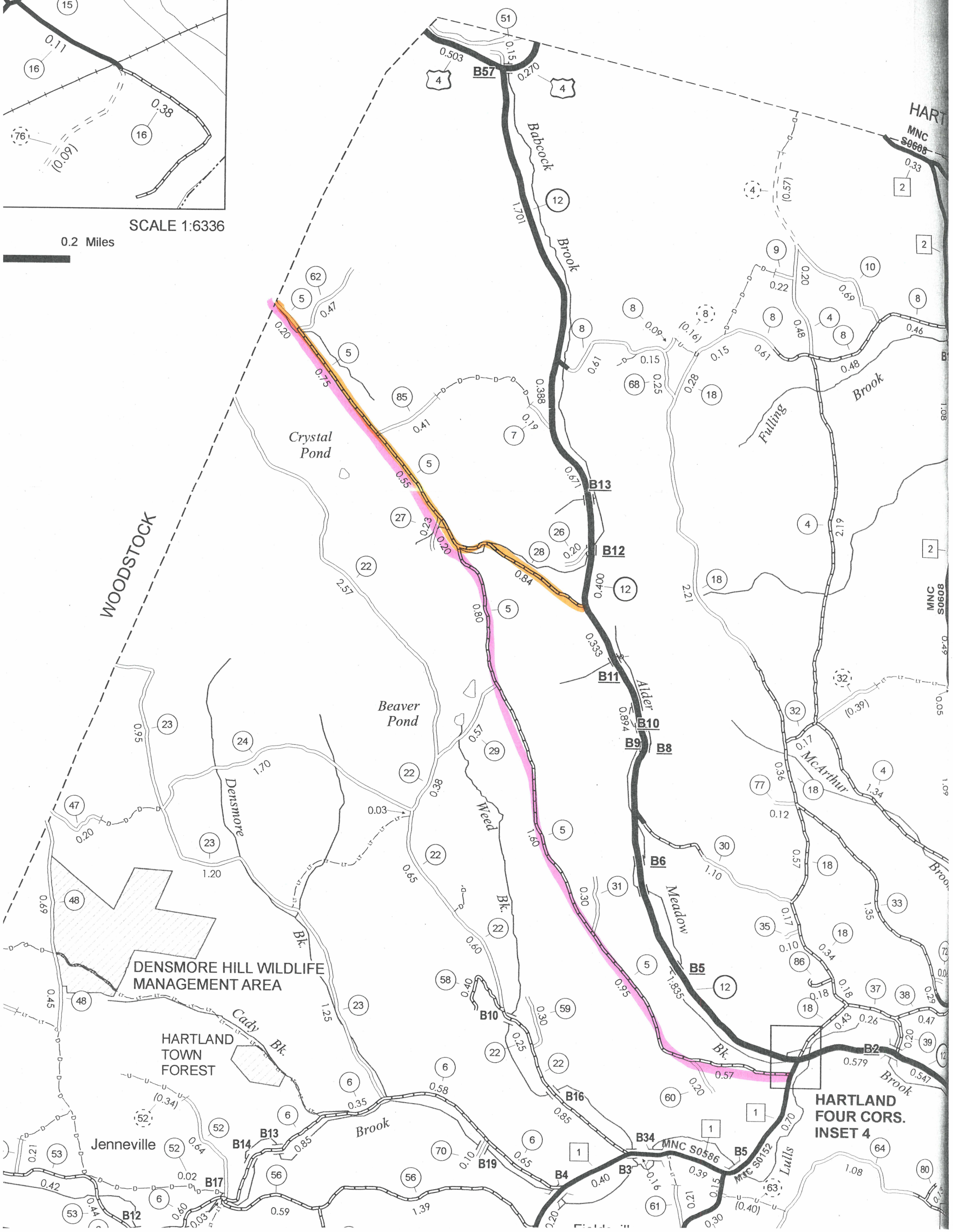

SCALE 1:6336

0.2 Miles



HARTLAND FOUR CORNS. INSET 4