

CERTIFICATE OF HIGHWAY MILEAGE
YEAR ENDING FEBRUARY 10, 2017

Fill out form, make and file copy with the Town Clerk, and mail ORIGINAL, before February 20, 2017 to:
Vermont Agency of Transportation, Division of Policy, Planning and Intermodal Development, Mapping Section
One National Life Drive, Montpelier, VT 05633.

We, the members of the legislative body of HARTFORD in WINDSOR County
on an oath state that the mileage of highways, according to Vermont Statutes Annotated, Title 19, Section 305,
added 1985, is as follows:

PART I - CHANGES TOTALS - Please fill in and calculate totals.

Table with 6 columns: Town Highways, Previous Mileage, Added Mileage, Subtracted Mileage, Total, Scenic Highways. Rows include Class 1, Class 2, Class 3, State Highway, Total, Class 1 Lane, Class 4, and Legal Trail.

* Mileage for Class 1 Lane, Class 4, and Legal Trail classifications are NOT included in total.

PART II - INFORMATION AND DESCRIPTION OF CHANGES SHOWN ABOVE.

totals by K. Grimsdell 28/02/2017

- 1. NEW HIGHWAYS: Please attach Selectmen's "Certificate of Completion and Opening".
2. DISCONTINUED: Please attach SIGNED copy of proceedings (minutes of meeting).
3. RECLASSIFIED/REMEASURED: Please attach SIGNED copy of proceedings (minutes of meeting).
4. SCENIC HIGHWAYS: Please attach a copy of order designating/discontinuing Scenic Highways.

IF THERE ARE NO CHANGES IN MILEAGE: Check box and sign below. []

PART III - SIGNATURES - PLEASE SIGN.

Selectmen/ Aldermen/ Trustees Signatures:

Handwritten signatures of Richard Johnson, Brian Brown, and Gaudin Mawett.

T/C/V Clerk Signature:

Handwritten signature of Mary E. Hill

Date Filed:

Please sign ORIGINAL and return it for Transportation signature.

AGENCY OF TRANSPORTATION APPROVAL:

Signed copy will be returned to T/C/V Clerk.

APPROVED:

Handwritten signature and text: Representative, Agency of Transportation

DATE:

Handwritten date: 3/30/2017

Vermont Statutes Annotated

19 V.S.A. § 305. Measurement and inspection

Received

FEB 21 2017

Policy, Planning & Intermodal
Development Division

§ 305. Measurement and inspection

(a) After reasonable notice to the selectboard, a representative of the agency may measure and inspect the class 1, 2, and 3 town highways in each town to verify the accuracy of the records on file with the agency. Upon request, the selectboard or their designee shall be permitted to accompany the representative of the agency during the measurement and inspection. The agency shall notify the town when any highway, or portion of a highway, does not meet the standards for its assigned class. If the town fails, within one year, to restore the highway or portion of the highway to the accepted standard, or to reclassify, or to discontinue, or develop an acceptable schedule for restoring to the accepted standards, the agency for purposes of apportionment under section 306 of this title shall deduct the affected mileage from that assigned to the town for the particular class of the road in question.

(b) Annually, on or before February 10, the selectboard shall file with the town clerk a sworn statement of the description and measurements of all class 1, 2, 3, and 4 town highways and trails then in existence, including any special designation such as a throughway or scenic highway. When class 1, 2, 3, or 4 town highways, trails, or unidentified corridors are accepted, discontinued, or reclassified, a copy of the proceedings shall be filed in the town clerk's office and a copy shall be forwarded to the agency.

(c) All class 1, 2, 3, and 4 town highways and trails shall appear on the town highway maps by July 1, 2015.

(d) At least 45 days prior to first including a town highway or trail that is not clearly observable by physical evidence of its use as a highway or trail and that is legally established prior to February 10, 2006 in the sworn statement required under subsection (b) of this section, the legislative body of the municipality shall provide written notice and an opportunity to be heard at a duly warned meeting of the legislative body to persons owning lands through which a highway or trail passes or abuts.

(e) The agency shall not accept any change in mileage until the records required to be filed in the town clerk's office by this section are received by the agency. A request by a municipality to the agency for a change in mileage shall include a description of the affected highway or trail, a copy of any surveys of the affected highway or trail, minutes of meetings at which the legislative body took action with respect to the changes, and a current town highway map with the requested deletions and additions sketched on it. A survey shall not be required for class 4 town highways that are legally established prior to February 10, 2006. All records filed with the agency are subject to verification in accordance with subsection (a) of this section.

(f) The selectboard of any town who are aggrieved by a finding of the agency concerning the measurement, description, or classification of a town highway may appeal to the transportation board by filing a notice of appeal with the executive secretary of the transportation board.

(g) The agency shall provide each town with a map of all of the highways in that town together with the mileage of each class 1, 2, 3, and 4 highway, as well as each trail, and such other information as the agency deems appropriate.

Excerpt of 19 V.S.A. § 305 - *Measurement and inspection* from Vermont Statutes Online located at – <http://legislature.vermont.gov/statutes/section/19/003/00305>

December 2016

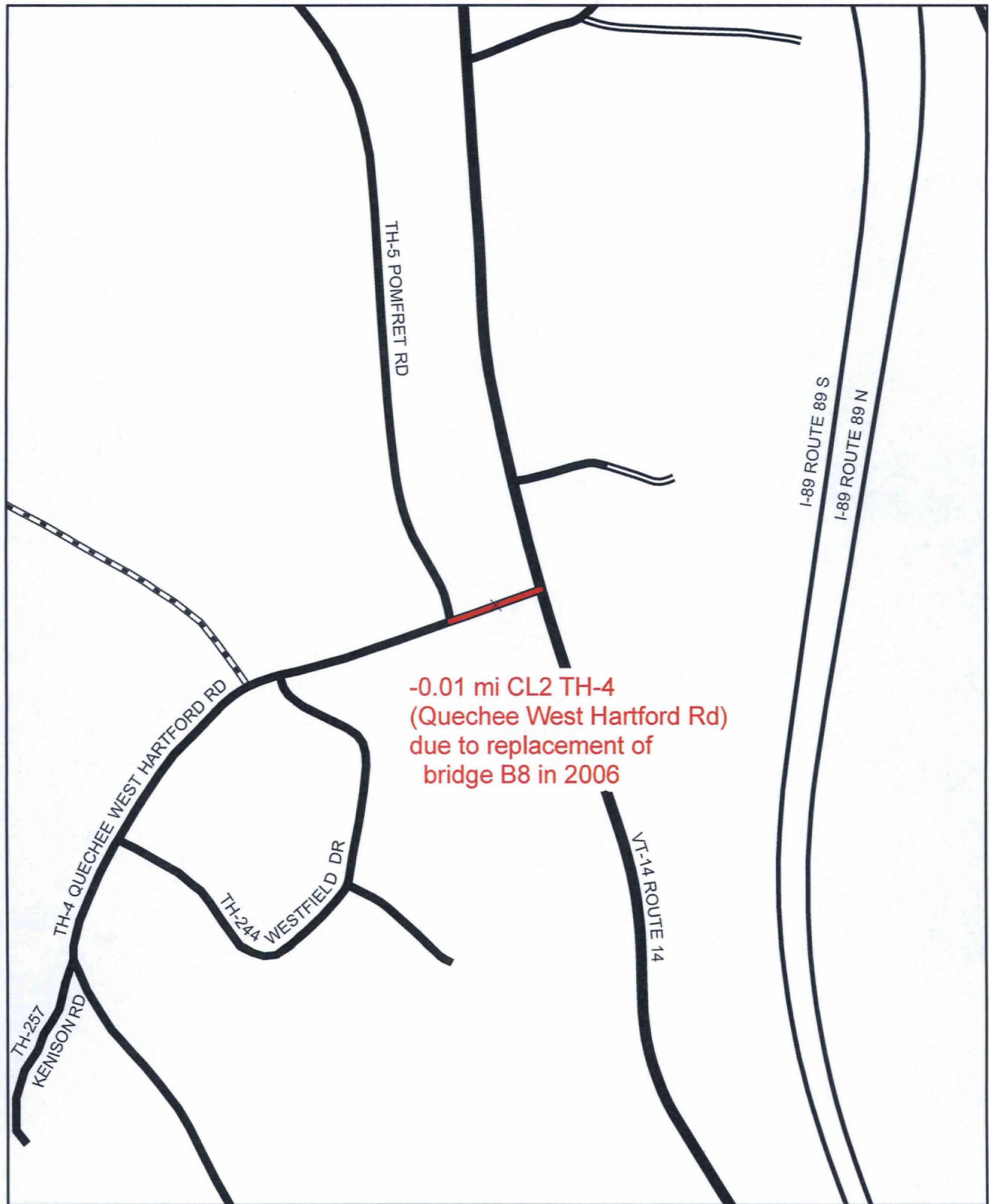

-0.01 mi CL2 TH-4
 (Quechee West Hartford Rd)
 due to replacement of
 bridge B8 in 2006

Mileage Certificate Change 2017
HARTFORD

(CTCODE: 1408)

Mapping Section
 Division of Policy, Planning and Intermodal Development
 Vermont Agency of Transportation - February 2017



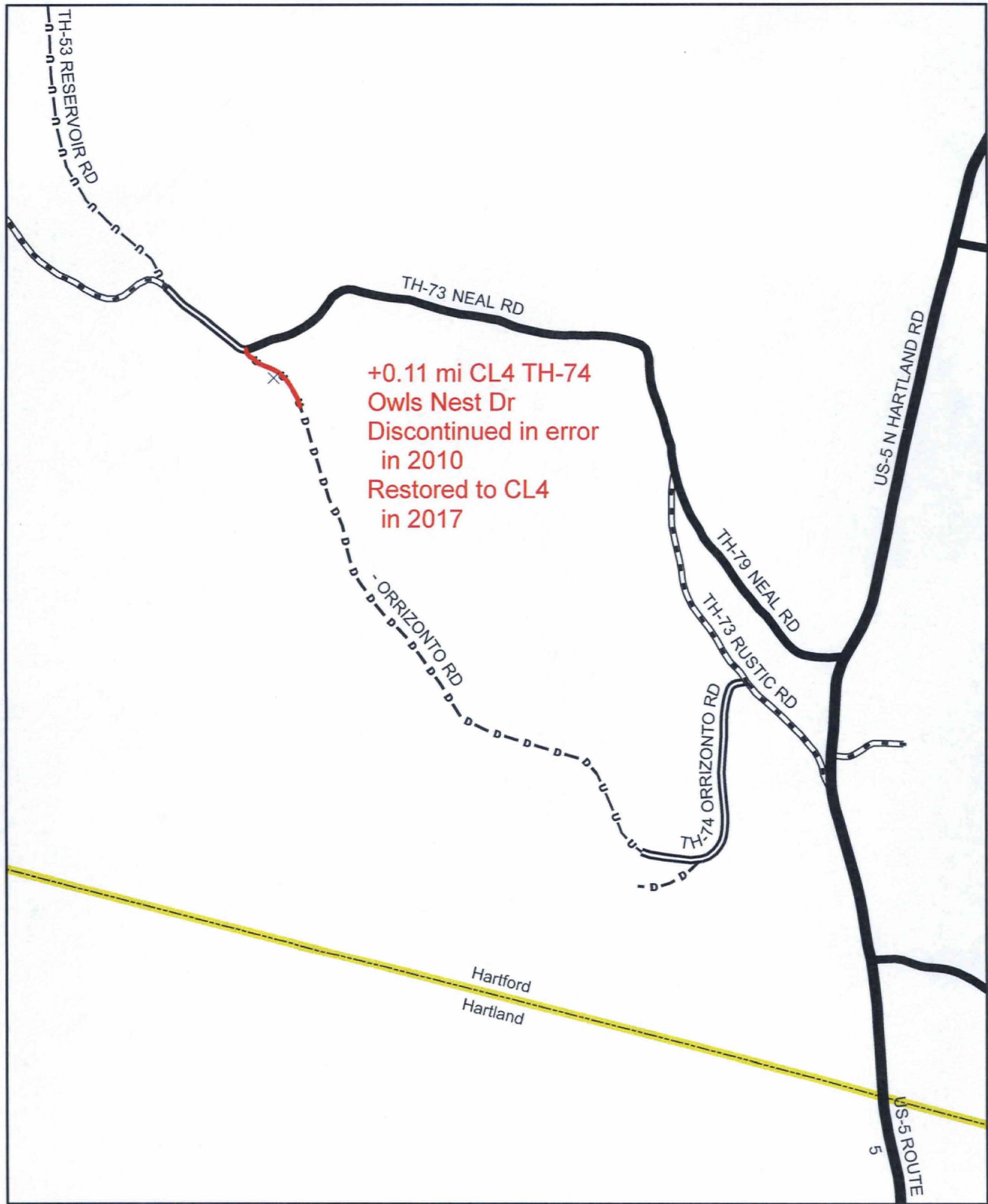

+0.11 mi CL4 TH-74
Owls Nest Dr
Discontinued in error
in 2010
Restored to CL4
in 2017

Mileage Certificate Change 2017 HARTFORD

(CTCODE: 1408)

Mapping Section
Division of Policy, Planning and Intermodal Development
Vermont Agency of Transportation - February 2017



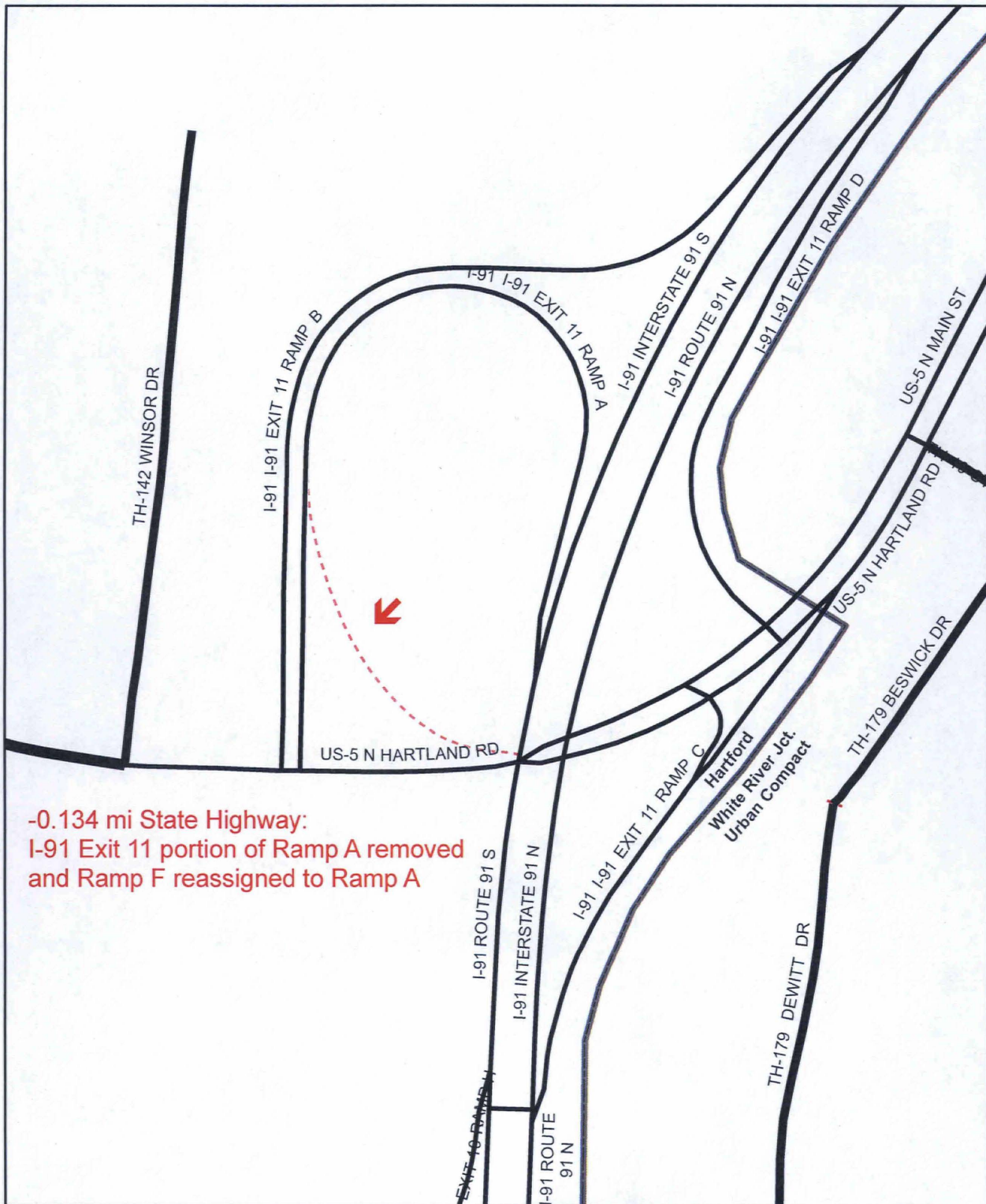

-0.134 mi State Highway:
 I-91 Exit 11 portion of Ramp A removed
 and Ramp F reassigned to Ramp A

Mileage Certificate Change 2017
HARTFORD

(CTCODE: 1408)

Mapping Section
 Division of Policy, Planning and Intermodal Development
 Vermont Agency of Transportation - May 2017



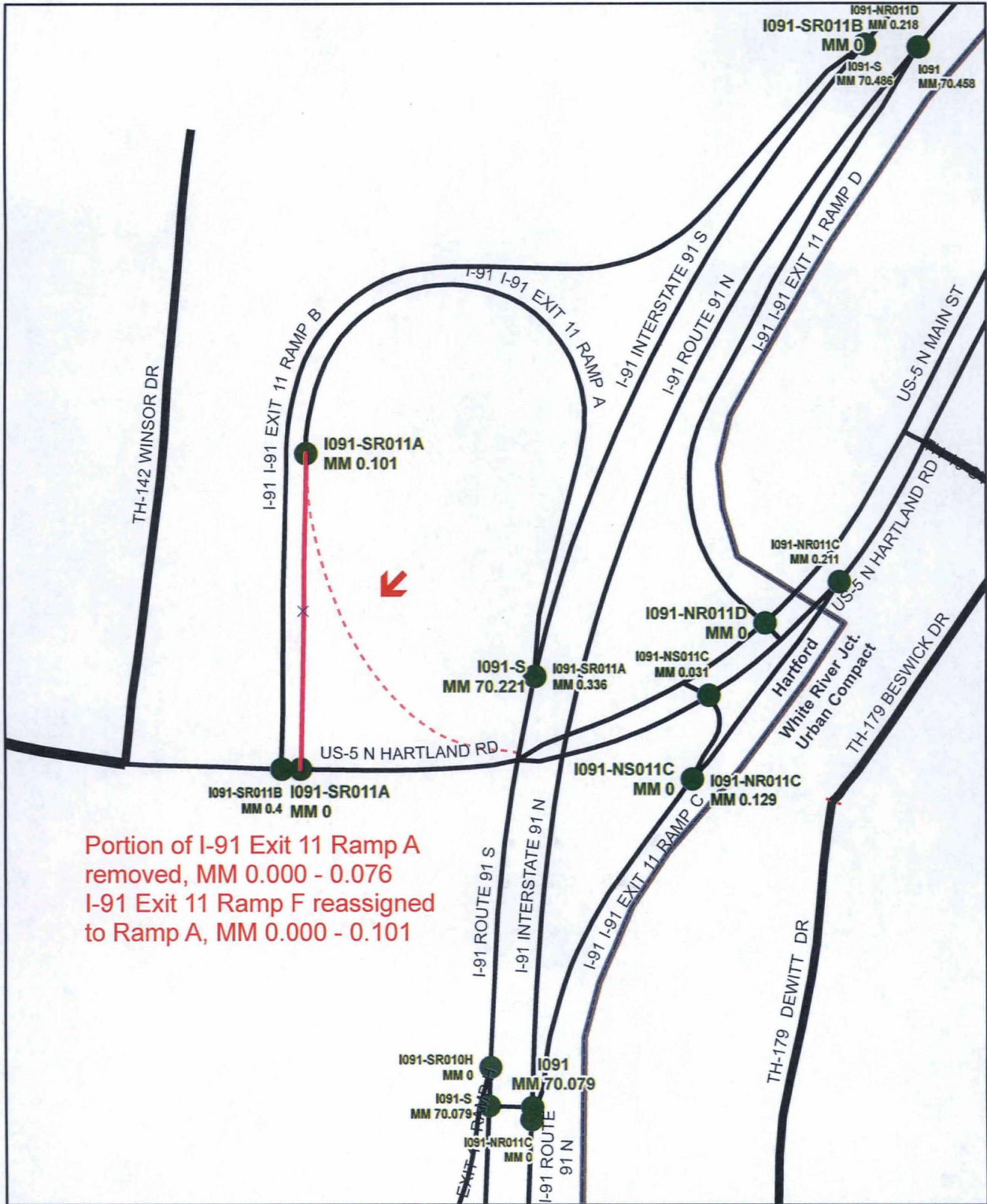

Portion of I-91 Exit 11 Ramp A removed, MM 0.000 - 0.076
 I-91 Exit 11 Ramp F reassigned to Ramp A, MM 0.000 - 0.101

Mileage Certificate Change 2017

HARTFORD

(CTCODE: 1408)

Mapping Section
 Division of Policy, Planning and Intermodal Development
 Vermont Agency of Transportation - May 2017

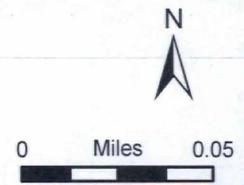



State of Vermont
Division of Policy, Planning and Intermodal Development - Mapping Section
1 National Life Drive
Montpelier, VT 05633-5001
<http://vtrans.vermont.gov>

Agency of Transportation

Telephone: 802-828-2109
Fax: 802-828-2334
Email: sara.moulton@vermont.gov

30 November 2016

Mr. Richard Grassi
Selectboard Chair
Town of Hartford
171 Bridge St
White River Junction, VT 05001

Dear Mr. Grassi,

In working with E911 on questions dealing with the road now known as Owls Nest Dr (formerly Orrizonto Rd), we discovered that we made an error when we processed the discontinuance that was submitted by the Town of Hartford in 2010. The northwestern portion of the road should have remained Class 4 (see enclosed map).

According to our GIS data, this section of highway measures 0.11 miles. We would like to correct this error as part of the 2017 Certificate of Highway Mileage process. In January, we will be sending the Mileage Certificate to the town and plan to note the addition of 0.11 miles of Class 4 TH-74 on the Certificate.

Please let me know if you have any questions.

Sincerely,

Sara Moulton

Sara Moulton
Mapping & GIS Specialist

cc: Christopher Bump, District 4 Project Manager
Jackie Cassino, VTrans Transportation Planning Coordinator

*preloaded on
cert 12/5/2016*



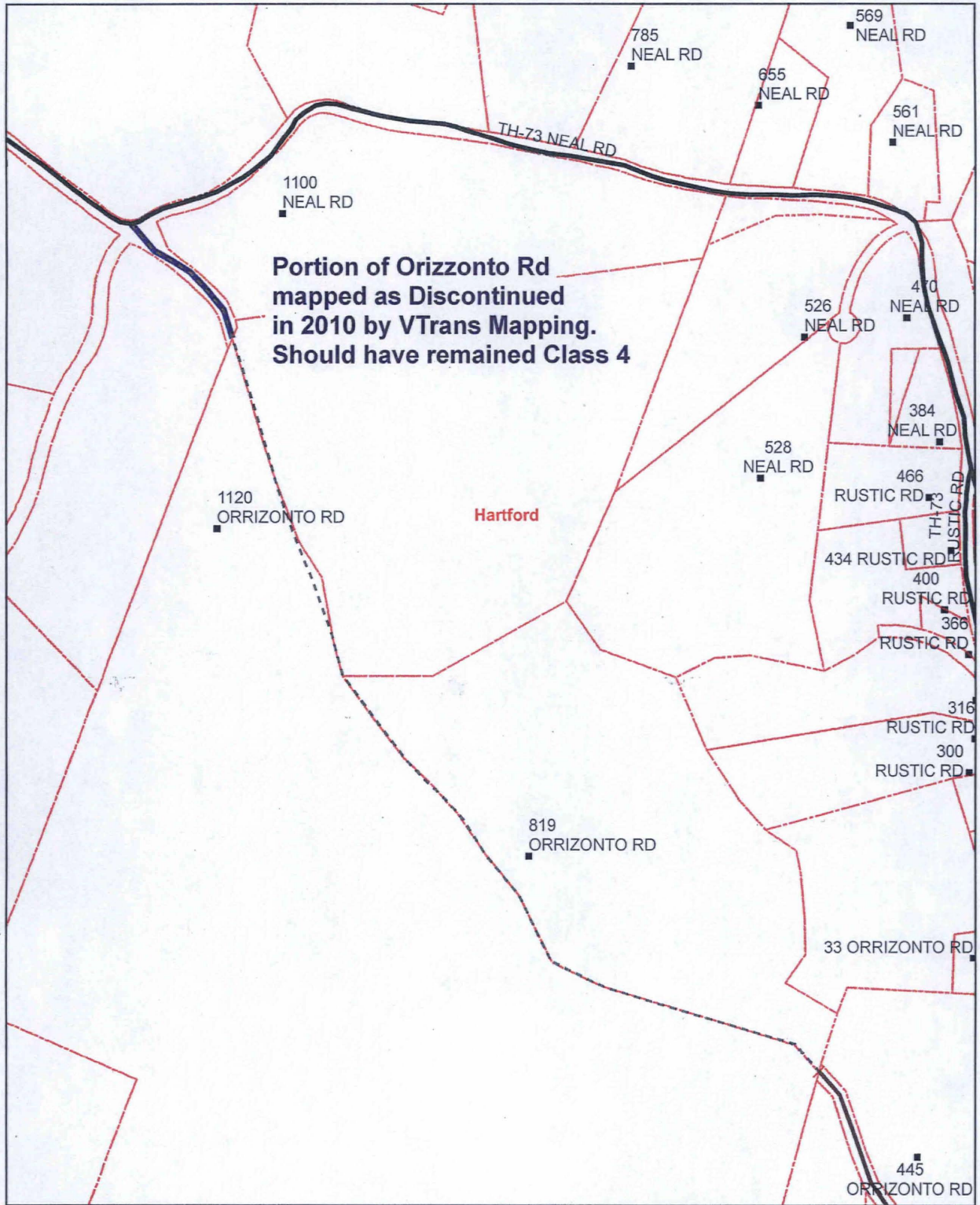

**Orizzonto Rd -TH-74
Discontinuance Mapping Error
HARTFORD**

Mapping Section
Division of Policy, Planning and Intermodal Development
Vermont Agency of Transportation - October 2016

(CTCODE: 1408)

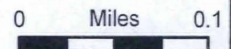

Moulton, Sara

From: Moulton, Sara
Sent: Thursday, November 17, 2016 11:04 AM
To: 'mhill@hartford-vt.org'
Subject: Hartford TH-74 Orrizonto Rd / Owls Nest Dr
Attachments: Hartford_TH74OrizzontoRd_ErrorCorrection.pdf

In working with E911 on questions dealing with the road now known as Owls Nest Dr (formerly Orrizonto Rd), we discovered that we made an error when we processed the discontinuance that was submitted by the Town of Hartford in 2010.

The northwestern portion of the road should have remained Class 4 (see attached map).

According to our GIS data, this section of highway measures 0.11 miles. We would like to correct this error as part of the 2017 Certificate of Highway Mileage process. In January, we will be sending the Mileage Certificate to the town and plan to note the addition of 0.11 miles of Class 4 TH-74 on the Certificate.

Please let me know if you have any questions.

Sara Moulton, GISP
Mapping & GIS Specialist, Mapping Section
Division of Policy, Planning and Intermodal Development
Vermont Agency of Transportation (VTrans)
Email: sara.moulton@vermont.gov
Tel: 802-828-2109

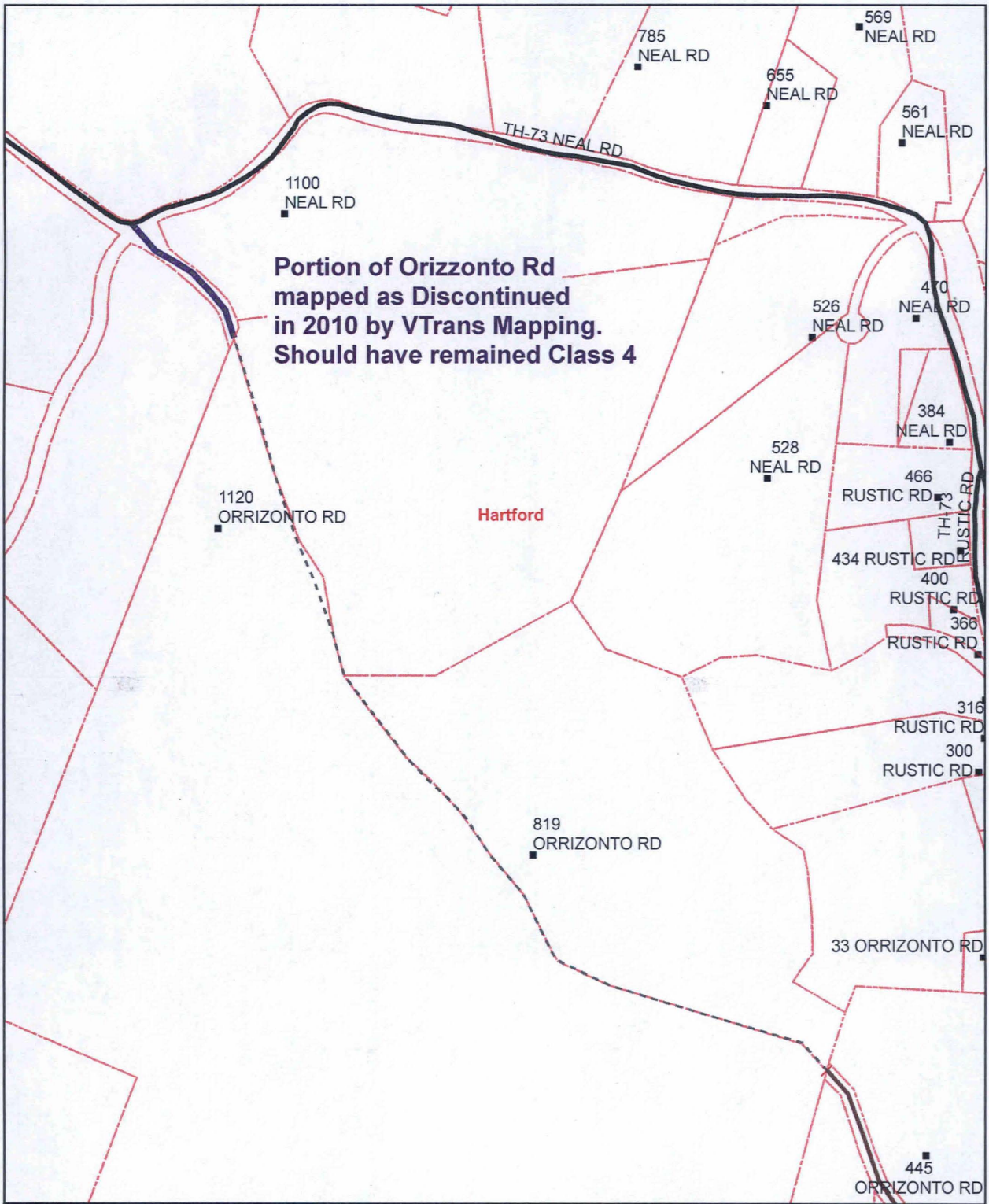

Orizzonto Rd -TH-74
Discontinuance Mapping Error
HARTFORD

Mapping Section
 Division of Policy, Planning and Intermodal Development
 Vermont Agency of Transportation - October 2016

(CTCODE: 1408)

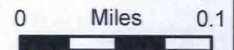

Hartford 1408-0

2017

Moulton, Sara

From: Croft, Johnathan
Sent: Monday, October 03, 2016 9:06 AM
To: Hermanson, Tyler
Cc: Moulton, Sara; Alley, Kerry
Subject: RE: Roads

Good morning Tyler,

We will need to work with the Town to figure out what they have done with Orrizonto Road, as once a highway is discontinued, it reverts back to the adjoining landowners and is private. If it has become public again, there needs to be a laying out process following statute. If the road is private and in use, that is a different story.

Thanks for the heads-up on this and we will work to get this figured out and have the classification corrected.

Johnathan Croft
Vermont Agency of Transportation (VTrans)
Mapping Section
(802) 828-2600

johnathan.croft@vermont.gov

From: Hermanson, Tyler
Sent: Friday, September 30, 2016 2:52 PM
To: Croft, Johnathan <Johnathan.Croft@vermont.gov>; Moulton, Sara <Sara.Moulton@vermont.gov>; Alley, Kerry <Kerry.Alley@vermont.gov>
Subject: Roads

FYI...

Orrizonto Rd (discontinued section) has been reactivated from the town, and flipped and renamed and reclassified. Access from Rustic Rd is left alone. Access from Neal Rd is town maintained (class 4?) for the first ~250 feet and the rest is private rd. The access from Neal Rd was renamed OWLS NEST DR.



Tyler Hermanson GIS Specialist State of Vermont Enhanced 911 Board

Link to E9-1-1 Viewer Map Display: <http://maps.vermont.gov/e911/Html5Viewer/?viewer=e911viewer>

E: tyler.hermanson@vermont.gov C: 802-380-4499 ; P: 802-828-4092 ; F: 802-828-4109 ; **Tue – Fri** : 7-5:30

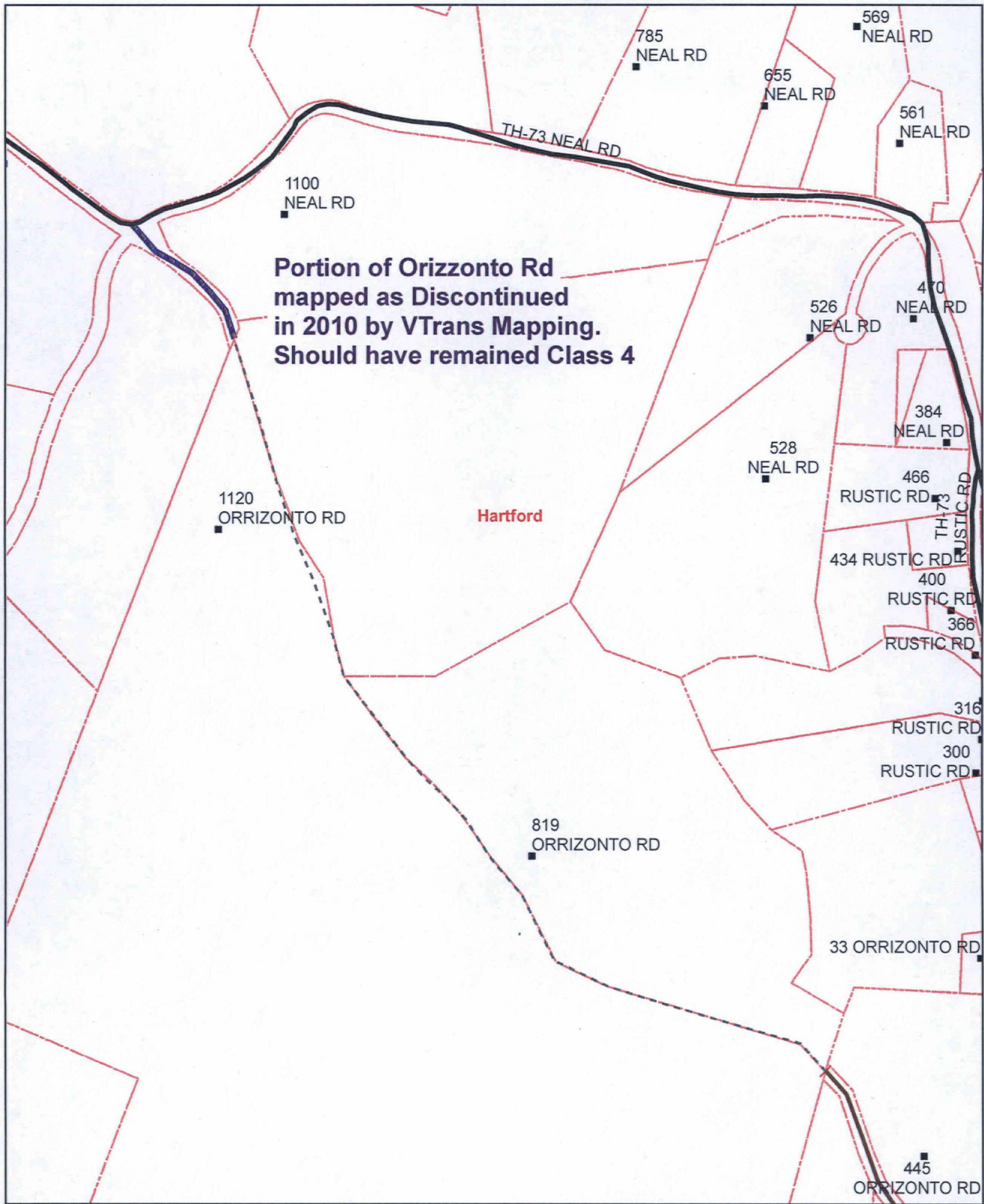

**Orizzonto Rd -TH-74
Discontinuance Mapping Error
HARTFORD**

Mapping Section
Division of Policy, Planning and Intermodal Development
Vermont Agency of Transportation - October 2016

(CTCODE: 1408)

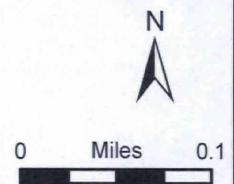



State of Vermont
Division of Planning, Outreach and Community Affairs
Mapping Unit
1 National Life Drive
Montpelier, VT 05633-5001
<http://www.aot.state.vt.us>

Agency of Transportation

Telephone: 802-828-2600
Fax: 802-828-2334
Email: johnathan.croft@state.vt.us

May 24, 2010

Ken Parker, Selectboard Chair
Hartford, c/o Town Clerk
171 Bridge St
White River Junction, VT 05001

Dear Mr. Parker,

The VTrans Mapping Unit has not accepted all the changes noted on Hartford's 2010 Certificate of Highway Mileage. The 0.027 mile addition to the class 3 town highway, Wallace Road, was not accepted. VTrans Mapping needed additional clarification for this mileage and had requested more information in the letter sent on March 16, 2010. The Mapping Unit believes this addition of 0.027 miles is redundant and has not accepted this change.

There has been an additional 0.17 miles added to the discontinued mileage for class 4 town highway as part of the discontinuance of TH-74. The remaining portion of class 4 TH-74 was well described as being 0.12 miles and the other portion of the highway was described as being discontinued, thus increasing the amount of mileage from 0.70 to 0.87 miles.

The other changes included on the Mileage Certificate, being the addition of 0.07 miles of legal trail and the discontinuance of TH-23, were both accepted.

Please feel free to contact me with any questions or comments related to this letter, or mapping in general.

Thank you.

Sincerely,

Johnathan Croft
AOT GIS Database Administrator
VTrans Mapping Unit

JFC/jfc

Enclosures

cc: Susan Clark, VTrans Planning Coordinator
Matt Osborn, Hartford Assistant Zoning Administrator

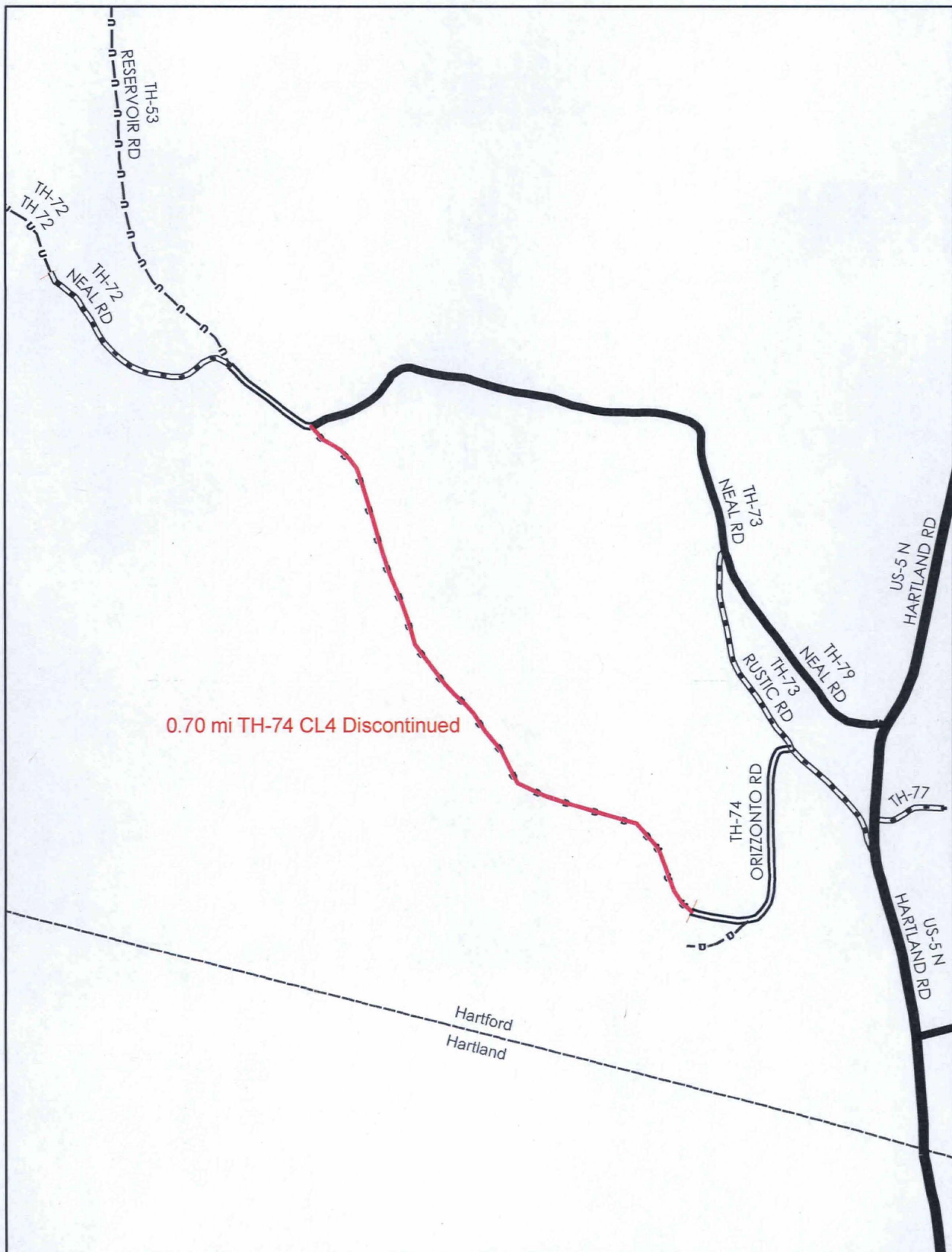

**Mileage Certificate Change 2010
HARTFORD**

Mapping Unit
 Division of Planning, Outreach and Community Affairs
 Vermont Agency of Transportation – May 2010

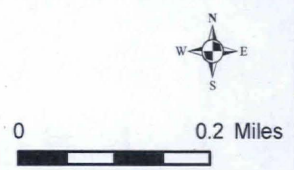



POMFREY RD-TH-5

QUECHEE-W HARTFORD RD-TH-4

ROUTE 145-TH-4

B8

TH-4 & 5
Hartford, VT

LRS Bust Reporting Sheet

Date 5/11/12 Filled Out By MICHAEL
501791408
LRS Code 501661408 LRS Version Used 2011
Route TH4/TH-5 INVENTORY DATE 5/23/12
Town HARTFORD

Mileage Values

Which is Correct?

Highway Research Mileage	_____	<input type="checkbox"/>
LRS Mileage	_____	<input type="checkbox"/>
RDS Mileage	_____	<input type="checkbox"/>
MRDTable Mileage	_____	<input type="checkbox"/>
Printed Route Log Mileage	_____	<input type="checkbox"/>

Correction needed:

- Highway Research Data Needs Updating
- LRS Needs Update
- RDS Needs Update
- MRDTable's Needs Update

LRS Change

Correction Description:

HIGHWAYS ALIGNMENT CHANGED DUE TO BRIDGE PROJECT

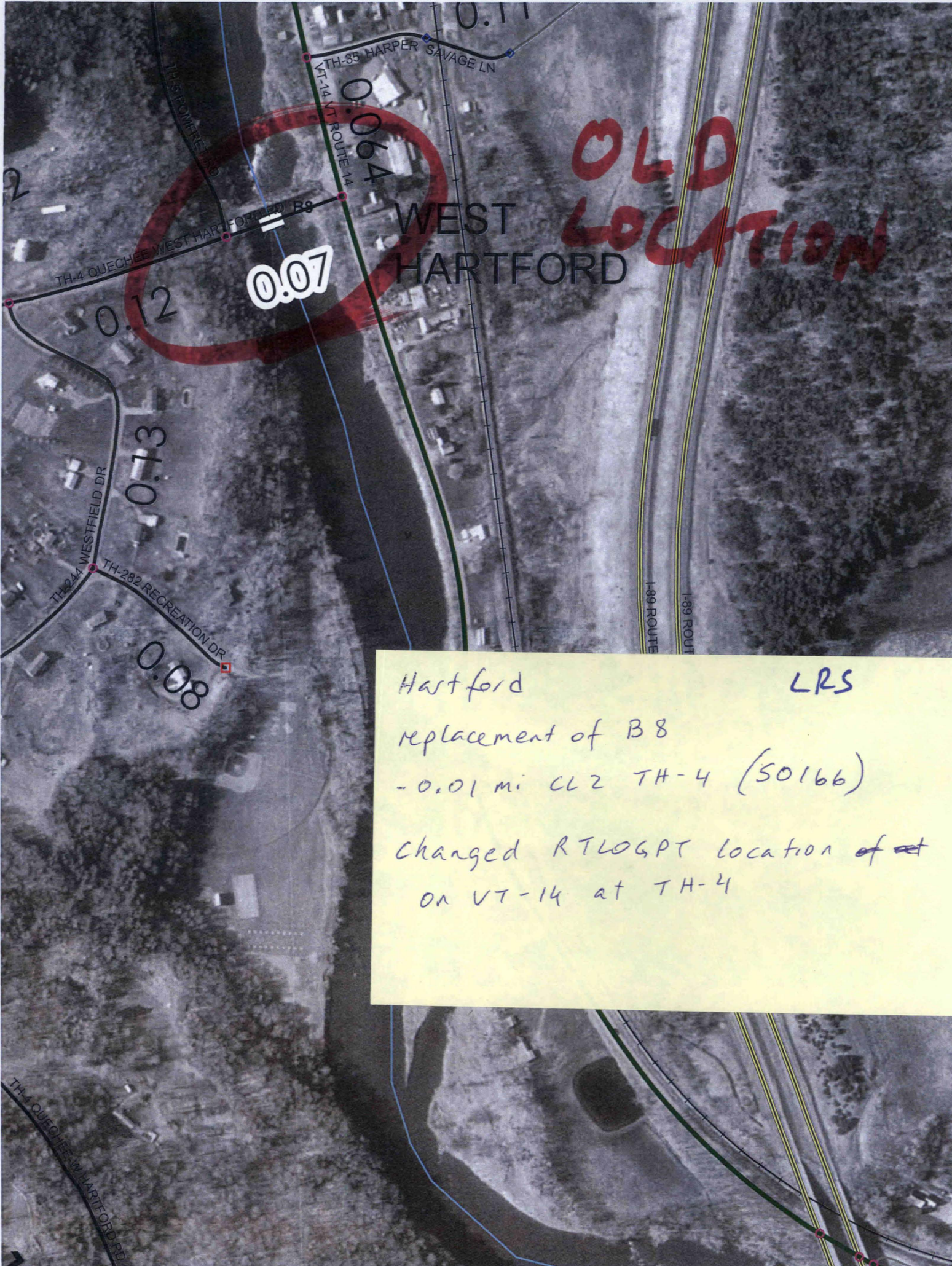

OLD
LOCATION

WEST
HARTFORD

0.07

0.064

0.12

0.13

0.08

Hartford LRS
replacement of B8
- 0.01 mi CL2 TH-4 (50166)
changed RTLOGPT location of ~~at~~
on VT-14 at TH-4

TH-35 HARPER SAVAGE LN

VT-14 VT ROUTE 14

TH-4 QUECHEE WEST HARTFORD RD B8

TH-244 WESTFIELD DR

TH-282 RECREATION DR

1-89 ROUTE

1-89 ROUTE

TH-4 QUECHEE IN HARTFORD RD

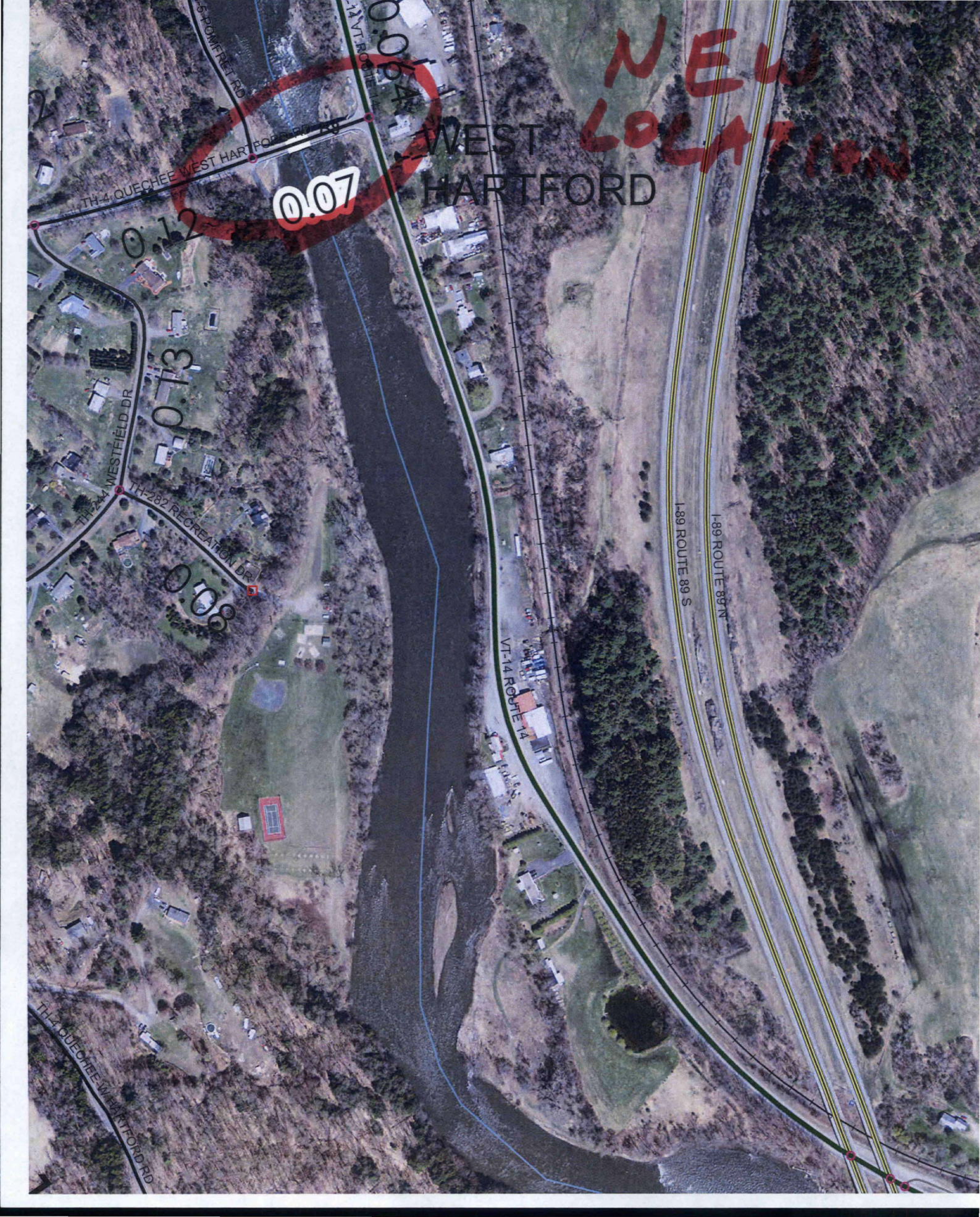

NEW
LOCATION

WEST
HARTFORD

0.07

0.12

0.13

0.08

0.064

1-89 ROUTE 89 S

1-89 ROUTE 89 N

VT-14 ROUTE 14

TH-4 QUECHEE WEST HARTFORD RD

TH-244 WESTFIELD DR

TH-282 RECREATION DR

TH-4 QUECHEE WEST HARTFORD RD

5-POMFRET RD

TH-35 HARPER SAVAGE LN

V014
MM 6.967

TH-5 POMFRET RD

VT-14 VT ROUTE 14

0.064

now
0.073

now
6.895
↑

V014
MM 6.904

S0166
MM 0.9

now
0.89

TH-4 QUECHE WEST HARTFORD RD

B8

S0166
MM 0.83

S0179
MM 5.99

0.07

now

0.06

now
1.887
1.870

VT-14 ROUTE 14

0.12

Hartford

WESTFIELD DR

preloaded on Cert 2016-12-19

Moulton, Sara

From: Croft, Johnathan
Sent: Tuesday, December 13, 2016 12:58 PM
To: Moulton, Sara; Grimaldi, Kevan
Subject: I-91 Exit 11 Hartford Ramp A and Ramp F adjustments

Good morning Sara and Kevan,

I have made the mileage changes and RDS coding updates for the I-91 Ramps A and F at Exit 11 in Hartford. Ramp F has been renamed Ramp A, and a portion of Ramp A has been taken out of service and has been deleted from the RDS. Here are the mileage changes that need to be reflected on the Hartford Mileage Certificate:

Elimination of a portion of Ramp A and Reassignment of Ramp F to Ramp A - Total change in mileage Minus 708 feet (0.134 miles)

New mileage for Ramp A is 1773 feet (0.336 miles)

Please let me know if you have any questions regarding this update.

Johnathan Croft
Vermont Agency of Transportation (VTrans)
Mapping Section
(802) 828-2600

johnathan.croft@vermont.gov