

CERTIFICATE OF HIGHWAY MILEAGE

YEAR ENDING FEBRUARY 10, 2007

Vermont Agency of Transportation

Fill out form, make and file copy with the Town Clerk, and mail ORIGINAL, before February 20, 2007 to: Vermont Agency of Transportation, Policy and Planning Division, Drawer 33, Montpelier, VT 05633

FEB 10 2007

We, the Selectmen or Aldermen or Trustees of WARDSBORO in WINDHAM County

Policy & Planning Division

on an oath state that the mileage of highways, according to Title 19, V.S.A, Sec #305, added 1985, is as follows:

PART I - CHANGES TOTALS - Please fill in and calculate totals.

Table with 6 columns: Town Highways, Previous Mileage, Added Mileage, Subtracted Mileage, Total, Scenic Highways. Rows include Class 1, Class 1 Lane, Class 2, Class 3, State Highway, Class 4, Legal Trail, and Total. Handwritten values are present in the Total column.

* Mileage for Class 1 Lane, Class 4, and Legal Trail classifications is NOT included in total.

PART II - INFORMATION AND DESCRIPTION OF CHANGES SHOWN ABOVE.

- 1. NEW HIGHWAYS: Please attach Selectmen's "Certificate of Completion and Opening"
2. DISCONTINUED: Please attach SIGNED copy of proceedings (minutes of meeting)
3. RECLASSIFIED/REMEASURED: Please attach SIGNED copy of proceedings (minutes of meeting)
4. SCENIC HIGHWAYS: Please attach a copy of order designating/discontinuing Scenic Highways

IF THERE ARE NO CHANGES IN MILEAGE: Check box and sign below. []

PART III - SIGNATURES - PLEASE SIGN.

Selectmen/ Aldermen/ Trustees Signatures: [Handwritten signatures]

T/C/V Clerk Signature: [Handwritten signature] Date Filed: 2-6-2007

Please sign ORIGINAL and return it for Transportation signature.

AGENCY OF TRANSPORTATION APPROVAL: Signed copy will be returned to T/C/V Clerk.

APPROVED: [Signature] DATE: 4/10/2007
Representative, Agency of Transportation

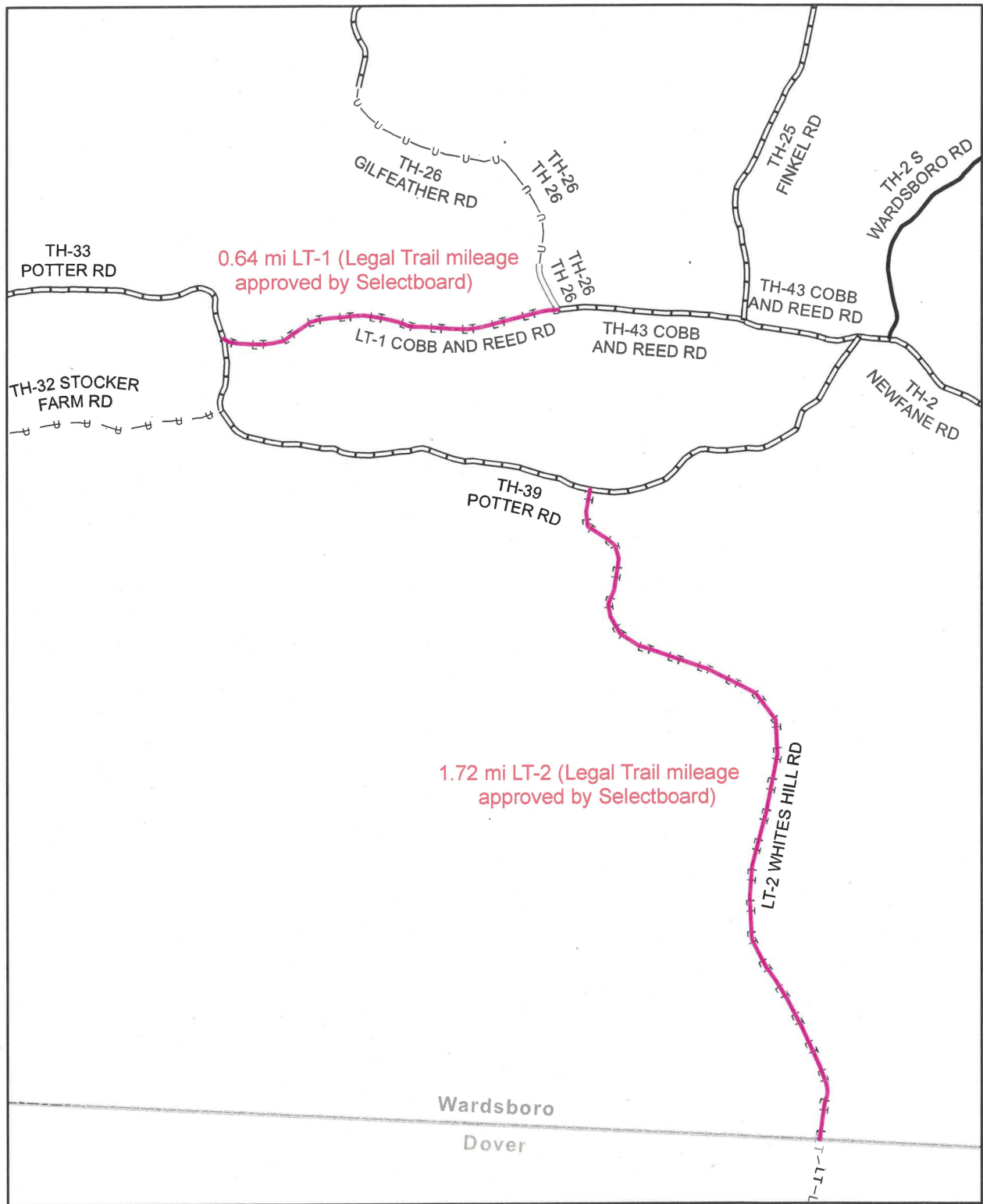

Mileage Certificate Change 2007 -- WARDSBORO

Mapping Unit
 Policy & Planning Division
 Vermont Agency of Transportation -- March 2007



**TOWN OF WARDSBORO
P.O. Box 48
71 Main Street
Wardsboro, VT 05355**

Vermont
Agency of Transportation

MAR 12 2007

Policy & Planning Division

8 March 2007

Sara Moulton
State of Vermont
Policy & Planning Division-Mapping Unit
1 National Life Drive, Drawer 33
Montpelier, VT 05633-5001

RE: Annual Certificate of Highway Mileage – Legal Trail Mileage Discrepancy

Dear Ms. Moulton;

Please find enclosed the town's annual certificate of highway mileage, signed by the board of selectmen, dated 2-6-2007.

You returned it to the board on February 9, 2007 concerning a discrepancy of mileage for legal trails. The town submitted a total of 2.36 miles and your records indicated 2.14. It is my understanding that the town's chairman of the selectmen, Peter Sebastian, spoke to you recently regarding this matter and that you resolved it by agreeing with the town's mileage figure.

If you have any questions or comments, I can be reached at 802-896-6055, Monday thru Thursday from 9 to noon and 1 to 4:30 pm.

Sincerely,

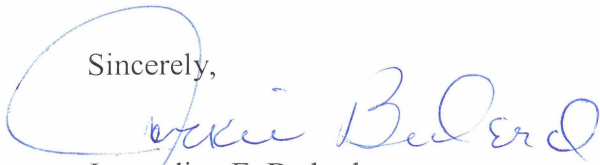

Jacqueline E. Bedard,
Clerk, Board of Selectmen

To: File
From: Sara Moulton, GIS Specialist
Date: 23 February 2007

Subject: Wardsboro Legal Trails

In response to my letter dated 9 February 2007 asking the town for clarification about the distribution of the mileage of the Legal Trails in Wardsboro, I received a telephone call on 21 February 2007 from Peter Sebastian, Selectboard Chair.

He stated that he had personally measured the trails using a measuring wheel, and that the distribution of the mileage for the trails was:

LT-1 0.64 mi
LT-2 1.72 mi

State of Vermont
Policy & Planning Division-Mapping Unit
1 National Life Drive, Drawer 33
Montpelier, VT 05633-5001
<http://www.aot.state.vt.us>

Agency of Transportation

Telephone: 802-828-2109
Fax: 802-828-2334
Email: sara.moulton@state.vt.us

February 9, 2007

Chairperson, Board of Selectmen
Wardsboro, c/o Town Clerk
PO Box 48
Wardsboro, VT 05355

Dear Town Clerk and Selectboard:

Thank you for sending your 2007 Certificate of Highway Mileage. I need to follow up on the 2.36 miles of Legal Trail mileage that was entered on the certificate. Based on our records, we can account for a total of 2.14 miles of Legal Trail.

I've enclosed a summary of our records which indicates that Wardsboro has two Legal Trails with the following approximate mileage distribution: LT-1 0.69 miles
LT-2 1.45 miles.

It would be helpful if the town could provide clarification about the distribution of the mileage of the Legal Trails in Wardsboro and documentation regarding the additional mileage.

If you have any questions, please call me at 802-828-2109 or send e-mail to sara.moulton@state.vt.us

Thank you.

Sincerely,

Sara Moulton

Sara Moulton
Mapping & GIS Specialist

CERTIFICATE OF HIGHWAY MILEAGE

YEAR ENDING FEBRUARY 10, 2007

Vermont Agency of Transportation

Fill out form, make and file copy with the Town Clerk, and mail ORIGINAL, before February 20, 2007 to: Vermont Agency of Transportation, Policy and Planning Division, Drawer 33, Montpelier, VT 05602

FEB 10 2007

We, the Selectmen or Aldermen or Trustees of WARDSBORO in WINDHAM County

on an oath state that the mileage of highways, according to Title 19, V.S.A, Sec #305, added 1985, is as follows:

PART I - CHANGES TOTALS - Please fill in and calculate totals.

Table with 6 columns: Town Highways, Previous Mileage, Added Mileage, Subtracted Mileage, Total, Scenic Highways. Rows include Class 1, Class 1 Lane, Class 2, Class 3, State Highway, Class 4, Legal Trail, and Total.

* Mileage for Class 1 Lane, Class 4, and Legal Trail classifications is NOT included in total.

PART II - INFORMATION AND DESCRIPTION OF CHANGES SHOWN ABOVE.

- 1. NEW HIGHWAYS: Please attach Selectmen's "Certificate of Completion and Opening"
2. DISCONTINUED: Please attach SIGNED copy of proceedings (minutes of meeting)
3. RECLASSIFIED/REMEASURED: Please attach SIGNED copy of proceedings (minutes of meeting)
4. SCENIC HIGHWAYS: Please attach a copy of order designating/discontinuing Scenic Highways

IF THERE ARE NO CHANGES IN MILEAGE: Check box and sign below. []

PART III - SIGNATURES - PLEASE SIGN.

Selectmen/ Aldermen/ Trustees Signatures:

Handwritten signatures of Peter Selenta, Victor Gaudreau, and others.

T/C/V Clerk Signature:

Date Filed:

2-6-2007

Please sign ORIGINAL and return it for Transportation signature.

AGENCY OF TRANSPORTATION APPROVAL: Signed copy will be returned to T/C/V Clerk.

APPROVED:

Representative, Agency of Transportation

DATE:

State of Vermont
Agency of Transportation
Policy and Planning Division - Mapping Unit

1 National Life Drive, Drawer 33
Montpelier, VT 05633-5001
<http://www.aot.state.vt.us>

Telephone: 802-828-2109
Fax: 802-828-2334
Email: sara.moulton@state.vt.us

Chairperson, Board of Selectmen
Wardsboro, c/o Town Clerk
PO Box 48
Wardsboro, VT 05355

January 2007

Below is a table summarizing the information on Legal Trails that is on file in the Mapping Unit. Act 178 of 2006 requires the measurement of trails be included on the sworn statement, the Mileage Certificate. To assist in this, we are providing a summary of the information we have on the trails that are shown on the Town Highway Maps, including mileage and former town highway number. The majority of trails were created by the reclassification of a town highway into a trail, thus the legal trail inherited an official measurement. The former town highway number is included in the FORMER_RTNAME column, and the former town highway mileage is in the AOTMILES column for each trail. VTrans has assigned a trail number, such as LT-1, to make the trails distinct. If the AOTMILES column is zero, the municipality will need to provide a mileage. The column ARCMILES contains the mileage as generated by the geometry of the trail, as digitized in the Geographic Information System (GIS). The mileages included in this table should be used as approximate mileages and the municipality should measure or verify the mileage of these trails.

A map showing the Legal Trail numbers and mileage has been included with this packet to further assist in this project. Any additional trails that exist should be added to the Mileage Certificate, as defined in the provided guidelines. Please feel free to contact us with any questions or comments regarding the above information, or the Mileage Certificates in general.

HIGHWAY / LEGAL TRAIL IDENTIFIER (RTNAME)	AOTMILES	ARCMILES	FORMER TOWN HIGHWAY NUMBER (FORMER_RTNAME)
LT-1	0.00	0.69	-
LT-2	0.00	1.45	-

If you have any questions, please call me at 802-828-2109 or send email to sara.moulton@state.vt.us

Thank you.

Sara Moulton

Sara Moulton
Mapping and GIS Specialist

LEGAL TRAIL NUMBER LENGTH IN MILES

LT-1	0
LT-2	0
LT-21	1
LT-23	1.35
LT-24	0.4
LT-8	0.29

In neighboring towns

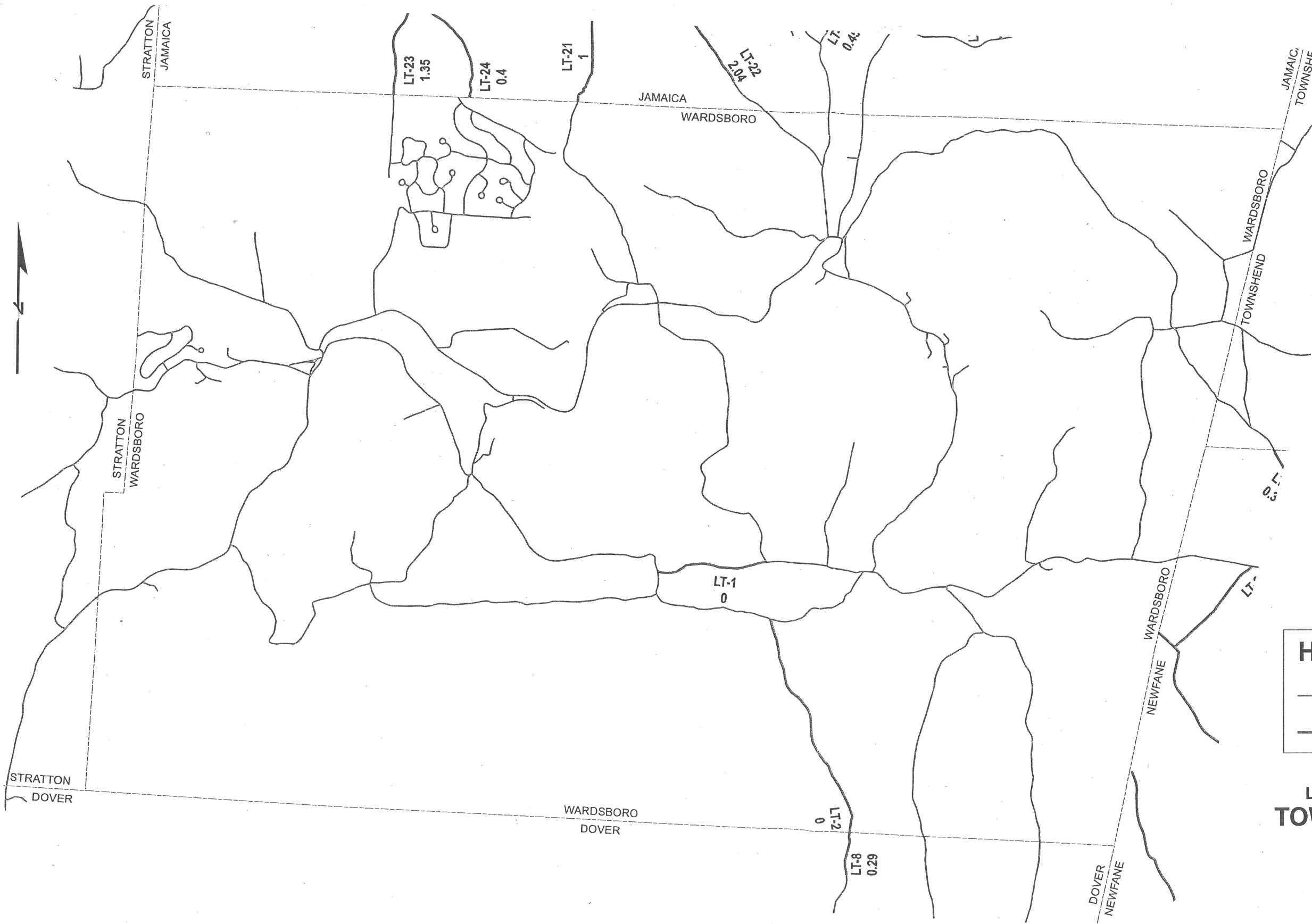

HIGHWAYS

— PUBLIC HIGHWAYS

— LEGAL TRAILS

**LEGAL TRAIL VERIFICATION
TOWN OF WARDBORO**

WINDHAM COUNTY

Map generated: November, 2006

SCALE: 1:38282

