

CERTIFICATE OF HIGHWAY MILEAGE
YEAR ENDING FEBRUARY 10, 2009

Fill out form, make and file copy with the Town Clerk, and mail ORIGINAL, before February 20, 2009 to: Vermont Agency of Transportation, Policy and Planning Division, One National Life Drive, Montpelier, VT 05633.

We, the members of the legislative body of GRAFTON in WINDHAM County

on an oath state that the mileage of highways, according to Vermont Statutes Annotated, Title 19, Section 305, added 1985, is as follows:

PART I - CHANGES TOTALS - Please fill in and calculate totals.

Table with 6 columns: Town Highways, Previous Mileage, Added Mileage, Subtracted Mileage, Total, Scenic Highways. Rows include Class 1, Class 1 Lane, Class 2, Class 3, State Highway, Class 4, Legal Trail, and Total.

* Mileage for Class 1 Lane, Class 4, and Legal Trail classifications is NOT included in total.

PART II - INFORMATION AND DESCRIPTION OF CHANGES SHOWN ABOVE.

- 1. NEW HIGHWAYS: Please attach Selectmen's "Certificate of Completion and Opening".
2. DISCONTINUED: Please attach SIGNED copy of proceedings (minutes of meeting).
3. RECLASSIFIED/REMEASURED: Please attach SIGNED copy of proceedings (minutes of meeting).
4. SCENIC HIGHWAYS: Please attach a copy of order designating/discontinuing Scenic Highways.

IF THERE ARE NO CHANGES IN MILEAGE: Check box and sign below. []

PART III - SIGNATURES - PLEASE SIGN.

Selectmen/ Aldermen/ Trustees Signatures:

Handwritten signatures of selectmen/aldermen/trustees.

T/C/V Clerk Signature:

Handwritten signature of T/C/V Clerk.

Date Filed:

2/9/09

Please sign ORIGINAL and return it for Transportation signature.

AGENCY OF TRANSPORTATION APPROVAL:

Signed copy will be returned to T/C/V Clerk.

APPROVED:

Handwritten signature and printed name of Representative, Agency of Transportation.

DATE:

4/2/2009

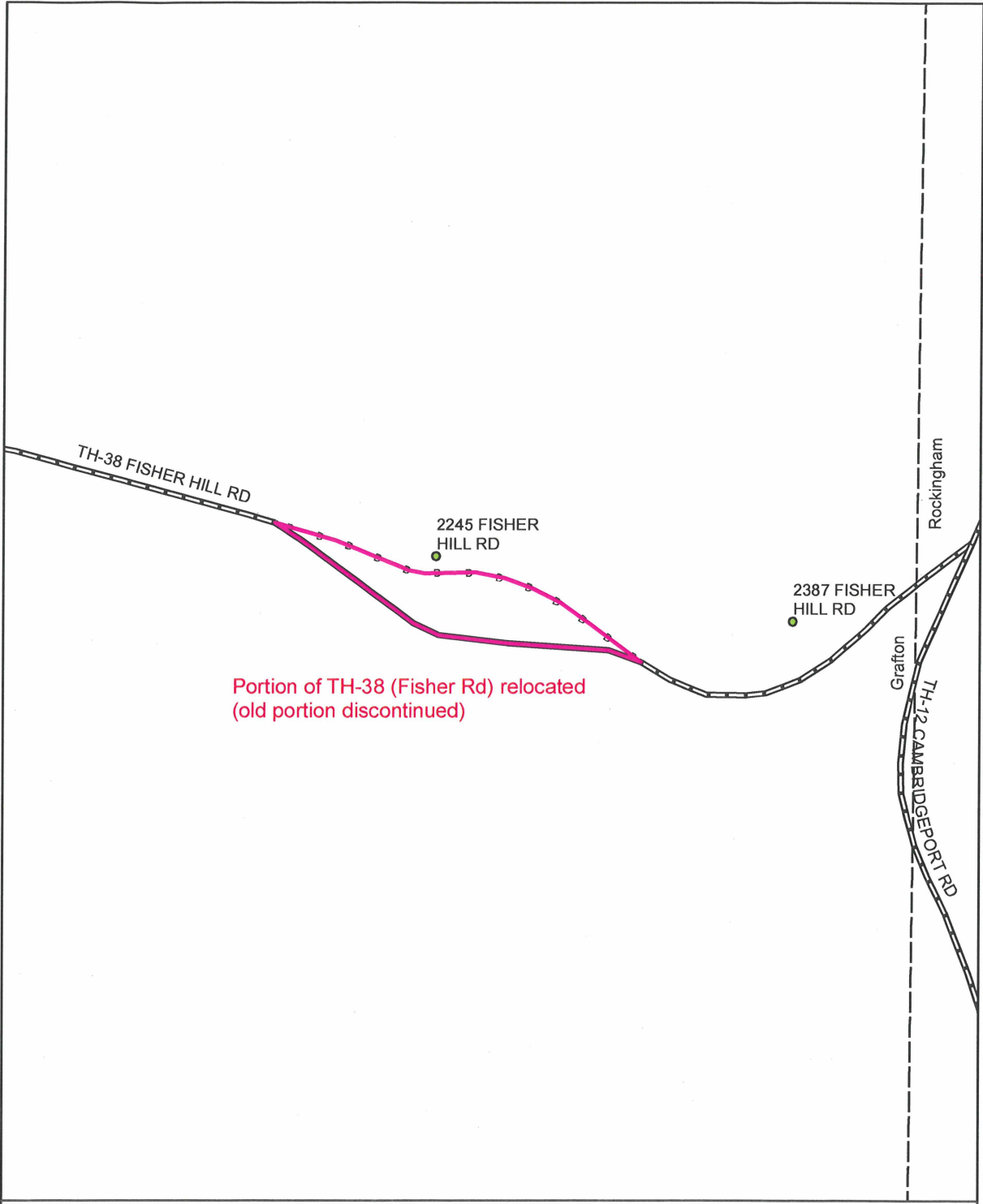

**Mileage Certificate Change 2009
GRAFTON**

Mapping Unit
Policy & Planning Division
Vermont Agency of Transportation -- March 2009



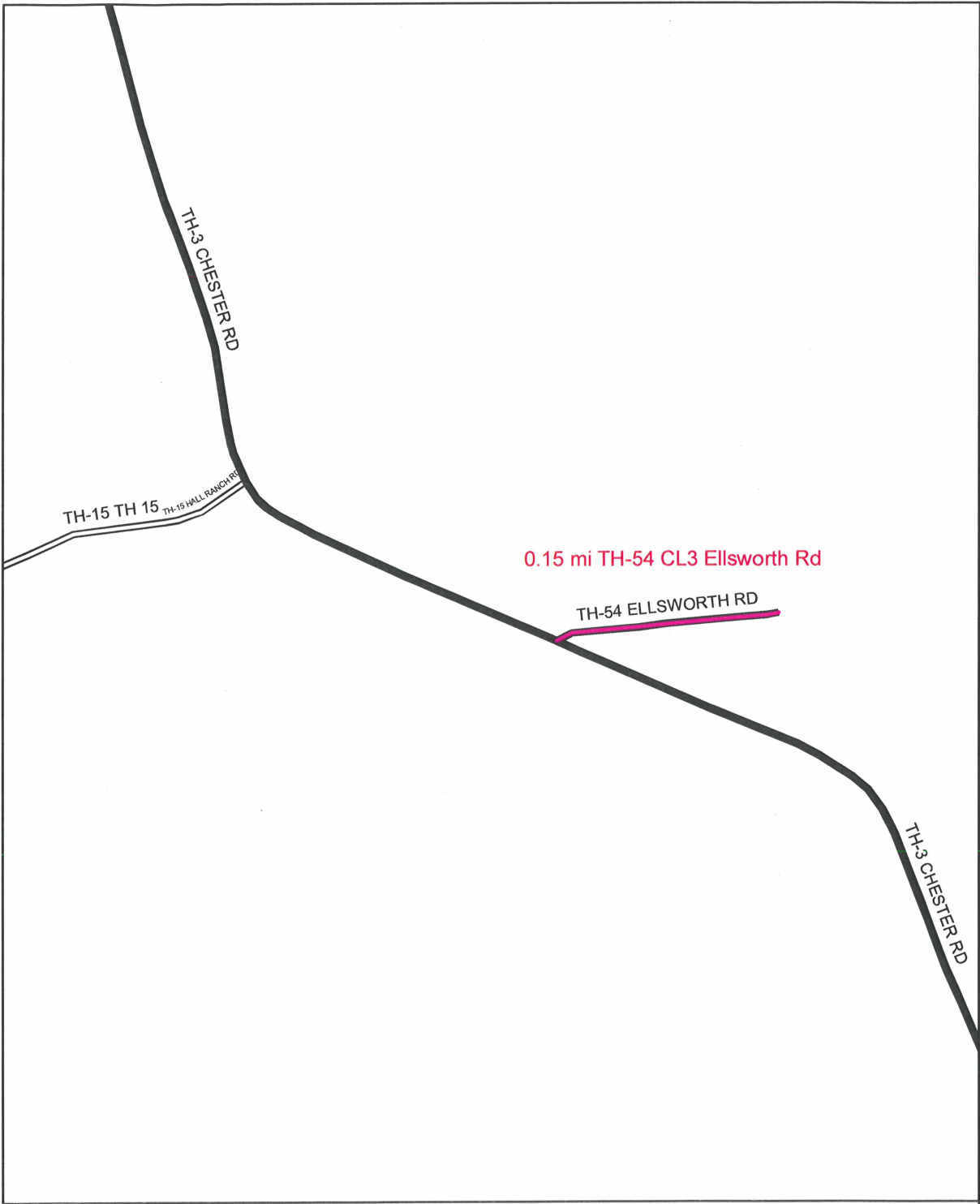

**Mileage Certificate Change 2009
GRAFTON**

Mapping Unit
Policy & Planning Division
Vermont Agency of Transportation -- March 2009



TH # 54
 0.15 miles Class III
 Seems to have been dropped off.

TOWN	LENGTH IN MILES	HWY. CLASS	CLASS
6	3.960	3	4
7	2.190		
8	2.130		
9	0.020		
10	0.850		
11	0.930		
12	0.060	(0.140)	
13		(0.500)	
14	0.150		
15	1.430	(0.540)	
16	0.100		
17	0.200		
18	0.950		
19	0.530		
20	2.950		
21	0.310	(0.190)	
22	0.140		
23	0.220	(0.590)	
24	0.210	(0.590)	
25	1.170		
26	0.200		
28	0.200	(0.190)	
29	1.800		
30	0.050		
31	0.270		
32		(0.280)	
33		(0.300)	
34	0.080	(0.460)	
35	0.380		
36	0.230	(0.180)	
37	0.510		
38	2.500		
39	1.770		
41		(0.650)	
42	0.680	(0.620)	
43	2.080	(2.820)	
44	0.270	(0.180)	
45	0.180	(0.620)	
46	0.710		
47	0.150		
48	0.110		
49	0.060		
50	0.050		
51	0.050		
52	0.030		
53	0.160		
TOTAL	30.820	8.880	

MILEAGE SUMMARY

CLASS 2	
TH-1	9.770
TH-2	3.730
TH-3	4.540
TH-4	0.260
TOTAL CLASS 2	18.300

CLASS 3	
TOTAL CLASS 3	30.820
TOTAL TOWN	49.120

TOTAL, TRAVELED HIGHWAYS, FEB. 10, 2007: 49.120
 (Excludes Class 4 Mileage)

- HIGHWAYS**
- INTERSTATE
 - U.S. ROUTE
 - STATE ROUTE
 - CLASS 1
 - CLASS 2
 - CLASS 3
 - CLASS 4
 - INTERSTATE OR DIVIDED HIGHWAY
 - STATE - HARD SURFACE OR PAVED
 - TOWN - HARD SURFACE OR PAVED
 - GRAVEL
 - SOIL OR GRADED AND DRAINED EARTH
 - UNIMPROVED OR PRIMITIVE
 - IMPASSABLE OR UNTRAVELED
 - LEGAL TRAIL
 - DISCONTINUED
 - HIGHWAY CLASS CHANGE
 - RAILROAD
- PUBLIC LAND**
- POLITICAL SUBDIVISIONS
 - STATE BOUNDARY
 - COUNTY BOUNDARY
 - TOWN BOUNDARY
 - VILLAGE BOUNDARY
 - URBAN COMPACT
 - WATER BODIES
 - OPEN WATER
 - SWAMP
 - STREAM OR BROOK
 - BRIDGE OR CULVERT
 - BRIDGE OR CULVERT GREATER THAN 20'
 - BRIDGE OR CULVERT 6' - 20'
 - STATE BRIDGE IDENTIFIER
 - TOWN BRIDGE IDENTIFIER
- FEDERAL CLASSIFICATION IDENTIFIER**
- FAU URBAN ARTERIAL OR COLLECTOR
 - MA MINOR ARTERIAL
 - MIC MAJOR COLLECTOR
 - MNC MINOR COLLECTOR
 - PA PRINCIPAL ARTERIAL

DISCLAIMER
 The untraveled highways (dashed-out town highways), discontinued highways, and legal trails shown hereon are those of which the Agency of Transportation has record; others may exist.
 Highway and bridge data by the Agency of Transportation, Policy & Planning Division. All other data from the Vermont Center for Geographic Information.

Vermont State Plane Coordinate System
 North American Datum of 1983
 SPCS_Zone_Identifier: 4400
 Geographic Reference System: 80
 4,000-meter grid, Easting - Northing

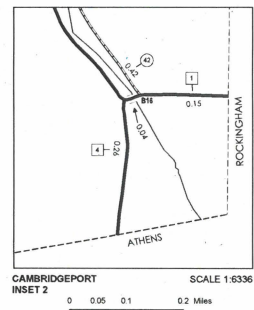
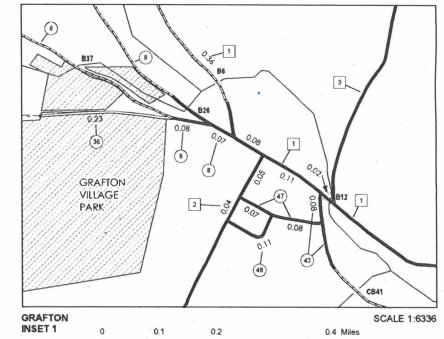
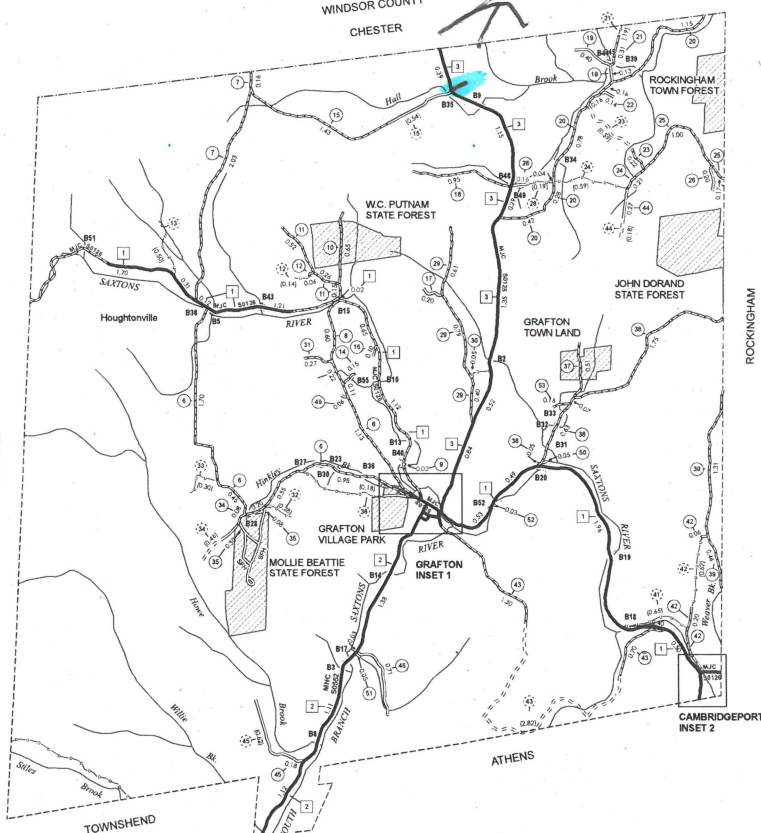

VERMONT
GENERAL HIGHWAY MAP
Town of Grafton
 WINDHAM COUNTY
 Transportation District #2

Prepared by the
 Vermont Agency of Transportation
 Policy & Planning Division
 in cooperation with
 U.S. Department of Transportation
 Federal Highway Administration

Mileage as of Feb. 10, 2007
 Map generated October, 2007

SCALE: 1:31680

INSET 2
CAMBRIDGEPORT

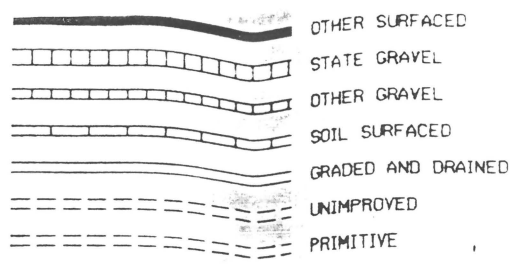

VERMONT GENERAL HIGHWAY MAP

TOWN OF GRAFTON

PREPARED BY THE
VERMONT AGENCY OF TRANSPORTATION
PLANNING DIVISION

IN COOPERATION WITH THE
U.S. DEPARTMENT OF TRANSPORTATION
FEDERAL HIGHWAY ADMINISTRATION

1986

SCALE

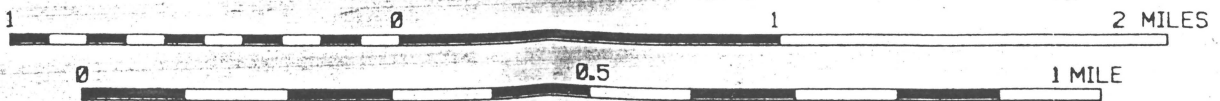

SCALE FOR INSETS (UNLESS OTHERWISE NOTED)

500,000

COUNTY
ER

(A) ADDITION
T. 54
PROVISIONAL
to 15 C13

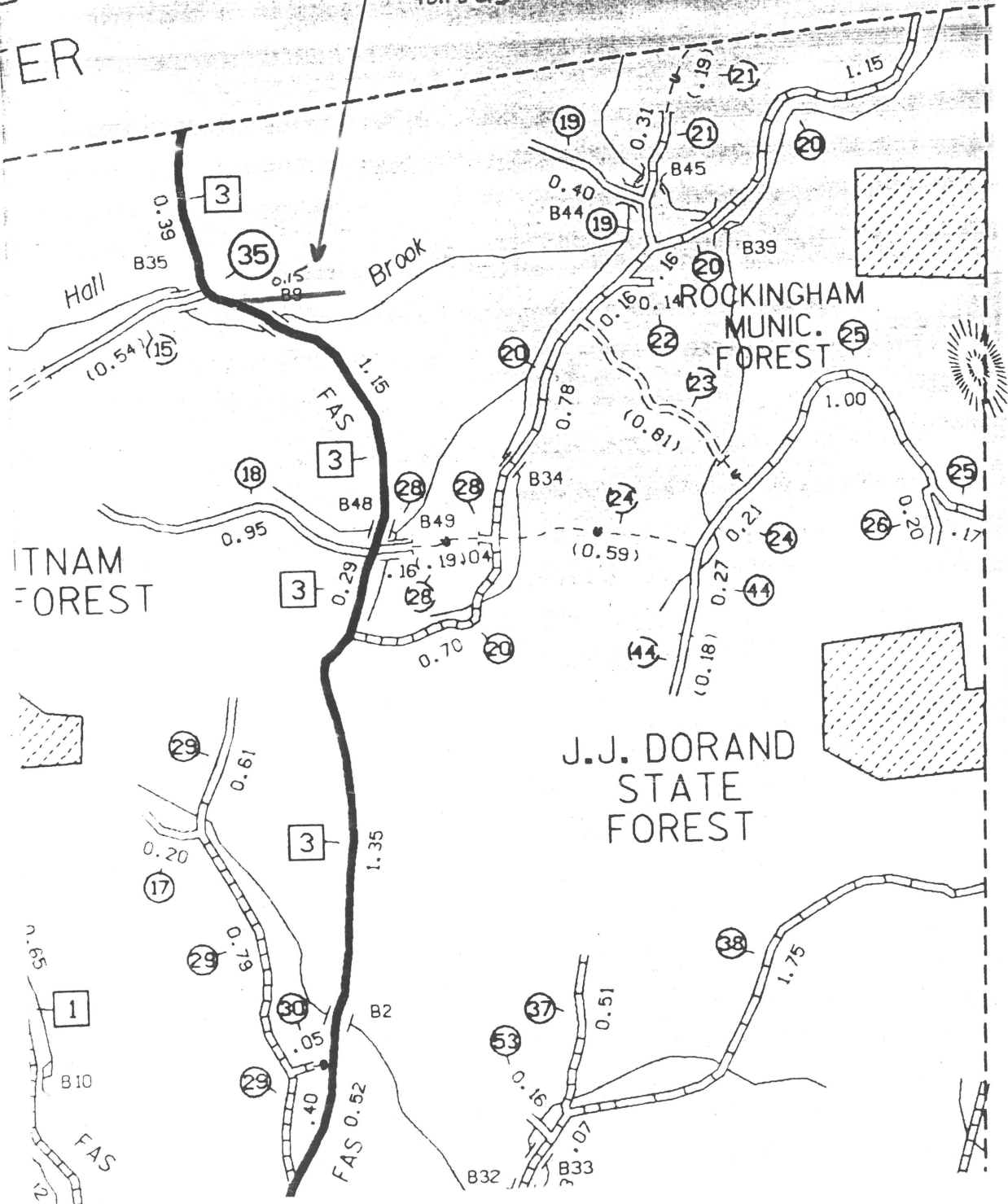

,000

14	0.150	
15	1.430	(0.540)
16	0.100	
17	0.200	
18	0.950	
19	0.530	
20	2.950	
21	0.310	(0.190)
22	0.140	
23		(0.810)
24	0.210	(0.590)
25	1.170	
26	0.200	
28	0.200	(0.190)
29	1.800	
30	0.050	
31	0.270	
32		(0.280)
33		(0.300)
34	0.080	(0.460)
35	0.380	
36	0.230	(0.180)
37	0.510	
38	2.500	
39	1.770	
41		(0.650)
42	0.680	(0.620)
43	1.380	(3.520)
44	0.270	(0.180)
45	0.120	(0.680)
46	0.710	
47	0.150	
48	0.110	
49	0.060	
50	0.050	
51	0.050	
52	0.030	
53	0.160	
6	3.960	
7	2.190	
8	2.130	
9	0.020	

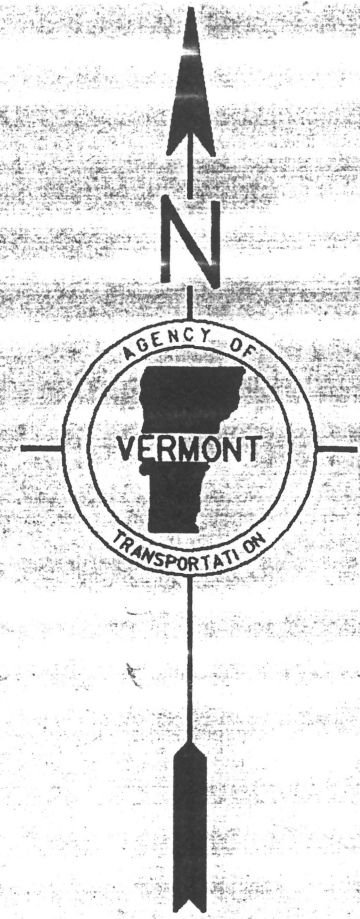

TOTAL ~~29.840~~ 9.830

(A) Prov. 54 0.15

,000

FEB 03 2009

STATEMENT OF NOTICE
CERTIFICATE OF MAILING, POSTING AND PUBLICATION

Policy & Planning Division

I, Jacqueline LeBlanc, Town Administrator for the Grafton Selectboard do hereby certify that I mailed by certified mail on October 29, 2008, the attached Notice of Discontinuance and Alteration of a portion of Fisher Hill to:

Priscilla Clough
2245 Fisher Hill Road
Grafton, Vermont 05146

David and Priscilla Lambert
Pleasant Valley Road
Bellows Falls, Vermont 05101

Grafton Planning Commission
P.O. Box 180
Grafton, Vermont 05146

Rockingham Selectboard
P.O. Box 370
Bellows Falls, Vermont 05101

I further certify that I posted the attached notice on October 29, 2008 in the Office of the Grafton Town Clerk, the Grafton Town Office and the Grafton Post Office Bulletin Board.

The attached notice was published in The Message, a local newspaper of general circulation in the Town of Grafton for the week of November 5-12, 2008, a date not less than 10 days prior to the hearing date of December 1, 2008.

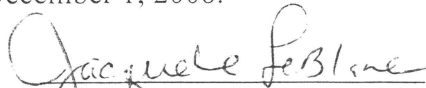
Jacqueline LeBlanc
Town Administrator to the
Grafton Selectboard

TOWN CLERK'S OFFICE, GRAFTON, VERMONT
Received for record Jan 13, 2009
at 10 o'clock 30 minutes A. M.
and recorded in Book 50 Page 669
Attest Kira Record
Town Clerk

EXCERPT OF MINUTES OF GRAFTON SELECTBOARD MEETING
OCTOBER 13, 2008

I. Jacqueline LeBlanc, Administrative Assistant to the Grafton Selectboard hereby certify that following resolution was adopted by the Grafton Selectboard on October 13, 2008:

RESOLVED that the Town of Grafton discontinue a portion of Fisher Hill and alter a portion of Fisher Hill, comprising approximately 800 feet of road, pursuant to the agreement between the Town of Grafton, Priscilla Clough and David and Priscilla Lambert dated October 13, 2008.

Dated this 9th day of January 2009.

Jacqueline LeBlanc
Town Administrator for
The Grafton Selectboard

TOWN CLERK'S OFFICE, GRAFTON, VERMONT
Received for record Jan 13, 2009
at 10 o'clock 30 minutes A.M.
and recorded in Book 50 Page 666
Attest Kim Record
Town Clerk

REPORT OF FINDINGS AND ORDER

On December 1, 2008 at 3 p.m. pursuant to statutory notice and publication, four of the five members of the Selectboard of the Town of Grafton did examine that portion of the highway premises proposed to be discontinued and laid out or altered at Fisher Hill Road, so-called, and heard persons interested in such discontinuance and laying out or alteration of a portion of Fisher Hill Road. See attached Statement of Notice.

The Selectboard hereby judge that the public good, necessity and convenience of the inhabitants of the Town of Grafton require that portion of the highway premises be discontinued and laid out or altered all as shown on that survey commissioned for the within purpose of describing the discontinued and laid out or altered portion of Fisher Hill Road captioned "Plan of Fisher Hill Road Alteration, Vicinity of 2245 Fisher Hill Rd, Grafton, Vermont", by DiBernardo Associates, LLC dated Nov. 28, 2008, to be recorded herewith.

The discontinued portion of Fisher Hill Road as depicted on the above referenced survey is described as follows:

See attached description.

The laid out or altered portion of Fisher Hill Road as depicted on the above referenced survey is described as follows:

See attached description.

This discontinuance and laying out or alteration of a portion of Fisher Hill Road have been made at the request of Priscilla Clough, David Lambert and Priscilla Lambert and no damages are due to any party or landowner as a result of the discontinuance and alteration. Title to the discontinued portion described above shall vest in Priscilla Clough, the record title holder of both sides of the discontinued portion of the highway. Pursuant to consent of the landowner, possession of the laid out or altered portion of Fisher Hill Road by the Town of Grafton is effective immediately and open for travel.

Dated this 2nd day of December 2008.

GRAFTON SELECTBOARD



Ann Craven

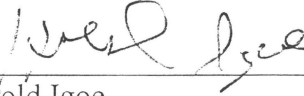

Harold Igoe

Lisa Record

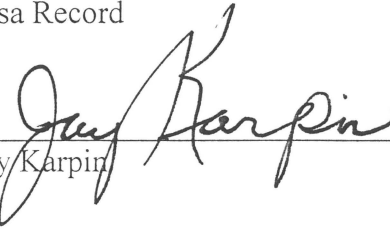

Jay Karpin

TOWN CLERK'S OFFICE, GRAFTON, VERMONT

Received for record Jan 13, 2009

at 10 o'clock 30 minutes A. M.

and recorded in Book 50 Page 662-665

Attest Kim Record
Town Clerk

DESCRIPTION OF DISCONTINUED PORTION OF FISHER HILL ROAD

Beginning at a point marked "A" on the hereinafter described survey, said point lies in the existing centerline of Fisher Hill Road, so-called, said point of beginning is at Vermont State Plane Coordinates Northing 253953.5632 and Easting 1624067.1666 based on North American Datum 1983, said point bears S 38° 01' 12" W 32.13 feet from a 5/8 inch diameter rebar set in a stone wall corner in the northerly bounds of Fisher Hill Road and S 03° 36' 41" W 29.42 feet from a 5/8 inch diameter rebar set in a stone wall in the northerly bounds of said Fisher Hill Road;

Thence the following courses along the present centerline of said Fisher Hill Road:

S 75° 05' 15" E	151.96 feet to a point;
S 74° 43' 53" E	113.41 feet to a point;
S 76° 51' 43" E	300.50 feet to a point;
S 76° 15' 27" E	52.10 feet to a point;
S 60° 13' 09" E	79.62 feet to a point;
S 40° 59' 52" E	121.43 feet to a point marked "B" on the hereinafter

described survey, said point is at Vermont State Plane Coordinates Northing 253672.7189 and Easting 1624815.4215 based on North American Datum 1983.

Reference is made to a plan entitled, "**PLAN OF FISHER HILL ROAD ALTERATION VICINITY OF 2245 FISHER HILL ROAD GRAFTON, VERMONT**" Dated November 28, 2008, Drawing No. 1010-1 prepared by DiBernardo Associates, LLC, Licensed Land Surveyors, Bellows Falls, VT to be filed with the Grafton Town Clerk's Office.

DESCRIPTION OF LAID OUT OR ALTERED PORTION OF FISHER HILL ROAD

Beginning at a point marked "A" on the hereinafter described survey, said point lies in the existing centerline of Fisher Hill Road, so-called, said point of beginning is at Vermont State Plane Coordinates Northing 253953.5632 and Easting 1624067.1666 based on North American Datum 1983, said point bears S 38° 01' 12" W 32.13 feet from a 5/8 inch diameter rebar set in a stone wall corner in the northerly bounds of Fisher Hill Road and S 03° 36' 41" W 29.42 feet from a 5/8 inch diameter rebar set in a stone wall in the northerly bounds of said Fisher Hill Road;

Thence the following courses along the newly laid out centerline of said Fisher Hill Road, the road being approximately 49.5 feet in width;

S 53° 40' 36" E	329.07 feet to a point;
S 64° 35' 13" E	48.64 feet to a point;
S 83° 21' 38" E	121.18 feet to a point;
S 85° 27' 50" E	202.98 feet to a point;

S73° 16' 56" E 121.62 feet to a point marked "B" on the hereinafter described survey, said point is at Vermont State Plane Coordinates Northing 253672.7189 and Easting 1624815.4215 based on North American Datum 1983. Said road alteration laid out at 3 rods or 49.5 feet wide.

Reference is made to a plan entitled, "**PLAN OF FISHER HILL ROAD ALTERATION VICINITY OF 2245 FISHER HILL ROAD GRAFTON, VERMONT**" Dated November 28, 2008, Drawing No. 1010-1 prepared by DiBernardo Associates, LLC, Licensed Land Surveyors, Bellows Falls, VT to be filed with the Grafton Town Clerk's Office.

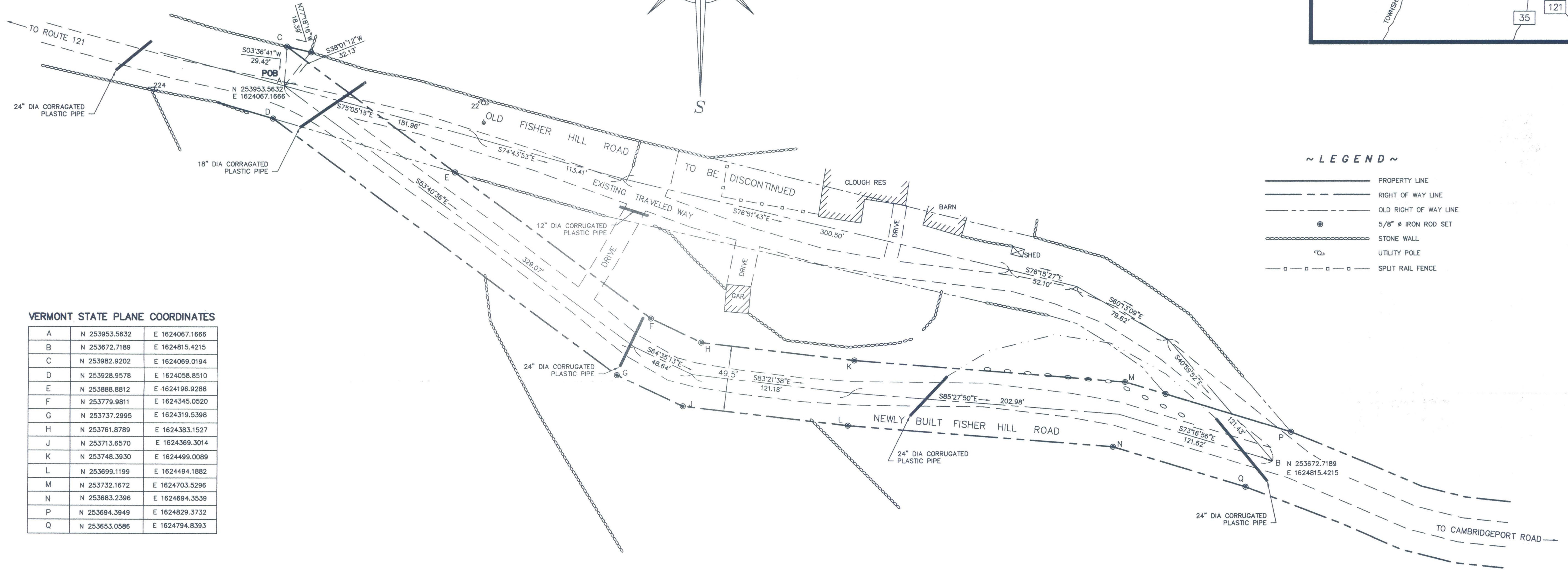
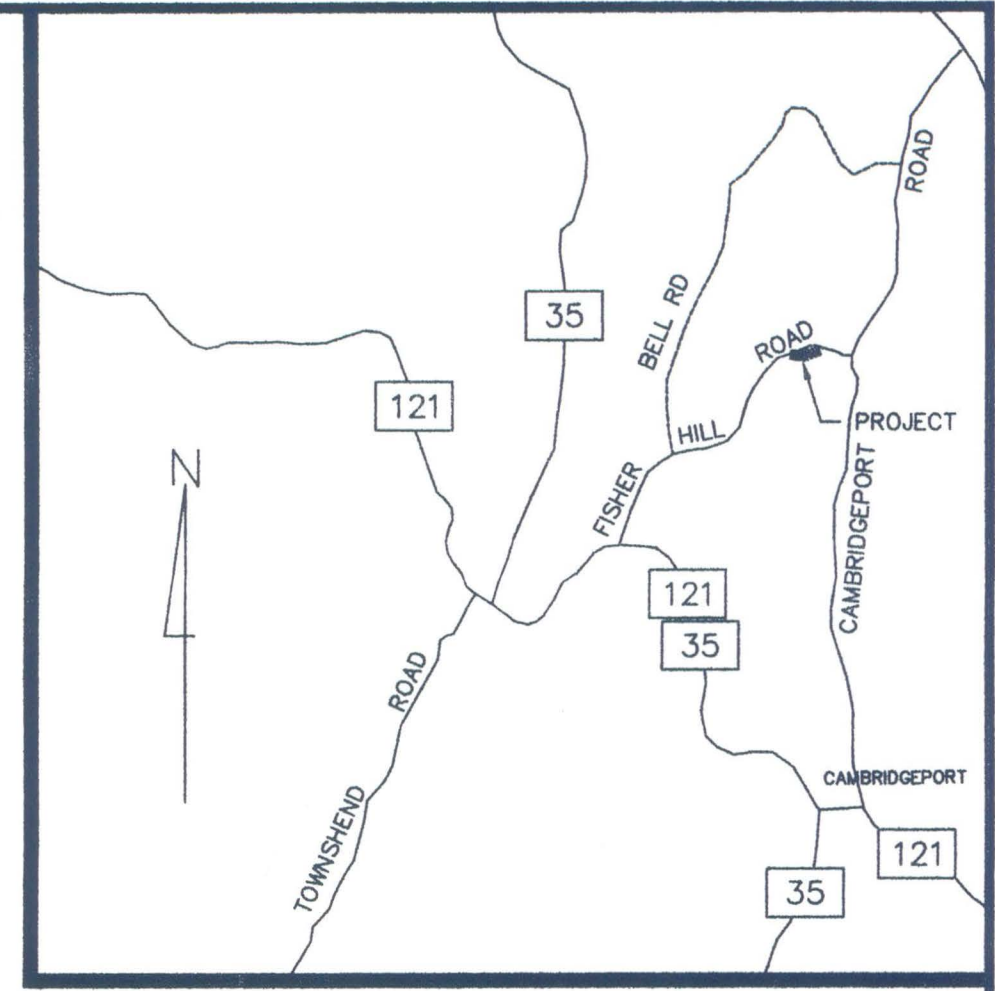
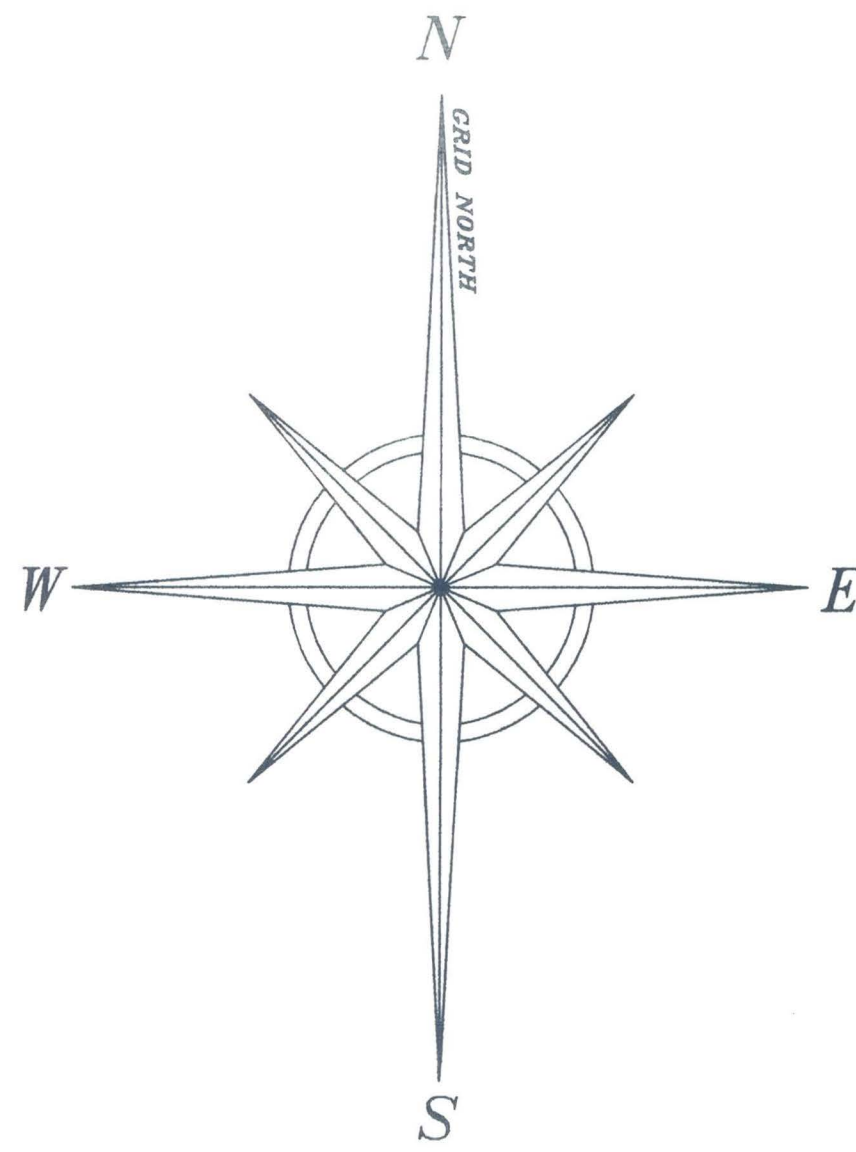

~ LEGEND ~

—	PROPERTY LINE
- - -	RIGHT OF WAY LINE
- · - · -	OLD RIGHT OF WAY LINE
●	5/8" IRON ROD SET
— · — · —	STONE WALL
⊕	UTILITY POLE
- · - · - · -	SPLIT RAIL FENCE

VERMONT STATE PLANE COORDINATES

A	N 253953.5632	E 1624067.1666
B	N 253672.7189	E 1624815.4215
C	N 253982.9202	E 1624069.0194
D	N 253928.9578	E 1624058.8510
E	N 253888.8812	E 1624196.9288
F	N 253779.9811	E 1624345.0520
G	N 253737.2995	E 1624319.5398
H	N 253761.8789	E 1624383.1527
J	N 253713.6570	E 1624369.3014
K	N 253748.3930	E 1624499.0089
L	N 253699.1199	E 1624494.1882
M	N 253732.1672	E 1624703.5296
N	N 253683.2396	E 1624894.3539
P	N 253694.3949	E 1624829.3732
Q	N 253653.0586	E 1624794.8393

~ NOTES ~

- METHOD OF SURVEY: NIKON DTM-520 TOTAL STATION & LEICA 1200 GPS.
- BEARINGS ARE REFERENCED TO VERMONT STATE PLANE COORDINATE SYSTEM.
- DIBERNARDO ASSOCIATES IS NOT RESPONSIBLE FOR PROPERTY DESCRIPTIONS PREPARED BY OTHER PERSONS FOR CONVEYANCE OF THE PROPERTY SHOWN HEREON.

~ CERTIFICATION ~

IN MY OPINION AND TO THE BEST OF MY KNOWLEDGE THIS SURVEY AND PLAN IS CONSISTENT WITH AND PHYSICAL EVIDENCE FOUND IN THE FIELD. THIS PLAN IS AN EXPRESSION OF PROFESSIONAL OPINION REGARDING THE EVIDENCE SHOWN, AND DOES NOT REPRESENT A WARRANTY OR A GUARANTEE.

JOSEPH A. DIBERNARDO VT LLS. NO. 715

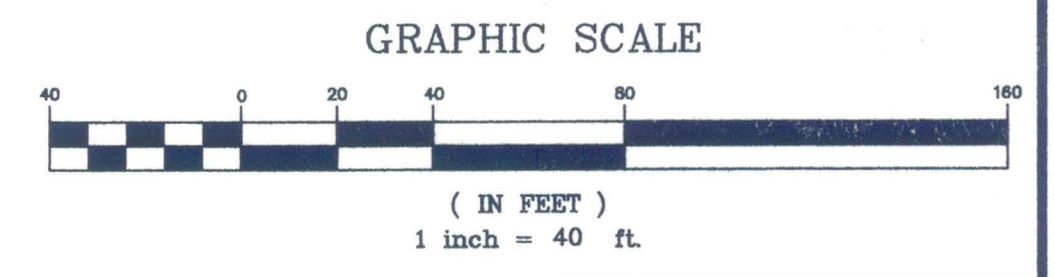

PLAN OF
FISHER HILL ROAD ALTERATION
 VICINITY OF 2245 FISHER HILL RD
 GRAFTON, VERMONT

DIBERNARDO ASSOCIATES, LLC
 VT NH
 LICENSED LAND SURVEYORS
 802-463-3031 440 ROCKINGHAM ROAD 803-950-6609
 P.O. BOX 62
 BELLOWS FALLS, VT 05101

DATE NOV. 28, 2008 SCALE AS SHOWN
 DRAWN BY JW, AD CK'D BY JD
 SURVEYED BY JD, JW
 DWG. NO. 1010-1

STATE OF VERMONT
 LICENSED LAND SURVEYOR
 JOSEPH A. DIBERNARDO
 NO. 715

~ REVISIONS ~

1.	12-11-08	REVISED LINES C-E-F	JW
NO.	DATE	DESCRIPTION	BY

© COPYRIGHT 2008
 DIBERNARDO ASSOCIATES, LLC.