

CERTIFICATE OF HIGHWAY MILEAGE

YEAR ENDING FEBRUARY 10, 2007

JAN 25 2007

Policy & Planning Division

Fill out form, make and file copy with the Town Clerk, and mail ORIGINAL, before February 20, 2007 to: Vermont Agency of Transportation, Policy and Planning Division, Drawer 33, Montpelier, VT 05633.

We, the Selectmen or Aldermen or Trustees of GRAFTON in WINDHAM County

on an oath state that the mileage of highways, according to Title 19, V.S.A, Sec #305, added 1985, is as follows:

PART I - CHANGES TOTALS - Please fill in and calculate totals.

Town Highways	Previous Mileage	Added Mileage	Subtracted Mileage	Total	Scenic Highways
Class 1	0.000				0.000
Class 1 Lane	0.000				
Class 2	18.300			18.300	0.000
Class 3	30.79	30.760	0.06	30.82	0.000
State Highway	0.000				0.000
Class 4	8.910		0.06	8.85	0.000
Legal Trail	0.000				
<b>Total</b>	<b>49.09</b>	<b>49.060</b>		<b>49.120</b>	<b>0.000</b>

\* Mileage for Class 1 Lane, Class 4, and Legal Trail classifications is NOT included in total.

PART II - INFORMATION AND DESCRIPTION OF CHANGES SHOWN ABOVE.

- NEW HIGHWAYS: Please attach Selectmen's "Certificate of Completion and Opening" by S. Moulton 1/26/07
- DISCONTINUED: Please attach SIGNED copy of proceedings (minutes of meeting)
- RECLASSIFIED/REMEASURED: Please attach SIGNED copy of proceedings (minutes of meeting)  
Reclassified 300' on Wyman Hill Road from Class IV to Class III.  
(TH 45) 0.06 mi (S. Moulton 26 Jan 07)
- SCENIC HIGHWAYS: Please attach a copy of order designating/discontinuing Scenic Highways

IF THERE ARE NO CHANGES IN MILEAGE: Check box and sign below. [ ]

PART III - SIGNATURES - PLEASE SIGN.

Selectmen/ Aldermen/ Trustees Signatures:

[Handwritten signatures]

T/C/V Clerk Signature:

[Handwritten signature: Cynthia W. Gibbs]

Date Filed:

1/22/2007

Please sign ORIGINAL and return it for Transportation signature.

AGENCY OF TRANSPORTATION APPROVAL: Signed copy will be returned to T/C/V Clerk.

APPROVED:

Representative, Agency of Transportation

[Handwritten signature: Jonathan Croft]

DATE:

4/10/2007

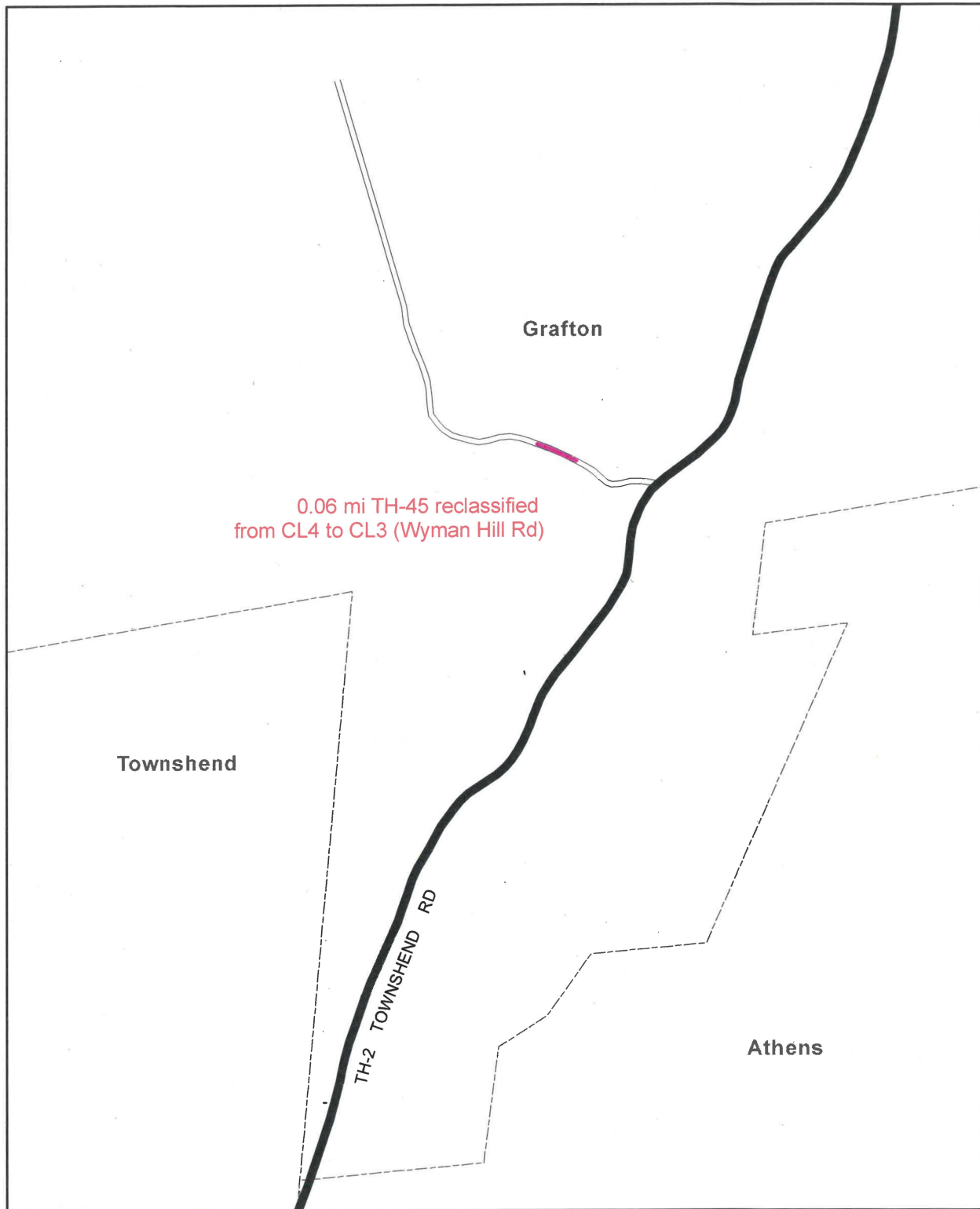

**Mileage Certificate Change 2007 -- GRAFTON**

Mapping Unit  
Policy & Planning Division  
Vermont Agency of Transportation -- January 2007



0  0.2 Miles

PUBLIC HEARING – RECLASSIFICATION OF WYMAN HILL ROAD

DATE: January 5, 2007

CONVENED: 10:05 AM      ADJOURNED 10:30 AM

SELECTMEN PRESENT: Bob Crawford, Harold Igoe, Anna Vesely

SELECTMEN ABSENT: Chris Moore, David Rogers

ALSO PRESENT: Paul Hallock & John Gregory

Discussion of work done on the 300 feet of Wyman Hill Road off from the Townshend Road to be considered for reclassification to Class III from Class IV.

The board agreed along with John Gregory, Road Foreman, that the road was brought up to specs and has sufficient space for the town truck to turn around.

Motion by Igoe and seconded by Crawford to reclassify 300 feet of Wyman Hill Road (TH 45) off of Townshend Road as Class III. MOTION PASSED UNANIMOUSLY.

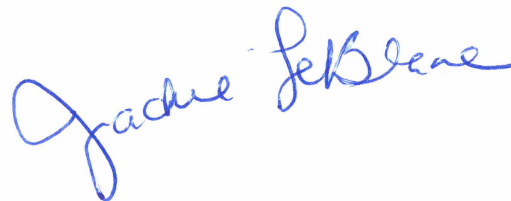

TOWN OF GRAFTON  
NOTICE OF HEARING

In accordance with V.S.A. Title 19, Chapter 7, Section 709, the Town of Grafton will hold a hearing on January 05, 2007, 10:00 am regarding the reclassification of approximately 300 feet of Wyman Hill Road from Class IV to Class III. The meeting will be held at the Wyman Hill Road to inspect the site and receive testimony.

GRAFTON BOARD OF SELECTMEN

Road Foreman's Comments: Road is done and is  
up the specs.

Selectboards Decision:

The application of Robert Hallock to do work  
within the Town Right of Way on Town Highway # 45

Road name Wymon Hill is hereby:

Approved with these conditions:

\_\_\_\_\_  
\_\_\_\_\_

Denied for these reasons:

\_\_\_\_\_  
\_\_\_\_\_

Date: 1/5/2007

SELECTBOARD:

Robert Hallock  
Christopher...  
David...  
Paul...  
Wesley

TOWN HWY. NO.	LENGTH IN MILES CLASS 3	LENGTH IN MILES CLASS 4
5	3.960	
7	2.190	
8	2.130	
9	0.020	
10	0.650	
11	0.930	
12	0.060	(0.140)
13		(0.500)
14	0.150	
15	1.430	(0.540)
16	0.100	
17	0.200	
18	0.950	
19	0.530	
20	2.950	
21	0.310	(0.190)
22	0.140	
23	0.220	(0.590)
24	0.210	(0.590)
25	1.170	
26	0.200	
28	0.200	(0.190)
29	1.800	
30	0.050	
31	0.270	
32		(0.280)
33		(0.300)
34	0.080	(0.460)
35	0.390	
36	0.230	(0.180)
37	0.510	
38	2.500	
39	1.770	
41		(0.650)
42	0.680	(0.620)
43	2.080	(2.850)
44	0.270	(0.180)
45	0.120	(0.680)
46	0.710	
47	0.150	
48	0.110	
49	0.060	
50	0.050	
51	0.050	
52	0.030	
53	0.160	
<b>TOTAL</b>	<b>30.760</b>	<b>8.910</b>

**MILEAGE SUMMARY**

CLASS 2	CLASS 3	TOTAL CLASS 2	TOTAL CLASS 3	TOTAL TOWN
TH-1 9.770				
TH-2 3.730				
TH-3 4.540				
TH-4 0.260				
		<b>18.300</b>		
			<b>30.760</b>	
				<b>49.060</b>

**TOTAL, TRAVELED HIGHWAYS, FEB. 10, 2006: 49.060**  
(Excludes Class 4 Mileage)

- HIGHWAYS**
- INTERSTATE
  - U.S. ROUTE
  - STATE ROUTE
  - CLASS 1
  - CLASS 2
  - CLASS 3
  - CLASS 4
  - INTERSTATE OR DIVIDED HIGHWAY
  - STATE - HARD SURFACE OR PAVED
  - TOWN - HARD SURFACE OR PAVED
  - GRAVEL
  - SOIL OR GRADED AND DRAINED EARTH
  - UNIMPROVED OR PRIMITIVE
  - IMPASSABLE OR UNTRAVELED
  - LEGAL TRAIL
  - DISCONTINUED
  - HIGHWAY CLASS CHANGE
  - RAILROAD
- PUBLIC LAND**
- POLITICAL SUBDIVISIONS
  - STATE BOUNDARY
  - COUNTY BOUNDARY
  - TOWN BOUNDARY
  - VILLAGE BOUNDARY
  - URBAN COMPACT
- WATER BODIES**
- OPEN WATER
  - SWAMP
  - STREAM OR BROOK
  - BRIDGE OR CULVERT
  - BRIDGE OR CULVERT GREATER THAN 20'
  - BRIDGE OR CULVERT 6' - 20'
- B34 STATE BRIDGE IDENTIFIER**  
**B34 TOWN BRIDGE IDENTIFIER**

- FEDERAL CLASSIFICATION IDENTIFIER**
- FAU - URBAN ARTERIAL OR COLLECTOR
  - MA - MINOR ARTERIAL
  - MJC - MAJOR COLLECTOR
  - MNC - MINOR COLLECTOR
  - PA - PRINCIPAL ARTERIAL

**DISCLAIMER:**  
The untraveled highways (laid-out town highways), discontinued highways, and legal trails shown herein are those of which the Agency of Transportation has record; others may exist.  
Highway and bridge data by the Agency of Transportation, Policy & Planning Division. All other data from the Vermont Center for Geographic Information.

Vermont State Plane Coordinate System  
North American Datum of 1983  
SPCS Zone Identifier: 4009  
Geodetic Reference System 80  
4,000-meter grid, Easting - Northing

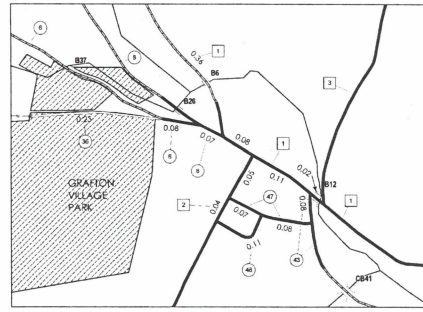
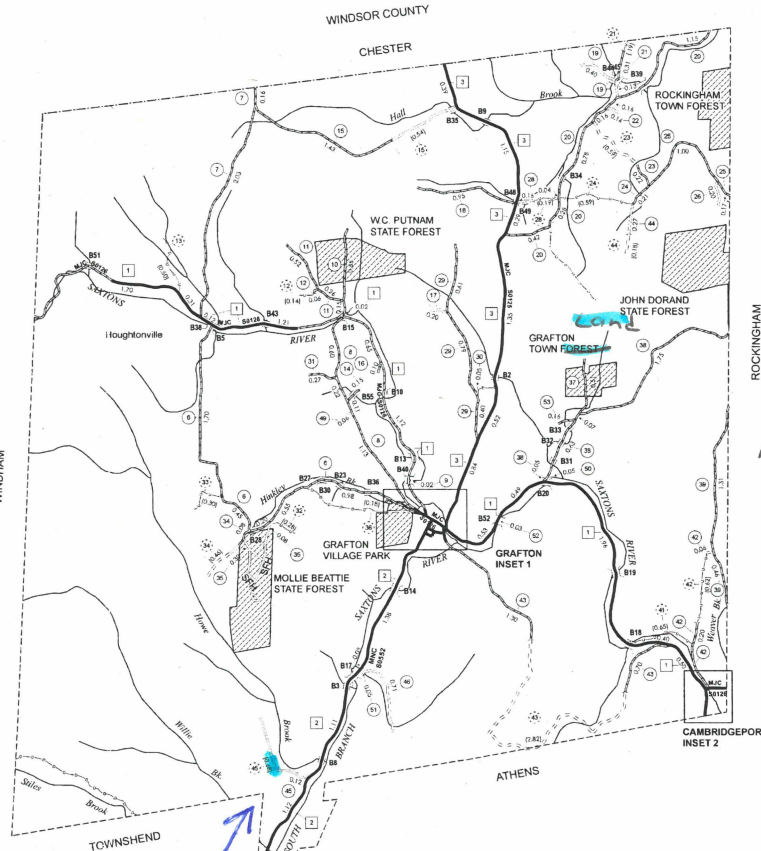

*Not Grafton Town Forest  
(Grafton Town Land)*

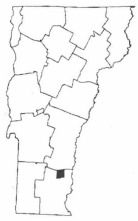
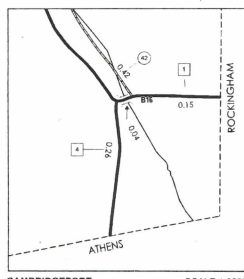

**VERMONT  
GENERAL HIGHWAY MAP  
Town of Grafton  
WINDHAM COUNTY**

Transportation District #2

Prepared by the  
Vermont Agency of Transportation  
Policy & Planning Division  
in cooperation with  
U.S. Department of Transportation  
Federal Highway Administration

Mileage as of Feb. 10, 2006  
Map generated November 2006

